

~~To replace M.D. submitted to Stewart #4 same location~~

UNITED STATES  
DEPARTMENT OF THE INTERIOR  
BUREAU OF LAND MANAGEMENT

30-045-28909  
APPLICATION FOR PERMIT TO DRILL, DEEPEN, OR PLUG BACK

1a. TYPE OF WORK DRILL	5. LEASE NUMBER SF-068990
1b. TYPE OF WELL GAS	6. IF INDIAN, ALL. OR TRIBE NAME
2. OPERATOR MERIDIAN OIL INC.	7. UNIT AGREEMENT NAME
3. ADDRESS & PHONE NO. OF OPERATOR P O BOX 4289 FARMINGTON, NM 87499	8. FARM OR LEASE NAME SHIOTANI FEDERAL
4. LOCATION OF WELL 1630' FSL 870' FWL	9. WELL NO. 400
14. DISTANCE IN MILES FROM NEAREST TOWN 3 MILES E. OF FARMINGTON	10. FIELD, POOL, OR WILDCAT BASIN 71629 FRUITLAND COAL
15. DISTANCE FROM PROPOSED LOCATION 870' TO NEAREST PROPERTY OR LEASE LINE. This action is subject to technical and procedural review pursuant to 43 CFR 3165.3 and appeal pursuant to 91.00000	11. SEC. T. R. M OR BLK. SEC. 8 T29N R12W NMPM
16. ACRES IN LEASE	12. COUNTY SAN JUAN
17. ACRES ASSIGNED TO WELL 320.00-325.77- DRILLING OPERATIONS AUTHORIZED AND SUBJECT TO COMPLIANCE WITH ATTACHED "GENERAL REQUIREMENTS".	13. STATE NM
18. DISTANCE FROM PROPOSED LOCATION TO NEAREST WELL DR. 140' COMPL., OR APPLIED FOR ON THIS LEASE.	19. PROPOSED DEPTH 1900'
20. ROTARY OR CABLE TOOLS ROTARY	
21. ELEVATIONS (DF, FT, GR, ETC.) 5608' GL	22. APPROX. DATE WORK WILL START

23. PROPOSED CASING AND CEMENTING PROGRAM

\*SEE OPERATIONS PLAN

24. AUTHORIZED BY: [Signature]  
REG. DRILLING ENGR.

RECEIVED  
DEC 23 1992  
OIL CON. DIV.  
DIST. 3

DATE

RECEIVED  
BLM

PERMIT NO. \_\_\_\_\_ APPROVAL DATE \_\_\_\_\_

APPROVED BY \_\_\_\_\_ TITLE \_\_\_\_\_ DATE \_\_\_\_\_ APPROVED AS AMENDED

NOTE: THIS FORMAT IS ISSUED IN LIEU OF US BLM FORM 3160-3. DEC 18 1992

AREA MANAGER

03-12-19

NOV 1971

Submit to Appropriate  
District Office  
State Lease - 4 copies  
Fee Lease - 3 copies

State of New Mexico  
Energy, Minerals and Natural Resources Department

Form C-102  
Revised 1-1-89

OIL CONSERVATION DIVISION

P.O. Box 2088  
Santa Fe, New Mexico 87504-2088

DISTRICT I  
P.O. Box 1980, Hobbs, NM 88240

DISTRICT II  
P.O. Drawer DD, Artesia, NM 88210

DISTRICT III  
1000 Rio Brazos Rd., Aztec, NM 87410

WELL LOCATION AND ACREAGE DEDICATION PLAT

All Distances must be from the outer boundaries of the section

Operator Meridian Oil Inc.		Lease Shiotani Federal (SF-068990)		Well No 400
Unit Letter L	Section 8	Township 29 N	Range 12 W	County San Juan
Actual Footage Location of Well 1630 feet from the South line and 870 feet from the West line				
Ground level Elev. 5608	Producing Formation Fruitland Coal	Pool Basin	Dedicated Acreage 325.77 Acres	

1. Outline the acreage dedicated to the subject well by colored pencil or hatchure marks on the plat below.

2. If more than one lease is dedicated to the well, outline each and identify the ownership thereof (both as to working interest and royalty).

3. If more than one lease of different ownership is dedicated to the well, have the interest of all owners been consolidated by communitization, unitization, force-pooling, etc.?

☐ Yes

☐ No

If answer is "yes" type of consolidation communitization agreement will be obtained  
this form if necessary.

No allowable will be assigned to the well until all interests have been consolidated (by communitization, unitization, forced-pooling, or otherwise) or until a non-standard unit, eliminating such interest, has been approved by the Division.

0 330 660 990 1320 1650 1980 2310 2640 2000 1500 1000 500 0

N 89° 22' W 40.00 ac. N 89° 43' W 38.67 ac.

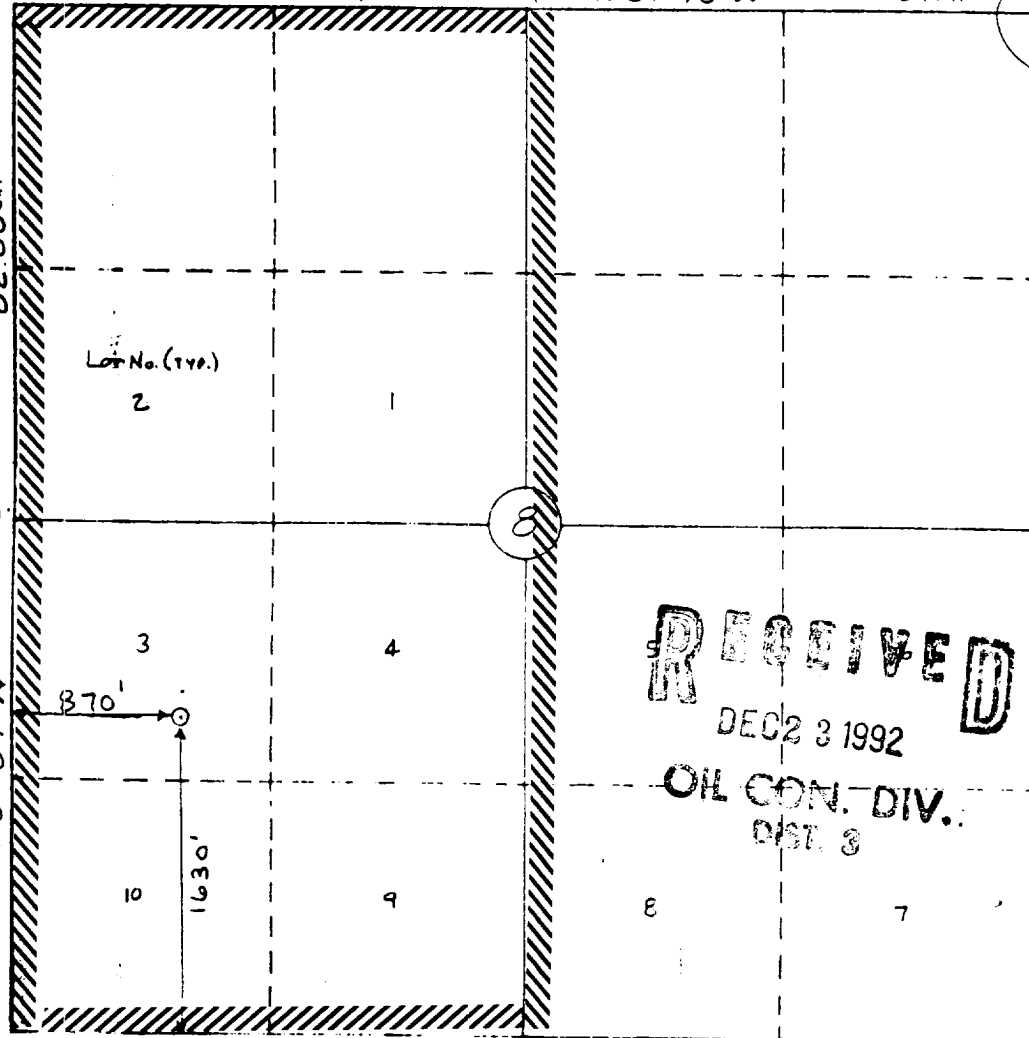

OPERATOR CERTIFICATION

I hereby certify that the information contained herein is true and complete to the best of my knowledge and belief.

Signature  
Peggy Bradfield

Printed Name  
Regulatory Affairs

Position  
Meridian Oil Inc.

Company  
12-10-92

Date

SURVEYOR CERTIFICATION

I hereby certify that the well location shown on this plat was plotted from field notes of actual surveys made by me or under my supervision, and that the same is true and correct to the best of my knowledge and belief.

11-19-92

Date Surveyed  
William M. Mahne II

Signature & Seal of Professional Surveyor

Certificate No. 8466

OPERATIONS PLAN

**Well Name:** Shiotani Federal #400  
**Location:** 1630'FSL, 870'FWL, Section 8, T-29-N, R-12-W  
 San Juan County, New Mexico  
**Formation:** Basin Fruitland Coal  
**Elevation:** 5608'GL

Formation:	Top	Bottom	Contents
Surface	Nacimiento	248'	
Ojo Alamo	248'	338'	aquifer
Kirtland	338'	1251'	
Fruitland	1251'	1365'	
Fruitland Coal Top	1365'	1614'	gas & salt water
Pictured Cliffs	1621'		gas & salt water
Total Depth	1900'		

**Logging Program:** Mud logs from 1150' to Total Depth.

**Mud Program:**

Interval	Type	Weight	Vis.	Fluid Loss
0- 200'	Spud	8.4-8.9	40-50	no control
200-1900'	Non-dispersed	8.4-9.5	30-60	no control

**Casing Program:**

Hole Size	Depth Interval	Csg.Size	Wt.	Grade
12 1/4"	0 - 200'	8 5/8"	24.0#	K-40
7 7/8"	0 - 1900'	4 1/2"	10.5#	K-55

**Tubing Program:**

0 - 1900'	2 3/8"	4.7#	J-55
-----------	--------	------	------

**Float Equipment:** 8 5/8" surface casing - saw tooth guide shoe.  
 Centralizers will be run in accordance with Onshore Order #2.

4 1/2" production casing - float shoe on bottom. Three centralizers run every other joint above shoe. Two centralizers run every 3rd joint to the base of the Ojo Alamo @ 338'. Two turbolizing type centralizers - one below and one into the base of the Ojo Alamo @ 338'. Standard centralizers thereafter every fourth joint up to the base of the surface pipe.

**Wellhead Equipment:** 8 5/8" x 4 1/2" x 2 3/8" x 11" 3000 psi xmas tree assembly.



**UNITED STATES  
DEPARTMENT OF THE INTERIOR  
BUREAU OF LAND MANAGEMENT**

**Sundry Notices and Reports on Wells**

<p>1. Type of Well GAS</p> <p>2. Name of Operator Meridian Oil Inc.</p> <p>3. Address &amp; Phone No. of Operator PO Box 4289, Farmington, NM 87499 (505) 326-9700</p> <p>4. Location of Well, Footage, Sec., T, R, M 1630' FSL, 870' FWL Sec. 8 T-29-N, R-12-W, NMPM</p>	<p>5. Lease Number SF-068990</p> <p>6. If Indian, All. or Tribe Name</p> <p>7. Unit Agreement Name</p> <p>8. Well Name &amp; Number Shiotani Fed #400</p> <p>9. API Well No. 30-045-</p> <p>10. Field and Pool Basin Frt Coal</p> <p>11. County and State San Juan Co, NM</p>
---	---

**12. CHECK APPROPRIATE BOX TO INDICATE NATURE OF NOTICE, REPORT, OTHER DATA**

**Type of Submission**

**Type of Action**

<input type="checkbox"/> Notice of Intent	<input type="checkbox"/> Abandonment	<input type="checkbox"/> Change of Plans
<input checked="" type="checkbox"/> Subsequent Report	<input type="checkbox"/> Recompletion	<input type="checkbox"/> New Construction
<input type="checkbox"/> Final Abandonment	<input type="checkbox"/> Plugging Back	<input type="checkbox"/> Non-Routine Fracturing
	<input type="checkbox"/> Casing Repair	<input type="checkbox"/> Water Shut off
	<input type="checkbox"/> Altering Casing	<input type="checkbox"/> Conversion to Injection
	<input type="checkbox"/> Other -	

**13. Describe Proposed or Completed Operations**

12-30-92 Spudded well at 5:15 am. Drilled to 221'. Ran 5 jts. 8 5/8", 24.0#, K-55 surface casing set at 222'. Cemented with 235 sks. Class "G" with 3% calcium chloride and 1/4#/sx flocele (270 cu.ft.) circulated to surface. WOC 12 hrs. Tested 600#/30 min., OK.

01-01-93 TD 1900'. Ran 45 jts. 4 1/2", 10.5#, K-55 casing 1887' set @ 1899'. Stage tool @ 1216'. Cemented first stage with 150 sks. Class "B" 65/35 Pozmix, 6% gel, 5#/sx gilsonite, 1/4#/sx cello-seal and 2% calcium chloride, (266 cu.ft.), tailed w/80 sx Class "B" w/2% calcium chloride (93 cu.ft.). Cemented 2nd stage with 330 sks. Class "B" 65/35 Pozmix, 6% gel, 2% calcium chloride, 5#/sx gilsonite, and 1/4#/sx cello-seal (584 cu.ft.), tailed w/25 sx Class "B" w/2% calcium chloride (29 cu.ft.). WOC 18 hours. Circ 35 bbl. to surface.

**RECEIVED**

JAN 1 5 1993

**OIL CONTROL**  
DIST. 2

**RECEIVED  
BULM MAIL ROOM**

**14. I hereby certify that the foregoing is true and correct.**

Signed [Signature] Title Regulatory Affairs Date 1/4/93

(This space for Federal or State Office use)

APPROVED BY \_\_\_\_\_ Title \_\_\_\_\_ **ACCEPTED FOR RECORD** Date \_\_\_\_\_

CONDITION OF APPROVAL, if any: