

Submit to Appropriate
District Office
State Lease - 6 copies
Fee Lease - 5 copies

State of New Mexico
Energy, Minerals and Natural Resources Department

Form C-101
Revised 1-1-89

OIL CONSERVATION DIVISION

DISTRICT I
P.O. Box 1980, Hobbs, NM 88240
DISTRICT II
P.O. Drawer DD, Artesia, NM 88210
DISTRICT III
1000 Rio Brazos Rd., Aztec, NM 87410

P.O. Box 2088
Santa Fe, New Mexico 87504-2088

API NO. (assigned by OCD on New Wells)
30-045-28792
5. Indicate Type of Lease STATE <input type="checkbox"/> FEE <input checked="" type="checkbox"/>
6. State Oil & Gas Lease No.

APPLICATION FOR PERMIT TO DRILL, DEEPEN, OR PLUG BACK

1a. Type of Work: DRILL <input checked="" type="checkbox"/> RE-ENTER <input type="checkbox"/> DEEPEN <input type="checkbox"/> PLUG BACK <input type="checkbox"/>	7. Lease Name or Unit Agreement Name Northridge 13564
b. Type of Well: OIL WELL <input type="checkbox"/> GAS WELL <input checked="" type="checkbox"/> OTHER <input type="checkbox"/> SINGLE ZONE <input type="checkbox"/> MULTIPLE ZONE <input type="checkbox"/>	8. Well No. 1 (160-51)
2. Name of Operator Robert L. Bayless 19418	9. Pool name or Wildcat 66725 Undesignated Pictured Cliffs
3. Address of Operator P O Box 168 Farmington, N.M. 87499	
4. Well Location Unit Letter A : 1205 Feet From The North Line and 584 Feet From The East Line Section 3 Township 29N Range 13W NMPM San Juan County	

10. Proposed Depth 1660	11. Formation Pictured Cliffs	12. Rotary or C.T. Rotary
13. Elevations (Show whether DF, RT, GR, etc.) 5511 GR ✓	14. Kind & Status Plug. Bond	15. Drilling Contractor
16. Approx. Date Work will start October 1, 1993		

PROPOSED CASING AND CEMENT PROGRAM					
SIZE OF HOLE	SIZE OF CASING	WEIGHT PER FOOT	SETTING DEPTH	SACKS OF CEMENT	EST. TOP
9 7/8	7 5/8	26.4	120	45	Surface
6 3/4	5 1/2	14.0	1660	125	Surface

Will drill 9 7/8" hole to 120 ft and set 120 ft 7 5/8" 26.4#/ft J-55 used casing with 45 sx Class B cement circulated to surface. Will drill 6 3/4" hole to 1660 ft and set 1660 ft of 5 1/2" 14.0#/ft M-50 new casing with 125 sx cement, circulated to surface. Circulating medium will be clear water, natural mud, and water loss control additives. No abnormal pressures or temperatures are anticipated. Induction and density logs will be run. Blowout preventer schematic is attached. The gas from this well is not dedicated.

Estimated Tops

Ojo Alamo Surface
Fruitland 1141
Pictured Cliffs 1436

This Approval
Expires 9-8-94
And Will Not Be
Extended

RECEIVED
SEP - 3 1993
OIL CON. DIV.
DIST. 3

IN ABOVE SPACE DESCRIBE PROPOSED PROGRAM: IF PROPOSAL IS TO DEEPEN OR PLUG BACK, GIVE DATA ON PRESENT PRODUCTIVE ZONE AND PROPOSED NEW PRODUCTIVE ZONE. GIVE BLOWOUT PREVENTER PROGRAM, IF ANY.

I hereby certify that the information above is true and complete to the best of my knowledge and belief.

SIGNATURE Price M. Bayless TITLE Engineer DATE 8/31/93

TYPE OR PRINT NAME Price M. Bayless TELEPHONE NO. 505-326-2659

(This space for State Use)

APPROVED BY Price M. Bayless TITLE DEPUTY OIL & GAS INSPECTOR, DIST. 3 DATE SEP 08 1993

CONDITIONS OF APPROVAL, IF ANY:

Held C-104 For USL & city notification & approval

Submit to Appropriate
District Office
State Lease - 4 copies
Fee Lease - 3 copies

State of New Mexico
Energy, Minerals and Natural Resources Department

Form C-102
Revised 1-1-89

OIL CONSERVATION DIVISION

P.O. Box 2088
Santa Fe, New Mexico 87504-2088

DISTRICT I
P.O. Box 1980, Hobbs, NM 88240

DISTRICT II
P.O. Drawer DD, Artesia, NM 88210

DISTRICT III
1000 Rio Brazos Rd., Aztec, NM 87410

WELL LOCATION AND ACREAGE DEDICATION PLAT

All Distances must be from the outer boundaries of the section

Operator ROBERT L. BAYLESS		Lease NORTHRIDGE		Well No. 1
Unit Letter A	Section 3	Township 29 N	Range 13 W	County San Juan
Actual Footage Location of Well: 1205 feet from the North line and 584 feet from the East line				
Ground level Elev. 5511	Producing Formation Pictured Cliffs	Pool Undesignated Pictured Cliffs	Dedicated Acreage: 160 Acres	
<p>1. Outline the acreage dedicated to the subject well by colored pencil or hatchure marks on the plat below.</p> <p>2. If more than one lease is dedicated to the well, outline each and identify the ownership thereof (both as to working interest and royalty).</p> <p>3. If more than one lease of different ownership is dedicated to the well, have the interest of all owners been consolidated by communitization, unitization, force-pooling, etc.? <input type="checkbox"/> Yes <input type="checkbox"/> No If answer is "yes" type of consolidation _____</p> <p>If answer is "no" list the owners and tract descriptions which have actually been consolidated. (Use reverse side of this form if necessary.) _____</p> <p>No allowable will be assigned to the well until all interests have been consolidated (by communitization, unitization, forced-pooling, or otherwise) or until a non-standard unit, eliminating such interest, has been approved by the Division.</p>				

330 660 990 1320 1650 1980 2310 2640 2000 1500 1000 500 0

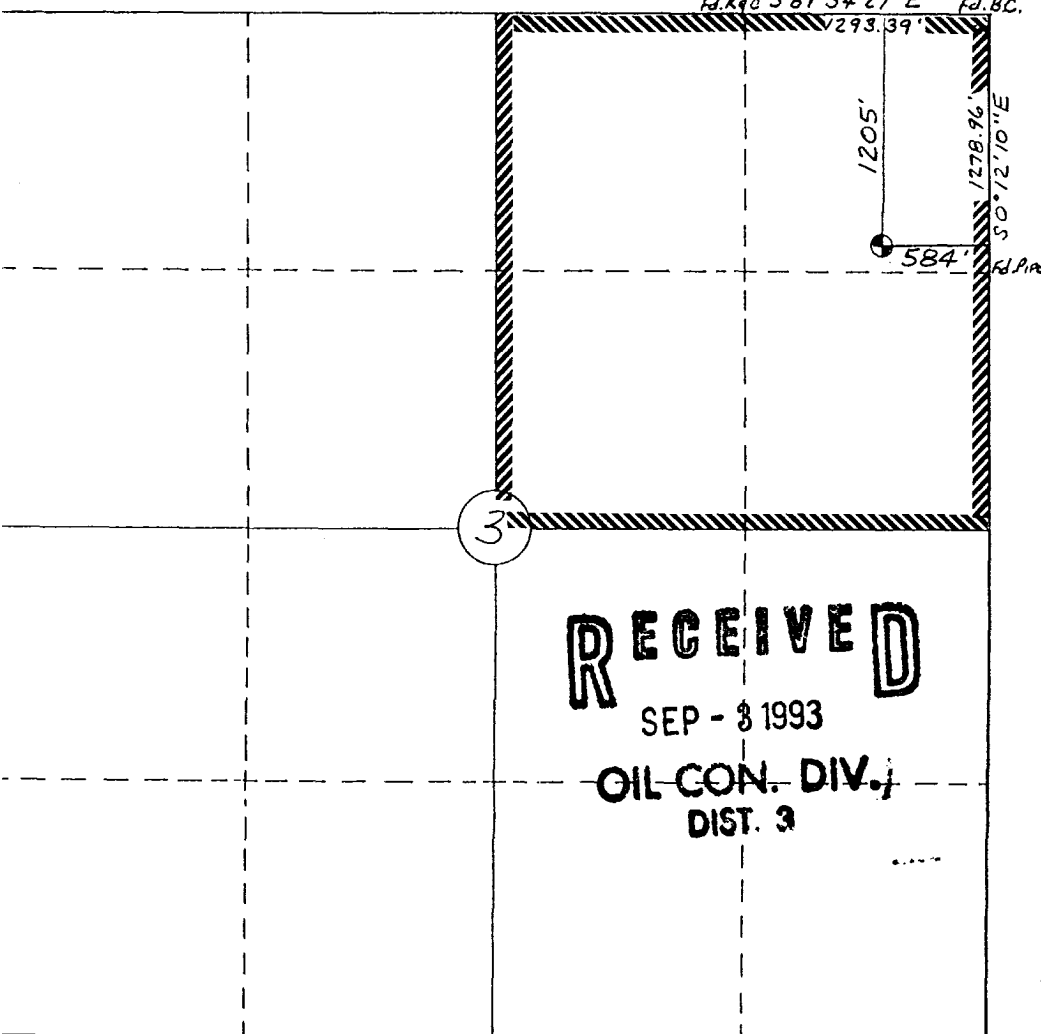

OPERATOR CERTIFICATION

I hereby certify that the information contained herein in true and complete to the best of my knowledge and belief.

Signature *P. M. Bayless*
Printed Name **Price M. Bayless**
Position **Engineer**
Company **Robert L. Bayless, Producer**
Date _____

SURVEYOR CERTIFICATION

I hereby certify that the well location shown on this plat was plotted from field notes of actual surveys made by me or under my supervision, and that the same is true and correct to the best of my knowledge and belief.

23 Aug., 1993

Date Surveyed
William F. Mahnke II

Signature & Seal of Professional Surveyor

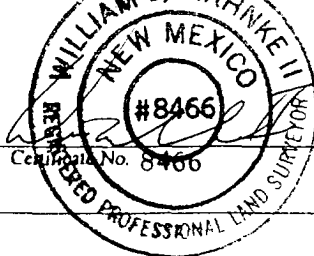

ROBERT L. BAYLESS
 NORTH RIDGE #1
 1205' FNL & 584' FEL
 Sec. 3, T29N, R13W
 San Juan Co., N.M.

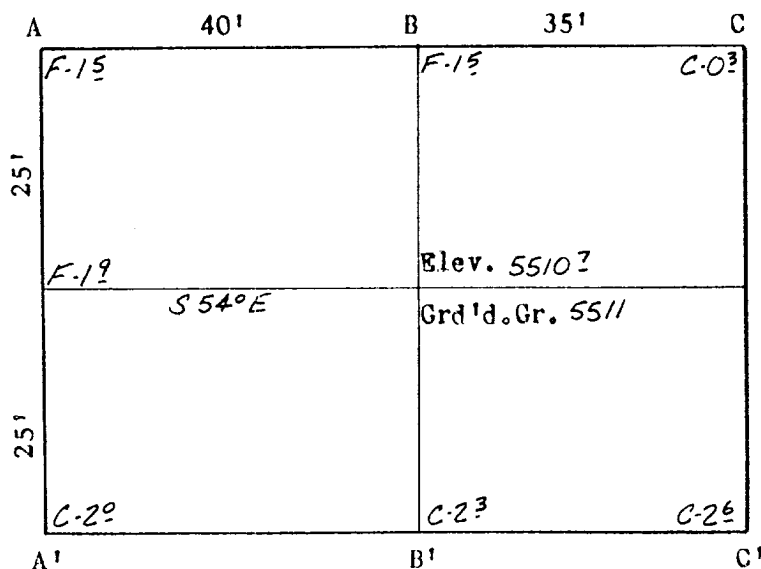

Scale: 1"=20'

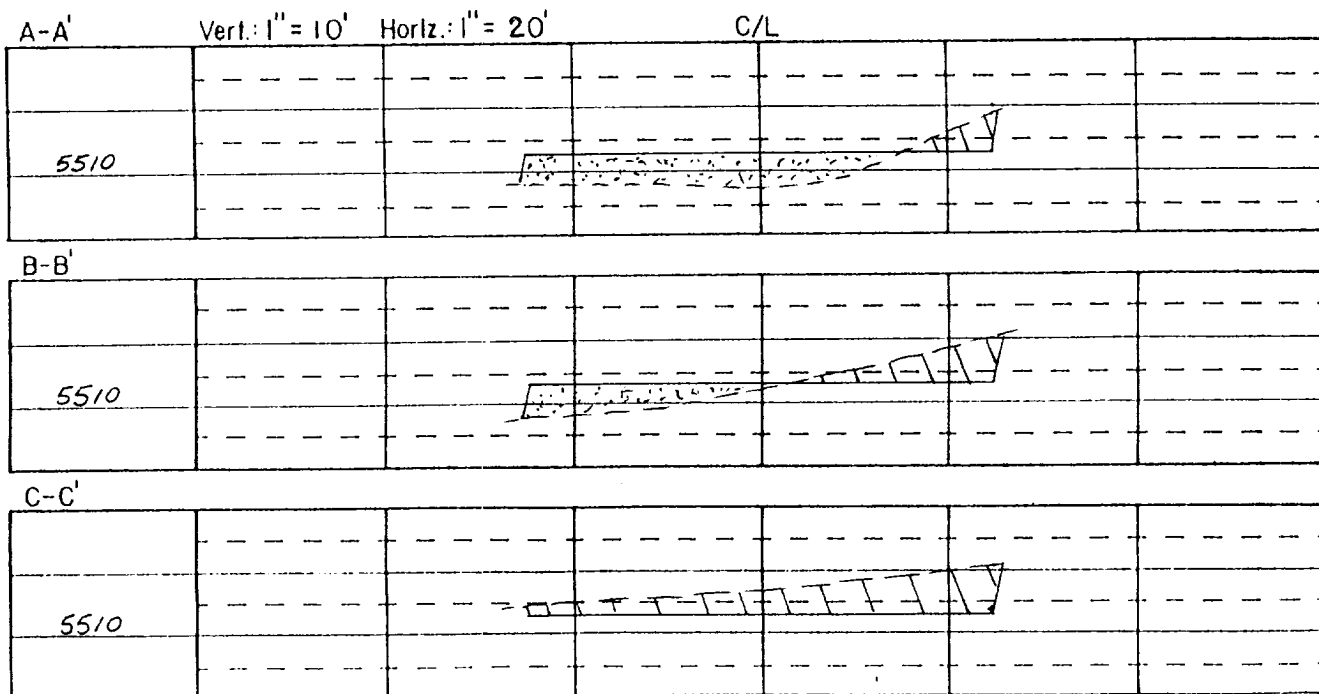

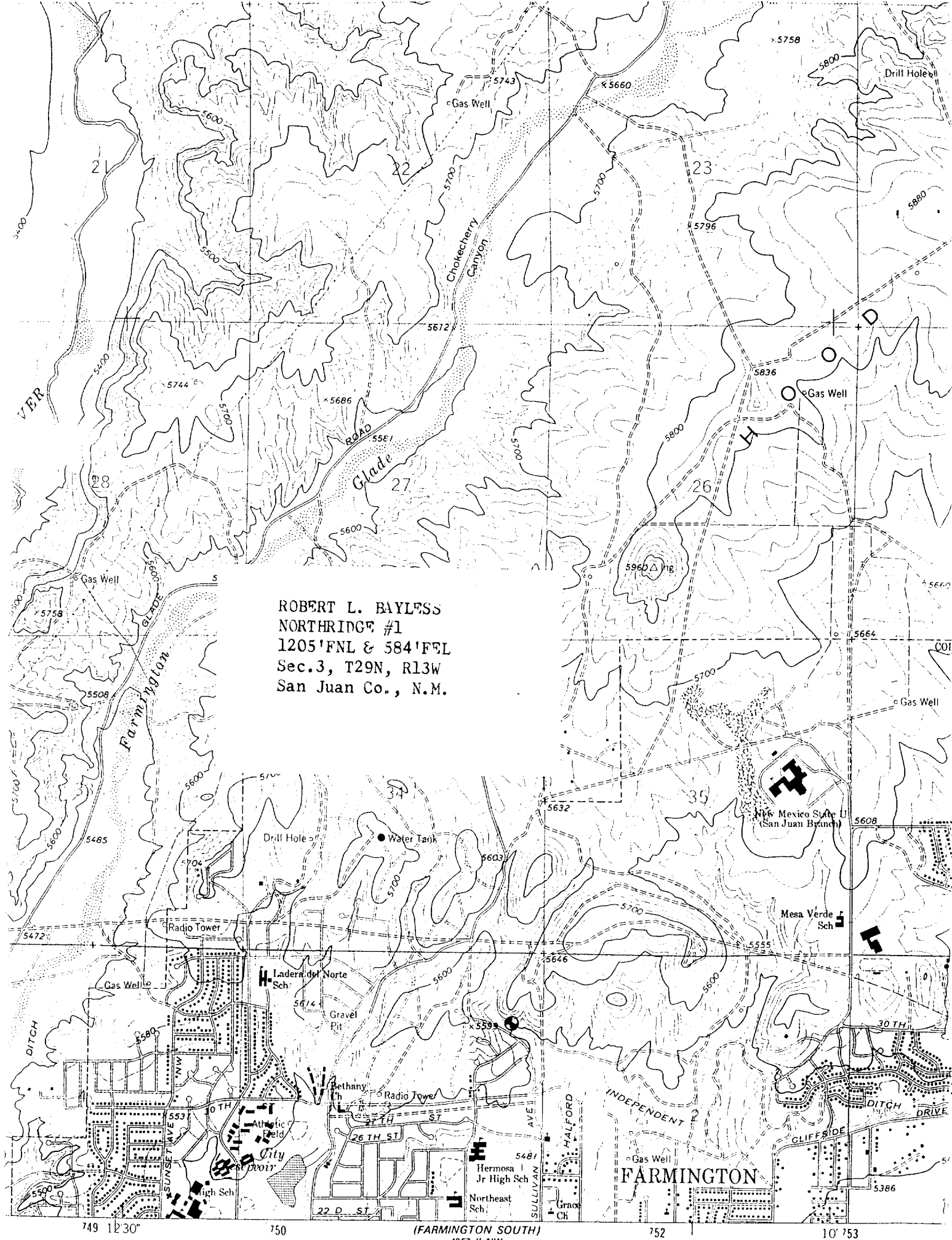

ROBERT L. BAYLESS
NORTH RIDGE #1
1205' FNL & 584' FEL
Sec. 3, T29N, R13W
San Juan Co., N.M.