

Submit 3 Copies
to Appropriate
District Office

State of New Mexico
Energy, Minerals and Natural Resources Department

Form C-103
Revised 1-1-89

DISTRICT I
P.O. Box 1980, Hobbs, NM 88240

DISTRICT II
P.O. Drawer DD, Artesia, NM 88210

DISTRICT III
1000 Rio Brazos Rd., Aztec, NM 87410

OIL CONSERVATION DIVISION
P.O. Box 2088
Santa Fe, New Mexico 87504-2088

WELL API NO.	30-045-29035
5. Indicate Type of Lease	STATE <input type="checkbox"/> FEE <input checked="" type="checkbox"/>
6. State Oil & Gas Lease No.	

SUNDRY NOTICES AND REPORTS ON WELLS
(DO NOT USE THIS FORM FOR PROPOSALS TO DRILL OR TO DEEPEN OR PLUG BACK TO A
DIFFERENT RESERVOIR. USE "APPLICATION FOR PERMIT"
(FORM C-101) FOR SUCH PROPOSALS)

7. Lease Name or Unit Agreement Name

Redfern

RECEIVED

DEC 27 1993

OIL CON. DIV
DIST. 3

1. Type of Well: OIL WELL <input type="checkbox"/> GAS WELL <input checked="" type="checkbox"/> OTHER	8. Well No. 1
2. Name of Operator Hallwood Petroleum, Inc. 9812	9. Pool name or Wildcat
3. Address of Operator P.O. Box 378111, Denver, Colorado 80237	

4. Well Location Unit Letter <u>K</u> : <u>1,470</u> Feet From The <u>South</u> Line and <u>1,500</u> Feet From The <u>West</u> Line

Section <u>14</u> Township <u>29N</u> Range <u>13W</u> NMPM San Juan County	10. Elevation (Show whether LF, RKB, RT, GR, etc.) 5,340' GL
---	---

11. Check Appropriate Box to Indicate Nature of Notice, Report, or Other Data	
NOTICE OF INTENTION TO:	SUBSEQUENT REPORT OF:
PERFORM REMEDIAL WORK <input type="checkbox"/>	REMEDIAL WORK <input type="checkbox"/>
TEMPORARILY ABANDON <input type="checkbox"/>	ALTERING CASING <input type="checkbox"/>
PULL OR ALTER CASING <input type="checkbox"/>	COMMENCE DRILLING OPNS. <input type="checkbox"/>
OTHER: <input type="checkbox"/>	PLUG AND ABANDONMENT <input type="checkbox"/>
	CASING TEST AND CEMENT JOB <input type="checkbox"/>
	OTHER: <input type="checkbox"/>

12. Describe Proposed or Completed Operations (Clearly state all pertinent details, and give pertinent dates, including estimated date of starting any proposed work) SEE RULE 1103.
--

Hallwood Petroleum, Inc. has moved the spot location of the proposed new Fruitland Coal well 350 feet to the southwest to comply and cooperate with the surface owner's request.

The new location is listed above: Unit K, 1,470' FSL & 1,500' FWL.

The old permitted location was : Unit K, 1,688' FSL & 1,848' FWL.

NOTES:

- The operator of the offset well (Conoco) in this quarter-quarter section has been notified of our drilling plans.
- A City of Farmington permit has been applied for, hearing date is 12/30/93.

I hereby certify that the information above is true and complete to the best of my knowledge and belief.

SIGNATURE Kevin E. O'Connell TITLE Drig. & Prod. Manager DATE 12/22/93

TYPE OR PRINT NAME Kevin E. O'Connell (303) TELEPHONE NO. 850-78

(This space for State Use)

APPROVED BY [Signature] DEPUTY OIL & GAS INSPECTOR DATE DEC 29 1993

CONDITIONS OF APPROVAL, IF ANY:

Submit to Appropriate
District Office
State Lease - 4 copies
Fee Lease - 3 copies

State of New Mexico
Energy, Minerals and Natural Resources Department

Form C-102
Revised 1-1-89

OIL CONSERVATION DIVISION

DISTRICT I
P.O. Box 1980, Hobbs, NM 88240

P.O. Box 2088

Santa Fe, New Mexico 87504-2088

DISTRICT II
P.O. Drawer DD, Artesia, NM 88210

DISTRICT III
1000 Rio Brazos Rd., Aztec, NM 87410

WELL LOCATION AND ACREAGE DEDICATION PLAT

All Distances must be from the outer boundaries of the section

Operator <i>Hallwood Petroleum Inc. ONE OF</i> <i>THE HALLWOOD ENERGY COMPANIES</i>		Lease <i>REDFERN</i>		Well No. <i>1</i>
Unit Letter <i>K</i>	Section <i>14</i>	Township <i>29 N</i>	Range <i>13 W</i>	County <i>San Juan</i>
Actual Footage Location of Well: <i>1470</i> feet from the <i>South</i> line and <i>1500</i> feet from the <i>West</i> line				
Ground level Elev. <i>5340</i>	Producing Formation <i>FRUITLAND COAL</i>	Pool <i>BASIN FRUITLAND</i>		Dedicated Acreage: <i>± 320</i> Acres
<p>1. Outline the acreage dedicated to the subject well by colored pencil or hatchure marks on the plat below.</p> <p>2. If more than one lease is dedicated to the well, outline each and identify the ownership thereof (both as to working interest and royalty).</p> <p>3. If more than one lease of different ownership is dedicated to the well, have the interest of all owners been consolidated by communitization, unitization, force-pooling, etc.? <input type="checkbox"/> Yes <input type="checkbox"/> No If answer is "yes" type of consolidation _____</p> <p>If answer is "no" list the owners and tract descriptions which have actually been consolidated. (Use reverse side of this form if necessary.)</p> <p>No allowable will be assigned to the well until all interests have been consolidated (by communitization, unitization, forced-pooling, or otherwise) or until a non-standard unit, eliminating such interest, has been approved by the Division.</p>				

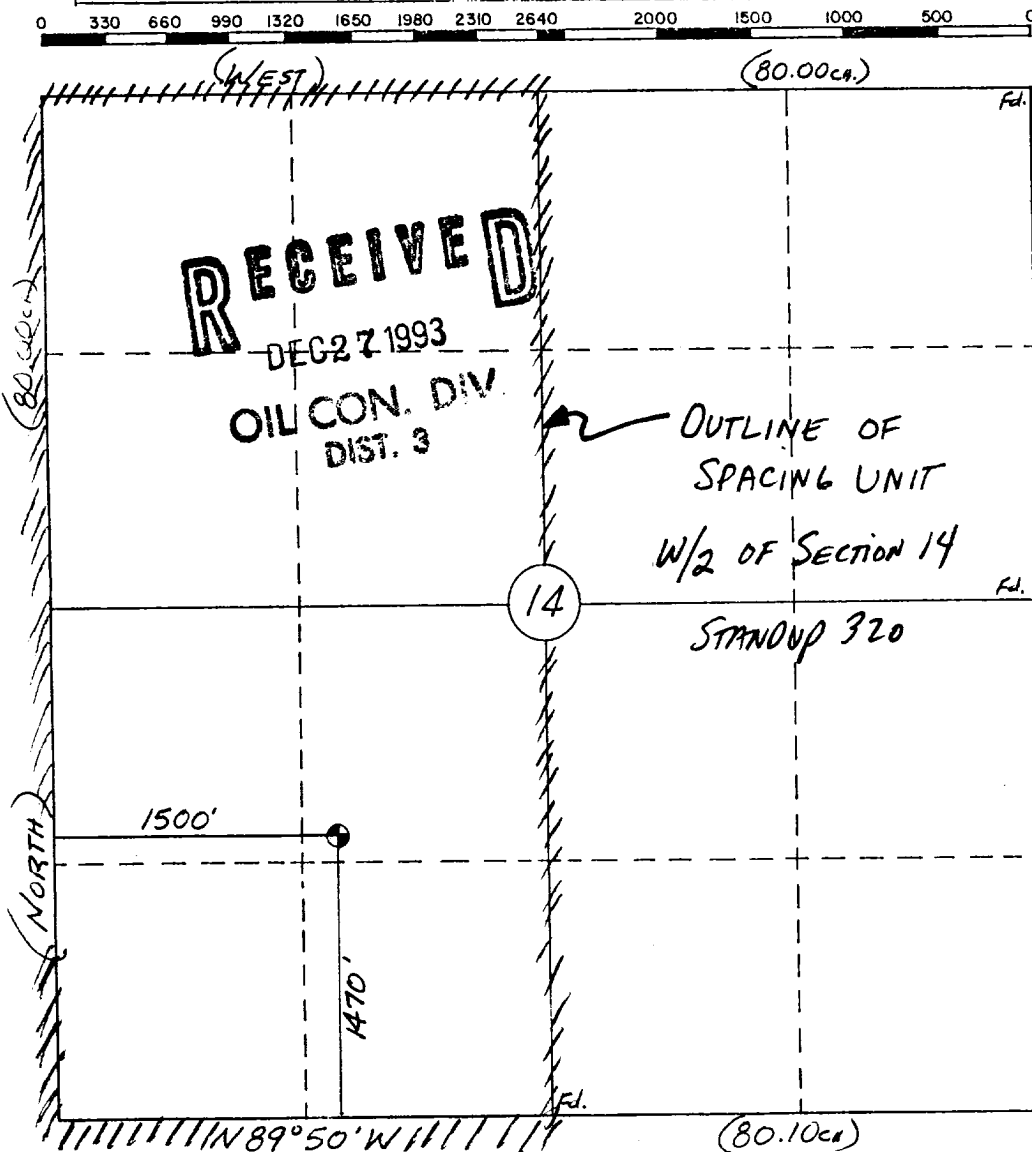

OPERATOR CERTIFICATION

I hereby certify that the information contained herein is true and complete to the best of my knowledge and belief.

Signature *Kevin E. O'Connell*
Printed Name *KEVIN E. O'CONNELL*
Position *DR/G. & PRODUCTION MNGR.*
Company *Hallwood Petroleum Inc*
Date *12/22/93*

SURVEYOR CERTIFICATION

I hereby certify that the well location shown on this plat was plotted from field notes of actual surveys made by me or under my supervision, and that the same is true and correct to the best of my knowledge and belief.

14 Dec., 1993

Date Surveyed
William E. Mahnke II

Signature of Professional Surveyor
WILSON E. MAHNKE II

Professional Surveyor
#8466
Certified

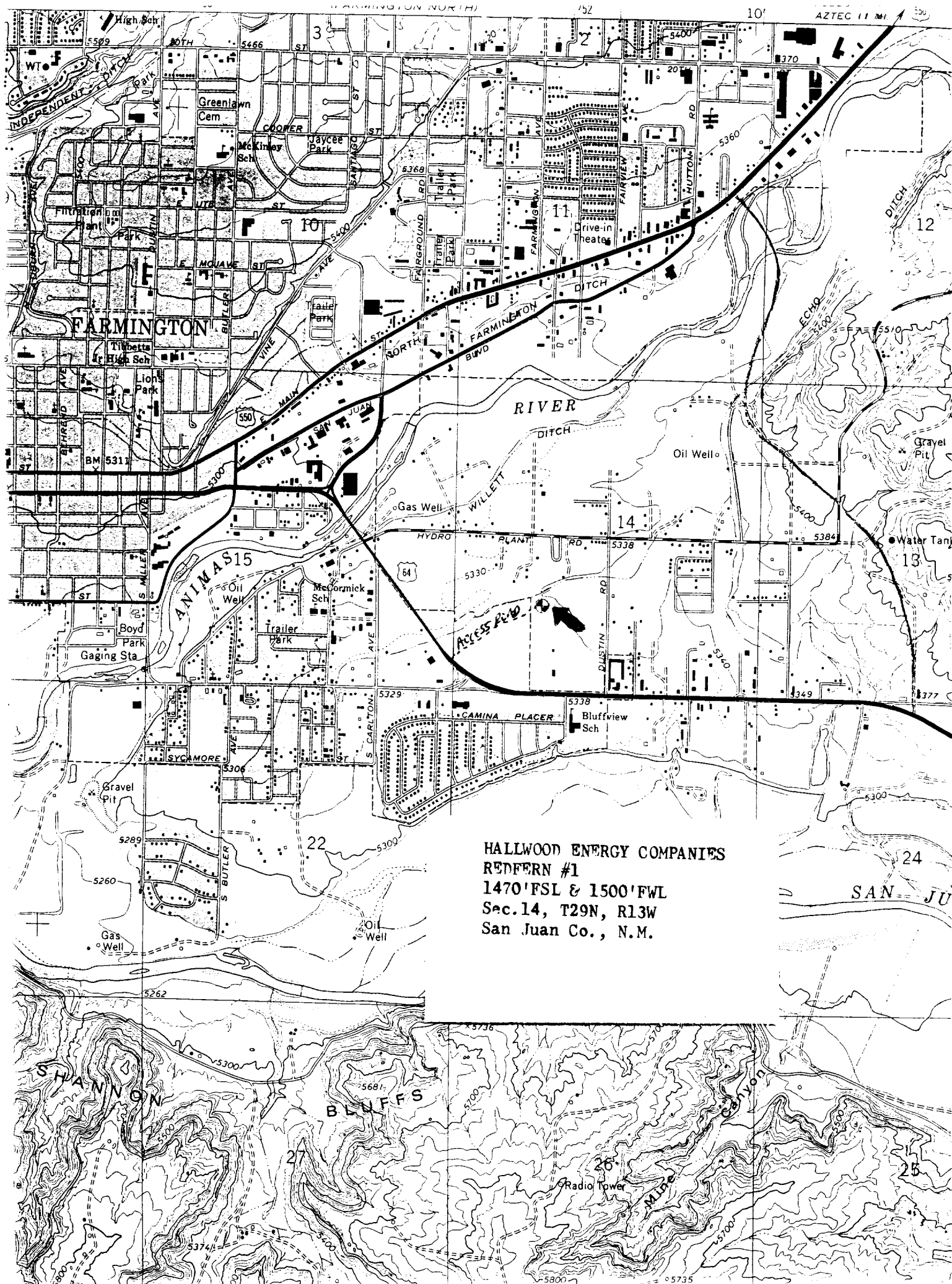

HALLWOOD ENERGY COMPANIES
REDFERN #1
1470' FSL & 1500' FWL
Sec. 14, T29N, R13W
San Juan Co., N.M.

HALLWOOD ENERGY COMPANIES
 REFERN #1
 1470' FSL & 1500' FWL
 Sec. 14, T29N, R13W
 San Juan Co., N.M.

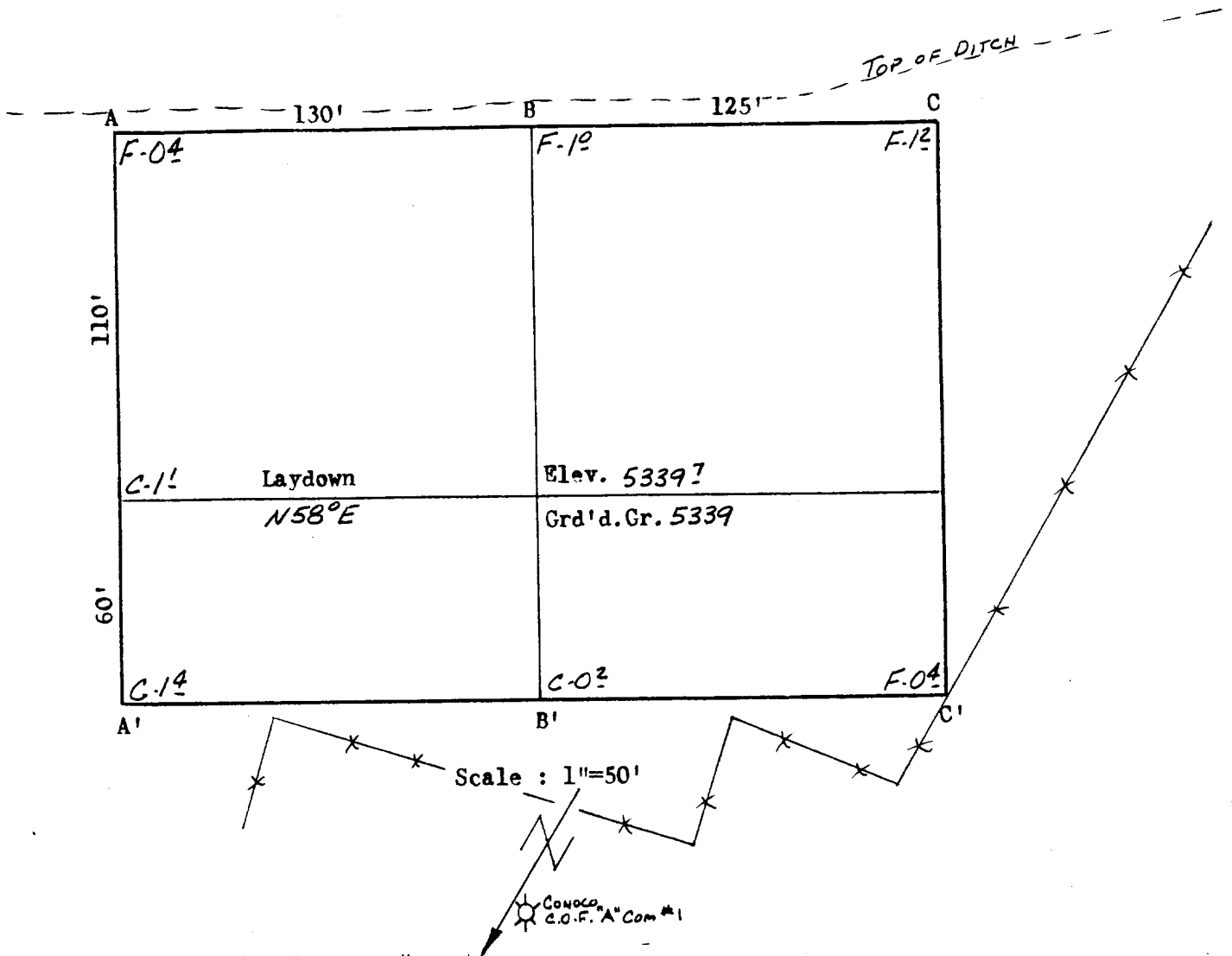

A-A' Vert.: 1" = 30' Horiz.: 1" = 100' C/L

5340	-----	-----	-----	-----	-----	-----
5330	-----	-----	-----	-----	-----	-----
	-----	-----	-----	-----	-----	-----

B-B'

5340	-----	-----	-----	-----	-----	-----
5330	-----	-----	-----	-----	-----	-----
	-----	-----	-----	-----	-----	-----

C-C'

5340	-----	-----	-----	-----	-----	-----
5330	-----	-----	-----	-----	-----	-----
	-----	-----	-----	-----	-----	-----

Rule 102. C - STATES THAT APPLICANT (HALLWOOD) SHALL
FILE A PLAT PERTAINING TO AN OFFSET
WELL IN THE SAME QUARTER / QUARTER.

CONOCO INC.
FARMINGTON "A" Com #1
1600' FSL & 1450' FWL

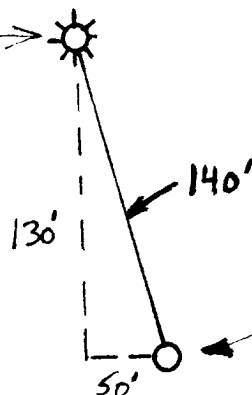

PLANNED LOCATION
Hallwood Pet.
REDFERN #1
1470' FSL X
1500' FWL

NOTE: CALCULATED DISTANCE IS 140', PAGED OFF DISTANCE
APPEARS TO BE MORE LIKE 165 - 185'.

STATEMENT: A COPY OF THIS INFORMATION AND ENTIRE
DRILLING PERMIT HAS BEEN MAILED TO:

CONOCO INC.
7415 EAST MAIN
FARMINGTON, NM 87401

by: Karen E. O'Connell DRILLING & PRODUCTION MANAGER
Hallwood Petroleum INC 121

Submit to Appropriate
District Office
State Leases - 6 copies
Fee Leases - 5 copies

State of New Mexico
Energy, Minerals and Natural Resources Department

Form C-101
Revised 1-1-89

OIL CONSERVATION DIVISION
P.O. Box 2088
Santa Fe, New Mexico 87504-2088

DISTRICT I
P.O. Box 1980, Hobbs, NM 88240

DISTRICT II
P.O. Drawer DD, Artesia, NM 88210

DISTRICT III
1000 Rio Brazos Rd., Aztec, NM 87410

API NO. (assigned by OCD on New Wells)

30-145-29035

5. Indicate Type of Lease

STATE ☐ F ☒

6. State Oil & Gas Lease No.

APPLICATION FOR PERMIT TO DRILL, DEEPEN, OR PLUG BACK

1a. Type of Work:

DRILL ☒ RE-ENTER ☐ DEEPEN ☐ PLUG BACK ☐

b. Type of Well:

OIL WELL ☐ GAS WELL ☒ OTHER ☐

SINGLE ZONE ☒

MULTIPLE ZONE ☐

7. Lease Name or Unit Agreement Name

Redfern

2. Name of Operator

Hallwood Petroleum, Inc.

3. Address of Operator

P. O. Box 378111, Denver, Colorado 80237

8. Well No.

1

9. Pool name or Wildcat

Basin Fruitland Coal

4. Well Location

Unit Letter K

1688

Feet From The

South

Line and

1848

Feet From The

West

Line

Section 14

Township 29N

Range 13W

NMPM

San Juan

County

10. Proposed Depth

1600'

11. Formation

Fruitland Coal

12. Rotary or C.T.

Rotary

13. Elevations (Show whether DF, RT, GR, etc.)

GR 5344', KB 5356'

14. Kind & Status Plug Bond

Blanket B1595 231

15. Drilling Contractor

Four Corners

16. Approx. Date Work will start

1/30/94

17.

PROPOSED CASING AND CEMENT PROGRAM

SIZE OF HOLE	SIZE OF CASING	WEIGHT PER FOOT	SETTING DEPTH	SACKS OF CEMENT	EST. TOP
12 1/4"	8-5/8"	24#	250'	175sx	Surface
7-7/8"	5-1/2"	15.5#	1600'	325sx	Surface

Hallwood Petroleum, Inc. proposes to drill a 12 1/4" hole with native mud to 250' and set 8 5/8" 24# J-55 casing at 250', cementing back to surface with approximately 175 sx of Class "B" cement. Drill 7-7/8" hole out of surface casing to 1600' with mud, log well and set 5 1/2" 15.5# J-55 production casing from 0-1600'. Cement to surface with approximately 250 sx of lead cement and 75 sx of Class "B" tail cement. Perforate and fracture stimulate coal interval and put well on beam pump to test well.

Drilling operations to include a BOP system consisting of a Shaffer LSW 10" 3000# with pipe and blind rams.

This Approval

Expires 12-9-94

Approved by

REG

DEC-8-1993

OIL C

IN ABOVE SPACE DESCRIBE PROPOSED PROGRAM: IF PROPOSAL IS TO DEEPEN OR PLUG BACK, GIVE DATA ON PRESENT PRODUCTIVE ZONE AND PROPOSED NEW PRODUCTIVE ZONE. GIVE BLOWOUT PREVENTER PROGRAM, IF ANY.

I hereby certify that the information above is true and complete to the best of my knowledge and belief.

SIGNATURE

Kevin O'Connell

TITLE Drilling & Prod. Manager

DATE 12/6/93

TYPE OR PRINT NAME

Kevin O'Connell

(303) TELEPHONE NO. 850-7373

(This space for State Use)

APPROVED BY

Ernest Buch

DEPUTY OIL & GAS INSPECTOR, DIST. #3

DEC 09 1993

CONDITIONS OF APPROVAL, IF ANY:

Subject to City Approval