

UNITED STATES
DEPARTMENT OF THE INTERIOR
BUREAU OF LAND MANAGEMENT

30-645-29046

APPLICATION FOR PERMIT TO DRILL, DEEPEN, OR PLUG BACK

5. LEASE DESIGNATION SF080614
6. INDIAN, ALLOTTEE, TRIBE NAME
7. UNIT AGREEMENT NAME GALLEGOS CANYON UNIT
8. FARM OR LEASE NAME GALLEGOS CANYON UNIT 238
9. WELL NO. 536
10. FIELD and POOL or WILDCAT Pictured Cliffs 79680
11. SEC., T., R., M., or BLK Sec. 13, T29N, R13W, NMPM
12. COUNTY or PARISH San Juan
13. STATE NM

1a. TYPE of WORK DRILL <input checked="" type="checkbox"/> DEEPEN <input type="checkbox"/> PLUG BACK <input type="checkbox"/>
b. TYPE of WELL OIL WELL <input type="checkbox"/> GAS WELL <input checked="" type="checkbox"/> OTHER <input type="checkbox"/> SINGLE ZONE <input checked="" type="checkbox"/> MULTIPLE ZONE <input type="checkbox"/>
2. NAME of OPERATOR BHP Petroleum (Americas), Inc. 2217
3. ADDRESS of OPERATOR P.O. Box 977 Farmington, NM 87499
4. LOCATION of WELL 790' FNL & 1095' FEL
14. DISTANCE IN MILES and DIRECTION from NEAREST TOWN 0.5 miles east of Farmington, NM

15. DISTANCE from PROPOSED LOCATION to NEAREST PROPERTY or LEASE LINE, Ft. 790'	16. NO. of ACRES in LEASE 280 (e)	17. NO. of ACRES ASSIGNED to WELL 160
18. DISTANCE from PROPOSED LOCATION to NEAREST WELL, DRILLING, COMPLETED, or APPLIED FOR, ON THIS LEASE, Ft. +/-100'	19. PROPOSED DEPTH 1581'	20. ROTARY or CABLE TOOLS Rotary

21. ELEVATIONS (Show DF, RT, GR, etc.) 5482' GR	22. APPROX. DATE WORK WILL START As soon as approved
---	--

23. PROPOSED CASING and CEMENTING PROGRAM				
SIZE of HOLE	SIZE of CASING	WEIGHT per FOOT	SETTING DEPTH	QUANTITY OF CEMENT
8 3/4"	7"	20#K-55	130'	35 sx (41 cu ft) circ to surface
6 1/4"	4 1/2"	10.5#K-55	1581'	200 sx (248 cu ft) circ to surface

BHP Petroleum (Americas), Inc. proposes to spud in the Nacimiento Formation. Will drill an 8-3/4" hole to a TD of 130'. Run and cement surface casing with cement returns to surface. WOC 12 hours. Test casing to 2000 psi for 30 minutes. Drill a 6-1/4" hole to TD of 1581' using fresh water mud. No abnormal pressures or poisonous gases are anticipated. Adequate weight material will be on location to control flows from the Farmington sands. Run logs at TD. Run and cement production casing with cement returns to surface. WOC 12 hrs. Move out drilling rig and move in completion unit. Pressure test to 2500 psi for 30 minutes prior to perforating. Run cased hole correlation logs. Perforate Pictured Cliffs and stimulate using a fresh water based gel or foam system.

RECEIVED
DEC 23 1993
OIL CON. DIV.
DIST. 3

Surface ownership is Fee.

24. SIGNED: <u>JRER Lowmy</u>	TITLE: <u>Operations Superintendent</u>	DATE: <u>11/29/93</u>
-------------------------------	---	-----------------------

(This space for Federal or State office use)

PERMIT NO. _____	APPROVAL DATE _____
APPROVED BY <u>elk</u>	TITLE _____
CONDITIONS OF APPROVAL, IF ANY:	
<p style="text-align: right;">APPROVED AS AMENDED DEC 21 1993 DISTRICT MANAGER</p>	

Submit to Appropriate
District Office
State Lease - 4 copies
Fee Lease - 3 copies

State of New Mexico
Energy, Minerals and Natural Resources Department

Form C-102
Revised 1-1-89

OIL CONSERVATION DIVISION

DISTRICT I
P.O. Box 1980, Hobbs, NM 88240

P.O. Box 2088

Santa Fe, New Mexico 87504-2088

DISTRICT II
P.O. Drawer DD, Artesia, NM 88210

DISTRICT III
1000 Rio Brazos Rd., Aztec, NM 87410

WELL LOCATION AND ACREAGE DEDICATION PLAT

All Distances must be from the outer boundaries of the section

Operator BHP PETROLEUM (AMERICAS) INC.			Lease GALLEGOS CANYON UNIT		Well No. 536 (Alt. 1)
Unit Letter A	Section 13	Township 29 N	Range 13 W	County San Juan	
Actual Footage Location of Well: 790 feet from the North line and 1095 feet from the East line					
Ground level Elev. 5482	Producing Formation PICTURED CLIFF		Pool WEST KUTZ PICTURED CLIFF	Dedicated Acreage: 160 Acres	
<p>1. Outline the acreage dedicated to the subject well by colored pencil or hatchure marks on the plat below.</p> <p>2. If more than one lease is dedicated to the well, outline each and identify the ownership thereof (both as to working interest and royalty).</p> <p>3. If more than one lease of different ownership is dedicated to the well, have the interest of all owners been consolidated by communitization, unitization, force-pooling, etc.? <input type="checkbox"/> Yes <input type="checkbox"/> No If answer is "yes" type of consolidation _____</p> <p>If answer is "no" list the owners and tract descriptions which have actually been consolidated. (Use reverse side of this form if necessary.) _____</p> <p>No allowable will be assigned to the well until all interests have been consolidated (by communitization, unitization, forced-pooling, or otherwise) or until a non-standard unit, eliminating such interest, has been approved by the Division.</p>					

0 330 660 990 1320 1650 1980 2310 2640 2000 1500 1000 500 0

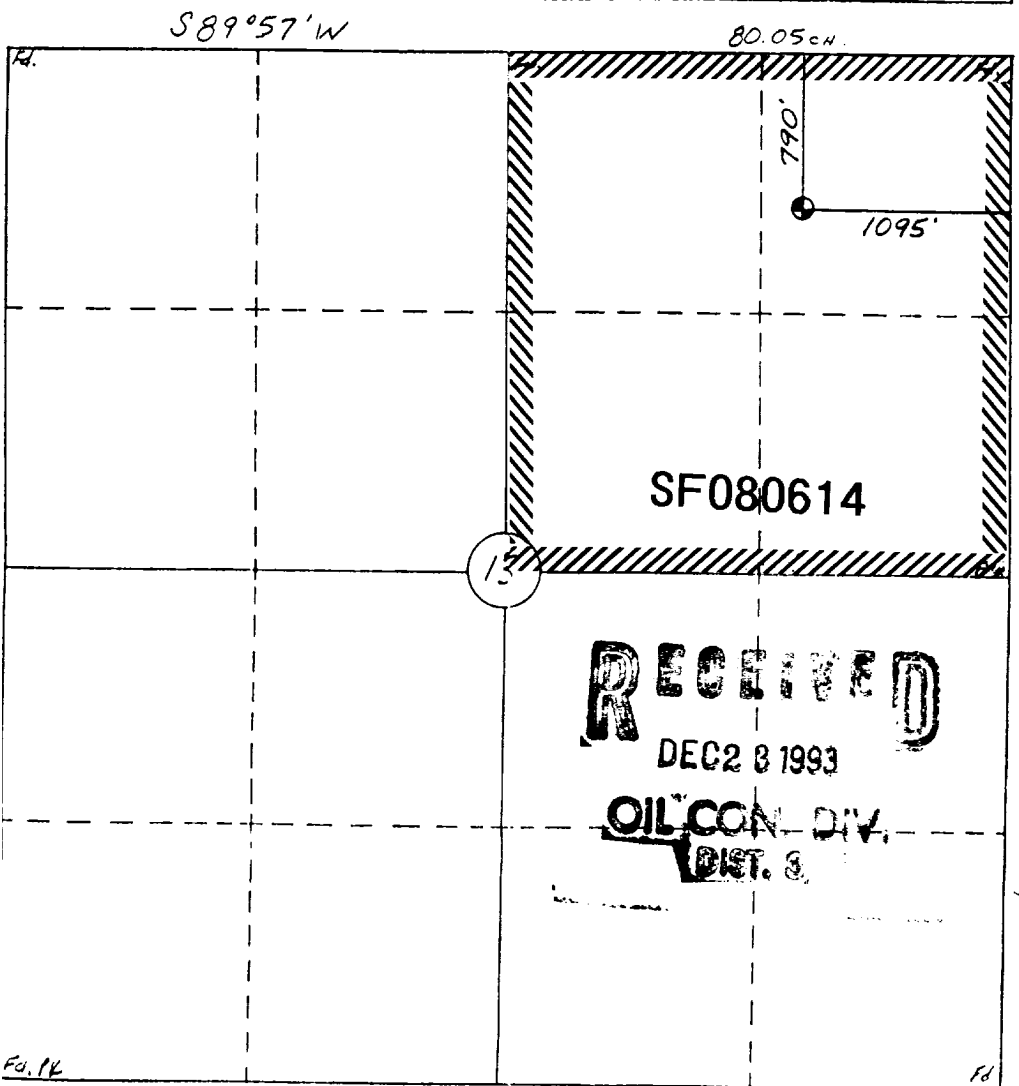

OPERATOR CERTIFICATION

I hereby certify that the information contained herein is true and complete to the best of my knowledge and belief.

Signature

Printed Name

FRED LOWERY

Position

OPERATION SUPT.

Company

BHP PETROLEUM

Date

11-4-93

SURVEYOR CERTIFICATION

I hereby certify that the well location shown on this plat was plotted from field notes of actual surveys made by me or under my supervision, and that the same is true and correct to the best of my knowledge and belief.

18 Oct., 1993

Date Surveyed

William F. Mahnke II

Signature of Seal of Professional Surveyor

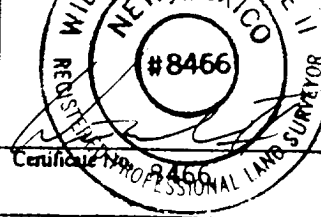

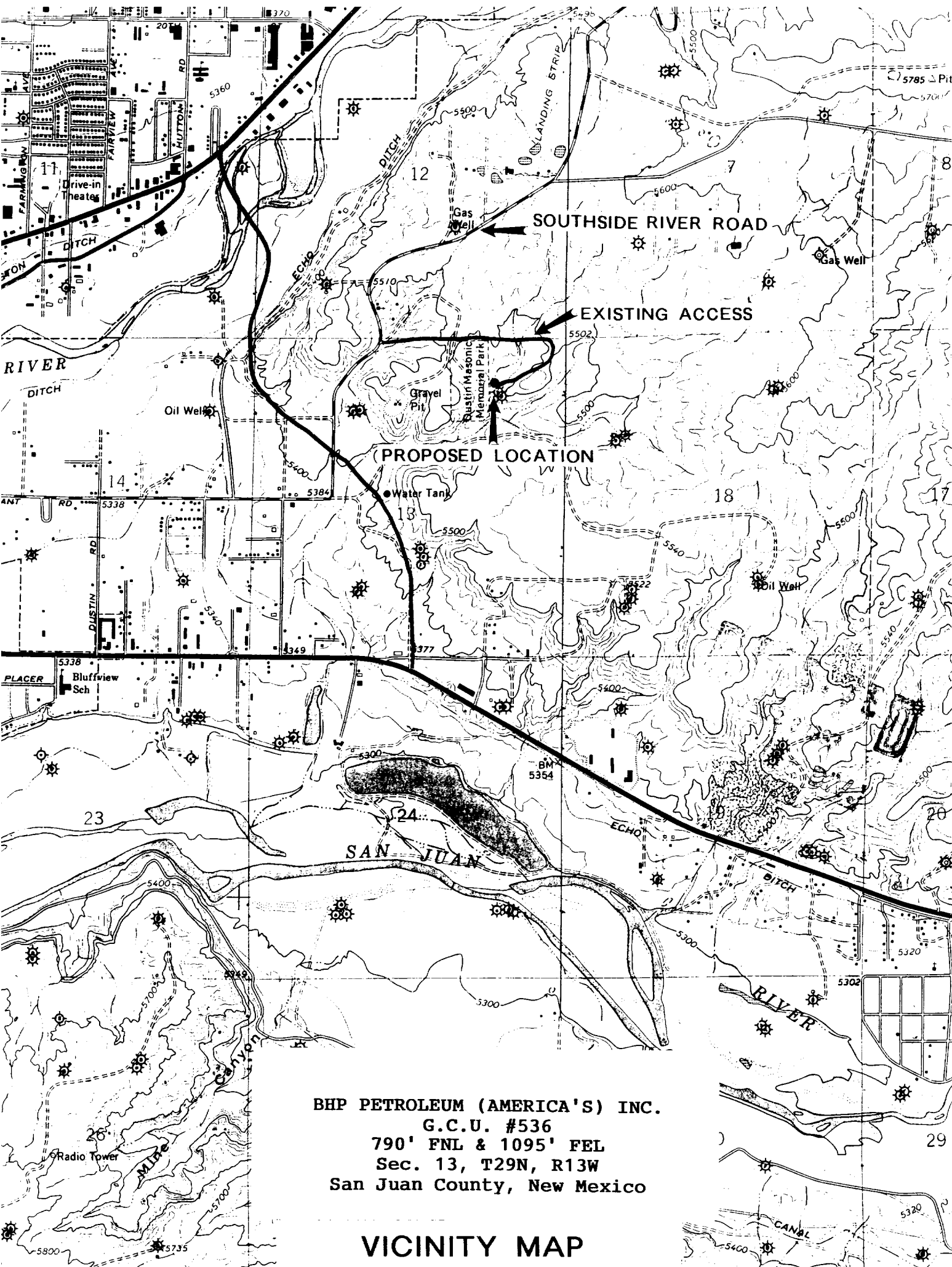

BHP PETROLEUM (AMERICA'S) INC.
G.C.U. #536
790' FNL & 1095' FEL
Sec. 13, T29N, R13W
San Juan County, New Mexico

VICINITY MAP