

UNITED STATES  
DEPARTMENT OF THE INTERIOR  
BUREAU OF LAND MANAGEMENT

APPLICATION FOR PERMIT TO DRILL OR DEEPEN

1a. TYPE OF WORK  
DRILL ☒ DEEPEN ☐

b. TYPE OF WELL  
OIL WELL ☒ GAS WELL ☐ OTHER ☐ SINGLE ZONE ☒ MULTIPLE ZONE ☐

2. NAME OF OPERATOR  
SIRGO BROTHERS ENERGY CORP., AS AGENT  
FOR MOUNTAIN STATES PETROLEUM CORP. 15346

3. ADDRESS AND TELEPHONE NO.  
P. O. BOX 3531, MIDLAND, TX 79702 (915) 685-0878

4. LOCATION OF WELL (Report location clearly and in accordance with any State requirements.)  
At surface 1761' FNL & 1741' FEL Unit G  
At proposed prod. zone Sec. 28, T29N, R14W, NMPM  
Same

14. DISTANCE IN MILES AND DIRECTION FROM NEAREST TOWN OR POST OFFICE\*  
5 MILES SOUTHWEST OF FARMINGTON

15. DISTANCE FROM PROPOSED\*  
LOCATION TO NEAREST 1034' from unit  
PROPERTY OR LEASE LINE, FT. boundary  
(Also to nearest drlg. unit line, if any)

16. NO. OF ACRES IN LEASE  
1440

17. NO. OF ACRES ASSIGNED  
TO THIS WELL  
14/80

18. DISTANCE FROM PROPOSED LOCATION\*  
TO NEAREST WELL, DRILLING, COMPLETED, 1637' from  
OR APPLIED FOR, ON THIS LEASE, FT. Well #36

19. PROPOSED DEPTH  
5330'

20. ROTARY OR CABLE TOOLS  
Rotary

21. ELEVATIONS (Show whether DF, RT, GR, etc.)  
5606' GR This action is subject to technical and  
procedural review pursuant to 43 CFR 3155.3  
and appeal pursuant to 43 CFR 3155.4

22. APPROX. DATE WORK WILL START\*  
March 20, 1994

5. LEASE DESIGNATION AND SERIAL NO.  
14-20-603-2168A

6. IF INDIAN, ALLOTTEE OR TRIBE NAME  
NAVAJO NATION

7. UNIT AGREEMENT NAME  
N.W. CHA CHA UNIT

8. FARM OR LEASE NAME, WELL NO.  
N.W. CHA CHA UNIT #49 8095

9. API WELL NO.  
30-045-29126

10. FIELD AND POOL, OR WILDCAT  
CHA CHA (GALLUP) 11880

11. SEC., T., R., M., OR BLE.  
AND SURVEY OR AREA  
G Sec. 28, T29N,  
R14W, NMPM

12. COUNTY OR PARISH  
SAN JUAN

13. STATE  
NM

SIZE OF HOLE	GRADE, SIZE OF CASING	WEIGHT PER FOOT	SETTING DEPTH	QUANTITY OF CEMENT
12-1/4"	J-55, 8-5/8"	24#	210'	165 sacks
7-7/8"	J-55, 5-1/2"	15.5#	5300'	860 sacks

1. Circulate cement to surface on 8-5/8" surface pipe.
2. Will two stage 5-1/2" casing to circulate cement back to surface pipe.
3. BOP Diagram attached.

RECEIVED  
MAY 12 1994

RECEIVED  
MAY 19 1994

OIL CON. DIV.  
DIST. 3

OIL CON. DIV.  
DIST. 3

IN ABOVE SPACE DESCRIBE PROPOSED PROGRAM. If proposal is to deepen, give data on present productive zone and proposed new productive zone. If proposal is to drill or deepen directionally, give pertinent data on sub-surface locations and measured and true vertical depths. Give blowout prevention program, if any.

SIGNED M. A. Sirgo, III TITLE President DATE Feb. 17, 1994  
(This space for Federal or State office use)

PERMIT NO. \_\_\_\_\_ APPROVAL DATE \_\_\_\_\_

Application approval does not warrant or certify that the applicant holds legal or equitable title to those rights in the subject lease which would entitle the applicant to conduct operations thereon.

CONDITIONS OF APPROVAL, IF ANY:

APPROVED BY 156-3392 TITLE NMOCD DATE MAY 09 1994

\*See Instructions On Reverse Side

DISTRICT MANAGER

State of New Mexico  
Energy, Minerals and Natural Resources Department

Submit to Appropriate  
District Office  
State Lease - 4 copies  
Fee Lease - 3 copies

AMENDED

OIL CONSERVATION DIVISION

P.O. Box 2088  
Santa Fe, New Mexico 87504-2088

RECEIVED  
Form C-102  
Revised 1-1-89

DISTRICT I  
P.O. Box 1980, Hobbs, N.M. 88240

DISTRICT II  
P.O. Drawer DD, Artesia, N.M. 88210

DISTRICT III  
1000 Rio Brazos Rd. Aztec, N.M. 87410

WELL LOCATION AND ACREAGE DEDICATION PLAT  
All Distances must be from the outer boundaries of the section

Operator <b>SIRGO OPERATING, INC.</b>			Lease <b>NW CHA CHA</b>		Well No. <b>49</b>
Unit Letter <b>G</b>	Section <b>28</b>	Township <b>29 NORTH</b>	Range <b>14 WEST</b>	County <b>NMPM SAN JUAN</b>	
Actual Footage Location of Well: <b>1761</b> feet from the <b>NORTH</b> line and <b>1741</b> feet from the <b>EAST</b> line					
Ground level Elev. <b>5606</b>	Producing Formation <b>Gallup</b>		Pool <b>Cha Cha Gallup</b>	Dedicated Acreage: <b>80 Acres</b>	
<p>1. Outline the acreage dedicated to the subject well by colored pencil or hatchure mark on the plat below.</p> <p>2. If more than one lease is dedicated to the well, outline each and identify the ownership thereof (both as to working interest and royalty).</p> <p>3. If more than one lease of different ownership is dedicated to the well, have the interest of all owners been consolidated by communitization, unitization, force-pooling, etc.?</p> <p><input type="checkbox"/> Yes <input type="checkbox"/> No If answer is "yes" type of consolidation _____</p> <p>If answer is "no" list the owners and tract descriptions which have actually been consolidated. (Use reverse side of this form if necessary.) _____</p> <p>No allowable will be assigned to the well until all interests have been consolidated (by communitization, unitization, forced-pooling, or otherwise) or until a non-standard unit, eliminating such interest, has been approved by the Division.</p>					

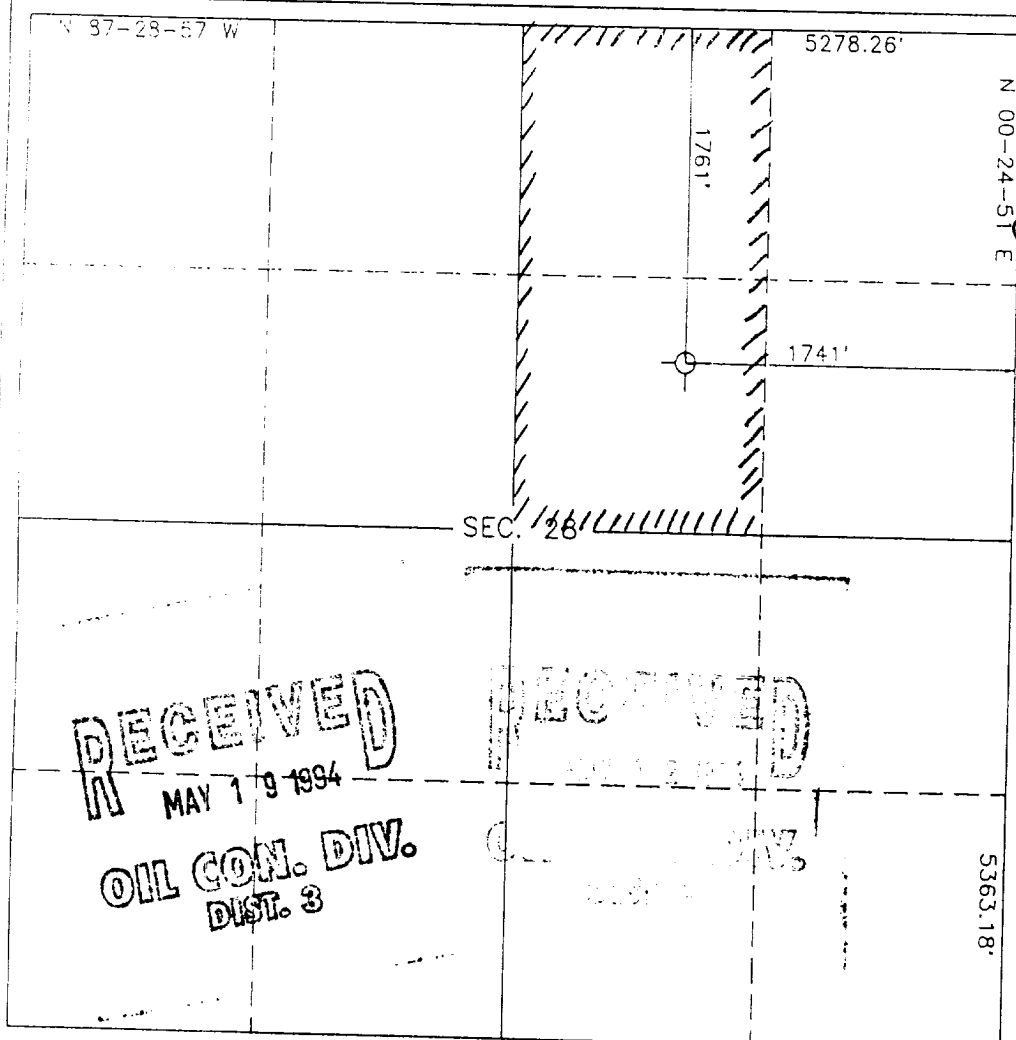

<b>OPERATOR SURVEYOR CERTIFICATION</b>	
I hereby certify that the information contained herein is true and complete to the best of my knowledge and belief.	
Signature <i>Brian M. Sirgo</i>	Printed Name <b>BRIAN M. SIRGO</b>
Position <b>VICE PRESIDENT</b>	
Company <b>SIRGO OPERATING INC</b>	
Date <b>MAY 18, 1994</b>	

<b>SURVEYOR CERTIFICATION</b>	
I hereby certify that the well location shown on this plat was plotted from field notes of actual surveys made by me or under my supervision, and that the same is true and correct to the best of my knowledge and belief.	
Date Surveyed <b>JANUARY 20, 1994</b>	Signature & Seal of Professional Surveyor <i>Roy A. Rush</i>
Certificate No. <b>PROFESSIONAL LAND SURVEYOR 889</b>	

RECEIVED  
MAY 19 1994  
OIL CON. DIV.  
DIST. 3

RECEIVED  
MAY 19 1994  
OIL CON. DIV.  
DIST. 3

Attachment No. 3  
NW Cha Cha Unit Well No. 49

