

UNITED STATES
DEPARTMENT OF THE INTERIOR
BUREAU OF LAND MANAGEMENT

APPLICATION FOR PERMIT TO DRILL OR DEEPEN

1a. TYPE OF WORK
DRILL ☒ DEEPEN ☐

b. TYPE OF WELL
OIL WELL ☒ GAS WELL ☐ OTHER ☐ SINGLE ZONE ☒ MULTIPLE ZONE ☐

2. NAME OF OPERATOR
SIRGO BROTHERS ENERGY CORP. AS AGENT
FOR MOUNTAIN STATES PETROLEUM CORP. 15346

3. ADDRESS AND TELEPHONE NO.
P. O. BOX 3531, MIDLAND, TX 79702 (915) 685-0878

4. LOCATION OF WELL (Report location clearly and in accordance with any State requirements.)
At surface 2431' FSL & 1889' FWL Unit K
Sec. 22, T29N, R14W, NMPM
At proposed prod. zone
Same

14. DISTANCE IN MILES AND DIRECTION FROM NEAREST TOWN OR POST OFFICE*
5 MILES SOUTHWEST OF FARMINGTON

15. DISTANCE FROM PROPOSED* LOCATION TO NEAREST PROPERTY OR LEASE LINE, FT.
Also to nearest drig. unit line, if any.
4223' from unit boundary

16. NO. OF ACRES IN LEASE
1632

17. NO. OF ACRES ASSIGNED TO THIS WELL
N/80

18. DISTANCE FROM PROPOSED LOCATION* TO NEAREST WELL, DRILLING, COMPLETED, OR APPLIED FOR, ON THIS LEASE, FT.
1810' from Well #16

19. PROPOSED DEPTH
5330'

20. ROTARY OR CABLE TOOLS
Rotary

21. ELEVATIONS (Show whether DF, RT, GR, etc.)
5574' GR

22. APPROX. DATE WORK WILL START*
March 20, 1994

23. PROPOSED CASING AND CEMENTING PROGRAM

5. LEASE DESIGNATION AND SERIAL NO.
14-20-603-2199

6. IF INDIAN, ALLOTTEE OR TRIBE NAME
NAVAJO NATION

7. UNIT AGREEMENT NAME
N.W. CHA CHA UNIT

8. FARM OR LEASE NAME, WELL NO.
N.W. CHA CHA UNIT #25

9. API WELL NO.
30-045-29163

10. FIELD AND POOL, OR WILDCAT
CHA CHA (GALLUP) 11880

11. SEC., T., R., M., OR BLK. AND SURVEY OR AREA
K Sec. 22, T29N, R14W, NMPM

12. COUNTY OR PARISH
SAN JUAN

13. STATE
NM

SIZE OF HOLE	GRADE, SIZE OF CASING	WEIGHT PER FOOT	SETTING DEPTH	GENERAL QUANTITY OF CEMENT
12-1/4"	J-55, 8-5/8"	24#	210'	165 sacks
7-7/8"	J-55, 5-1/2"	15.5#	5330'	860 sacks

1. Circulate cement to surface on 8-5/8" surface pipe.
2. Will two stage 5-1/2" casing to circulate cement back to surface pipe.
3. BOP Diagram attached.

RECEIVED
AUG 22 1994
OIL CON. DIV.
DIST. 3

RECEIVED
AUG 29 1994
OIL CON. DIV.
DIST. 3
SANTO - 3 AM 10-03
RECEIVED
BLM

IN ABOVE SPACE DESCRIBE PROPOSED PROGRAM: If proposal is to deepen, give data on present productive zone and proposed new productive zone. If proposal is to drill or deepen directionally, give pertinent data on subsurface locations and measured and true vertical depths. Give blowout preventer program, if any.

SIGNED M. A. Sirgo, III TITLE President DATE Feb. 17, 1994
(This space for Federal or State office use)

PERMIT NO. _____ APPROVAL DATE _____

Application approval does not warrant or certify that the applicant holds legal or equitable title to those rights in the subject lease which would entitle the applicant to conduct operations thereon.

CONDITIONS OF APPROVAL, IF ANY:
15L-3372-2 HMOCD

APPROVED BY _____ TITLE _____ DATE Aug 18 1994
DISTRICT MANAGER

*See Instructions On Reverse Side

State of New Mexico
Energy, Minerals and Natural Resources Department

Submit to Appropriate
District Office
State Lease - 4 copies
Fee Lease - 3 copies

AMENDED

OIL CONSERVATION DIVISION

P.O. Box 2088
Santa Fe, New Mexico 87504-2088

RECEIVED
BLM

Form C-102
Revised 1-1-89

DISTRICT I

P.O. Box 1980, Hobbs, N.M. 88240

DISTRICT II

P.O. Drawer DD, Artesia, N.M. 88210

DISTRICT III

1000 Rio Bruzon Rd., Aztec, N.M. 87410

WELL LOCATION AND ACREAGE DEDICATION PLAT

All Distances must be from the outer boundaries of the section

SW 1/4 - 5 AM 9:37

OTD 7/1/94, NM

Operator SIRGO OPERATING, INC.		Lease NW CHA CHA		Well No. 25
Unit Letter K	Section 22	Township 29 NORTH	Range 14 WEST	County NMPM SAN JUAN
Actual Footage Location of Well: 2431 feet from the SOUTH line and 1889 feet from the WEST line				
Ground level Elev. 5574	Producing Formation Gallup	Pool Cha Cha Gallup	Dedicated Acreage: 80 Acres	

- Outline the acreage dedicated to the subject well by colored pencil or hatchure mark on the plat below.
- If more than one lease is dedicated to the well, outline each and identify the ownership thereof (both as to working interest and royalty).
- If more than one lease of different ownership is dedicated to the well, have the interest of all owners been consolidated by communitization, unitization, force-pooling, etc.?
☐ Yes ☐ No If answer is "yes" type of consolidation _____

If answer is "no" list the owners and tract descriptions which have actually been consolidated. (Use reverse side of this form if necessary.)

No allowable will be assigned to the well until all interests have been consolidated (by communitization, unitization, forced-pooling, or otherwise) or until a non-standard unit, eliminating such interest, has been approved by the Division.

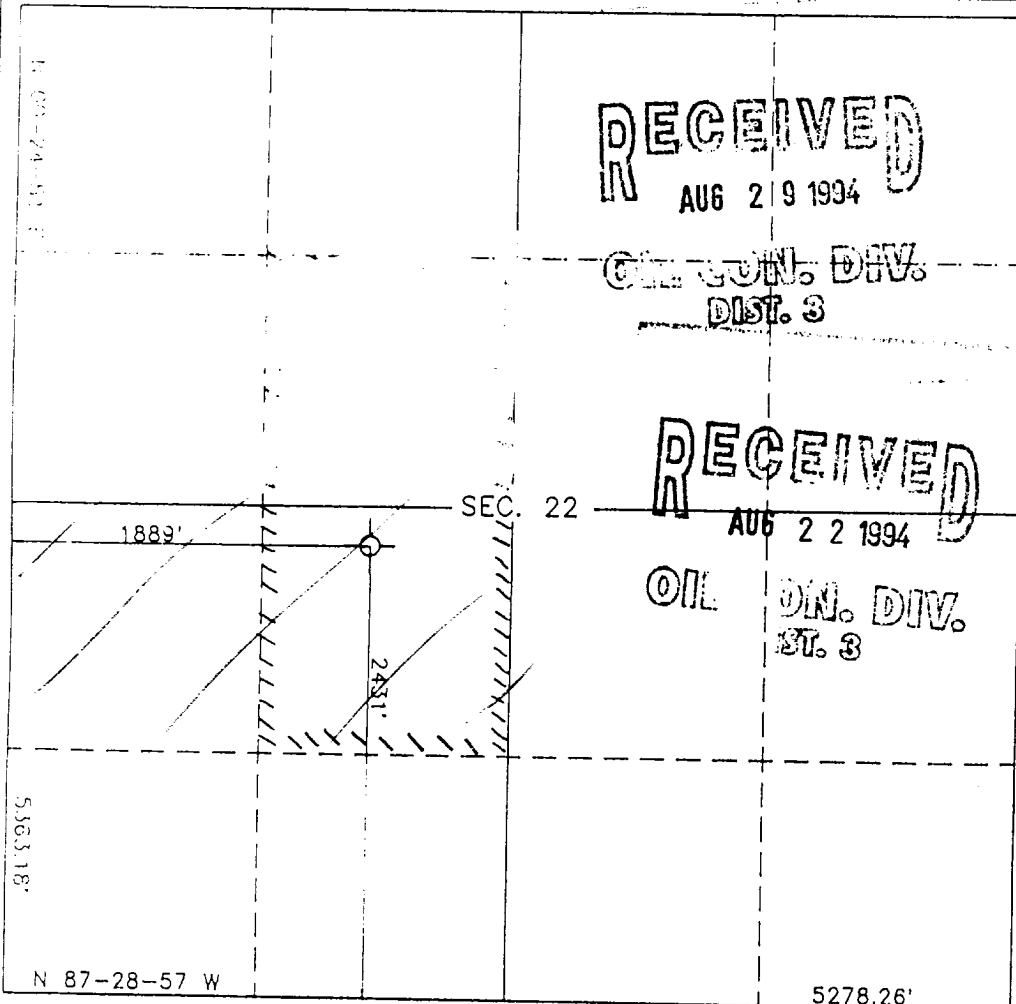

RECEIVED
AUG 2 9 1994

OIL CON. DIV.
DIST. 3

RECEIVED
AUG 2 2 1994

OIL CON. DIV.
DIST. 3

SURVEYOR CERTIFICATION

I hereby certify that the information contained herein is true and complete to the best of my knowledge and belief.

Signature

M.A. SIRGO III

Printed Name

PRESIDENT Agent for

Position

SIRGO BROSENERGY CORP

Company

8-24-94

Date

SURVEYOR CERTIFICATION

I hereby certify that the well location shown on this plat was plotted from field notes of actual surveys made by me or under my supervision, and that the same is true and correct to the best of my knowledge and belief.

Date Surveyed

JANUARY 21 1994

Signature & Seal of Professional Surveyor

ROY A. RUSH
8894

Certificate No.

PROFESSIONAL LAND SURVEYOR
8894

NMOCD

Attachment No. 3
NW Cha Cha Unit Well No. 25

