

UNITED STATES  
DEPARTMENT OF THE INTERIOR

BUREAU OF LAND MANAGEMENT

Form approved.  
Budget Bureau No. 1004-0136  
Expires: December 31, 1991

APPLICATION FOR PERMIT TO DRILL OR DEEPEN

1a. TYPE OF WORK

DRILL ☒

DEEPEN ☐

b. TYPE OF WELL

OIL WELL ☐

GAS WELL ☒

OTHER

SINGLE ZONE ☒

MULTIPLE ZONE ☐

2. NAME OF OPERATOR

Attention:

Amoco Production Company

Julie L. Acevedo

3. ADDRESS AND TELEPHONE NO.

P.O. Box 800, Denver, Colorado 80201

(303) 830-6003

4. LOCATION OF WELL (Report location clearly and in accordance with any State requirements.)

At surface

760 FNL

570 FEL

At proposed prod. zone

14. DISTANCE IN MILES AND DIRECTION FROM NEAREST TOWN OR POST OFFICE\*

39 miles from Aztec, N.M.

15. DISTANCE FROM PROPOSED\* LOCATION TO NEAREST PROPERTY OR LEASE LINE, FT. (Also to nearest drilg. unit line, if any)

16. NO. OF ACRES IN LEASE

1207.47

17. NO. OF ACRES ASSIGNED TO THIS WELL

320 E/2

18. DISTANCE FROM PROPOSED LOCATION\* TO NEAREST WELL, DRILLING, COMPLETED, OR APPLIED FOR, ON THIS LEASE, FT.

19. PROPOSED DEPTH

2950' TD

20. ROTARY OR CABLE TOOLS

Rotary

21. ELEVATIONS (Show whether DF, RT, GR., etc.)

6147' GR

22. APPROX. DATE WORK WILL START\*

23. PROPOSED CASING AND CEMENTING PROGRAM SUBJECT TO COMPLETION OF ATTACHED

SIZE OF HOLE	GRADE, SIZE OF CASING	WEIGHT PER FOOT	SETTING DEPTH	QUANTITY OF CEMENT
12 1/4"	9 5/8"	32#	250'	250sx CL B
8 3/4"	7"	23#	2639'	300sx Halliburton Lite

Notice of Staking submitted: 07/28/94 as the Florance Gas Com A #1R

T-30-N R--8-W

SEC 10: S/2SE/4 (AKA LOT 7(4.03), 8(32.79), SE/4SE/4)

SEC 15: SW/4 (AKA LOTS 9(39.13), 10(39.71), S/2S/W4)

SEC 17: NE/4

SEC 20: LOTS 1(38.40), 3(37.41), 4(37.16), 5(35.45), 6(35.18), 11(33.98), 12(34.23)

SEC 21: E/2

SEC 22: NE/4, W/2SE/4

RECEIVED  
NOV 29 1994

07 OCT 11 AM 10:24  
OIL CON. DIV.  
DIST. 3

IN ABOVE SPACE DESCRIBE PROPOSED PROGRAM: If proposal is to deepen, give data on present productive zone and proposed new productive zone. If proposal is to drill or deepen directionally, give pertinent data on subsurface locations and measured and true vertical depths. Give blowout preventer program, if any.

24.

SIGNED

TITLE Sr. Staff Assistant

DATE 07-14-1994

(This space for Federal or State office use)

PERMIT NO.

APPROVAL DATE

APPROVED  
AS AMENDED

Application approval does not warrant or certify that the applicant holds legal or equitable title to those rights in the subject lease which would entitle the applicant to produce oil or gas.

CONDITIONS OF APPROVAL, IF ANY:

APPROVED BY

TITLE

NOV 23 1994

DISTRICT MANAGER

See Instructions On Reverse Side

Title 18 U.S.C. Section 1001, makes it a crime for any person knowingly and willfully to make to any department or agency of the United States any false, fictitious or fraudulent statements or representations as to any matter within its jurisdiction.

District I  
PO Box 1980, Hobbs, NM 88241-1980  
District II  
PO Drawer DD, Artesia, NM 88211-0719  
District III  
1000 N. Hrazos Rd., Aztec, NM 87410  
District IV  
PO Box 2088, Santa Fe, NM 87504-2088

State of New Mexico  
Energy, Minerals & Natural Resources Department

Form C-102  
Revised February 21, 1994  
Instructions on back  
Submit to Appropriate District Office  
State Lease - 4 Copies  
Fee Lease - 3 Copies  
94 OCT 11 AM 10:24 ☐ AMENDED REPORT

OIL CONSERVATION DIVISION  
PO Box 2088  
Santa Fe, NM 87504-2088

WELL LOCATION AND ACREAGE DEDICATION PLAT

API Number <u>30-045-29,202</u>		Pool Code 71629	Pool Name Basin Fruitland Coal Gas
Property Code <u>531</u>	Property Name FLORANCE GAS COM A		Well Number # 1 R
OGRID No. 000778	Operator Name AMOCO PRODUCTION COMPANY		Elevation 6147

10 Surface Location

UL or lot no. A	Section 22	Township 30 N	Range 8 W	Lot Idn	Feet from the 760	North/South line NORTH	Feet from the 570	East/West line EAST	County SAN JUAN
--------------------	---------------	------------------	--------------	---------	----------------------	---------------------------	----------------------	------------------------	--------------------

11 Bottom Hole Location If Different From Surface

UL or lot no.	Section	Township	Range	Lot Idn	Feet from the	North/South line	Feet from the	East/West line	County
---------------	---------	----------	-------	---------	---------------	------------------	---------------	----------------	--------

12 Dedicated Acres 320	13 Joint or Infill	14 Consolidation Code	15 Order No.
---------------------------	--------------------	-----------------------	--------------

NO ALLOWABLE WILL BE ASSIGNED TO THIS COMPLETION UNTIL ALL INTERESTS HAVE BEEN CONSOLIDATED  
OR A NON-STANDARD UNIT HAS BEEN APPROVED BY THE DIVISION

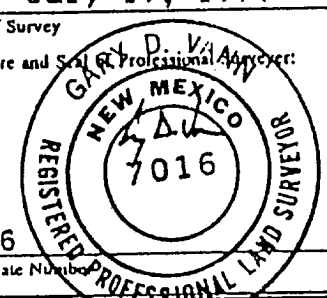
16									
<b>RECEIVED</b> NOV 29 1994 OIL CON. DIV. DIST. 3									
<b>17 OPERATOR CERTIFICATION</b> I hereby certify that the information contained herein is true and complete to the best of my knowledge and belief.  <u>Julie L. Acevedo</u> Signature <u>Julie L. Acevedo</u> Printed Name <u>Sr. Staff Assistant</u> Title <u>7/28/94</u> Date									
<b>18 SURVEYOR CERTIFICATION</b> I hereby certify that the well location shown on this plat was plotted from field notes of actual surveys made by me or under my supervision, and that the same is true and correct to the best of my belief.  <u>July 19, 1994</u> Date of Survey <u>GARY D. V. A.</u> Signature and Seal of Professional Surveyor:  <u>7016</u> Certificate Number									

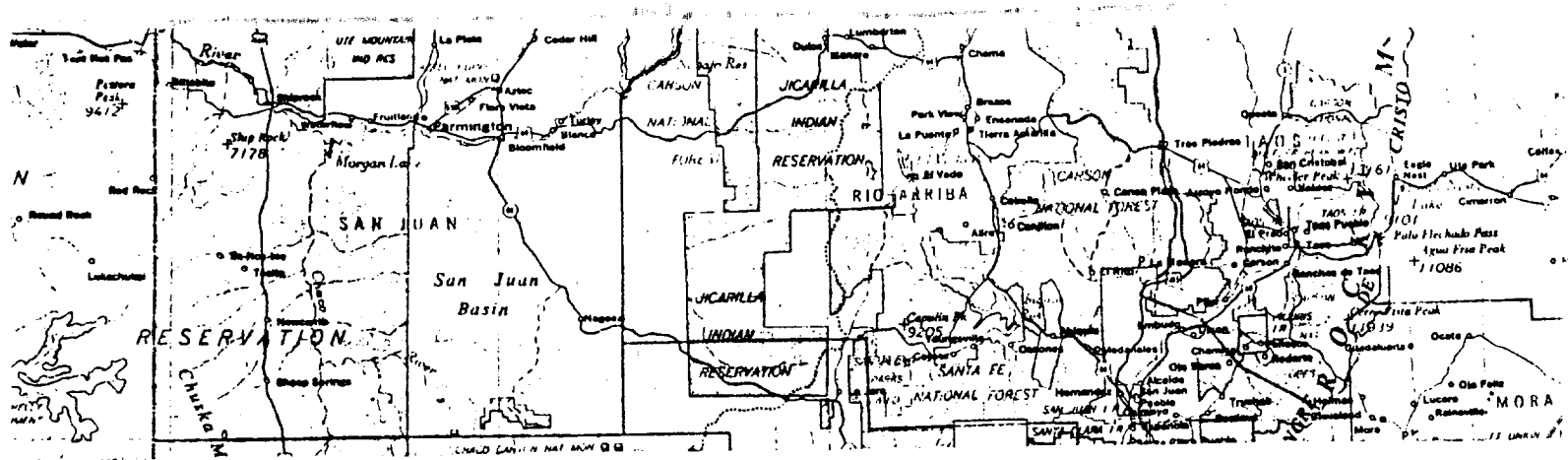

FLORANCE GAS COM A # 1 R  
 760' F/NL 570' F/EL  
 SEC. 22, T30N, R8W, NMPM  
 RAIL POINT: 182 miles from Montrose, Co.  
 MUD POINT: 39 miles from Aztec, N.M.  
 CEMENT POINT: 43 miles from Farmington, N.M.

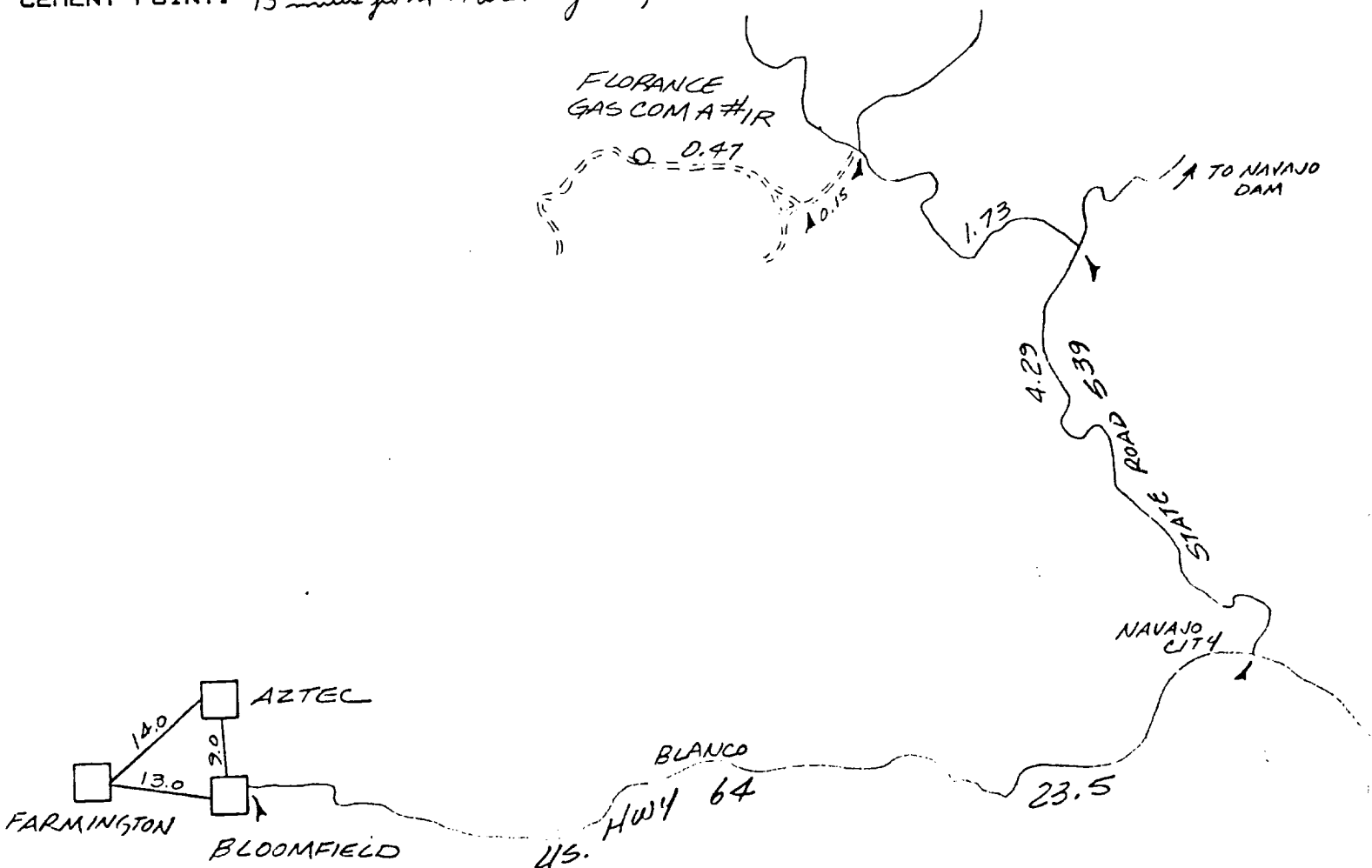



AMOCO PRODUCTION COMPANY  
FLORANCE GAS COM A # 1 R  
760' F/NL 570' F/EL  
SEC. 22, T30N, R8W, NMPM  
SAN JUAN COUNTY, NEW MEXICO