

Submit to Appropriate
District Office
State Lease - 6 copies
Fee Lease - 5 copies

State of New Mexico
Energy, Minerals and Natural Resources Department

Form C-101
Revised 1-1-89

OIL CONSERVATION DIVISION

DISTRICT I
P.O. Box 1980, Hobbs, NM 88240

P.O. Box 2088

Santa Fe, New Mexico 87504-2088

DISTRICT II
P.O. Drawer DD, Artesia, NM 88210

DISTRICT III
1000 Rio Brazos Rd., Aztec, NM 87410

API NO. (assigned by OCD on New Wells)

3-045-29225

5. Indicate Type of Lease

STATE ☐

FEE ☒

6. State Oil & Gas Lease No.

APPLICATION FOR PERMIT TO DRILL, DEEPEN, OR PLUG BACK

1a. Type of Work:

DRILL ☒

RE-ENTER ☐

DEEPEN ☐

PLUG BACK ☐

b. Type of Well:

OIL
WELL ☐

GAS
WELL ☒

OTHER

SINGLE
ZONE ☒

MULTIPLE
ZONE ☐

7. Lease Name or Unit Agreement Name

Woods Gas Com B

2. Name of Operator

AMOCO PRODUCTION COMPANY 778

Attention:

Julie L. Acevedo

8. Well No.

#1

3. Address of Operator

P.O. Box 800 Denver Colorado 80201

9. Pool name or Wildcat

158.52

4. Well Location

Unit Letter M : 1520 Feet From The South Line and 1150 Feet From The West Line

Section 7 Township 29N Range 12W NMPM SAN JUAN County

10. Proposed Depth

1782' TD

11. Formation

Pictured Cliffs

12. Rotary or C.T.

Rotary

13. Elevations (Show whether DF, RT, GR, etc.)

5476' GR

14. Kind & Status Plug. Bond

15. Drilling Contractor

Aztec

16. Approx. Date Work will start

4/30/95

17.

PROPOSED CASING AND CEMENT PROGRAM

SIZE OF HOLE	SIZE OF CASING	WEIGHT PER FOOT	SETTING DEPTH	SACKS OF CEMENT	EST. TOP
8.75"	7"	23#	250'	100 sx CI B	Surface
6.25"	3.5"	9.2#	1782'	257 sx CI B	Surface
option: 8 3/4"					

RECEIVED
MAR 28 1995

OIL CON. DIV.
DIST. 3

IN ABOVE SPACE DESCRIBE PROPOSED PROGRAM: IF PROPOSAL IS TO DEEPEN OR PLUG BACK, GIVE DATA ON PRESENT PRODUCTIVE ZONE AND PROPOSED NEW PRODUCTIVE ZONE. GIVE BLOWOUT PREVENTER PROGRAM, IF ANY.

I hereby certify that the information above is true and complete to the best of my knowledge and belief.

SIGNATURE

Julie L. Acevedo

TITLE

Sr. Staff Assistant

DATE

03-24-1995

TYPE OR PRINT NAME

Julie L. Acevedo

TELEPHONE NO. (303) 830-6003

(This space for State Use)

APPROVED BY

Emile Busch

TITLE

DEPUTY OIL & GAS INSPECTOR, DIST. #3

DATE

3-29-95
MAR 29 1995

CONDITIONS OF APPROVAL, IF ANY:

District I
PO Box 1980, Hobbs, NM 88241-1980
District II
PO Drawer DD, Artesia, NM 88211-0719
District III
1000 Rio Brazos Rd., Aztec, NM 87410
District IV
PO Box 2088, Santa Fe, NM 87504-2088

State of New Mexico
Energy, Minerals & Natural Resources Department

OIL CONSERVATION DIVISION
PO Box 2088
Santa Fe, NM 87504-2088

Form C-102
Revised February 21, 1994
Instructions on back
Submit to Appropriate District Office
State Lease - 4 Copies
Fee Lease - 3 Copies

☐ AMENDED REPORT

WELL LOCATION AND ACREAGE DEDICATION PLAT

1 API Number 30-045-2225	2 Pool Code 77200	3 Pool Name Ludlow Katy Petroleum Wells EXT
4 Property Code 16902	5 Property Name Woods Gas Com B	6 Well Number #1
7 OGRID No. 00778	8 Operator Name AMOCO PRODUCTION COMPANY	9 Elevation 5569

10 Surface Location

UL or lot no. M Lot 3	Section 7	Township 29 N	Range 12 W	Lot Idn	Feet from the 1520	North/South line SOUTH	Feet from the 1150	East/West line WEST	County SAN JUAN
-----------------------------	--------------	------------------	---------------	---------	-----------------------	---------------------------	-----------------------	------------------------	--------------------

11 Bottom Hole Location If Different From Surface

UL or lot no.	Section	Township	Range	Lot Idn	Feet from the	North/South line	Feet from the	East/West line	County
---------------	---------	----------	-------	---------	---------------	------------------	---------------	----------------	--------

12 Dedicated Acres 158.52	13 Joint or Infill	14 Consolidation Code	15 Order No.
------------------------------	--------------------	-----------------------	--------------

NO ALLOWABLE WILL BE ASSIGNED TO THIS COMPLETION UNTIL ALL INTERESTS HAVE BEEN CONSOLIDATED
OR A NON-STANDARD UNIT HAS BEEN APPROVED BY THE DIVISION

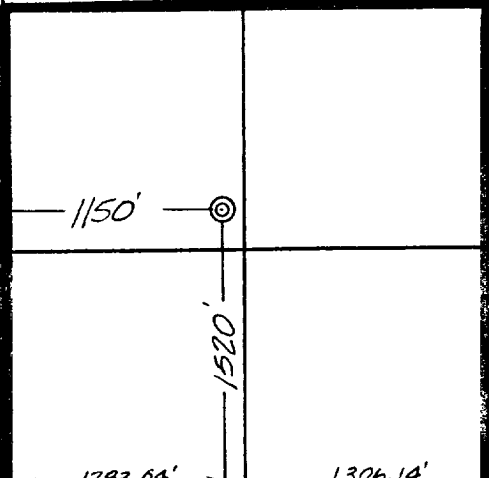
16 	7	17 OPERATOR CERTIFICATION I hereby certify that the information contained herein is true and complete to the best of my knowledge and belief Signature Julie L. Acevedo Printed Name Sr. Staff Assistant Title 3/24/95 Date

BLM RECORD

**AMOCO PRODUCTION COMPANY
DRILLING PROGRAM**

File No.: woodgcb1.xlw
Date: 1/26/95

Lease: Woods G.C. B Well No. #1
County: San Juan County, New Mexico Surface Location: 1520' FSL & 1150' FWL of Section 7, T29N, R12W
Former name: Field:

OBJECTIVE: Develop PC				
METHOD OF DRILLING		APPROXIMATE DEPTHS OF GEOLOGICAL MARKER		
TYPE OF TOOLS	DEPTH OF DRILLING	GL-----Estimated KB	5569	5582
Rotary	Ground Level - TD	Marker	Depth (ft.)	SS Elev. (ft.)
LOGGING PROGRAM		Ojo Alamo		
TYPE	DEPTH	PC **	1,515	4,067
Cased Hole Neutron-GR	No open hole logs required. To be logged during completion.	Lewis Shale	1,732	3,850
		Cliff House		
		Menefee Shale		
		Point Lookout		
		Mancos		
		Gallup		
		Greenhorn		
REMARKS:		Dakota		
		TOTAL DEPTH	1,782	3,800
* Possible pay ** Probable completion Ojo Alamo is possible usable water				
SPECIAL TESTS		DRILL CUTTING SAMPLES		DRILLING TIME
TYPE	DEPTH INTERVAL, ETC	FREQUENCY	DEPTH	FREQUENCY
None				Geolograph
REMARKS:		Remarks:		
		Mud Logging Program: None		
		Coring Program: None		

MUD PROGRAM:

Approx. Interval	Type Mud	Weight, #/g	Vis, sec/qt	W/L, cc's/30 min.
0 - 250'	Spud			
Production	LSND	8.6 - 9.5	Sufficient to clean hole	

REMARKS:

CASING PROGRAM:

Casing String	Estimated Depth	Casing Size	Hole Size	Landing Point, Cement, Etc
Conductor				
Surface	250	7"	8.75"	1
Intermediate				
Production	1,782	3.5"	6.25"	1, 2, 3

Remarks:

- 1 - Circulate cement to surface.
- 2 - Production cement to be designed by Denver drilling staff.
- 3 - Casing set 50' into the Lewis Shale.

GENERAL REMARKS:

Business Unit Engineering staff to design completion program.

Form 46 Reviewed by:

Logging program reviewed by:

PREPARED BY:	APPROVED:	APPROVED:
Grotke/Dvitz		
Form 46 7-84bw	For Production Dept	For Exploration Dept.
3/23/95 17:40		

CEMENTING PROGRAM

blp

Woods Gas Com 'B' #1

Well Name: **Woods Gas Com 'B' #1**
Location: 1520' FSL X 1150' FWL, Sec 07, T29N, R12W
County: San Juan
State: New Mexico

Field:
API No.
Well Flac
Formation: Pictured Cliff
KB Elev. (est.) 5582 ft.
GL Elev. (est.) 5569 ft.

Casing Program:

Casing String	Est. Depth (ft.)	Hole Size (in.)	Casing Size (in.)	Casing Weight (lb/ft.)	Casing Grade	Thread	TOC (ft.)
Surface	250	8.75	7.000	23	J-55	8R, LT&C	Surface
Production	1,782	6.25	3.500	9.2	H-40	8R, EUE	Surface

Casing Properties:

(No Safety Factor Included)

Casing String	Casing Weight (lb/ft.)	Burst (psi.)	Collapse (psi.)	Joint St. (1000 lbs.)	Capacity (bbl/ft.)	Torque(ft. lbs.) Opt/Min/Max	Drift (in.)
Surface	23	4360	3270	313	0.0393		6.241
Production	9.2	5080	5380	79	0.0087		2.867

Mud Program:

Apx. Interval (ft.)	Mud Type	Mud Weight (lb/gal)	Recommended Mud Properties Prior Cementing:	
			PV	< 20
			YP	< 10
			Fluid Loss	< 15
0 - SCP	Spud	8.6-8.8		
SCP - TD	LSND	8.6-9.5		

Cementing Program:

	Surface	Production
Excess %, Bit	75	30
Excess %, Caliper	NA	30
BHST (est. deg. F)	55	100
Pipe Movement	NA	NA
Rate, Max. (bpm)	1 truck	4
Rate, Recommended (bpm)	6	4
Pressure, Max. (psi)	200	2000
Shoe Joint	40'	40
Batch Mix	NA	NA
Circulating prior cmtng (hr.)	0.5	1
Time Between Stages,(hr.)	NA	NA
Special Instructions	1,6,7	2,4,6,8

- 1 Do not wash pumps and lines
- 2 Wash pumps and lines.
- 3 Do not reverse out
- 4 Run Blend Test on Cement
- 5 Record Rate , Pressure, and Density on 3.5" disk
- 6 Confirm densometer with pressurized mud scales
- 7 1" cement to surface if cement is not circulated.
- 8 If cement is not circulated to the surface, run temp. survey 10-12 hr. after landing plug.

Notes:

- *** Displace top plug on the production casing job with 0.2% Clay Fix II or 2% KCl water.
- *** Do not wash up on top of plug. Wash pumps and lines. We want to do rig less completions.

CEMENTING PROGRAM

Woods Gas Com 'B' #1

Surface:

Preflush	20 bbl.	Fresh Water + dye marker	
Slurry 1 TOC@Surface	100 sk	Standard Cement + 2% CaCl ₂ + 1/4 lb/sk floccle	95 cu. ft.

Slurry Properties:	density (lb/gal)	yield (ft ³ /sk)	water (gal/sk)
slurry 1	15.60	1.18	5.20

Casing Equipment: (Halliburton) 7", 8R, ST&C

- 1 Type M Guide Shoe
- 1 Insert Float w Auto Fill
- 1 Weld A
- 3 S-4 Centralizer
- 1 Top Wooden Plug

CEMENTING PROGRAM

blp

Woods Gas Com 'B' #1

Production:

Preflush	20 bbl. 10 bbl.	Mud Flush Fresh Water	
Lead Cement Slurry 1		50/50 Std. Cmt/Poz A + 2% gel (total) + 5 lb/sk gilsonite + 0.4% Halad-344 + 1/4 lb/sk flocele	340 cu. ft.

Slurry Properties:	density (lb/gal)	yield (ft ³ /sk)	water (gal/sk)
slurry 1	13.50	1.32	5.59

Note: The job should be pumped at 4 bpm max rate. Do not exceed 2 bpm on displacement.
Slow to 2 bpm for the displacement. Displace with 2% KCl or 0.2% Clay Fix II water.
This is to be a rigless completion.

Casing Equipment: Halliburton 3 1/2", 8R, EUE, (no need to cut long pin)

- 1 Super Seal II Float Shoe
- 10 S-4 Fluidmaster Centralizer
- 1 Lock Clamp
- 1 Weld A
- 1 Omega Latch Down Plug and Baffle

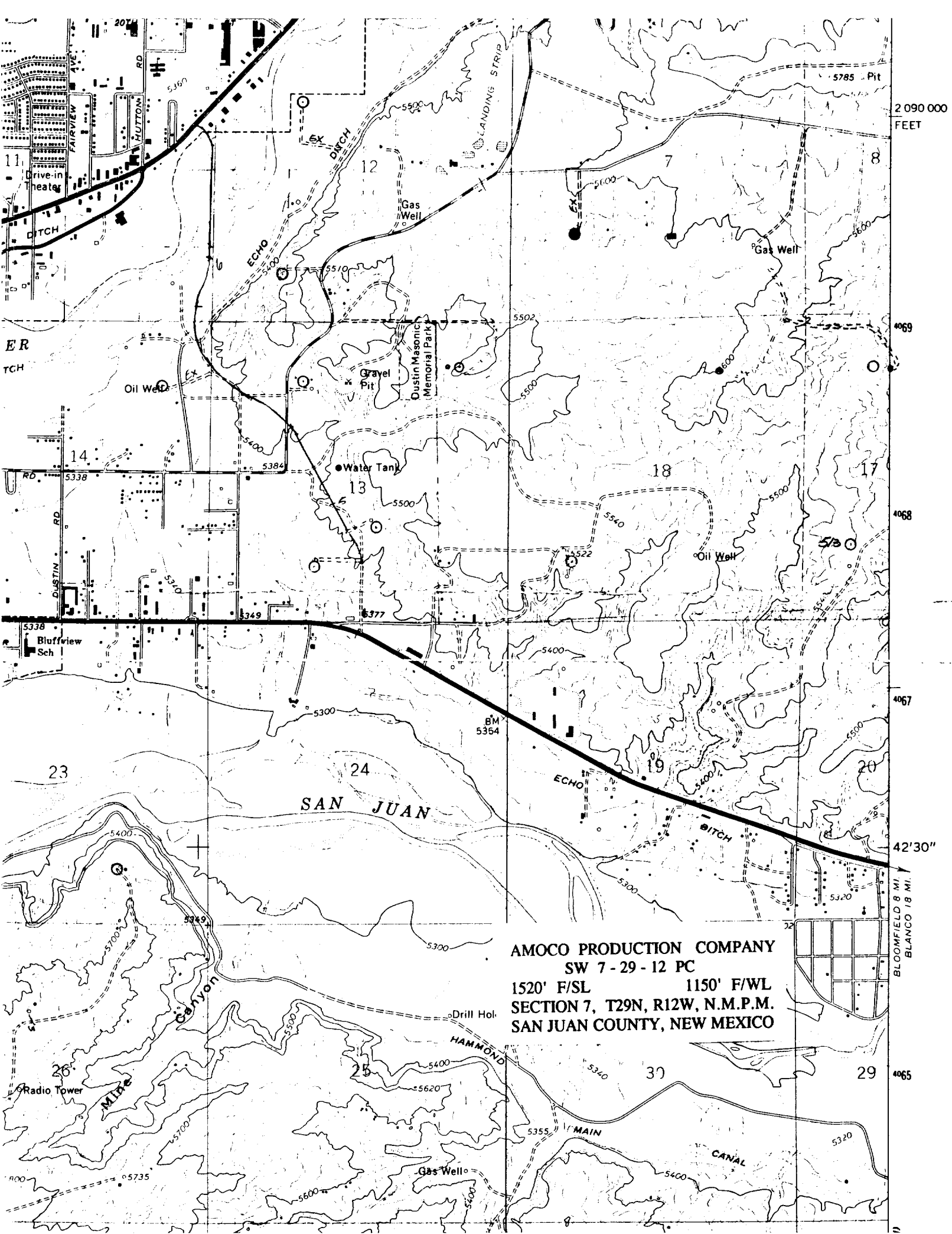

AMOCO PRODUCTION COMPANY
SW 7-29-12 PC
1520' F/SL 1150' F/WL
SECTION 7, T29N, R12W, N.M.P.M.
SAN JUAN COUNTY, NEW MEXICO