

Submit 3 Copies
to Appropriate
District Office

State of New Mexico
Energy, Minerals and Natural Resources Department

Form C-103
Revised 1-1-89

DISTRICT I
P.O. Box 1980, Hobbs, NM 88240

OIL CONSERVATION DIVISION

P.O. Box 2088

DISTRICT II
P.O. Drawer DD, Artesia, NM 88210

Santa Fe, New Mexico 87504-2088

DISTRICT III
1000 Rio Brazos Rd., Aztec, NM 87410

WELL API NO.

3004529228

5. Indicate Type of Lease

STATE ☐

FEE ☒

6. State Oil & Gas Lease No.

7. Lease Name or Unit Agreement Name

Roberts

8. Well No.

#1

9. Pool name or Wildcat

Kutz, W Pictured Cliffs Ext.

SUNDRY NOTICES AND REPORTS ON WELLS

(DO NOT USE THIS FORM FOR PROPOSALS TO DRILL OR TO DEEPEN OR PLUG BACK TO A
DIFFERENT RESERVOIR. USE "APPLICATION FOR PERMIT"
(FORM C-101) FOR SUCH PROPOSALS.)

1. Type of Well:

OIL
WELL ☐

GAS
WELL ☒

OTHER

2. Name of Operator

Amoco Production Company

Attention:

Patty Haeefe

3. Address of Operator

P.O. Box 800 Denver

Colorado

80201

(303) 830-4988

4. Well Location

Unit Letter A : 1130 Feet From The North Line and 810 Feet From The East Line

Section

14

Township

29N

Range

13W

NMPM

San Juan

County

10. Elevation (Show whether DF, RKB, RT, GR, etc.)

5356' GR

11. Check Appropriate Box to Indicate Nature of Notice, Report, or Other Data

NOTICE OF INTENTION TO:

PERFORM REMEDIAL WORK ☐

PLUG AND ABANDON ☐

TEMPORARILY ABANDON ☐

CHANGE PLANS ☐

PULL OR ALTER CASING ☐

OTHER: Restaked location ☒

SUBSEQUENT REPORT OF:

REMEDIAL WORK ☐ ALTERING CASING ☐

COMMENCE DRILLING OPNS. ☐ PLUG AND ABANDONMENT ☐

CASING TEST AND CEMENT JOB ☐

OTHER: ☐

12. Describe Proposed or Completed Operations (Clearly state all pertinent details, and give pertinent dates, including estimated date of starting any proposed work) SEE RULE 1103.

Amoco Production Company has restaked the subject well from 1160' FNL and 850' FEL, Sec. 14 T29N R13W to a new location of 1130' FNL and 810' FEL, Sec. 14 T29N R13W. New C102 attached.

RECEIVED
SEP 21 1995
OIL CON. DIV.
DIST. 3

I hereby certify that the information above is true and complete to the best of my knowledge and belief.

SIGNATURE

Patty Haeefe

TITLE

Staff Assistant

DATE

09-19-1995

TYPE OR PRINT NAME

Patty Haeefe

TELEPHONE NO. (303) 830-4988

(This space for State Use)

APPROVED BY

Ernie Busch

TITLE

DEPUTY OIL & GAS INSPECTOR, DIST. #2

DATE

SEP 21 1995

CONDITIONS OF APPROVAL, IF ANY:

District I
PO Box 1980, Hobbs, NM 88241-1980
District II
PO Drawer DD, Artesia, NM 88211-0719
District III
1000 Rio Grande Rd., Aztec, NM 87410
District IV
PO Box 2088, Santa Fe, NM 87504-2088

State of New Mexico
Energy, Minerals & Natural Resources Department

OIL CONSERVATION DIVISION
PO Box 2088
Santa Fe, NM 87504-2088

dh
e

Form C-102
Revised February 21, 1994
Instructions on back
Submit to Appropriate District Office
State Lease - 4 Copies
Fee Lease - 3 Copies

☐ AMENDED REPORT

WELL LOCATION AND ACREAGE DEDICATION PLAT

1 API Number 30-045-29228		1 Pool Code 79680		1 Pool Name Kutz, West-Pictured Cliffs Ext.	
1 Property Code 16904		1 Property Name ROBERTS			1 Well Number # 1
1 OGRID No. 00778		1 Operator Name AMOCO PRODUCTION COMPANY			1 Elevation 5356

10 Surface Location

UL or lot no. A	Section 14	Township 29 N	Range 13 W	Lot Idn	Feet from the 1130	North/South line NORTH	Feet from the 810	East/West line EAST	County SAN JUAN
--------------------	---------------	------------------	---------------	---------	-----------------------	---------------------------	----------------------	------------------------	--------------------

11 Bottom Hole Location If Different From Surface

UL or lot no.	Section	Township	Range	Lot Idn	Feet from the	North/South line	Feet from the	East/West line	County
11 Dedicated Acres 160		11 Joint or Infill		11 Consolidation Code		11 Order No.			

NO ALLOWABLE WILL BE ASSIGNED TO THIS COMPLETION UNTIL ALL INTERESTS HAVE BEEN CONSOLIDATED
OR A NON-STANDARD UNIT HAS BEEN APPROVED BY THE DIVISION

<div>16</div> <div>14</div> <div>1130'</div> <div>810'</div>				<div>17 OPERATOR CERTIFICATION</div> <div>I hereby certify that the information contained herein is true and complete to the best of my knowledge and belief</div> <div>Signature <u>Patty Haefele</u></div> <div>Printed Name <u>Patty Haefele</u></div> <div>Title <u>Staff Assistant</u></div> <div>Date <u>9/19/95</u></div>	
				<div>18 SURVEYOR CERTIFICATION</div> <div>I hereby certify that the well location shown on this plat was plotted from field notes of actual surveys made by me or under my supervision, and that the same is true and correct to the best of my belief.</div> <div>Date of Survey <u>July 5, 1995</u></div> <div>Signature and Seal of Professional Surveyor: <u>GARY D. VAN</u></div> <div><div>7016</div><div>REGISTERED PROFESSIONAL LAND SURVEYOR</div></div> <div>Certificate Number <u>7016</u></div>	

RECEIVED
SEP 21 1995
OIL CONSERV. DIV.

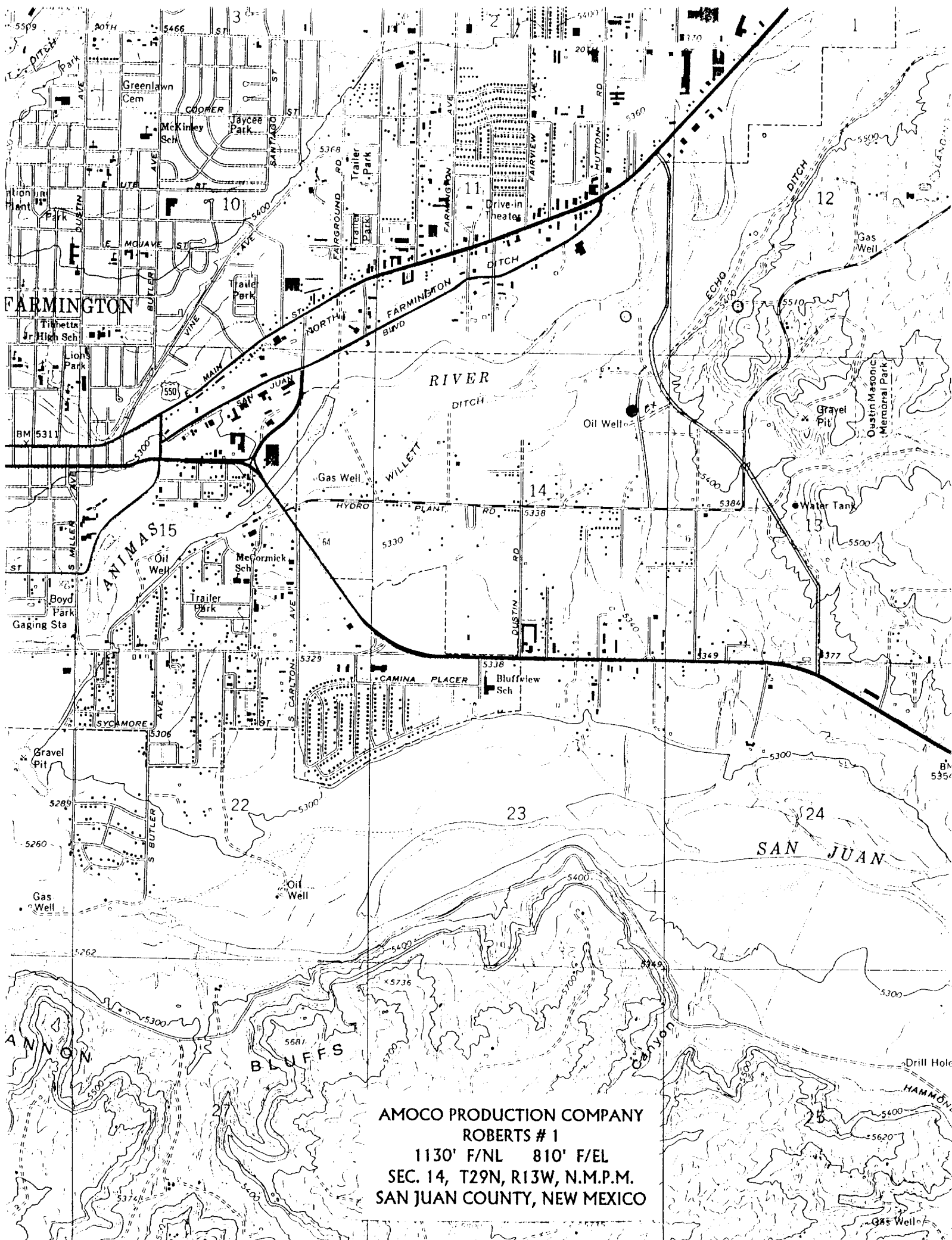

SKETCH OF PROPOSED WELL

ROBERTS # 1
1130' F/NL 810' F/EL
WITHIN THE NE 1/4 OF SEC. 14, T29N, R13W, NMPM
SAN JUAN COUNTY, NEW MEXICO

FOR

AMOCO PRODUCTION COMPANY

