



NEW MEXICO ENERGY, MINERALS
& NATURAL RESOURCES DEPARTMENT

OIL CONSERVATION DIVISION
2040 South Pacheco Street
Santa Fe, New Mexico 87505
(505) 827-7131

February 17, 1999

Burlington Resources Oil & Gas Company
P. O. Box 4289
Farmington, New Mexico 87499-4289
Attention: Peggy Bradfield

RECEIVED
FEB 22 1999
Telefax No. (505) 326-9833

Administrative Order NSL-4214

Dear Ms. Bradfield:

Reference is made to the following: (i) your application dated February 5, 1999; and (ii) to a signed waiver of objection from Taurus Exploration U.S.A. that was submitted to the New Mexico Oil Conservation Division's ("Division") office in Santa Fe on February 17, 1999: all concerning Burlington Resources Oil and Gas Company's request for a non-standard gas well location for the proposed Hubbell Well No. 6-R (API No. 30-045-29730) to be drilled 2660 feet from the South line and 1420 feet from the West line (Unit K) of irregular Section 17, Township 29 North, Range 10 West, NMPM, to test the Pictured Cliffs formation, San Juan County, New Mexico. Lots 11 and 12 and the E/2 SW/4 (SW/4 equivalent) of Section 17 is to be dedicated to the well in order to form a standard 161.03-acre gas spacing and proration unit for the Aztec-Pictured Cliffs Pool.

The application has been duly filed under the provisions of Division Rule 104.F.

By the authority granted me under the provisions of Division Rule 104.F(2), the above-described unorthodox gas well location is hereby approved.

Sincerely,

Lori Wrotenbery
Director

LW/MES/kv

cc: New Mexico Oil Conservation Division - Aztec /
U. S. Bureau of Land Management - Farmington

BURLINGTON RESOURCES

SAN JUAN DIVISION

February 5, 1999 Sent Federal Express

Mr. Michael Stogner
New Mexico Oil Conservation Division
2040 South Pacheco
Santa Fe, New Mexico 87505

Re: Hubbell #6R
2660' FSL, 1420' FWL Section 17, T-29-N, R-10-W, San Juan County, New Mexico
30-045-29730

Dear Mr. Stogner:

Burlington Resources is applying for administrative approval of an unorthodox gas well location for the Aztec Pictured Cliffs pool.

This application for the referenced location is at the request of the Bureau of Land Management due to ledges and cliffs of the terrain as shown on the attached topographic map, which outlines the standard windows.

Production from the Aztec Pictured Cliffs pool is to be included in 160 acre gas spacing for the southwest quarter (SW/4) in Section 17. This well will be drilled as a replacement for the Hubbell #6 located at 990' FSL 1510' FWL Section 17, T-29-N, R-10-W (30-045-20792). The Pictured Cliffs in the Hubbell #6 was plugged and abandoned September 1990, and the well was recompleted to the Basin Fruitland Coal.

The following attachments are for your review:

- Application for Permit to Drill.
- Completed C-102 at referenced location.
- Offset operators/owners plat.
- 7.5 minute topographic map showing terrain features.

Three copies of this application are being submitted to Taurus Exploration USA by certified mail with a request that they furnish you with a Waiver of Objection, keep one copy for their files and return one copy to this office. We appreciate your earliest consideration of this application.

Sincerely,



Peggy Bradfield
Regulatory/Compliance Administrator

xc: NMOCD - Aztec District Office
Bureau of Land Management - Farmington

WAIVER

Taurus Exploration USA hereby waives objection to Burlington Resources' application for a non-standard location for the Hubbell #6R as proposed above.

By: _____ Date: _____

UNITED STATES
DEPARTMENT OF THE INTERIOR
BUREAU OF LAND MANAGEMENT

APPLICATION FOR PERMIT TO DRILL, DEEPEN, OR PLUG BACK

1a. Type of Work DRILL	5. Lease Number SF-078716 Unit Reporting Number	
1b. Type of Well GAS	6. If Indian, All. or Tribe	
2. Operator BURLINGTON RESOURCES Oil & Gas Company	7. Unit Agreement Name	
3. Address & Phone No. of Operator PO Box 4289, Farmington, NM 87499 (505) 326-9700	8. Farm or Lease Name Hubbell 9. Well Number 16R	
4. Location of Well 2660' FSL, 1420' FWL Latitude 36° 43.6 , Longitude 107° 54.7	10. Field, Pool, Wildcat Aztec Pictured Cliffs 11. Sec., Twn, Rge, Mer. (NMPM) Sec. 17, T-29-N, R-10-W API # 30-045-	
14. Distance in Miles from Nearest Town 5 miles to Blanco	12. County San Juan	13. State NM
15. Distance from Proposed Location to Nearest Property or Lease Line 1420'		
16. Acres in Lease	17. Acres Assigned to Well 161.03	
18. Distance from Proposed Location to Nearest Well, Drlg, Compl, or Applied for on this Lease 1000'		
19. Proposed Depth 2250'	20. Rotary or Cable Tools Rotary	
21. Elevations (DF, FT, GR, Etc.) 5738' GR	22. Approx. Date Work will Start	
23. Proposed Casing and Cementing Program See Operations Plan attached		
24. Authorized by:  Regulatory Compliance Administrator	11-6-98 Date	

PERMIT NO. _____ APPROVAL DATE _____
APPROVED BY _____ TITLE _____ DATE _____

Archaeological Report to be submitted

Threatened and Endangered Species Report to be submitted

NOTE: This format is issued in lieu of U.S. BLM Form 3160-3

Title 18 U.S.C. Section 1001, makes it a crime for any person knowingly and willfully to make to any department or agency of the United States any false, fictitious or fraudulent statements or presentations as to any matter within its jurisdiction.

Form C-
Revised February 21, 1964
Instructions on completion of
Appropriate District Office
State Lease - 4 Copies
Fee Lease - 3 Copies

OIL CONSERVATION DIVISION
PO Box 2088
Santa Fe, NM 87504-2088

Submit to Appropriate District Office
State Lease - 4 Copies
Fee Lease - 3 Copies

☐ AMENDED REPO

WELL LOCATION AND ACREAGE DEDICATION PLAT

*API Number 30-045-		*Pool Code 71280	*Pool Name Aztec Pictured Cliffs	
*Property Code 7133	*Property Name HUBBELL			*Well Number 6R
*GGRID No. 14538	*Operator Name BURLINGTON RESOURCES OIL & GAS COMPANY			*Elevation 5738'

¹⁰ Surface Location

UL or lot no.	Section	Township	Range	Lot 1st	Feet from the	North/South line	Feet from the	East/West line	County
K	17	29N	10W		2660	SOUTH	1420	WEST	SAN JU

¹¹Bottom Hole Location If Different From Surface

UL or lot no.	Section	Township	Range	Lot Idn	Feet from the	North/South line	Feet from the	East/West line	County
---------------	---------	----------	-------	---------	---------------	------------------	---------------	----------------	--------

12 Dedicated Acres SW/161.03	13 Joint or Infill	14 Consolidation Code	15 Order No.
---------------------------------	--------------------	-----------------------	--------------

NO ALLOWABLE WILL BE ASSIGNED TO THIS COMPLETION UNTIL ALL INTERESTS HAVE BEEN CONSOLIDATE
OR A NON-STANDARD UNIT HAS BEEN APPROVED BY THE DIVISION

16

2583.90'

2465.76'

17 OPERATOR CERTIFICATION

I hereby certify that the information contained hereon is true and complete to the best of my knowledge and belief.

Peggy Bradfield
Signature
Peggy Bradfield
Printed Name
Regulatory Administrator
Title
11-6-98
Date

17

1420'

2660'

5202.12'

5203.44'

2610.30'

2739.66'

NMSF-078716

17 SURVEYOR CERTIFICATION

I hereby certify that the well location shown on this plat was plotted from field notes of actual surveys made by me or under my supervision, and that the same is true and correct to the best of my belief.

AUGUST 3, 1998
Date of Survey

Neale C. Edwards
Signature and Seal of Professional Surveyor

NEALE C. EDWARDS
NEW MEXICO
6857
REGISTERED PROFESSIONAL SURVEYOR

6857
Certificate Number

OPERATIONS PLAN

Well Name: Hubbell #6R
Location: 2660' FSL, 1420' FWL, Section 17, T-29-N, R-10-W
 San Juan County, New Mexico
 Latitude 36° 43.6', Longitude 107° 54.7'
Formation: Aztec Pictured Cliffs
Elevation: 5738'GR

Formation:	Top	Bottom	Contents
Surface	Nacimiento	910'	
Ojo Alamo	910'	980'	aquifer
Kirtland	980'	1779'	
Fruitland	1779'	2050'	gas
Pictured Cliffs	2050'		gas
Total Depth	2250'		

Logging Program: None

Mud Program:

<u>Interval</u>	<u>Type</u>	<u>Weight</u>	<u>Vis.</u>	<u>Fluid Loss</u>
0- 120'	Spud	8.4-9.0	40-50	no control
120-2250'	Non-dispersed	8.4-9.5	30-60	no control

Casing Program (as listed, equivalent, or better):

<u>Hole Size</u>	<u>Depth Interval</u>	<u>Csg.Size</u>	<u>Wt.</u>	<u>Grade</u>
8 3/4"	0 - 120'	7"	20.0#	J-55
6 1/4"	0 - 2250'	3 1/2"	9.3#	J-55

Tubing Program: - none

Float Equipment: 7" surface casing - saw tooth guide shoe.
 Centralizers will be run in accordance with Onshore Order #2.

3 1/2" production casing - float shoe on bottom. Three centralizers run every other joint above shoe. Four centralizers run every 3rd joint to the base of the Ojo Alamo @ 980'. Two turbolizing type centralizers - one below and one into the base of the Ojo Alamo @ 980'. Standard centralizers thereafter every fourth joint up to the base of the surface pipe.

Wellhead Equipment: 7" x 3 1/2" x 11" 2000 psi screw on independent wellhead.

November 2, 1998

Cementing:

7" surface casing - Cement with 46 sx Class "B" cement with 1/4# flocele/sx and 3% calcium chloride (54 cu.ft. of slurry, 200% excess to circulate to surface). WOC 8 hrs. Test casing to 600 psi for 30 minutes.

3 1/2" production casing - Lead w/204 sx Class "B" cement w/2% calcium chloride, and 1/4# flocele/sx. Tail w/90 sx Class "B" cement w/2% calcium chloride (724 cu.ft. of slurry, 120% excess to circulate to surface). WOC 8 hrs. If cement does not circulate to surface, a CBL will be run during completion to determine TOC.

BOP and tests:

Surface to TD - 11" 2000 psi (minimum double gate BOP stack (Reference Figure #1 and #2). Prior to drilling out surface casing, test rams to 600 psi/30 min.

Completion - 6" 2000 psi (minimum) double gate BOP stack (Reference Figure #2). Prior to completion operations, test rams and casing to 2000 psi/15 min.

From surface to TD - choke manifold (Reference Figure #3).

Pipe rams will be actuated to least once each day and blind rams actuated once each trip to test proper functioning. An upper kelly cock valve with handle and drill string safety valves to fit each drill string will be maintained and available on the rig floor.

Additional information:

- * The Pictured Cliffs formation will be completed.
- * Anticipated pore pressure for the Fruitland is 300 psi and for the Pictured Cliffs is 300 psi.
- * This gas is dedicated.
- * The southwest quarter of the section is dedicated to the Pictured Cliffs.
- * New casing will be utilized.
- * Pipe movement (either rotation or reciprocation) will be done if hole conditions permit.

Rede C. White

Drilling Engineer

11/9/98

Date

BURLINGTON RESOURCES OIL & GAS COMPANY
HUBBELL #6R, 2660' FSL & 1420' FWL
SECTION 17, T29N, R10W, NMPM, SAN JUAN COUNTY, NEW MEXICO
GROUND ELEVATION: 5738' DATE: AUGUST 3, 1998

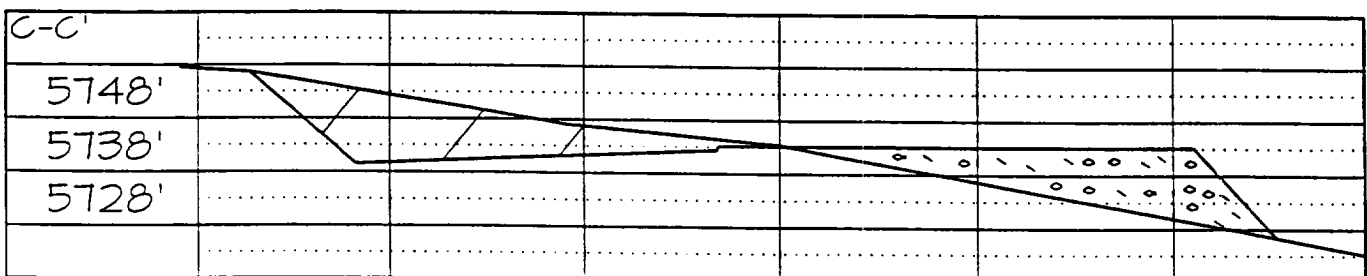
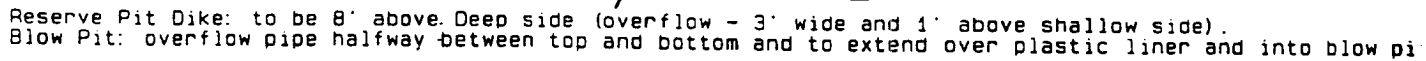

Note: Contractor should call One-Call for location of any marked or unmarked buried pipelines or cables on well pad and/or access road at least two (2) working days prior to construction

Re: Hubbell #6R
2660'FSL, 1420'FWL Section 17, T-29-N, R-10-W, San Juan County, New Mexico
30-045-29730

I hereby certify that the following offset operators/owners have been mailed notification of our application for non-standard location to drill the referenced well.

Taurus Exploration USA
2198 Bloomfield Highway
Farmington, NM 87401



Peggy Bradfield
Regulatory/Compliance Administrator

BURLINGTON RESOURCES OIL AND GAS COMPANY

**Hubbell #6R
OFFSET OPERATOR \ OWNER PLAT
Non Standard Location**

Pictured Cliffs (SW 1/4) Formation Well

Township 29 North, Range 10 West

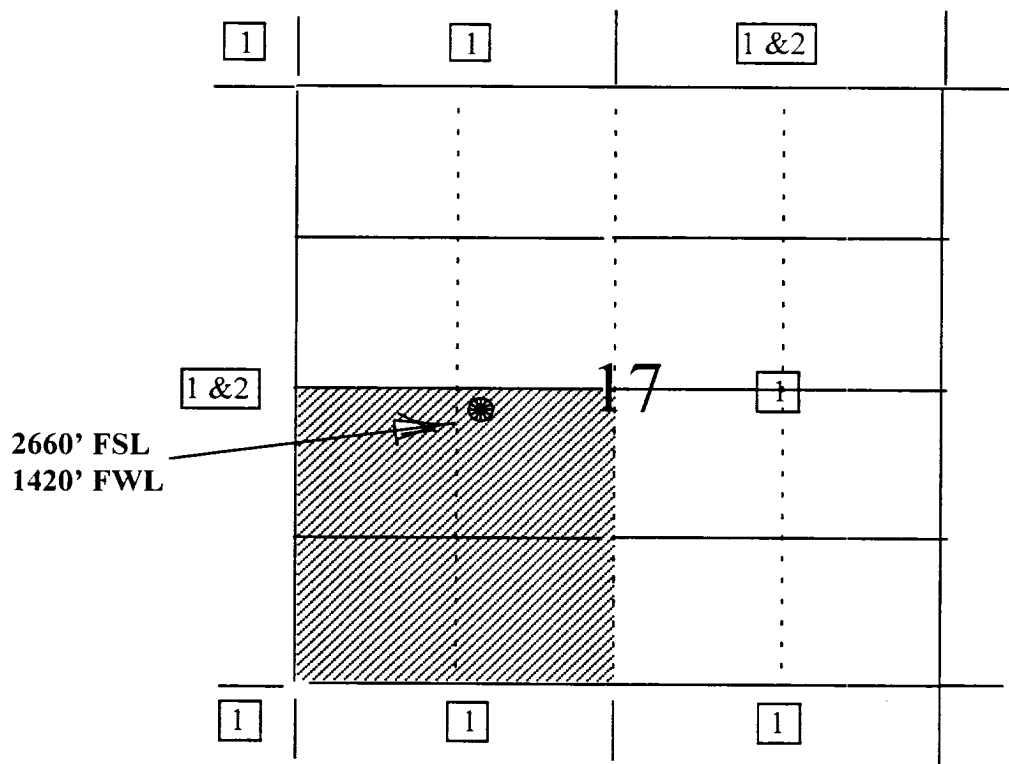

- 1) Burlington Resources
- 2) Taurus Exploration U.S.A.
Attn: Rich Corcoran
2198 Bloomfield Hwy.
Farmington, NM 87401

