

UNITED STATES  
DEPARTMENT OF THE INTERIOR  
BUREAU OF LAND MANAGEMENTFORM APPROVED  
Budget Bureau No. 1004-0136  
Expires: February 28, 1995

## APPLICATION FOR PERMIT TO DRILL OR DEEPEN

1a. Type of Work

DRILL ☒ -DEEPEN ☐

b. Type of Well

Oil Well ☐Gas Well ☒ Other ☐Single Well ☒Multiple Zone ☐

2. Name of Operator

Merrion Oil &amp; Gas Corporation

3. Address and Telephone No.

610 Reilly Ave Farmington NM 87401  
ph: (505) 327-9801

4. Location of Well (Footages)

At Surface ~~255~~ fnl & 585' fel (ne ne)

720

At proposed prod. zone Same

14. Distance in Miles and Directions from Nearest Town or Post Office

Near east edge of Farmington on Williams Drive (Southside River Road)

5. Lease Designation and Serial No.

SF078931

6. If Indian, Allottee or Tribe Name

7. If Unit or CA, Agreement Designation

CA 1408001-6749

8. Well Name and No.

Smith Com 1E 576 84

9. API Well No.

30-045-30388

10. Field and Pool, or Exploratory Area

Basin Dakota

11. Sec., T., R., M., or BLK.  
and Survey or Area

A Section 12, T29N, R13W

12. County or Parish

San Juan

13. State

NM

15. Distance from Proposed Location to Nearest  
(Also to nearest drlg. unit line, if any)

Property or Lease Line, Ft 585'

16. No. of Acres in Lease

80 acres

17. No. of Acres Assigned to This Well

320 acres

18. Distance from Proposed Location to Nearest Well Drilling, Completed, or Applied for, on this Lease, FT

~1858'

19. Proposed Depth

~6250'

20. Rotary or Cable Tools

Rotary

21. Elevations (Show whether DF, RT, GR, etc)

5510' GR, 5523' RKB

22. Approximate Date Work will Start

As soon as permitted &amp; rig available

## PROPOSED CASING AND CEMENTING PROGRAM

SIZE OF HOLE	SIZE & GRADE OF CASING	WEIGHT PER FOOT	SETTING DEPTH	QUANTITY OF CEMENT
12 1/4"	8 5/8" J55	24 ppf	~320' KB	~200 sx (236 cuft)
7 7/8"	4 1/2" J55	10.5 & 11.6 ppf	~6250' KB	~850 sx (1883 cuft)

Merrion proposes to drill 12 1/4" surface hole with native mud to approx. 320' and set 8 5/8" 24ppf J55 surface casing, cement to surface with ~200 sx 'H' w/ 2% CaCl<sub>2</sub> (236 cuft). Will drill 7 7/8" hole to TD @ approx. 6250' KB with low solids non-dispersed mud. Run open hole surveys. Will set 4 1/2" 10.5 ppf J55 production casing from TD to surface. Will cement in two stages: first stage with 100 sx 'B' 35:65 Pozimix w/ 12% Gel (292 cuft) and tail in with 200 sx 'B' 2% Gel (244 cuft) cement to fill from total depth across the Dakota pay zones and above the Gallup formation; second stage DV tool will be set at ~4150' KB at the Mancos top, will cement with 400 sx 'B' 35:65 Pozimix w/ 12% Gel (1164 cuft) and tail in with 150 sx 'B' 2% Gel (183 cuft) cement to fill from DV tool to surface (Will adjust volumes based upon caliper log).

Will test Dakota pay through perforated casing. Will fracture stimulate and put on production test. Drilling operations below surface casing will be conducted with a double-ram BOP in place, minimum working pressure - 2000 psig. This well is located outside the city limits of Farmington, therefore no city permit is required.

Water spacers will be pumped ahead of the lead slurries to prevent mud contamination of the cement. If cement does not reach surface, a temperature log or cement bond log will be run to determine top of cement.

The production casing will be centralized through the Dakota interval and above/below DV tool.

Additional drilling technical details attached.

Tops: Ojo Alamo - Surface, Kirtland - 180', Fruitland - 905', Pictured Cliffs - 1318', Lewis - 1545', Cliffhouse - 2875', Menefee - 3030', Pt. Lookout - 3770', Mancos - 4145', Gallup - 5115', Greenhorn - 5895', Graneros - 5965', Dakota - 6080'.

This action is subject to technical and procedural review pursuant to 43 CFR 3165.3 and appeal pursuant to 43 CFR 3165.4.

ALL ACTIONS ARE AUTHORIZED ARE  
SUBJECT TO COMPLIANCE WITH ATTACHED  
"GENERAL REQUIREMENTS"

IN ABOVE SPACE DESCRIBE PROPOSED PROGRAM: If proposal to deepen, give present productive zone and proposed new productive zone.

COPIES: BLM+5, WELL FILE+1

24. I hereby certify that the foregoing is true and correct

Sig.

Steven S. Dunn

Title Drilling &amp; Production Manager Date October 23, 2000

(This space for Federal or State office use)

Permit No.

Approval Date

Application approval does not warrant or certify that applicant holds legal or equitable title to those rights in the subject lease which would entitle the applicant to conduct operations thereon.  
Conditions of approval, if any:

APPROVED BY:

/s/ Jim Lovato

TITLE

DATE

HOLD C104 FOR NLS

NMOCD

MAR - 6 2001

State of New Mexico  
Energy, Minerals & Mining Resources Department

Form C - 102

GIL CONSERVATION DIVISION  
2040 South Pacheco  
Santa Fe, NM 87505

☐ AMENDED REPORT

WELL LOCATION AND ACREAGE DEDICATION PLAT

APA Number <b>30015-30388</b>	Pool Code <b>71599</b>	Pool Name <b>Basin Dakota</b>
Property Code <b>27684</b>	Property Name <b>Smith Com</b>	Well Number <b>1E</b>
OGRD No. <b>014634</b>	Operator Name <b>Merrion Oil &amp; Gas Corporation</b>	Elevation <b>5510'</b>

Surface Location

UL or Lot	Sec.	Twp.	Rge.	Lot Id.	Feet from	North/South	Feet from	East/West	County
<b>A</b>	<b>12</b>	<b>29N</b>	<b>13W</b>	<b>ne ne</b>	<b>720</b> <b>735</b>	<b>North</b>	<b>585</b>	<b>East</b>	<b>San Juan</b>

Bottom Hole Location if Different From Surface

UL or Lot	Sec.	Twp.	Rge.	Lot Id.	Feet from	North/South	Feet from	East/West	County

Dedication <b>320 Acres</b>	Joint ? <b>Y</b>	Consolidation <b>C</b>	Order No. <b>1408001-6749</b>
--------------------------------	---------------------	---------------------------	----------------------------------

NO ALLOWABLE WILL ASSIGNED TO THIS COMPLETION UNTIL ALL INTERESTS HAVE BEEN CONSOLIDATED  
OR A NON-STANDARD UNIT HAS BEEN APPROVED BY THE DIVISION

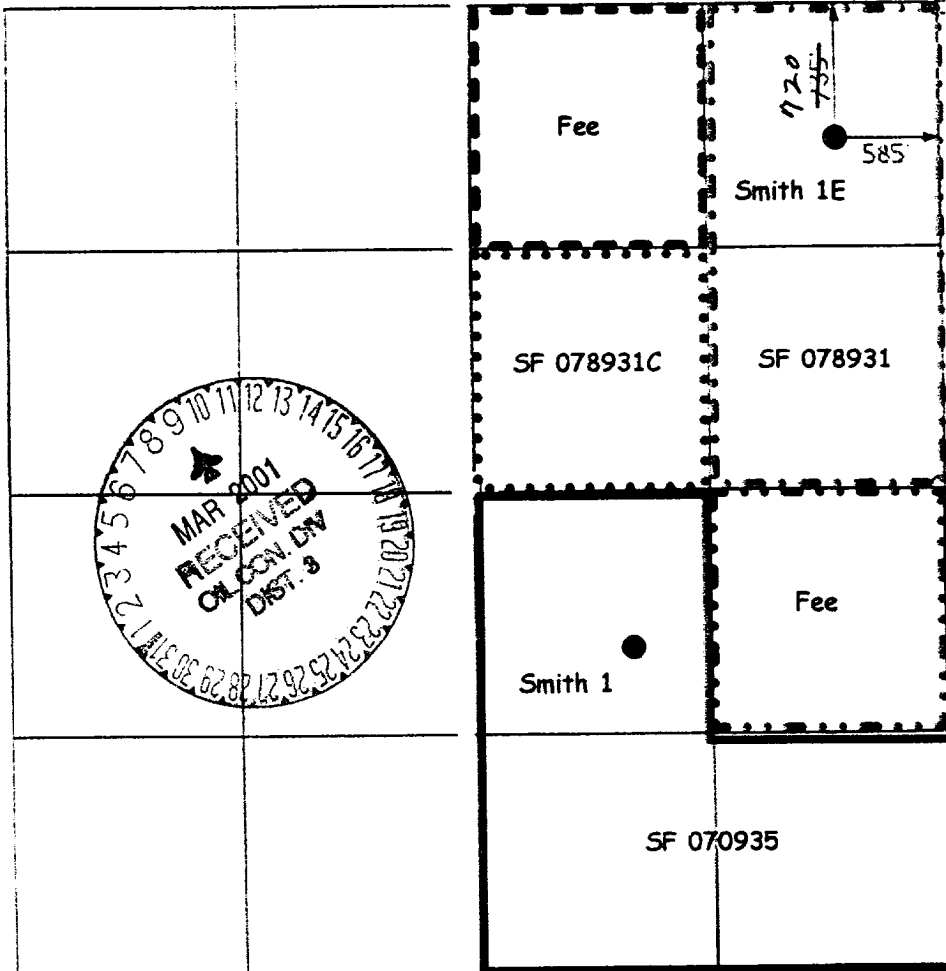

OPERATOR CERTIFICATION

I hereby certify that the information contained herein is true and complete to the best of my knowledge and belief.

Signature *Steven S. Dunn*

Printed Name **Steven S. Dunn**

Title  
**Drilling & Production Manager**

Date  
**October 9, 2000**

SURVEYOR CERTIFICATION

I hereby certify that the well location on this plat was plotted from field notes of actual surveys made by me or under my supervision, and that the same is true and correct to the best of my belief.

Date of Survey

**August 2000**

Signature and Seal of Professional Surveyor

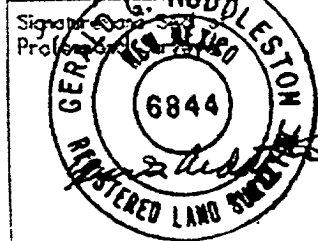

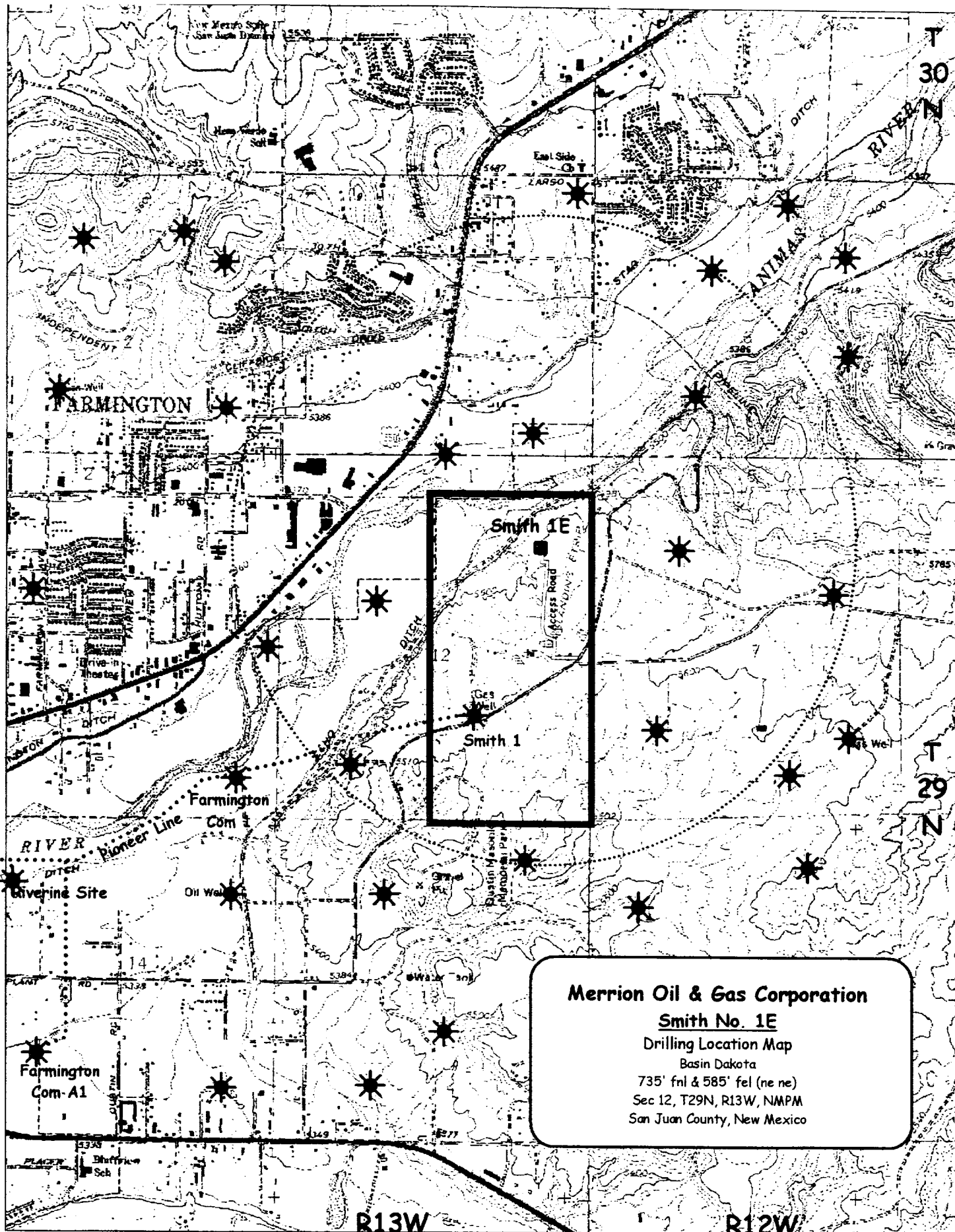

Form 3160-S  
(June 1990)UNITED STATES  
DEPARTMENT OF THE INTERIOR  
BUREAU OF LAND MANAGEMENTFORM APPROVED  
Budget Bureau No. 1004-0135  
Expires: March 31, 19935. Lease Designation and Serial No.  
SF078931

6. If Indian, Allottee or Tribe Name

## SUNDRY NOTICES AND REPORTS ON WELLS

Do not use this form for proposals to drill or to deepen or reentry to a different reservoir.

Use "APPLICATION FOR PERMIT—" for such proposals

## SUBMIT IN TRIPLICATE

1. Type of Well

☐ Oil Well ☒ Gas Well ☐ Other

2. Name of Operator

Merrion Oil &amp; Gas Corporation

3. Address and Telephone No.

610 Reilly Ave Farmington NM 87401

ph: (505) 327-9801

4. Location of Well (Footage, Sec., T., R., M., or Survey Description)

720' fml &amp; 585' fel

Sec 12, T29N, R13W, NMPM

7. If Unit or CA, Agreement Designation

CA 1408001-6749

8. Well Name and No.

Smith Com 1E

9. API Well No.

30-045-30388

10. Field and Pool, or Exploratory Area

Basin Dakota

11. County or Parish, State

San Juan County

New Mexico

## 12. CHECK APPROPRIATE BOX(S) TO INDICATE NATURE OF NOTICE, REPORT, OR OTHER DATA

## TYPE OF SUBMISSION

## TYPE OF ACTION

☒ Notice of Intent☐ Subsequent Report☐ Final Abandonment Notice☐ Abandonment☐ Recompletion☐ Plugging Back☐ Casing Repair☐ Altering Casing☒ Other Move Location☐ Change of Plans☐ New Construction☐ Non-Routine Fracturing☐ Water Shut-Off☐ Conversion to Injection☐ Dispose Water

(Note: Report results of multiple completion as Well Completion or Recompletion Report and Log Run.)

13. Describe Proposed or Completed Operations (Clearly state all pertinent details, and give pertinent dates, including estimated date of starting any proposed work. If well is directionally drilled, give subsurface locations and measured and true vertical depths for all quarters and zones pertinent to this work.)\*

Merrion requests approval to move the proposed location 15 feet north in order to satisfy El Paso Field Service's request for separation from their existing 16" gas gathering line traversing location. The new location footages are reflected above and place the wellbore ~30 feet away from EPFS's line. (Per discussions with Mr. Dale Wirth)

If further is required, please advise.

COPIES: BLM+4, LAND+1, ACTG+1, WELL FILE+1

14. I hereby certify that the foregoing is true and correct

Signed

Steven S. Dunn

Title Drilling &amp; Production Manager

Date March 06, 2001

(This space for Federal or State office use)

Approved by

/s/ Jim Lovato

Title

Date

MAR - 6 2001

# Merrion Oil & Gas Corporation

## Well Control Equipment Schematic for 2M Service

Attachment to Drilling Technical Program

### Smith Com 1E

Location: NW/4  
Sec 14, T29N, R13W, NMPM  
San Juan, New Mexico

Date: October 13, 1998  
By: Steven S. Dunn

#### BOP Stack

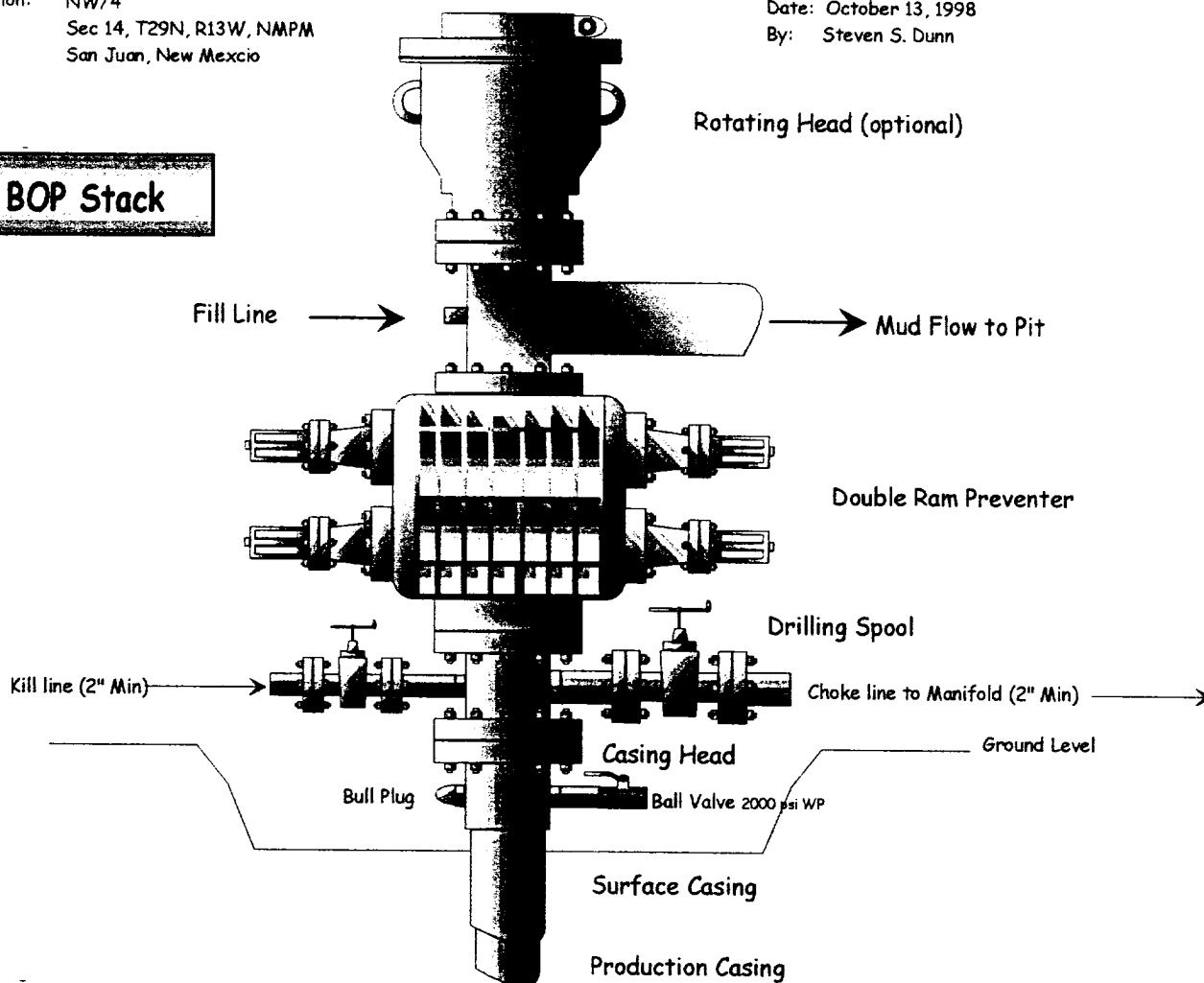

#### Choke & Kill Manifold

