

UNITED STATES
DEPARTMENT OF THE INTERIOR
BUREAU OF LAND MANAGEMENT

SUBMIT IN TRIPLICATE*
(Other instructions on
reverse side)

FORM APPROVED
OMB NO. 1004-0136
Expires: February 28, 1995

APPLICATION FOR PERMIT TO DRILL OR DEEPEN

1a. TYPE OF WORK

DRILL ☒

DEEPEN ☐

b. TYPE OF WELL

OIL
WELL ☐

GAS
WELL ☒

OTHER

SINGLE
ZONE ☒

MULTIPLE
ZONE ☐

2. NAME OF OPERATOR

Richardson Operating Co. (303) 830-8000

3. ADDRESS AND TELEPHONE NO.

1700 Lincoln St., Suite 1700, Denver, Co. 80203

4. LOCATION OF WELL (Report location clearly and in accordance with any State requirements.)*

At surface

1058' FSL & 790' FEL

At proposed prod. zone

Same

14. DISTANCE IN MILES AND DIRECTION FROM NEAREST TOWN OR POST OFFICE*

1 air miles SW of Farmington

15. DISTANCE FROM PROPOSED*

LOCATION TO NEAREST
PROPERTY OR LEASE LINE, FT.

(Also to nearest drlg. unit line, if any)

262'

18. DISTANCE FROM PROPOSED LOCATION*

TO NEAREST WELL, DRILLING, COMPLETED,
OR APPLIED FOR, ON THIS LEASE, FT.

1,779'

16. NO. OF ACRES IN LEASE

1,470.81

19. PROPOSED DEPTH

1,200'

17. NO. OF ACRES ASSIGNED
TO THIS WELL

SE/4 160

20. ROTARY OR CABLE TOOLS

Rotary

21. ELEVATIONS (Show whether DF, RT, GR, etc.)

5,370' ungraded

12. COUNTY OR PARISH 13. STATE
San Juan NM

5. LEASE DESIGNATION AND SERIAL NO.

NMSF-079065

6. IF INDIAN, ALLOTTEE OR TRIBE NAME

N/A

7. UNIT AGREEMENT NAME

26060 N/A

8. FARMOR LEASE NAME WELL NO.

Eaton White #3

9. API WELL NO.

30-045-30880

10. FIELD AND POOL, OR WILDERNESS

West Kutz Pic. Cliff

11. SEC., T., R., M., OR BLK.
AND SURVEY OR AREA

20-29n-13w NMPM

PROPOSED CASING AND CEMENTING PROGRAM

SIZE OF HOLE	GRADE SIZE OF CASING	WEIGHT PER FOOT	SETTING DEPTH	QUANTITY OF CEMENT
8-3/4"	K-55 7"	20	120'	≈36 cu. ft. & to surface
6-1/4"	K-55 4-1/2"	10.5	1,200'	≈235 cu. ft. & to surface

Archaeology report prepared by LaPlata.

On sited with Neel McBride

Formerly known as Hagood #2.

This action is subject to technical and
procedural review pursuant to 43 CFR 3165.3
and appeal pursuant to 43 CFR 3165.4.

DRILLING OPERATIONS AUTHORIZED ARE
SUBJECT TO COMPLIANCE WITH ATTACHED
"GENERAL REQUIREMENTS"

cc: BLM, Colby, OCD (via BLM)

IN ABOVE SPACE DESCRIBE PROPOSED PROGRAM: If proposal is to deepen, give data on present productive zone and proposed new productive zone. If proposal is to drill or deepen a new well, give pertinent data on surface location and measured and true vertical depths. Give blowout preventer program, if any.

24. SIGNED [Signature] CONSULTANT (505) 466-8120 11-15-01

TITLE DATE

(This space for Federal or State office use)

PERMIT NO. APPROVAL DATE 1/3/02

Application approval does not warrant or certify that the applicant holds legal or equitable title to those rights in the subject lease which would entitle the applicant to conduct operations thereon.
CONDITIONS OF APPROVAL, IF ANY:

APPROVED BY [Signature] DATE 1/3/02

*See Instructions on Reverse Side

State of New Mexico
Energy, Minerals & Mining Resources Department
OIL CONSERVATION DIVISION
2040 South Pacheco
Santa Fe, NM 87505

Form C - 102

☐ AMENDED REPORT

WELL LOCATION AND ACREAGE DEDICATION PLAT

APA Number 30-045-30880	Pool Code 79680	Pool Name WEST KUTZ PICTURED CLIFFS
Property Code 26060	Property Name EATON WHITE	Well Number #3
OGED No. 019219	Operator Name RICHARDSON OPERATING COMPANY	Elevation 5370'

Surface Location									
UL or Lot	Sec.	Twp.	Rge.	Lot Idn.	Feet from >	North/South	Feet from >	East/West	County
P	20	29 N.	13 W.		1058'	SOUTH	790'	EAST	SAN JUAN

Bottom Hole Location If Different From Surface									
UL or Lot	Sec.	Twp.	Rge.	Lot Idn.	Feet from >	North/South	Feet from >	East/West	County
Dedication 160	Joint ?	Consolidation	Order No.						

NO ALLOWABLE WILL ASSIGNED TO THIS COMPLETION UNTIL ALL INTERESTS HAVE BEEN CONSOLIDATED
OR A NON-STANDARD UNIT HAS BEEN APPROVED BY THE DIVISION

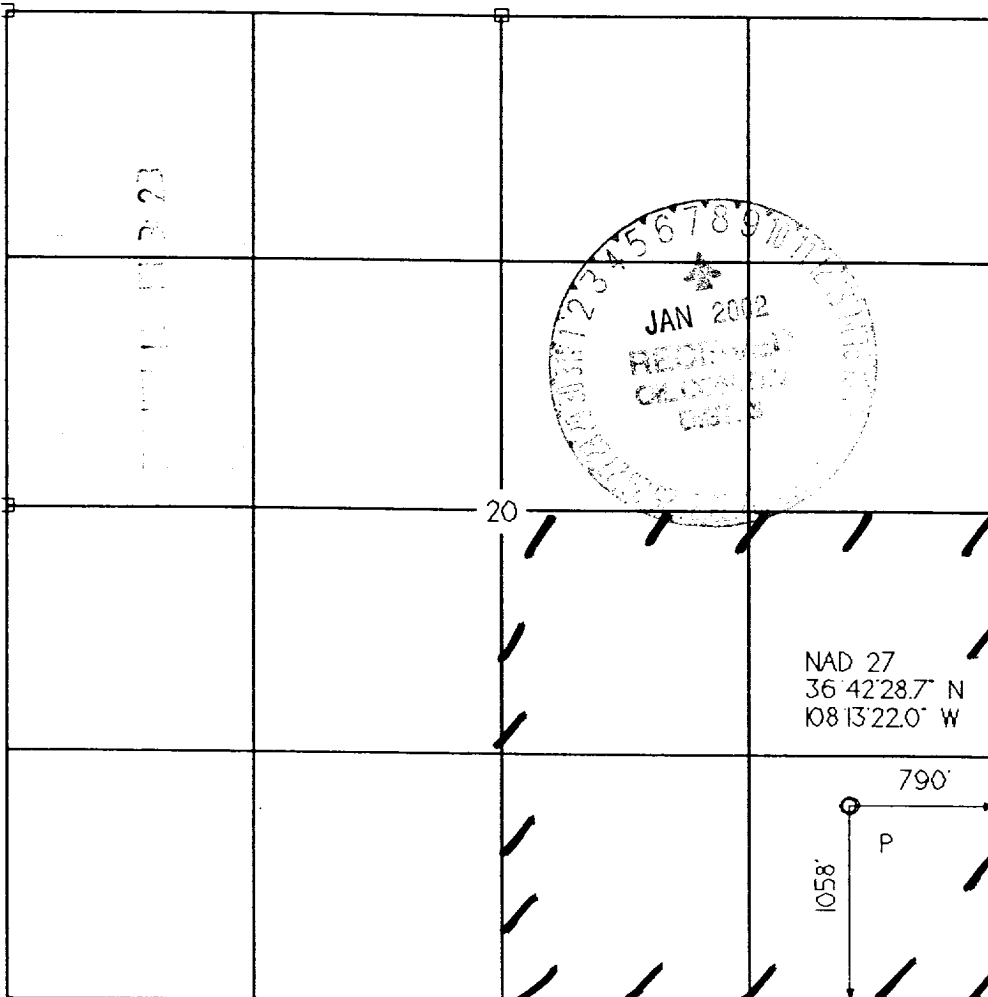

OPERATOR CERTIFICATION I hereby certify that the information contained herein is true and complete to the best of my knowledge and belief. Signature <i>Brian Wood</i>	
Printed Name	BRIAN WOOD
Title	CONSULTANT
Date	NOV. 15, 2001
SURVEYOR CERTIFICATION I hereby certify that the well location on this plat was plotted from field notes of actual surveys made by me or under my supervision, and that the same is true and correct to the best of my belief. Date of Survey SEPTEMBER 2001	
Signature and Seal of Professional Surveyor	<i>David S. Middleton</i> 6844 REGISTERED LAND SURVEYOR

Richardson Operating Co.
 Eaton White #3
 1058' FSL & 790' FEL
 Sec. 20, T. 29 N., R. 13 W.
 San Juan County, New Mexico

PAGE 11

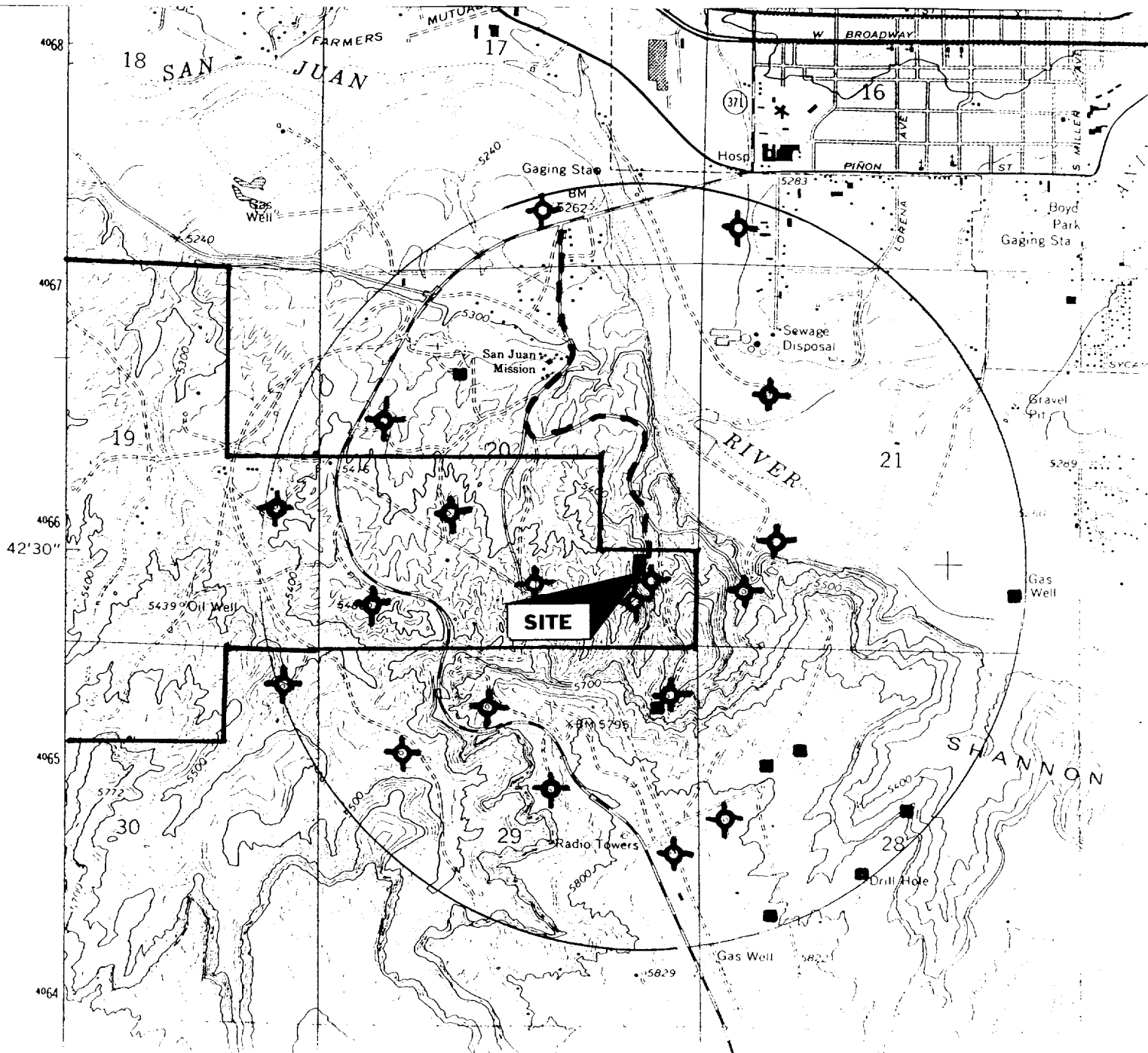

PROPOSED WELL: ■
 EXISTING WELL: ■
 P & A WELL: ⊕

LEASE BOUNDARY: ┌
 EXISTING ROAD: - - -

PERMITS WEST INC.
 PROVIDING PERMITS FOR LAND USERS

Richardson Operating Co.
Eaton White #3
1058' FSL & 790' FEL
Sec. 20, T. 29 N., R. 13 W.
San Juan County, New Mexico

PAGE 1

Drilling Program

1. ESTIMATED FORMATION TOPS

<u>Formation Name</u>	<u>GL Depth</u>	<u>KB Depth</u>	<u>Subsea Elevation</u>
Kirtland Shale	000'	5'	+5,370'
Fruitland Fm	500'	505'	+4,870'
Pictured Cliffs Ss	1,090'	1,095'	+4,280'
Total Depth (TD)*	1,200'	1,205'	+4,170'

* all elevations reflect the ungraded ground level of 5,370'

2. NOTABLE ZONES

<u>Gas Zones</u>	<u>Water Zones</u>	<u>Coal Zones</u>
Fruitland Fm (500')	Fruitland Fm (500')	Fruitland Fm (500')
Pictured Cliffs (1,090')		

Water zones will be protected with casing, cement, and weighted mud. Fresh water encountered during drilling will be recorded by depth, cased, and cemented. Oil and gas shows will be tested for commercial potential based on the well site geologist's recommendations.

3. PRESSURE CONTROL

The drilling contract has not yet been awarded, thus the exact BOP model to be used is not yet known. (A typical 2,000 psi model is on PAGE 3.) Double ram or annular system with a rotating head will be used. All ram preventers and related equipment will be hydraulically tested at nipple up and after any use under pressure to 1000 psi.

Richardson Operating Co.
Eaton White #3
1058' FSL & 790' FEL
Sec. 20, T. 29 N., R. 13 W.
San Juan County, New Mexico

PAGE 2

Blind rams will be hydraulically activated and checked for operational readiness each time pipe is pulled out of the hole. All checks of the BOP stack and equipment will be noted on the daily drilling report. BOP equipment will include a kelly cock, floor safety valve, and choke manifold all rated to 2000 psi. Maximum expected pressure is ≈ 415 psi.

4. CASING & CEMENT

<u>Hole Size</u>	<u>O.D.</u>	<u>Weight (lb/ft)</u>	<u>Grade</u>	<u>Age</u>	<u>GL Setting Depth</u>
8-3/4"	7"	20	K-55	New	120'
6-1/4"	4-1/2"	10.5	K-55	New	1,200'

Surface casing will be cemented to surface with ≈ 36 cu. ft. (≈ 30 sx) Class B + 2% CaCl_2 . Volume is based on 100% excess, yield of 1.18 cu. ft./sk, and slurry weight of 15.6 PPG. WOC = 12 hours. Pressure test surface casing to 600 psi for 30 minutes.

Production casing hole will first be cleaned of rock chips by circulating at least 150% of hole volume with mud to the surface. Forty barrels of fresh water will next be circulated. Lead with ≈ 145 cu. ft. (≈ 71 sx) of Class B with 2% metasilicate (yield = 2.06 cu. ft./sk, slurry weight = 12.5 PPG). Tail with ≈ 90 cu. ft. (≈ 77 sx) of Class B with 2% CaCl_2 (yield = 1.18 cu. ft./sk, slurry weight = 15.6 PPG). Total cement volume is ≈ 235 cubic feet based on 75% excess and circulating to surface.

Production casing will have 4-1/2" cement guide shoe and self fill float collar. Float will be placed one joint above the shoe. Six centralizers will be spaced on every other joint starting above the shoe. Six turbolizers will be placed on every other joint starting from the top of the well.