

UNITED STATES  
DEPARTMENT OF THE INTERIOR  
BUREAU OF LAND MANAGEMENT

APPLICATION FOR PERMIT TO DRILL, DEEPEN, OR PLUG BACK

1a. TYPE OF WORK

DRILL ☒

DEEPEN ☐

PLUG BACK ☐

b. TYPE OF WELL

OIL  
WELL ☐

GAS  
WELL ☒

OTHER

SINGLE  
ZONE ☒

MULTIPLE  
ZONE ☐

2. NAME OF OPERATOR

Northwest Pipeline Corporation

3. ADDRESS OF OPERATOR

3539 East 30th Street - Farmington, NM 87401

4. LOCATION OF WELL (Report location clearly and in accordance with any State requirements.)\*

At surface

730' FWL & 1275' FSL SE/4 SW/4

At proposed prod. zone

Same

14. DISTANCE IN MILES AND DIRECTION FROM NEAREST TOWN OR POST OFFICE\*

Approximately 20 miles to Gobernador

15. DISTANCE FROM PROPOSED\*

LOCATION TO NEAREST  
PROPERTY OR LEASE LINE, FT.  
(Also to nearest drlg. unit line, if any)

730'

16. NO. OF ACRES IN LEASE

N/A 2507.30

17. NO. OF ACRES ASSIGNED  
TO THIS WELL

232.89

18. DISTANCE FROM PROPOSED LOCATION\*

TO NEAREST WELL, DRILLING, COMPLETED,  
OR APPLIED FOR, ON THIS LEASE, FT.

+ 12,000'

19. PROPOSED DEPTH

3330'

20. ROTARY OR CABLE TOOLS

Rotary

21. ELEVATIONS (Show whether DE, RT, GR, etc.)

6543' GR

This action is subject to technical and  
procedural review pursuant to 43 CFR 3160.9  
and appeal pursuant to 43 CFR 3160.4.

22. APPROX. DATE WORK WILL START\*

3-1-89

23. PROPOSED CASING AND CEMENTING PROGRAM

DRILLING OPERATIONS AUTHORIZED ARE  
SUBJECT TO COMPLIANCE WITH ATTACHED  
"GENERAL REQUIREMENTS".

SIZE OF HOLE	SIZE OF CASING	WEIGHT PER FOOT	SETTING DEPTH
12-1/4"	9-5/8"	32.3#	200'
8-3/4"	7"	20#	3166'
6-1/4"	5-1/2"	23#	3330'

125 cu.ft.  
145 cu.ft.  
Open hole completion

The S/2 of Section 31 is dedicated to this well.

Location is unorthodox due to non-standard size section. W/2 is only 1205' wide.  
E/2 is standard size.

RECEIVED  
BLM MAIL ROOM

88 NOV 10 PM 3:18

BLM MINING RESOURCE AREA  
FARMINGTON, NEW MEXICO

RECEIVED  
MAY 22 1989  
OIL CON. DIV.  
DIST. 3

IN ABOVE SPACE DESCRIBE PROPOSED PROGRAM: If proposal is to deepen or plug back, give data on present productive zone and proposed new productive zone. If proposal is to drill or deepen directionally, give pertinent data on subsurface locations and measured and true vertical depths. Give blowout preventer program, if any.

24.

SIGNED

Mike Turnbaugh

TITLE

Sr. Engineer

DATE

11-8-88

(This space for Federal or State office use)

PERMIT NO.

APPROVAL DATE

APPROVED  
AS AMENDED

APPROVED BY

TITLE

MAY 17 1989

CONDITIONS OF APPROVAL, IF ANY:

AREA MANAGER

ch-1

NLP-1572 (C)

NMOCQ

\*See Instructions On Reverse Side

**NEW MEXICO OIL CONSERVATION COMMISSION  
WELL LOCATION AND ACREAGE DEDICATION PLAT**

Form C-102  
Supersedes C-128  
Effective 1-1-65

All distances must be from the outer boundaries of the Section.

Operator <b>Northwest Pipeline Corporation</b>			Lease <b>Rosa Unit</b>		Well No. <b>231</b>
Unit Letter <b>N</b>	Section <b>31</b>	Township <b>31 North</b>	Range <b>5 West</b>	County <b>Rio Arriba</b>	
Actual Footage Location of Well: <b>1275</b> feet from the <b>South</b> line and <b>730</b> feet from the <b>West</b> line					
Ground Level Elev. <b>5543</b>	Producing Formation <b>Fruitland</b>		Pool <b>Basin Fruitland Pool</b>		Dedicated Acreage: <b>232.89</b> Acres

1. Outline the acreage dedicated to the subject well by colored pencil or hatchure marks on the plat below.
2. If more than one lease is dedicated to the well, outline each and identify the ownership thereof (both as to working interest and royalty).
3. If more than one lease of different ownership is dedicated to the well, have the interests of all owners been consolidated by communitization, unitization, force-pooling, etc?

☒ Yes    ☐ No    If answer is "yes," type of consolidation unitization

If answer is "no," list the owners and tract descriptions which have actually been consolidated. (Use reverse side of this form if necessary.)

No allowable will be assigned to the well until all interests have been consolidated (by communitization, unitization, forced-pooling, or otherwise) or until a non-standard unit, eliminating such interests, has been approved by the Commission.

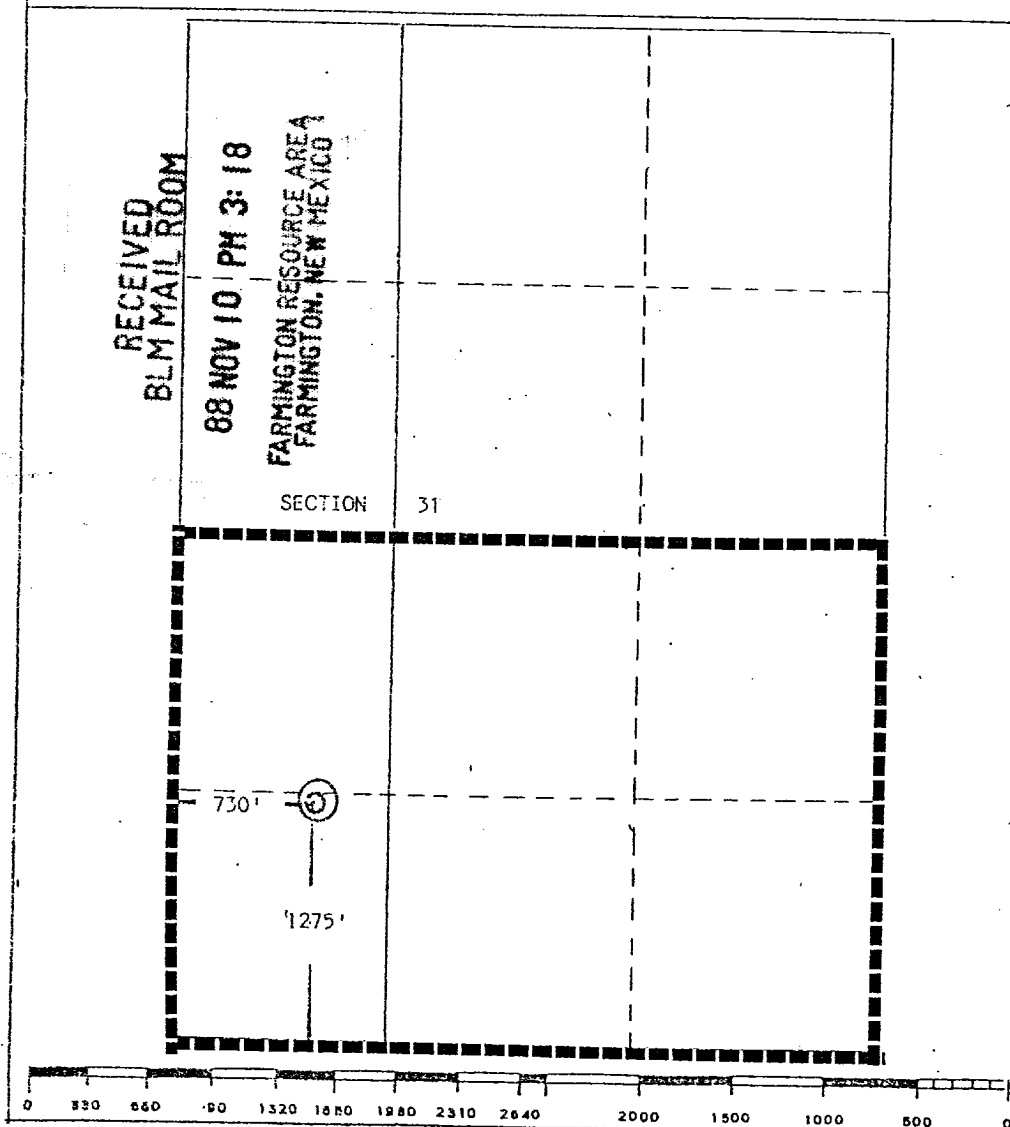

**CERTIFICATION**

I hereby certify that the information contained herein is true and complete to the best of my knowledge and belief.

*Mike Turnbaugh*

Name  
**Mike Turnbaugh**  
Position  
**Senior Engineer**  
Company  
**Northwest Pipeline Corp.**

Date  
**10-21-88**

I hereby certify that the location shown on this plat was plotted from field notes of actual survey made by me or under my supervision, and that the same is true and correct to the best of my knowledge and belief.

Date Surveyed  
**September 20, 1988**

Registered Professional Engineer and/or Land Surveyor

*Edgar L. Risenhoover*  
Certificate No. **5979**  
**Edgar L. Risenhoover L.S.**

4557 IV NE  
(BANCOS MESA)

