

BLM  
GB



STATE OF NEW MEXICO  
ENERGY, MINERALS AND NATURAL RESOURCES DEPARTMENT  
OIL CONSERVATION DIVISION

no  
APD  
5-9-89

GARREY CARRUTHERS  
GOVERNOR

POST OFFICE BOX 2088  
STATE LAND OFFICE BUILDING  
SANTA FE, NEW MEXICO 87504  
(505) 827-5800

May 2, 1989

Northwest Pipeline Corporation  
3539 East 30th Street  
Farmington, NM 87401

Attention: Mike Turnbaugh  
Senior Engineer

Administrative Order NSP-1572(L)

Dear Mr. Turnbaugh:

Reference is made to your application of November 11 and December 6, 1988 for a 232.89-acre non-standard gas proration unit consisting of the following acreage in the Basin-Fruitland Coal (Gas) Pool:

RIO ARRIBA COUNTY, NEW MEXICO  
TOWNSHIP 31 NORTH, RANGE 5 WEST, NMPM  
Section 31: Lots 3 and 4 and the SE/4

It is my understanding that this unit is to be dedicated to your Rosa Unit Well No. 231 to be drilled at a standard coal gas well location 1275 feet from the South line and 730 feet from the West line (Unit N) of said Section 31, hereby approved under provisions of Rule 8 of the Special Rules and Regulations for this pool as promulgated by Division Order No. R-8768.

By authority granted me under the provisions of Rule 6 of the Special Rules and Regulations for the Basin-Fruitland Coal (Gas) Pool, as promulgated by Division Order No. R-8768, the above non-standard gas proration unit is hereby approved.

Sincerely,

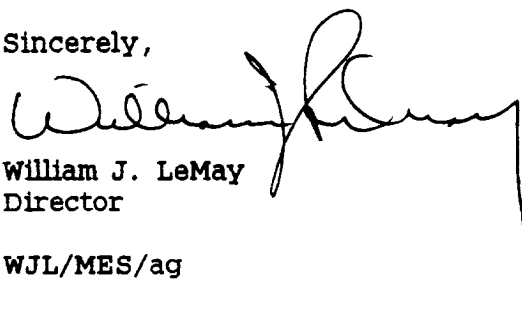
  
William J. LeMay  
Director

WJL/MES/ag

cc: Oil Conservation Division - Aztec  
NM Oil and Gas Engineering Committee - Hobbs  
US Bureau of Land Management - Farmington

RECEIVED  
MAY 3 1989  
OIL CON. DIV  
DIST. 3



STATE OF NEW MEXICO  
ENERGY AND MINERALS DEPARTMENT  
OIL CONSERVATION DIVISION  
AZTEC DISTRICT OFFICE

1000 MID BRAZOS ROAD  
AZTEC, NEW MEXICO 87410  
(505) 334-6178

OIL CONSERVATION DIVISION  
BOX 2088  
SANTA FE, NEW MEXICO 87501

DATE 11-23-88

RE: Proposed MC \_\_\_\_\_  
Proposed DHC \_\_\_\_\_  
Proposed NSL X \_\_\_\_\_  
Proposed SWD \_\_\_\_\_  
Proposed WFX \_\_\_\_\_  
Proposed PMX \_\_\_\_\_

NSIP X

Gentlemen:

I have examined the application dated 11-17-88  
for the NORTHWEST PIPELINE ROSA UNIT #231 N-31-31N-5W  
Operator Lease and Well No. Unit, S-T-R

and my recommendations are as follows:

APPROVE  
\_\_\_\_\_  
\_\_\_\_\_  
\_\_\_\_\_  
\_\_\_\_\_  
\_\_\_\_\_

Yours truly,

[Signature]

NORTHWEST PIPELINE CORPORATION

PRODUCTION & DRILLING  
P.O. BOX 90  
FARMINGTON, NEW MEXICO 87409

4320-PD-124-38

November 11, 1988

NMOCC

Attn: Bill LeMay  
310 Old Santa Fe Trail  
Room #206  
Santa Fe, NM 87503

Re: Unorthodox Location - Rosa Unit #231

Dear Mr. LeMay:

Northwest Pipeline requests permission to drill a Fruitland well on an unorthodox location due to the original survey of Sec. 31, T31N, R5W. The W/2 of Sec. 31 is approximately 1205' wide making it impossible to maintain the 790' offsets required in the new Fruitland Pool Rules.

Northwest Pipeline is the only operator in the Rosa Unit thus no notification of offset operators is being done.

Attached is a plat and topo map.

Sincerely,

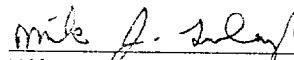
  
Mike J. Turnbaugh  
Sr. Engineer

MJT/ch  
attch

All distances must be from the outer boundaries of the Section.

Operator Northwest Pipeline Corporation			Lease Rosa Unit		Well No. 231
Unit Letter N	Section 31	Township 31 North	Range 5 West	County Rio Arriba	
Actual Footage Location of Well: 1275 feet from the South line and 730 feet from the West line					
Ground Level Elev. 5543	Producing Formation Fruitland	Pool Basin Fruitland Pool		Dedicated Acreage: 232.99 Acres	

1. Outline the acreage dedicated to the subject well by colored pencil or hachure marks on the plat below.
2. If more than one lease is dedicated to the well, outline each and identify the ownership thereof (both as to working interest and royalty).
3. If more than one lease of different ownership is dedicated to the well, have the interests of all owners been consolidated by communitization, unitization, force-pooling, etc?

☒ Yes ☐ No If answer is "yes," type of consolidation unitization

If answer is "no," list the owners and tract descriptions which have actually been consolidated. (Use reverse side of this form if necessary.)

No allowable will be assigned to the well until all interests have been consolidated (by communitization, unitization, forced-pooling, or otherwise) or until a non-standard unit, eliminating such interests, has been approved by the Commission.

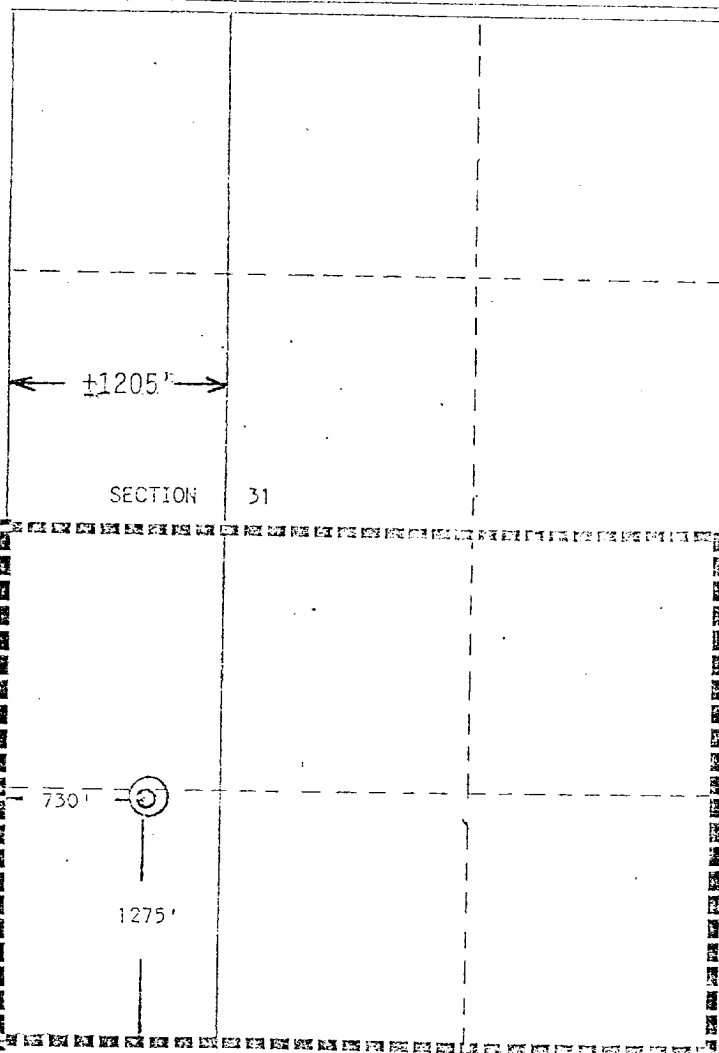

## CERTIFICATION

I hereby certify that the information contained herein is true and complete to the best of my knowledge and belief.

*Mike Turnbaugh*

Name

Mike Turnbaugh

Position

Senior Engineer

Company

Northwest Pipeline Corp.

Date

10-21-88

I hereby certify that the location shown on this plat was plotted from field notes of actual survey made by me or under my supervision, and that the same is true and correct to the best of my knowledge and belief.

Date Surveyed

September 20, 1988

Registered Professional Engineer and/or Land Surveyor

*Edgar L. Risenhoover*  
Certificate No. 5979

Edgar L. Risenhoover L.S.

4557 IV NE  
(BANCOS MESA)

4557 IV NE  
(BANCOS MESA)

4557 IV NE  
(BANCOS MESA)

