

UNITED STATES
DEPARTMENT OF THE INTERIOR

GEOLOGICAL SURVEY

30-039-25133 ✓

APPLICATION FOR PERMIT TO DRILL, DEEPEN, OR PLUG BACK

1a. TYPE OF WORK

DRILL ☒DEEPEN ☐PLUG BACK ☐

b. TYPE OF WELL

OIL
WELL ☐GAS
WELL ☒

OTHER

SINGLE
ZONE ☒MULTIPLE
ZONE ☐

2. NAME OF OPERATOR

MITCHELL ENERGY CORPORATION

3. ADDRESS OF OPERATOR

555 Seventeenth Street - Suite 3500
Denver, CO 80202

4. LOCATION OF WELL (Report location clearly and in accordance with any State requirements.)

At surface

1950' FNL & 2585' FEL Sec. 11-T31N-R4W

At proposed prod. zone

Same

14. DISTANCE IN MILES AND DIRECTION FROM NEAREST TOWN OR POST OFFICE*

+
-61 miles northeast of Blanco, New Mexico

15. DISTANCE FROM PROPOSED*

LOCATION TO NEAREST
PROPERTY OR LEASE LINE, FT.
(Also to nearest drlg. unit line, if any)

1950'

16. NO. OF ACRES IN LEASE

2560 acres

18. DISTANCE FROM PROPOSED LOCATION*
TO NEAREST WELL, DRILLING, COMPLETED,
OR APPLIED FOR, ON THIS LEASE, FT.

2308'

19. PROPOSED DEPTH

4000'

17. NO. OF ACRES ASSIGNED
TO THIS WELL

E/ 320 acres ✓

20. ROTARY OR CABLE TOOLS

rotary

21. ELEVATIONS (Show whether DF, RT, GR, etc.)

7046' 6952' GR

22. APPROX. DATE WORK WILL START*

9/15/90

PROPOSED CASING AND CEMENTING PROGRAM

SIZE OF HOLE	SIZE OF CASING	WEIGHT PER FOOT	SETTING DEPTH	QUANTITY OF CEMENT
12-1/4"	8-5/8"	24# K-55	500'	350 sx - circ. to surface
7-7/8"	5-1/2"	15.5# K-55	4000'	700 sx - est TOC 350'

The operator proposes to drill to a depth sufficient to test the Fruitland Formation. If productive, 5-1/2" casing will be run and set at ±4000'. If non-productive, the well will be plugged and abandoned consistent with Federal Regulations. Any zones above the Fruitland may be tested for productivity prior to Abandonment.

EXHIBITS ATTACHED

Ten Point Compliance Program

Surface Use & Operating Plan

Exhibit No. 1 Blowout Preventer Schematic Exhibit No. 6 Production Facilities

Exhibit No. 2 Location Elevation Plat

Layout

Exhibit No. 3 Planned Access Roads

Exhibit No. 7 Drilling Rig Layout

Exhibit No. 4 Planned Pipeline Map

Exhibit No. 5 One Mile Radius Map

IN ABOVE SPACE DESCRIBE PROPOSED PROGRAM: If proposal is to deepen or plug back, give data on present productive zone and proposed new productive zone. If proposal is to drill or deepen directionally, give pertinent data on subsurface locations and measured and true vertical depths. Give blowout preventer program, if any.

24.

SIGNED

James C. Anderson

TITLE District Production Manager

APPROVED
AS AMENDED

(This space for Federal National)

PERMIT

APPROVAL DATE

OCT 29 1991

APPROVED BY

NOV 1 1991

TITLE

NMOC

CONDITIONS OF APPROVAL, IF ANY:

OIL CON. DIV.

DISTRICT

*See Instructions On Reverse Side

Submit to Appropriate
District Office
State Lease - 4 copies
Fee Lease - 3 copies

State of New Mexico
Energy, Minerals and Natural Resources Department

Form C-102
Revised 1-1-89

OIL CONSERVATION DIVISION

P.O. Box 2088
Santa Fe, New Mexico 87504-2088

RECEIVED
BLM

91 AUG 28 AM 10:30

910 TARRINGTON, N.M.

DISTRICT I
P.O. Box 1980, Hobbs, NM 88240

DISTRICT II
P.O. Drawer DD, Artesia, NM 88210

DISTRICT III
1000 Rio Brazos Rd., Aztec, NM 87410

WELL LOCATION AND ACREAGE DEDICATION PLAT

All Distances must be from the outer boundaries of the section

Operator Mitchell Energy Corporation			Lease Rosa Unit		Well No. 342
Unit Letter B	Section 11	Township 31 North	Range 4 West	County Rio Arriba	
Actual Footage Location of Well: 765 feet from the North line and 2595 feet from the East line					
Ground level Elev. 7046'	Producing Formation Fruitland		Pool Basin Fruitland Coal	Dedicated Acreage: 320 Acres	

- Outline the acreage dedicated to the subject well by colored pencil or hachure marks on the plat below.
- If more than one lease is dedicated to the well, outline each and identify the ownership thereof (both as to working interest and royalty).
- If more than one lease of different ownership is dedicated to the well, have the interest of all owners been consolidated by communitization, unitization, force-pooling, etc.?
☐ Yes ☐ No If answer is "yes" type of consolidation _____
If answer is "no" list the owners and tract descriptions which have actually been consolidated. (Use reverse side of this form if necessary.) _____
No allowable will be assigned to the well until all interests have been consolidated (by communitization, unitization, forced-pooling, or otherwise) or until a non-standard unit, eliminating such interest, has been approved by the Division.

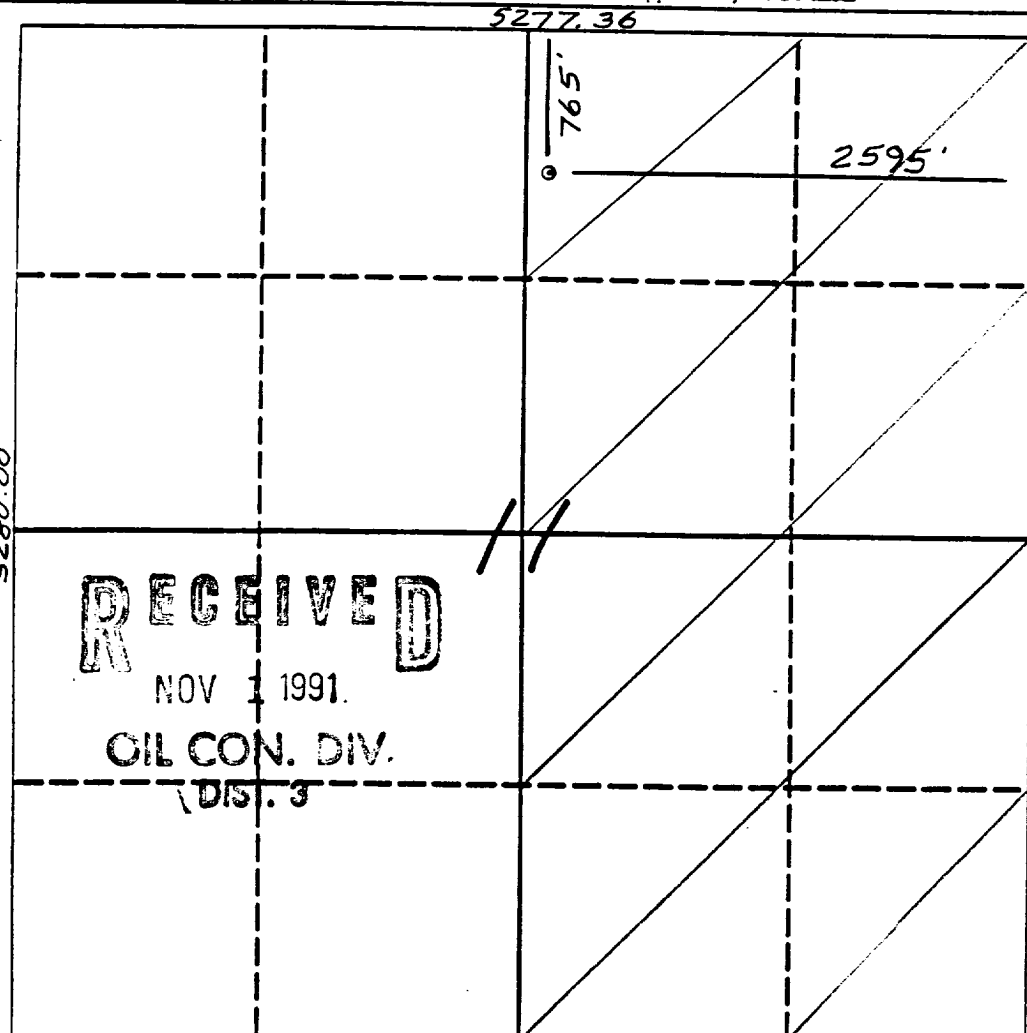

OPERATOR CERTIFICATION

I hereby certify that the information contained herein is true and complete to the best of my knowledge and belief.

Signature
Albert Libersat
Printed Name
ALBERT LIBERSAT
Position
DISTRICT ENGINEER
Company
MITCHELL ENERGY CORP
Date
6-12-91

SURVEYOR CERTIFICATION

I hereby certify that the well location shown on this plat was plotted from field notes of actual surveys made by me or under my supervision, and that the same is true and correct to the best of my knowledge and belief.

6-7-91

Date Surveyed
Signature
Professional Surveyor
NEW MEXICO
6857
6857
REGISTERED LAND SURVEYOR
Certificate
Neale Edwards

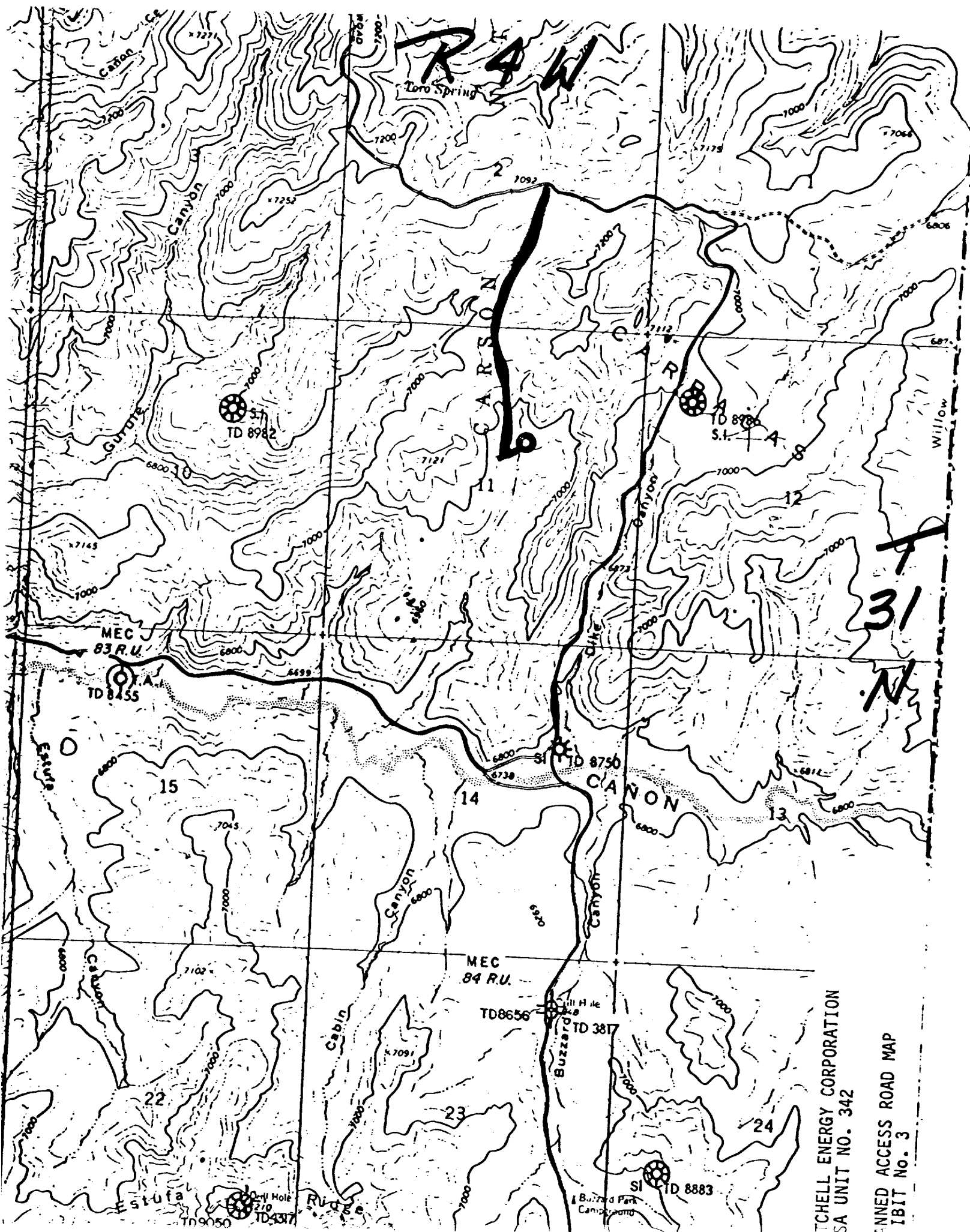

TCHILL ENERGY CORPORATION
SA UNIT NO. 342

ANNED ACCESS ROAD MAP
IBIT No. 3