

NEW MEXICO OIL CONSERVATION COMMISSION
Santa Fe, New Mexico

Form C-101
Revised (12/1/55)

NOTICE OF INTENTION TO DRILL

Notice must be given to the District Office of the Oil Conservation Commission and approval obtained before drilling or recompletion begins. If changes in the proposed plan are considered advisable, a copy of this notice showing such changes will be returned to the sender. Submit this notice in QUINTUPLICATE. One copy will be returned following approval. See additional instructions in Rules and Regulations of the Commission. If State Land submit 6 Copies Attach Form C- 128 in triplicate to first 3 copies of form C-101

Farmington, New Mexico
(Place)

January 27, 1959
(Date)

OIL CONSERVATION COMMISSION
SANTA FE, NEW MEXICO

Gentlemen:

You are hereby notified that it is our intention to commence the Drilling of a well to be known as

Pan American Petroleum Corporation

(Company or Operator)

Helton Gas Unit

(Lease)

Well No. 1, in 9 (Unit) The well is

located 790 feet from the South line and 1850 feet from the

East

line of Section 32, T. 30N, R. 9W, NMPM.

(GIVE LOCATION FROM SECTION LINE)

Blanco-Pictured Cliffs Pool, San Juan County

If State Land the Oil and Gas Lease is No.....

If patented land the owner is A. M. Helton est., E. A. Allen

Address Astec, New Mexico

We propose to drill well with drilling equipment as follows:.....

Rotary tools to total depth.

The status of plugging bond is.....

Drilling Contractor To be determined later.

We intend to complete this well in the Pictured Cliffs formation at an approximate depth of 2500 feet.

Section 32

We propose to use the following strings of Casing and to cement them as indicated:

Size of Hole	Size of Casing	Weight per Foot	New or Second Hand	Depth	Sacks Cement
<u>12-1/4"</u>	<u>8-5/8"</u>	<u>22.7</u>	<u>New</u>	<u>200'</u>	<u>160 sacks circulate</u>
<u>7-7/8"</u>	<u>4-1/2"</u>	<u>9.5</u>	<u>New</u>	<u>2500'</u>	<u>Circulate to surface</u>
					<u>if possible.</u>

If changes in the above plans become advisable we will notify you immediately.

ADDITIONAL INFORMATION (If recompletion give full details of proposed plan of work.)

We propose to drill the above well with rotary tools to an approximate total depth of 2500' to complete in the Pictured Cliffs formation. Stimulation will be indicated on reaching total depth. Copies of location plat are attached. Logs will be furnished upon completion of well.

Approved 1-28, 1959
Except as follows:

Sincerely yours,

Pan American Petroleum Corporation

(Company or Operator)

By R. M. Bauer, Jr.

Position Field Engineer

Send Communications regarding well to

Name Pan American Petroleum Corporation

Address Box 487, Farmington, New Mexico

OIL CONSERVATION COMMISSION

By A. R. Henderson

NEW MEXICO OIL CONSERVATION COMMISSION

Well Location and Acreage Dedication Plat

Section A.

Date JANUARY 13, 1959

Operator PAN AMERICAN PETROLEUM CORP. Lease HELTON GAS UNIT
 Well No. I Unit Letter B Section 32 Township 30N Range 9W NMPM
 Located 790 Feet From SOUTH Line, 1850 Feet From EAST Line
 County SAN JUAN G. L. Elevation * Dedicated Acreage 160 Acres
 Name of Producing Formation Pictured Cliffs Pool Blanco Pictured Cliffs

1. Is the Operator the only owner in the dedicated acreage outlined on the plat below?
 Yes _____ No X ***To be reported later**
2. If the answer to question one is "no", have the interests of all the owners been consolidated by communitization agreement or otherwise? Yes X No _____. If answer is "yes", Type of Consolidation.
Communitised Tract: Pan American 75%, El Paso 25%
3. If the answer to question two is "no", list all the owners and their respective interests below:

Owner

Land Description

Section B.

This is to certify that the information in Section A above is true and complete to the best of my knowledge and belief.

PAN AMERICAN PETROLEUM CORPORATION

(Operator)

R. M. Bauer, Jr. R.M. Bauer, Jr.

(Representative)

Box 487, Farmington, New Mexico

(Address)

REF. GLO PLAT DATED 2 JULY 1952

Note: All distances must be from outer boundaries of section.

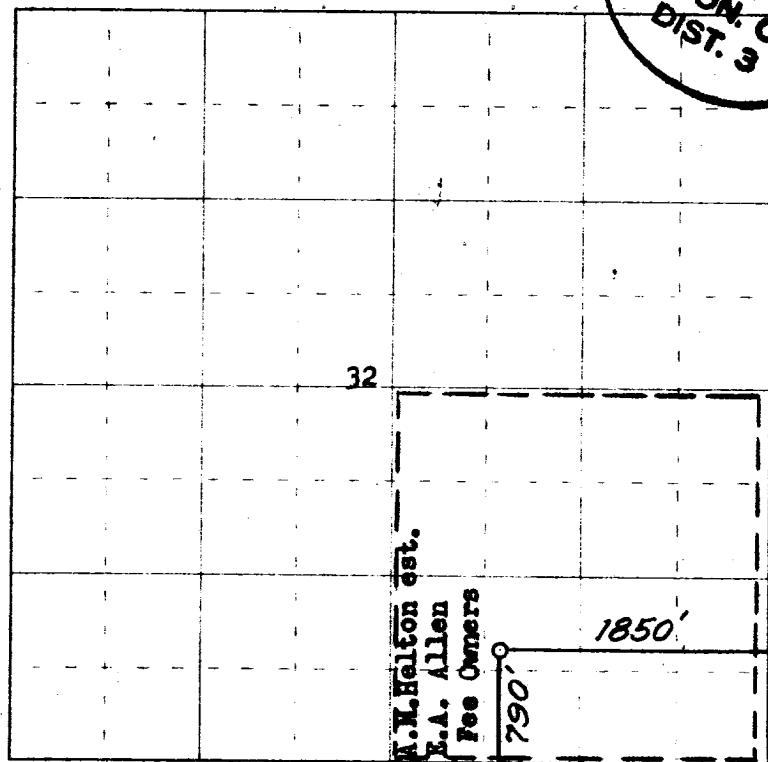

0 330 660 990 1320 1650 1980 2310 2640 2000 1800 1000 500 0

Scale 4 inches equal 1 mile

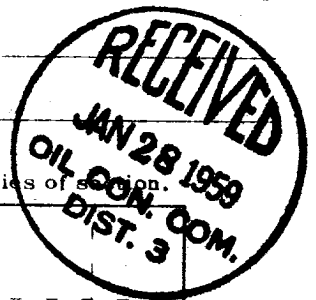

(Seal)

Farmington, New Mexico

I hereby certify that the above plat was prepared from field notes of actual surveys made by me or under my supervision and that the same are true and correct to the best of my knowledge and belief.

Date Surveyed JANUARY 6, 1959

James P. Leese
 Registered Professional Engineer and/or Land Surveyor
 James P. Leese N. Mex. Reg. No. 1463