

(SUBMIT IN TRIPLICATE)

UNITED STATES
DEPARTMENT OF THE INTERIOR
GEOLOGICAL SURVEY

Land Office Santa Fe
Lease No. New Mexico 06738
Unit SW/4 Sec. 34, Twp-30N,
Rge 10-W, N.M.P.M.,
San Juan County, New Mex.

SUNDRY NOTICES AND REPORTS ON WELLS

NOTICE OF INTENTION TO DRILL	<input checked="" type="checkbox"/>	SUBSEQUENT REPORT OF WATER SHUT-OFF	
NOTICE OF INTENTION TO CHANGE PLANS		SUBSEQUENT REPORT OF SHOOTING OR ACIDIZING	
NOTICE OF INTENTION TO TEST WATER SHUT-OFF		SUBSEQUENT REPORT OF ALTERING CASING	
NOTICE OF INTENTION TO RE-DRILL OR REPAIR WELL		SUBSEQUENT REPORT OF RE-DRILLING OR REPAIR	
NOTICE OF INTENTION TO SHOOT OR ACIDIZE		SUBSEQUENT REPORT OF ABANDONMENT	
NOTICE OF INTENTION TO PULL OR ALTER CASING		SUPPLEMENTARY WELL HISTORY	
NOTICE OF INTENTION TO ABANDON WELL			

(INDICATE ABOVE BY CHECK MARK NATURE OF REPORT, NOTICE, OR OTHER DATA)

June 6

19 55

No. 1 Sanchez

Well No. / is located 1000 ft. from NE line and 1100 ft. from W line of sec. 34

SW/4 SW/4 Section 34 Twp. 30-N R-10-W N.M.P.M.
(1/4 Sec. and Sec. No.) (Twp.) (Range) (Meridian)

Astec Pictured Cliffs San Juan County New Mexico
(Field) (County or Subdivision) (State or Territory)

The elevation of the derrick floor above sea level is _____ ft. **To Be Determined**

DETAILS OF WORK

(State names of and expected depths to objective sands; show sizes, weights, and lengths of proposed casings; indicate mudding jobs, cementing points, and all other important proposed work)

Objective sand is the Pictured Cliffs formation anticipated at approximately 2450'.

Proposed Casing Program: 90' 9 5/8" J-55 Cemented to Surface
2450' 5 1/2" J-55 Cemented with 150 sacks.

Rotary tools will be employed from surface to top of Pictured cliffs formation
Cable tools will be employed from top of Pictured Cliffs to Total Depth.

The well will be sand oil traced in an effort to stimulate production.

Estimated total depth 2525 feet.

I understand that this plan of work must receive approval in writing by the Geological Survey before operations may be commenced.

Company Southern Union Gas Company

Address 1001 Burt Building

Dallas 1, Texas

By _____

Title Lemwood S. Muenink
Jr. Petroleum Engineer

COMPANY Southern Union Gas Company

Well Name & No. Sanchez No. 1 Lease No. N.M. 06738

Location 1050' from the South line and 1100' from the West line.

Being in SW¹SW¹

Sec. 34, T30 N, R10 W., N.M.P.M., San Juan County, New Mexico.

Ground Elevation

RECEIVED
JUN 6 1955
U. S. GEOLOGICAL SURVEY
FARMINGTON, NEW MEXICO

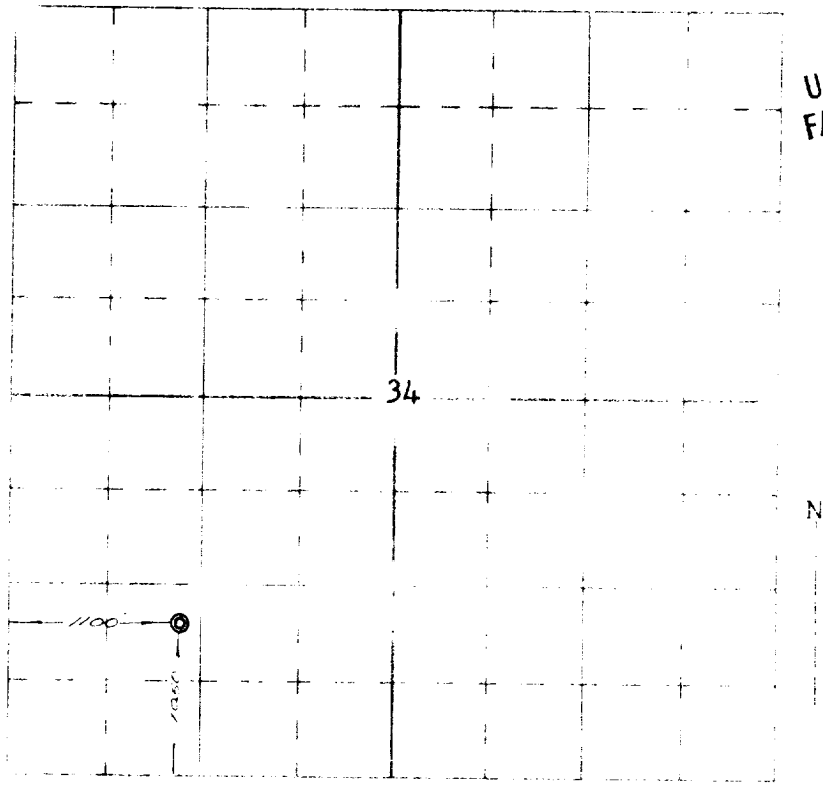

Scale - 4 inches equals 1 mile

Surveyed May 22 1955

This is to certify that the above plat was prepared from field notes of actual surveys made by me or under my supervision and that the same are true and correct to the best of my knowledge and belief.

Ernest V. Echohawk
Ernest V. Echohawk
Registered Land Surveyor
N. M. Reg. #1545

