

NEW MEXICO OIL CONSERVATION COMMISSION  
Santa Fe, New Mexico

NOTICE OF INTENTION TO DRILL OR RECOMPLETE

Notice must be given to the District Office of the Oil Conservation Commission and approval obtained before drilling or recompletion begins. If changes in the proposed plan are considered advisable, a copy of this notice showing such changes will be returned to the sender. Submit this notice in QUINTUPLICATE. One copy will be returned following approval. See additional instructions in Rules and Regulations of the Commission.

Farmington, New Mexico

(Place)

May 4, 1953

(Date)

OIL CONSERVATION COMMISSION  
SANTA FE, NEW MEXICO

Gentlemen:

You are hereby notified that it is our intention to commence the (Drilling) (Recompletion) of a well to be known as

El Paso Natural Gas Company

(Company or Operator)

Martin Pool Unit

(Lease)

, Well No. 1, in SW (Unit) The well is

located 1650 feet from the South line and 1650 feet from the West line of Section 34, T. 30N, R. 11W, NMPM.

(GIVE LOCATION FROM SECTION LINE) Artec Pool, San Juan County

If State Land the Oil and Gas Lease is No. Fee

If patented land the owner is D.A. Martin (SE 1/4 SW 1/4)

Address Artec, New Mexico

We propose to drill well with drilling equipment as follows: Rotary tools to the top of the P.C. formation, completing with cable tools.

The status of plugging bond is

Drilling Contractor El Paso Natural Gas Company

We intend to complete this well in the P. C.

formation at an approximate depth of 2190' feet.

CASING PROGRAM

We propose to use the following strings of Casing and to cement them as indicated:

Size of Hole	Size of Casing	Weight per Foot	New or Second Hand	Depth	Sacks Cement
<u>13 3/4</u>	<u>9 5/8</u>	<u>25.4</u>	<u>New</u>	<u>100'</u>	<u>75</u>
<u>7 7/8</u>	<u>5 1/2</u>	<u>15.5</u>	<u>New</u>	<u>2130'</u>	<u>150</u>

If changes in the above plans become advisable we will notify you immediately.

ADDITIONAL INFORMATION (If recompletion give full details of proposed plan of work.) It is intended to shoot the well with two quarts of S.N.G. per foot. Total Depth 2190'.

The SW 1/4 of Section 34 is dedicated to this well.

(1/2 SW 1/4 - SF 080956 - Murphy Corp.)

(SW 1/4 SE 1/4 - SF 043260 - A Murphy Corp.)

Approved \_\_\_\_\_, 19\_\_\_\_  
Except as follows:

Communitization will be filed as soon as possible  
Sincerely yours,

EL PASO NATURAL GAS COMPANY  
(Company or Operator)

By \_\_\_\_\_

Position Petroleum Engineer

Send Communications regarding well to

Name E. J. Coal

Address Box 997 Farmington, New Mexico

OIL CONSERVATION COMMISSION

By \_\_\_\_\_

Title \_\_\_\_\_

COMPANY EL PASO NATURAL GAS COMPANY

Well Name & No. Martin Pool Unit No. 1 Lease No. Fee

Location 1650 feet from the South line. 1650 feet from the West line.

Being in NE $\frac{1}{4}$  of the SW $\frac{1}{4}$

Sec. 34, T 30N., R 11W., N.M.P.M., San Juan County, New Mexico

Ground Elevation 5809.02

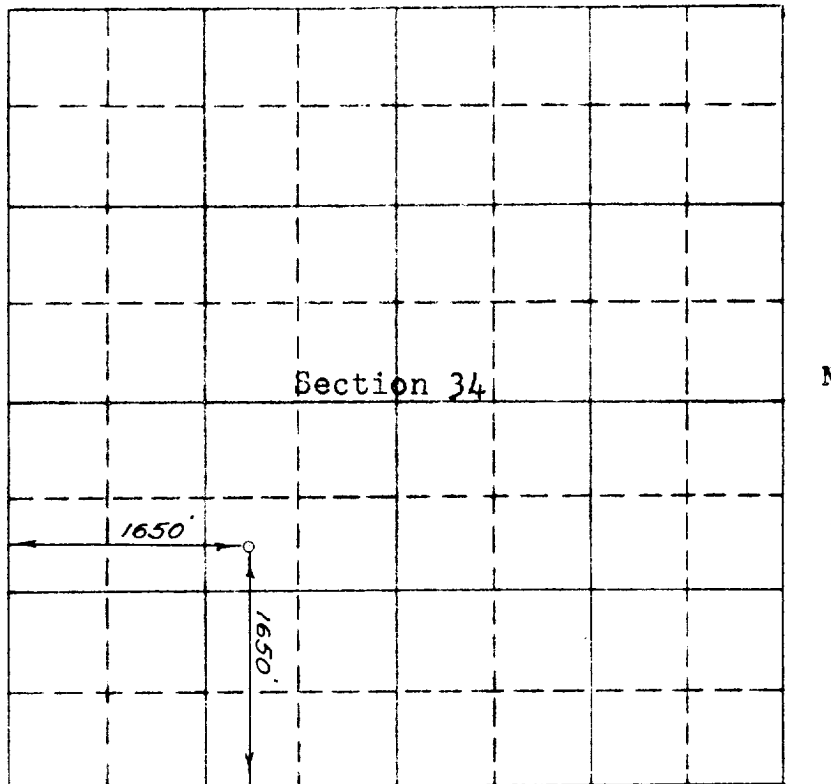

Scale -- 4 inches equals 1 mile

Surveyed April 4, 19 53

This is to certify that the above plat was prepared from field notes of actual surveys made by me or under my supervision and that the same are true and correct to the best of my knowledge and belief.

E. O. Walker  
Registered Professional  
Engineer and Land Surveyor.

Seal:

Farmington, New Mexico

OIL CONSERVATION COMMISSION		
AZTEC DISTRICT OFFICE		
No. Copies Received 7		
DISTRIBUTION		
	NO. FURNISHED	
Operator	2	
Santa Fe	1	
Proration Office		
State Land Office	1	
U. S. G. S.	2	
Transporter		
File	1	✓