

(SUBMIT IN TRIPLICATE)

UNITED STATES
DEPARTMENT OF THE INTERIOR
GEOLOGICAL SURVEY

Land Office Santa Fe
Lease No. 080597
Unit Gartner

SUNDRY NOTICES AND REPORTS ON WELLS

NOTICE OF INTENTION TO DRILL.....	<input checked="" type="checkbox"/>	SUBSEQUENT REPORT OF WATER SHUT-OFF.....
NOTICE OF INTENTION TO CHANGE PLANS.....		SUBSEQUENT REPORT OF SHOOTING OR ACIDIZING.....
NOTICE OF INTENTION TO TEST WATER SHUT-OFF.....		SUBSEQUENT REPORT OF ALTERING CASING.....
NOTICE OF INTENTION TO RE-DRILL OR REPAIR WELL.....		SUBSEQUENT REPORT OF RE-DRILLING OR REPAIR.....
NOTICE OF INTENTION TO SHOOT OR ACIDIZE.....		SUBSEQUENT REPORT OF ABANDONMENT.....
NOTICE OF INTENTION TO PULL OR ALTER CASING.....		SUPPLEMENTARY WELL HISTORY.....
NOTICE OF INTENTION TO ABANDON WELL.....		

RECEIVED
SEP 19 1961
U. S. GEOLOGICAL SURVEY
FARMINGTON, NEW MEXICO

(INDICATE ABOVE BY CHECK MARK NATURE OF REPORT, NOTICE, OR OTHER DATA)

September 19, 1961

Well No. 9 is located 1000 ft. from [N] line and 1090 ft. from [E] line of sec. 33
H.E. Section 33 30-N 8-W N.M.P.M.
 (1/4 Sec. and Sec. No.) (Twp.) (Range) (Meridian)
Basin Dakota San Juan New Mexico
 (Field) (County or Subdivision) (State or Territory)

RECEIVED
SEP 20 1961
OIL CON. COM.
DIST. 3

The elevation of the derrick floor above sea level is 6203 ft.

DETAILS OF WORK

(State names of and expected depths to objective sands; show sizes, weights, and lengths of proposed casings; indicate mudding jobs, cementing points, and all other important proposed work)

It is intended to ~~and~~ drill a well with rotary tools thru the Dakota formation. Possible productive intervals will be perforated and fractured. Est. T.D. 7540'.

Casing Program:

- 10 3/4" @ 280' with 220 sks cement circulated to surface.
- 4 1/2" @ 7537' with 2 stage tool 50' below base of Point Lookout & 3 stage tool 50' below base of Pictured Cliffs.
- 1st stage - 130 sks cement - 150% to cover 100' above Greenhorn.
- 2nd stage - 200 sks cement - 150% to cover 100' above Cliff House.
- 3rd stage - 340 sks cement - 135% to cover 100' above Fruitland.

The E/2 of Section 33 is dedicated to this well.

I understand that this plan of work must receive approval in writing by the Geological Survey before operations may be commenced.

Company El Paso Natural Gas Company
 Address Box 790
Farmington, New Mexico

By Original Signed D. W. Meehan
 Title Petroleum Engineer

NEW MEXICO OIL CONSERVATION COMMISSION

Well Location and Acreage Dedication Plat

Section A.

Date **April 18, 1961**

Operator **EL PASO NATURAL GAS COMPANY** Lease **GARTNER** SF **080597**
 Well No. **9** Unit Letter **A** Section **33** Township **30-N** Range **8-W** N.M.M. Line
 Located **1000** Feet From **NORTH** Line, **1090** Feet From **EAST** Line
 County **SAN JUAN** G. L. Elevation **6273** Dedicated Acreage **320** Acres
 Name of Producing Formation **DAKOTA** Pool **BASIN DAKOTA**

1. Is the Operator the only owner in the dedicated acreage outlined on the plat below?
 Yes ☒ No ☐
2. If the answer to question one is "no", have the interests of all the owners been consolidated by communitization agreement or otherwise? Yes ☐ No ☐ If answer is "yes", Type of Consolidation:

3. If the answer to question two is "no", list all the owners and their respective interests below:

Owner

Land Description

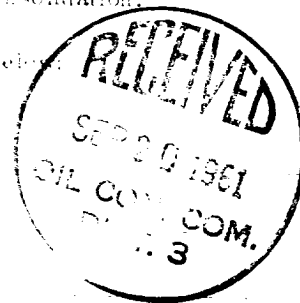

Section B.

This is to certify that the information in Section A above is true and complete to the best of my knowledge and belief.

El Paso Natural Gas Company
 Original Signed **D. W. Meehan**

(Representative)

Box 990

(Address)

Farmington, New Mexico

Note: All distances must be from outer boundaries of section.

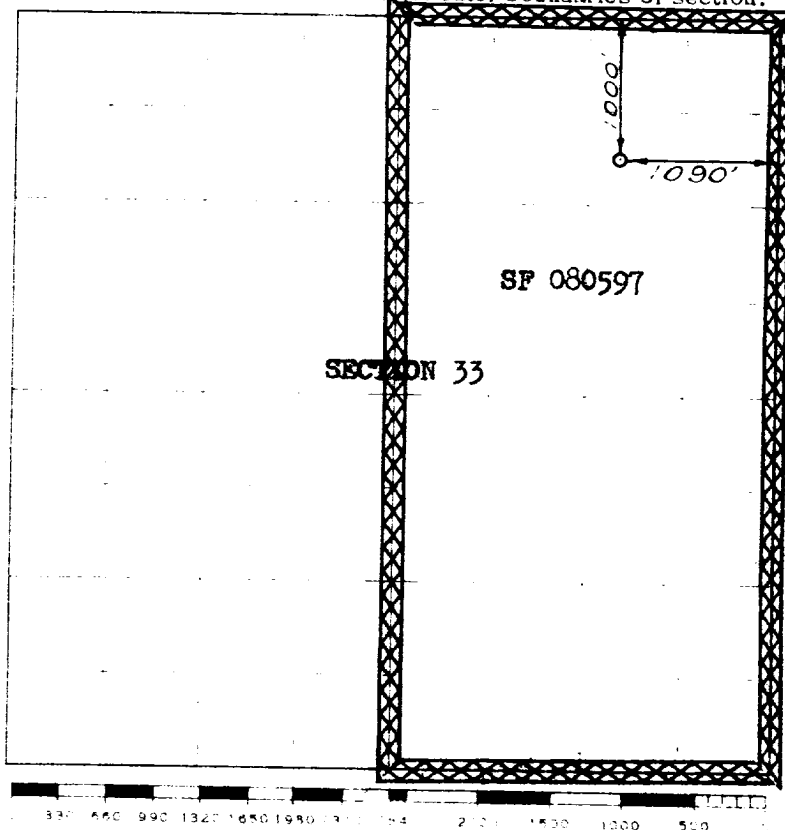

Scale 4 inches equal 1 mile

This is to certify that the above plat was prepared from field notes of actual surveys made by me or under my supervision and that the same are true and correct to the best of my knowledge and belief.

(Seal)

Date Surveyed **April 17, 1961**

David O. Villanueva
 Registered Professional Engineer and/or Land Surveyor

Farmington, New Mexico