

Company Don Traders, Inc.

Lease _____ Well No. _____

Sec. 25, T. 30 N., R. 12 W., N.M.P.M.

Location 890' from the South line and 990' from
the West line.

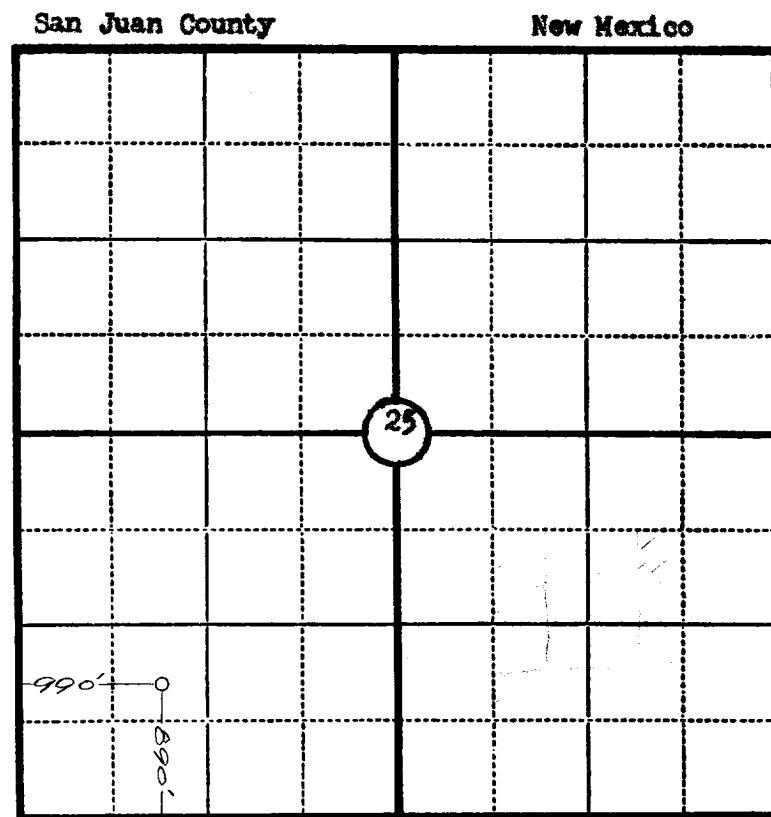

Scale—4 inches equal 1 mile.

This is to certify that the above plat was prepared from field notes of actual surveys made by me or under my supervision and that the same are true and correct to the best of my knowledge and belief.

Seal:

Registered Professional
Engineer and Land Surveyor.

Ernest V. Echohawk
N. Mex. Reg. No. 1545

Surveyed April 3, 19 53.

OIL CONSERVATION COMMISSION		
AZTEC DISTRICT OFFICE		
No. Copies Received <u>5</u>		
DISPOSITION		
	No. REMOVED	
Operator	<u>1</u>	
Auto Fr.	<u>1</u>	
Oil Field Office		
Oil Field Office		
U. S. O. S.	<u>2</u>	
Transporter		
File	<u>1</u>	<input checked="" type="checkbox"/>