

District I
P.O. Box 1980 Hobbs NM

District II
P.O. Drawer 10000, Santa Fe, NM 87505

District III
1000 R. 10000, Santa Fe, NM 87505

State of New Mexico
Energy, Minerals and Natural Resources Department

SUBMIT 1 COPY TO
APPROPRIATE
DISTRICT OFFICE
AND 1 COPY TO
SANTA FE OFFICE

OIL CONSERVATION DIVISION

2040 South Pacheco Street
Santa Fe, New Mexico 87505

JUL 18 1997

PIT REMEDIATION AND CLOSURE REPORT

Operator: PNM Gas Services, Questar Energy Telephone: 324-3764

Address: 603 W. Elm Street Farmington, NM 87401

Facility or Well Name: Federal A #1

Location: Unit: M Sec. 25 T. 30 N R. 13 W County San Juan

Pit Type: Separator Dehydrator ☒ Other

Land Type: BLM ☒ State Fee Other Loc for new High School

Pit Location: Pit dimensions: length 20 width 12 depth 20

(Attach diagram) Reference: wellhead ☒ other

Footage from reference: 186'

Direction from reference: 5 Degrees ☒ East North ☒
of
 West South

Depth to Ground Water:

(Vertical distance from contaminants to
seasonal high water elevation of ground
water)

Less than 50 feet (20 points)
50 feet to 99 feet (10 points)
Greater than 100 feet (0 points) 0

Wellhead Protection Area:

(Less than 200 feet from a private
domestic water source, or, less than 1,000
feet from all other water sources)

Yes (20 points)
No (0 points) 0

Distance to Surface Water:

(Horizontal distance to perennial lakes,
ponds, rivers, streams, creeks, irrigation
canals and ditches)

Less than 200 feet (20 points)
200 feet to 1,000 feet (10 points)
Greater than 1,000 feet (0 points) 0

RANKING SCORE (TOTAL POINTS): 0

RECEIVED
APR 24 1997

OIL CON. DIV.
DIST. 3

Date Remediation Started:		<u>11/19/96</u>		Date Completed:		<u>11/20/96</u>	
Remediation Method: (Check all appropriate sections)	Excavation	<u>X</u>	Approx. Cubic Yard		<u>713</u>		
	Landfarmed	<u>X</u>	Amount Landfarmed (cubic yds)		<u>593</u>		
	Other	<u></u>					
Remediation Location: (i.e., landfarmed onsite, name and location of offsite facility)		Onsite	<u>293 cu yds onsite</u>	Offsite	<u>300 cu yds offsite Federal A #1E 25-30N-13W.</u>		
Backfill Material Location: <u></u>							
General Description of Remedial Action: Excavated contaminated soil to pit size of 31'X27xX23' and landfarmed 293 cu yds soil onsite within a bermed area at a depth of 6" to 12". Soil was aerated by plowing until soil met regulatory levels. 300 cu yds landfarmed offsite. <u></u> <u></u> <u></u> <u></u>							
Ground Water Encountered: No <u>✓</u> Yes <u></u> Depth <u></u>							
Final Pit Closure Sampling:							
(if multiple samples, attach sample result and diagram of sample locations and depths.)	Sample Location		<u>5 pt composite-4 side walls and center of pit bottom</u>				
	Sample depth		<u>23'</u>				
	Sample date		<u>11/20/96</u>		Sample time		<u>10:20:00 AM</u>
	Sample Results						
	Benzene (ppm)		<u>0.0028</u>				
Total BTEX (ppm)		<u>0.1207</u>					
Field headspace (ppm)		<u></u>					
TPH		<u>< 5.00</u>	Method		<u>8015A</u>		
Vertical Extent (ft)		<u></u>		Risk Assessment form attached		Yes <u></u>	No <u>✓</u>
Ground Water Sample:		Yes <u></u>	No <u>✓</u>	(If yes, see attached Groundwater Site Summary Report)			
I HEREBY CERTIFY THAT THE INFORMATION ABOVE IS TRUE AND COMPLETE TO THE BEST OF MY KNOWLEDGE AND MY BELIEF DATE <u>April 28, 1997</u> SIGNATURE <u>Denver Bearden</u> PRINTED NAME AND TITLE <u>Denver Bearden Administrator III</u>							

Federal # A-1
Questar Energy Co.
Sec. 25, 30N, 13W
990' FSL + 1190 FUL

11/18/96

5° E of N

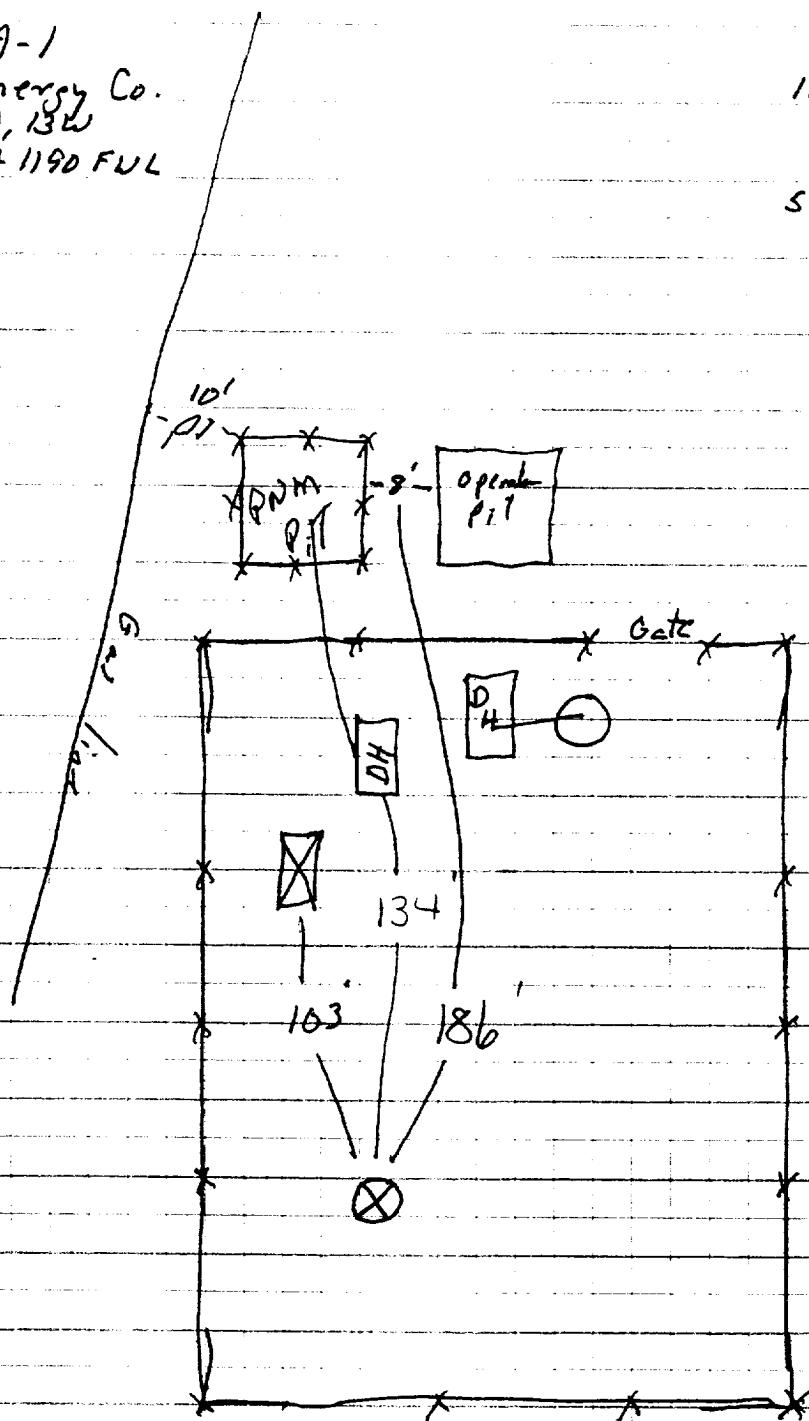

OFF: (505) 325-5667



LAB: (505) 325-1556

Diesel Range Organics

Attn: *Denver Bearden*
Company: *PNM Gas Services*
Address: *603 W. Elm*
City, State: *Farmington, NM 87401*

Date: *22-Nov-96*
COC No.: *5136*
Sample No. *12949*
Job No. *2-1000*

Project Name: *PNM Gas Services - Federal #A1*
Project Location: *9611201020; Pit Excavation Composite Sample*
Sampled by: *RH* Date: *20-Nov-96* Time: *10:20*
Analyzed by: *DC/HR* Date: *21-Nov-96*
Sample Matrix: *Soil*

Laboratory Analysis

<i>Parameter</i>	<i>Result</i>	<i>Unit of Measure</i>	<i>Detection Limit</i>	<i>Unit of Measure</i>
<i>Diesel Range Organics (C10 - C28)</i>	<i>< 5.0</i>	<i>mg/kg</i>	<i>5.0</i>	<i>mg/kg</i>

Quality Assurance Report

DRO QC No.: 0512-QC

Calibration Check

<i>Parameter</i>	<i>Method Blank</i>	<i>Unit of Measure</i>	<i>True Value</i>	<i>Analyzed Value</i>	<i>% Diff</i>	<i>Limit</i>
<i>Diesel Range (C10 - C28)</i>	<i>< 5.0</i>	<i>ppm</i>	<i>100</i>	<i>105</i>	<i>4.8</i>	<i>15%</i>

Matrix Spike

<i>Parameter</i>	<i>1 - Percent Recovered</i>	<i>2 - Percent Recovered</i>	<i>Limit</i>	<i>%RSD</i>	<i>Limit</i>
<i>Diesel Range (C10-C28)</i>	<i>109</i>	<i>107</i>	<i>(70-130)</i>	<i>1</i>	<i>20%</i>

Method - SW-846 EPA Method 8015A mod. - Nonhalogenated Volatile Hydrocarbons by Gas Chromatography

Approved by: 
Date: *11/22/96*

OFF: (505) 325-5667



LAB: (505) 325-1556

AROMATIC VOLATILE ORGANICS

Attn: *Denver Bearden*
Company: *PNM Gas Services*
Address: *603 W. Elm*
City, State: *Farmington, NM 87401*

Date: *22-Nov-96*
COC No.: *5136*
Sample No.: *12949*
Job No.: *2-1000*

Project Name: *PNM Gas Services - Federal #A1*
Project Location: *9611201020; Pit Excavation Composite Sample*
Sampled by: *RH* Date: *20-Nov-96* Time: *10:20*
Analyzed by: *DC* Date: *21-Nov-96*
Sample Matrix: *Soil*

Laboratory Analysis

Parameter	Result	Unit of Measure	Detection Limit	Unit of Measure
Benzene	2.8	ug/kg	0.2	ug/kg
Toluene	25.0	ug/kg	0.2	ug/kg
Ethylbenzene	4.4	ug/kg	0.2	ug/kg
m,p-Xylene	68.8	ug/kg	0.2	ug/kg
o-Xylene	19.7	ug/kg	0.2	ug/kg
	TOTAL	120.7		ug/kg

Method - SW-846 EPA Method 8020 Aromatic Volatile Organics by Gas Chromatography

Approved by: *DC*
Date: *11/22/96*

1-6-96

Federal # A-1

Questar

Sec. 25, 30N, 13W

LandFarm: On location

Composite sample # 9701061115

soil vapor head space PID reading = 33.6 ppm

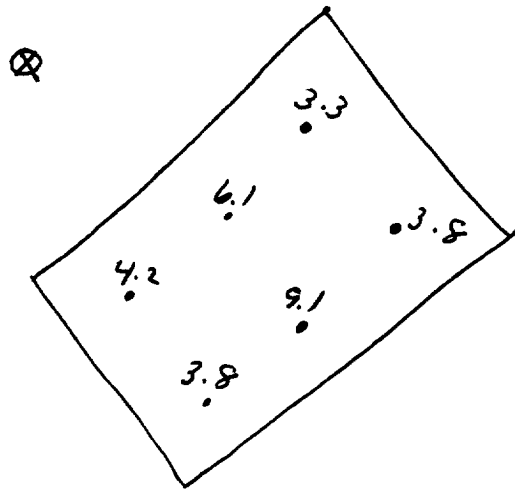

OFF: (505) 325-5667



LAB: (505) 325-1556

Diesel Range Organics

Attn: *Denver Bearden*
Company: *PNM Gas Services*
Address: *603 W. Elm*
City, State: *Farmington, NM 87401*

Date: *8-Jan-97*
COC No.: *5851*
Sample No. *13321*
Job No. *2-1000*

Project Name: *PNM Gas Services - Federal #A-1 Landfarm*
Project Location: *9701061115; 6pt. Composite, 2"-12" depth*
Sampled by: *GC* Date: *6-Jan-97* Time: *11:15*
Analyzed by: *HR* Date: *6-Jan-97*
Sample Matrix: *Soil*

Laboratory Analysis

<i>Parameter</i>	<i>Result</i>	<i>Unit of Measure</i>	<i>Detection Limit</i>	<i>Unit of Measure</i>
<i>Diesel Range Organics (C10 - C28)</i>	<i><5.0</i>	<i>mg/kg</i>	<i>5.0</i>	<i>mg/kg</i>

Quality Assurance Report

DRO QC No.: 0512-QC

Calibration Check

<i>Parameter</i>	<i>Method Blank</i>	<i>Unit of Measure</i>	<i>True Value</i>	<i>Analyzed Value</i>	<i>% Diff</i>	<i>Limit</i>
<i>Diesel Range (C10 - C28)</i>	<i><5.0</i>	<i>ppm</i>	<i>100</i>	<i>101</i>	<i>1.4</i>	<i>15%</i>

Matrix Spike

<i>Parameter</i>	<i>1 - Percent Recovered</i>	<i>2 - Percent Recovered</i>	<i>Limit</i>	<i>%RSD</i>	<i>Limit</i>
<i>Diesel Range (C10-C28)</i>	<i>98</i>	<i>100</i>	<i>(70-130)</i>	<i>1</i>	<i>20%</i>

Method - *SW-846 EPA Method 8015A mod. - Nonhalogenated Volatile Hydrocarbons by Gas Chromatography*

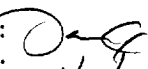
Approved by: 
Date: *1/8/97*

P.O. BOX 2606 • FARMINGTON, NM 87499

- TECHNOLOGY BLENDING INDUSTRY WITH THE ENVIRONMENT -

Federal A#1

1-6-98

Questar

Sec. 25, 30N, 13W

Land Farmed: Federal A#1E

Questar

Sec. 25, 30N, 13W

Composite sample # 9701061145

soil vapor headspace PID reading = 12.1 ppm

.50	.90
1.1	1.6
1.2	1.8

2"-12" depth

⊗

OFF: (505) 325-5667



LAB: (505) 325-1556

Diesel Range Organics

Attn: *Denver Bearden*
 Company: *PNM Gas Services*
 Address: *603 W. Elm*
 City, State: *Farmington, NM 87401*

Date: *8-Jan-97*
 COC No.: *5863*
 Sample No. *13326*
 Job No. *2-1000*

Project Name: *PNM Gas Services - Federal A #1 Landfarmed @ Federal A #1E*
 Project Location: *9701061145; 6pt. Composite, 2"-12" depth*
 Sampled by: *GC* Date: *6-Jan-97* Time: *11:45*
 Analyzed by: *HR* Date: *6-Jan-97*
 Sample Matrix: *Soil*

Laboratory Analysis

<i>Parameter</i>	<i>Result</i>	<i>Unit of Measure</i>	<i>Detection Limit</i>	<i>Unit of Measure</i>
<i>Diesel Range Organics (C10 - C28)</i>	<i><5.0</i>	<i>mg/kg</i>	<i>5.0</i>	<i>mg/kg</i>

Quality Assurance ReportDRO QC No.: *0512-QC****Calibration Check***

<i>Parameter</i>	<i>Method Blank</i>	<i>Unit of Measure</i>	<i>True Value</i>	<i>Analyzed Value</i>	<i>% Diff</i>	<i>Limit</i>
<i>Diesel Range (C10 - C28)</i>	<i><5.0</i>	<i>ppm</i>	<i>100</i>	<i>101</i>	<i>1.4</i>	<i>15%</i>

Matrix Spike

<i>Parameter</i>	<i>1- Percent Recovered</i>	<i>2- Percent Recovered</i>	<i>Limit</i>	<i>%RSD</i>	<i>Limit</i>
<i>Diesel Range (C10-C28)</i>	<i>98</i>	<i>100</i>	<i>(70-130)</i>	<i>1</i>	<i>20%</i>

Method - SW-846 EPA Method 8015A mod. - Nonhalogenated Volatile Hydrocarbons by Gas Chromatography

Approved by: *[Signature]*
 Date: *1/8/97*

P.O. BOX 2606 • FARMINGTON, NM 87499

- TECHNOLOGY BLENDING INDUSTRY WITH THE ENVIRONMENT -