

Company Nelson and Edward Morris, Ltd and A.M. Lloyd

Lease Payne Well No. 1

Sec. 26 T. 30 N., R. 11 W., N.M.P.M.

Location 1650' from the S. line & 990' from the W. line

San Juan County New Mexico

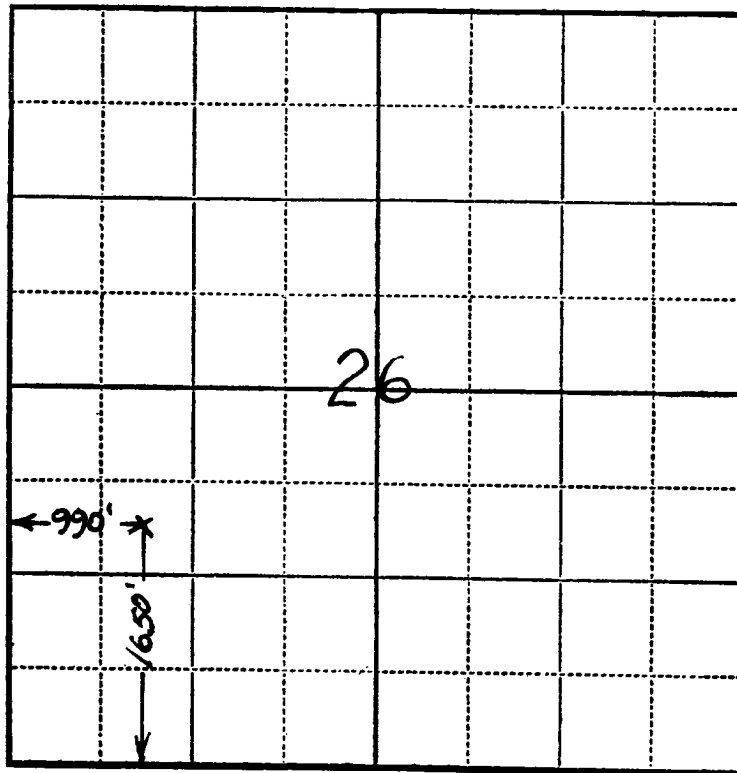

Scale—4 inches equals 1 mile.

REMARKS:

This is to certify that the above plat was prepared from field notes of actual surveys made by me or under my supervision and that the same are true and correct to the best of my knowledge and belief.

Seal:

John Payne
Registered Professional
Engineer and Land Surveyor.

Farmington, New Mexico

Surveyed on the day of October 14th of 1956