

(SUBMIT IN TRIPLICATE)

UNITED STATES
DEPARTMENT OF THE INTERIOR
GEOLOGICAL SURVEY

Land Office Santa Fe
Lease No. N.M. 02150
Unit 1

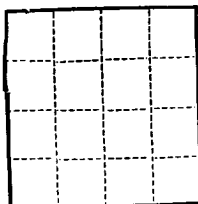

SUNDRY NOTICES AND REPORTS ON WELLS

RECEIVED

MAY 13 1960

| | | | |
|--|-------------------------------------|--|--|
| NOTICE OF INTENTION TO DRILL | <input checked="" type="checkbox"/> | SUBSEQUENT REPORT OF WATER SHUT-OFF | |
| NOTICE OF INTENTION TO CHANGE PLANS | | SUBSEQUENT REPORT OF SHOOTING OR ACIDIZING | |
| NOTICE OF INTENTION TO TEST WATER SHUT-OFF | | SUBSEQUENT REPORT OF ALTERING CASING | |
| NOTICE OF INTENTION TO RE-DRILL OR REPAIR WELL | | SUBSEQUENT REPORT OF RE-DRILLING OR REPAIR | |
| NOTICE OF INTENTION TO SHOOT OR ACIDIZE | | SUBSEQUENT REPORT OF ABANDONMENT | |
| NOTICE OF INTENTION TO PULL OR ALTER CASING | | SUPPLEMENTARY WELL HISTORY | |
| NOTICE OF INTENTION TO ABANDON WELL | | | |

(INDICATE ABOVE BY CHECK MARK NATURE OF REPORT, NOTICE, OR OTHER DATA)

Federal-FC

May 11, 1960

Well No. 2-30 is located 2320 ft. from N line and 130 ft. from W line of Section

SW 1/4 sec. 30 30 N 11 W N.M.P.
(1/4 Sec. and Sec. No.) (Twp.) (Range) (Meridian)
Unincorporated Agua Fria San Juan New Mexico
(Field) (County or Subdivision) (State or Territory)

The elevation of the drinking tank above sea level is 5698 ft. 2

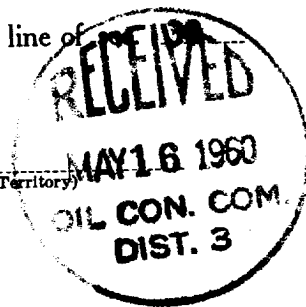

DETAILS OF WORK

(State names of and expected depths to objective sands; show sizes, weights, and lengths of proposed casings; indicate mudding jobs, cementing points, and all other important proposed work)

We propose to drill this well to 1350 ft. to test the Farmington sand.
We will drill a 12" hole to approximately 60 ft. and set 8-5/8" cas.
and circulate neat cement. If production is encountered we will set
5-1/2" cas thru the pay zone cemented with 100 lbs reg. neat cement.

I understand that this plan of work must receive approval in writing by the Geological Survey before operations may be commenced.

Company JOHN M. TRIDG
Address P. O. Box 5629
Hoswell, New Mexico

By [Signature]
Title Production Superintendent

NEW MEXICO OIL CONSERVATION COMMISSION
WELL LOCATION AND ACREAGE DEDICATION PLAT

FORM C-128
 Revised 5/1/57

SEE INSTRUCTIONS FOR COMPLETING THIS FORM ON THE REVERSE SIDE

SECTION A

| | | | | | |
|---|----------------------|------------------------------|-------------------------|---------------------------------------|--|
| Operator JOHN H. TRIGG | | Lease FEDERAL P.C. | | Well No. 2 - 30 | |
| Unit Letter E | Section 30 | Township 30 NORTH | Range 11 WEST | County SAN JUAN | |
| Actual Footage Location of Well: 2310 feet from the NORTH line and 330 feet from the WEST line | | | | | |
| Ground Level Elev. 5698.0 | Producing Formation | Pool | | Dedicated Acreage: 40 Acres | |

Ref: GLO plat dated 7 April 1881

1. Is the Operator the only owner in the dedicated acreage outlined on the plat below? YES _____ NO _____. ("Owner" means the person who has the right to drill into and to produce from any pool and to appropriate the production either for himself or for himself and another. (65-3-29 (e) NMSA 1935 Comp.)
2. If the answer to question one is "no," have the interests of all the owners been consolidated by community agreement or otherwise? YES _____ NO _____. If answer is "yes," Type of Consolidation _____
3. If the answer to question two is "no," list all the owners and their respective interests below:

| Owner | Land Description |
|-------|------------------|
| | |

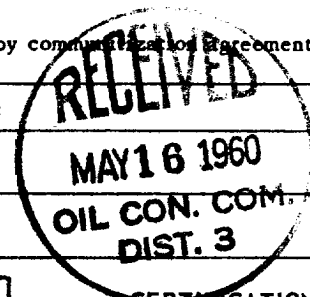

SECTION B

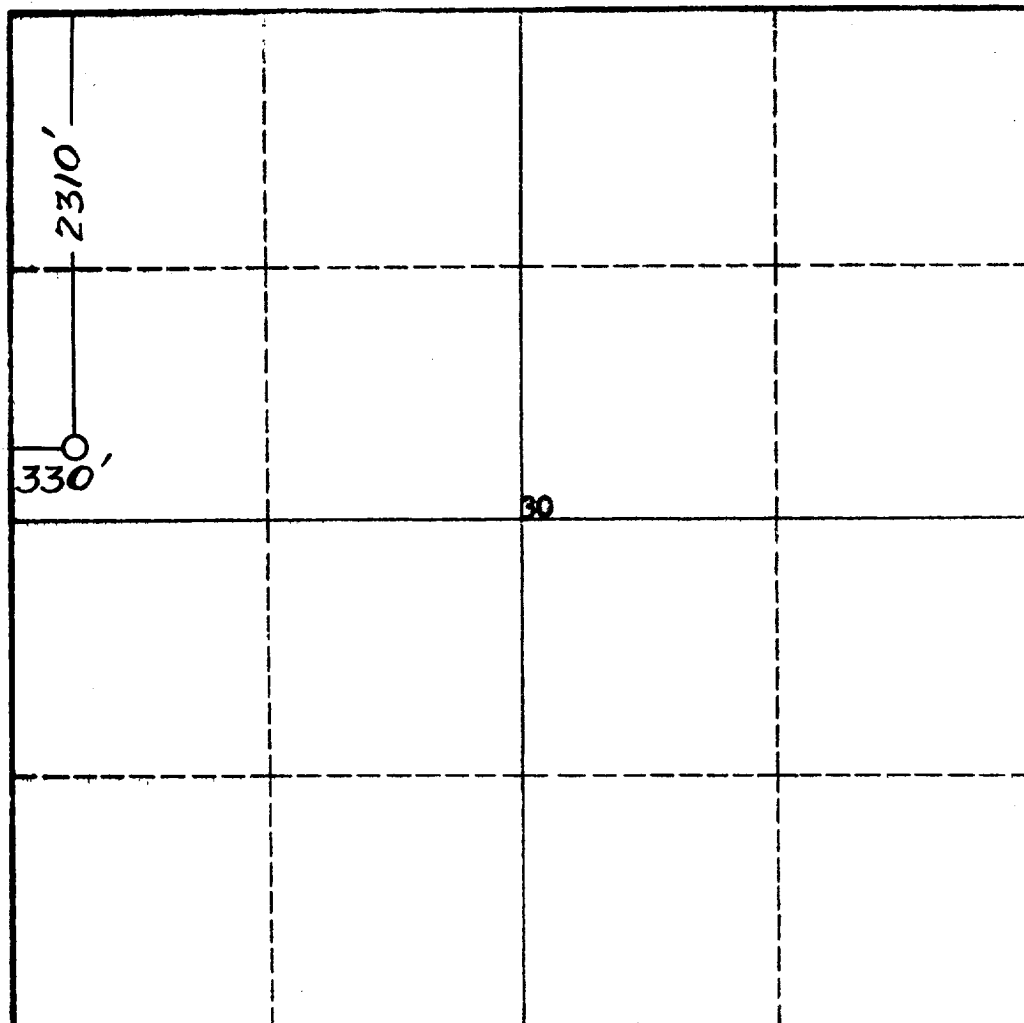

CERTIFICATION

I hereby certify that the information in SECTION A above is true and complete to the best of my knowledge and belief.

Name _____
 Position _____
 Company _____
 Date **5-13-60**

I hereby certify that the well location shown on the plat in SECTION B was plotted from field notes of actual surveys made by me or under my supervision, and that the same is true and correct to the best of my knowledge and belief.

Date Surveyed **12 May 1960**
 Registered Professional Engineer and/or Land Surveyor

 Certificate No. **1463**

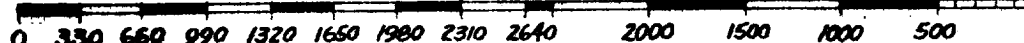

INSTRUCTIONS FOR COMPLETION OF FORM C-128

1. Operator shall furnish and certify to the information called for in Section A.
2. Operator shall outline the dedicated acreage for *both* oil and gas wells on the plat in Section B.
3. A registered professional engineer or land surveyor registered in the State of New Mexico or approved by the Commission shall show on the plat the location of the well and certify this information in the space provided.
4. All distances shown on the plat must be from the outer boundaries of the Section.
5. If additional space is needed for listing owners and their respective interests as required in question 3 of Section A, please use space below.