

(SUBMIT IN TRIPLICATE)

UNITED STATES
DEPARTMENT OF THE INTERIOR
GEOLOGICAL SURVEY

Budget Bureau No. 42-R358.4.
Approval expires 12-31-60.

Land Office **Santa Fe**

Lease No. **SF 078198**

Unit **NE/4 Sec. 25, T30N, R11W,**
San Juan Co., New Mexico

SUNDRY NOTICES AND REPORTS ON WELLS

NOTICE OF INTENTION TO DRILL.....	<input checked="" type="checkbox"/>	SUBSEQUENT REPORT OF WATER SHUT-OFF.....
NOTICE OF INTENTION TO CHANGE PLANS.....	<input type="checkbox"/>	SUBSEQUENT REPORT OF SHOOTING OR ACIDIZING.....
NOTICE OF INTENTION TO TEST WATER SHUT-OFF.....	<input type="checkbox"/>	SUBSEQUENT REPORT OF ALTERING CASING.....
NOTICE OF INTENTION TO RE-DRILL OR REPAIR WELL.....	<input type="checkbox"/>	SUBSEQUENT REPORT OF RE-DRILLING OR REPAIR.....
NOTICE OF INTENTION TO SHOOT OR ACIDIZE.....	<input type="checkbox"/>	SUBSEQUENT REPORT OF ABANDONMENT.....
NOTICE OF INTENTION TO PULL OR ALTER CASING.....	<input type="checkbox"/>	SUPPLEMENTARY WELL HISTORY.....
NOTICE OF INTENTION TO ABANDON WELL.....	<input type="checkbox"/>	

(INDICATE ABOVE BY CHECK MARK NATURE OF REPORT, NOTICE, OR OTHER DATA)

RECEIVED

JUL 5 1957

U. S. GEOLOGICAL SURVEY
FARMINGTON, NEW MEXICO

July 1, 1957

Well No. **1-A Albright** is located **990** ft. from **[N]** line and **990** ft. from **[E]** line of sec. **25**
NE/4 NE/4 Section 25 **30N** **11W** **N.M.P.M.**
(1/4 Sec. and Sec. No.) (Twp.) (Range) (Meridian)
Artec Pictured Cliffs **San Juan County** **New Mexico**
(Field) (County or Subdivision) (State or Territory)

The elevation of the derrick floor above sea level is ft. **To be determined.**

DETAILS OF WORK

(State names of and expected depths to objective sands; show sizes, weights, and lengths of proposed casings; indicate mudding jobs, cementing points, and all other important proposed work)

The objective sand is the Pictured Cliffs formation anticipated at approximately 2625'.

Proposed Casing Program: 125' 9-5/8" J-55 cemented to surface
2675' 5-1/2" J-55 cemented with 150 sacks

Rotary Tools will be employed using mud from surface to T.D.

The well will be sand fraced in an effort to stimulate production

I understand that this plan of work must receive approval in writing by the Geological Survey before operations may be commenced.

Company **Southern Union Gas Company**

Address **1001 Burt Building**

Dallas, Texas

By

L.S. Muennink

Title **Exploration Engineer**

NEW MEXICO OIL CONSERVATION COMMISSION
Well Location and Acreage Dedication Plat

Section A.

Date July 1, 1957

Operator SOUTHERN UNION GAS COMPANY Lease Albright
Well No. 1-A Unit Letter A Section 25 Township 30 NORTH Range 11 WEST NMPM
Located 990 Feet From the NORTH Line, 990 Feet From the EAST Line
County SAN JUAN G. L. Elevation to be determined Dedicated Acreage 150 Acres
Name of Producing Formation Pictured Cliffs Pool Artes F. C.

1. Is the Operator the only owner* in the dedicated acreage outlined on the plat below?
Yes _____ No XX.
2. If the answer to question one is "no," have the interests of all the owners been consolidated by communitization agreement or otherwise? Yes XX No _____. If answer is "yes," Type of Consolidation Communitization Agreement
3. If the answer to question two is "no," list all the owners and their respective interests below:

Owner

Land Description

Section B

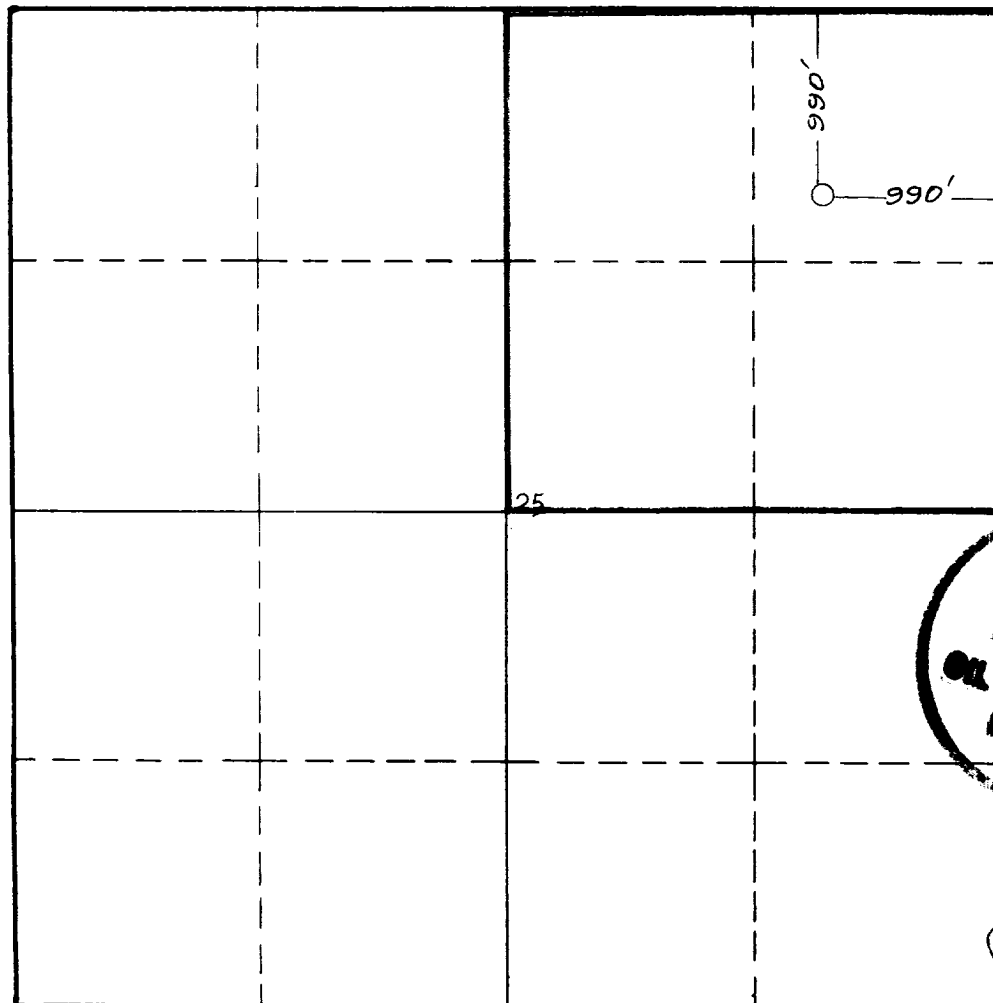

This is to certify that the information in Section A above is true and complete to the best of my knowledge and belief.

Southern Union Gas Company
(Operator)

L. H. McNeill
L. Representative

1001 Bart Bldg., Dallas, Texas
Address

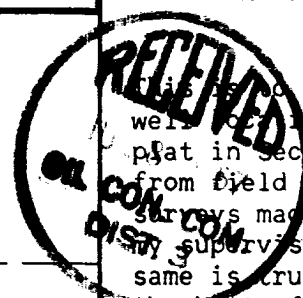

This is to certify that the well location shown on the plat in Section B was plotted from field notes of actual surveys made by me or under my supervision and that the same is true and correct to the best of my knowledge and belief.

Date Surveyed 16 JUNE 1957

James P. Leese
Registered Professional
Engineer and/or Land Surveyor.

James P. Leese
Certificate No. 1463

INSTRUCTIONS FOR COMPLETION:

1. Operator shall furnish and certify to the information called for in Section A.
2. Operator shall outline the dedicated acreage for both oil and gas wells on the plat in Section B.
3. A registered professional engineer or land surveyor registered in the State of New Mexico or approved by the Commission shall show on the plat the location of the well and certify this information in the space provided.
4. All distances shown on the plat must be from the outer boundaries of Section.
5. If additional space is needed for listing owners and their respective interests as required in question 3, Section A, please use space below

* "Owner" means the person who has the right to drill into and to produce from any pool and to appropriate the production either for himself or for himself and another. (65-3-29 (e) NMSA 1953 Comp.)