

NEW MEXICO OIL CONSERVATION COMMISSION
Santa Fe, New Mexico

Form C-101
Revised (12/1/55)

NOTICE OF INTENTION TO DRILL

Notice must be given to the District Office of the Oil Conservation Commission and approval obtained before drilling or recompletion begins. If changes in the proposed plan are considered advisable, a copy of this notice showing such changes will be returned to the sender. Submit this notice in QUINTUPLICATE. One copy will be returned following approval. See additional instructions in Rules and Regulations of the Commission. If State Land submit 6 Copies Attach Form C- 128 in triplicate to first 3 copies of form C-101

Farmington, New Mexico

(Place)

December 22, 1960

(Date)

OIL CONSERVATION COMMISSION
SANTA FE, NEW MEXICO

Gentlemen:

You are hereby notified that it is our intention to commence the Drilling of a well to be known as

~~XXXXXXXXXXXX~~ J. Glenn Turner

(Company or Operator)

Osborn

(Lease)

Well No. 1-22

in Unit M

(Unit)

The well is

located 900 feet from the West line and 790 feet from the

South

line of Section 22, T30-North, R 12-West, NMPM.

(GIVE LOCATION FROM SECTION LINE)

Basin Dakota

Pool,

San Juan

County

If State Land the Oil and Gas Lease is No.

If patented land the owner is Eldridge A. Osborn and wife

Address Flora Vista, New Mexico

We propose to drill well with drilling equipment as follows: Rotary rig. Complete with cable tools.

The status of plugging bond is On file in Santa Fe.

Drilling Contractor Great Western Drilling Co.

We intend to complete this well in the Dakota formation at an approximate depth of 6750 feet.

CASING PROGRAM

We propose to use the following strings of Casing and to cement them as indicated:

Size of Hole	Size of Casing	Weight per Foot	New or Second Hand	Depth	Sacks Cement
<u>12-1/4</u>	<u>8-5/8</u>	<u>24#</u>	<u>J-55 - new</u>	<u>32- 350</u>	<u>225</u>
<u>7-7/8</u>	<u>5-1/2</u>	<u>15.5#</u>	<u>J-55 new</u>	<u>6750</u>	<u>200</u>

If changes in the above plans become advisable we will notify you immediately.

ADDITIONAL INFORMATION (If recompletion give full details of proposed plan of work.)

Approved 12-23, 19 60
Except as follows:

Sincerely yours,

J. GLENN TURNER

(Company or Operator)

By

Position C. Beeson Neal, Agent in Farmington

Send Communications regarding well to

Name C. Beeson Neal

Address Box 728 - Farmington, New Mexico.

OIL CONSERVATION COMMISSION

By



NEW MEXICO OIL CONSERVATION COMMISSION
Well Location and Acreage Dedication Plat

Section A.

Date December 22, 1960

Operator J. GLENN TURNER Lease TURNER-OSBORN
Well No. 1-22 Unit Letter M Section 22 Township 30 N Range 12 W N.M.P.M.
Located 790 Feet From south Line, 900 Feet From west Line
County San Juan G. L. Elevation 5491 Dedicated Acreage 320 Acres
Name of Producing Formation Dakota Pool Basin Dakota

1. Is the Operator the only owner* in the dedicated acreage outlined on the plat below?
Yes _____ No x _____.
2. If the answer to question one is "no," have the interests of all the owners been consolidated by communitization agreement or otherwise? Yes x No _____. If answer is "yes," Type of Consolidation Pooled acreage
3. If the answer to question two is "no," list all the owners and their respective interests below:

Owner

Land Description

Section B

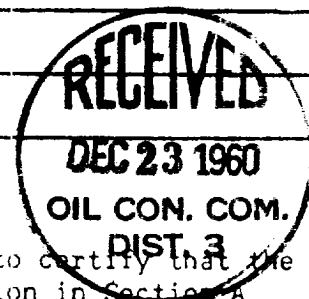
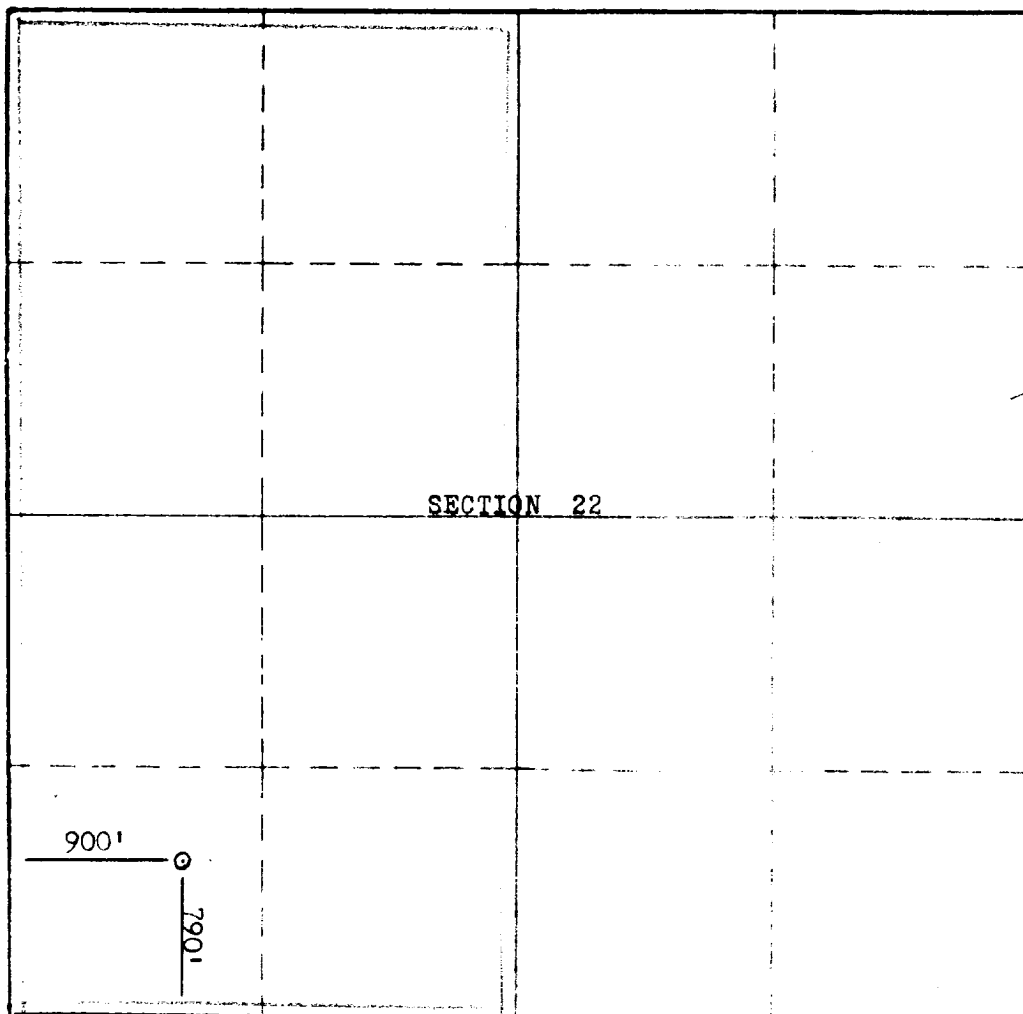

This is to certify that the information in Section A above is true and complete to the best of my knowledge and belief.

J. GLENN TURNER

(Operator)

(Representative)

C. Eason Neal

Agent in Farmington

Address

Box 728

Farmington, New Mexico.

This is to certify that the well location shown on the plat in Section B was plotted from field notes of actual surveys made by me or under my supervision and that the same is true and correct to the best of my knowledge and belief.

Date Surveyed Oct. 22, 1960

STEPHEN H. KIN

Registered Professional Engineer and/or Land Surveyor.

Certificate No. 803