

3-000

NUMBER OF COPIES RECEIVED		3
DISTRIBUTION		
SANTA FE		
FILE		
U.S.G.S		
LAND OFFICE		
TRANSPORTER	OIL	
	GAS	
PRODUCTION OFFICE		
OPERATOR		

2-EPNG, El Paso &amp; Farm.

1-International

1-F

NEW MEXICO OIL CONSERVATION COMMISSION

FORM C-103  
(Rev 3-55)

## MISCELLANEOUS REPORTS ON WELLS

(Submit to appropriate District Office as per Commission Rule 1106)

Name of Company

Beta Development Co.

Address

234 Petr. Club Plaza, Farmington, N. M.

Lease

Cedar Hill

Well No.

1

Unit Letter

M

Section

24

Township

30 N

Range

11 W

Date Work Performed

Pool

Basin Dakota

County

San Juan

THIS IS A REPORT OF: (Check appropriate block)

☐ Beginning Drilling Operations☐ Casing Test and Cement Job☒ Other (Explain):☐ Plugging☐ Remedial Work

Detailed account of work done, nature and quantity of materials used, and results obtained.

Notice filed to correct ground level elevation from 6128.0' to 6143.4'

Witnessed by

Position

Company

## FILL IN BELOW FOR REMEDIAL WORK REPORTS ONLY

## ORIGINAL WELL DATA

D F Elev.	T D	P B T D	Producing Interval	Completion Date
Tubing Diameter	Tubing Depth	Oil String Diameter	Oil String Depth	
Perforated Interval(s)				
Open Hole Interval		Producing Formation(s)		

## RESULTS OF WORKOVER

Test	Date of Test	Oil Production BPD	Gas Production MCFPD	Water Production BPD	GOR Cubic feet/Bbl	Gas Well Potential MCFPD
Before Workover						
After Workover						

OIL CONSERVATION COMMISSION

I hereby certify that the information given above is true and complete to the best of my knowledge.

Approved by Original Signed By  
A. R. KENDRICKOriginal signed by:  
Name JOHN T. HAMPTON

Title PETROLEUM ENGINEER DIST. NO. 3

Position  
Manager

Date

MAR 17 1964

Company

Beta Development Co.

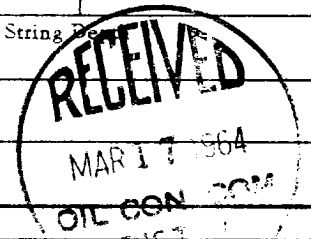

## NEW MEXICO OIL CONSERVATION COMMISSION

## Well Location and Acreage Dedication Plat

## Section A.

Date March 12, 1964

Operator BETA DEVELOPMENT CORPORATION Lease Cedar Mill  
 Well No. 1 Unit Letter M Section 24 Township 30 NORTH Range 11 WEST, NMPM  
 Located 1190 Feet From SOUTH Line, 1190 Feet From WEST Line  
 County SAN JUAN G. L. Elevation 6143.4 Dedicated Acreage W/320 Acres  
 Name of Producing Formation Dakota Pool Basin Dakota

1. Is the Operator the only owner in the dedicated acreage outlined on the plat below?

Yes X No

2. If the answer to question one is "no", have the interests of all the owners been consolidated by communitization agreement or otherwise? Yes No. If answer is "yes", Type of Consolidation.

3. If the answer to question two is "no", list all the owners and their respective interests below:

Owner

Land Description

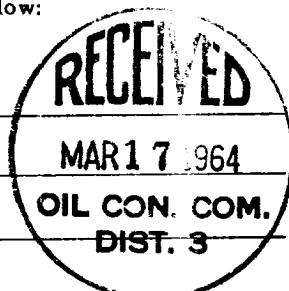
This plat is filed to correct ground level elevation.

## Section B.

Note: All distances must be from outer boundaries of section.

This is to certify that the information  
 in Section A above is true and complete  
 to the best of my knowledge and belief.

Beta Development Co.

Original signed by: JOHN T. HAMPTON Manager  
 (Representative)

234 Petr. Club Plaza

(Address)  
Farmington, New Mexico

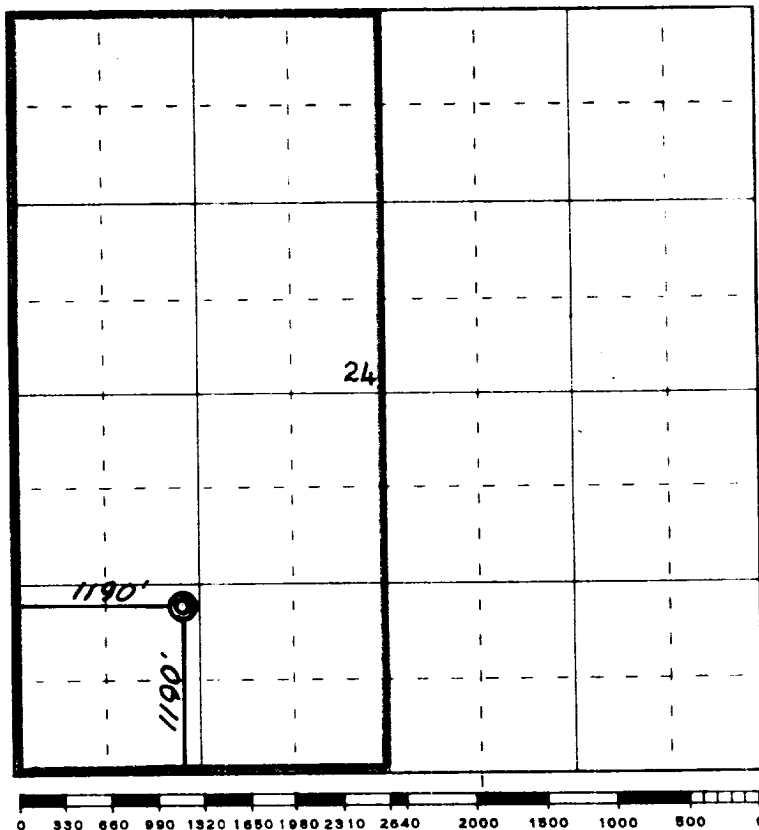

Scale 4 inches equal 1 mile



This is to certify that the above plat was prepared from field notes of actual surveys  
 made by me or under my supervision and that the same are true and correct to the best  
 of my knowledge and belief.

Date Surveyed 28 January 1964

James A. Lease  
 Registered Professional Engineer and/or Land Surveyor