

NUMBER OF COPIES RECEIVED	
DISTRIBUTION	
SANTA FE	
FILE	
U.S.G.S.	
LAND OFFICE	
TRANSPORTER	OIL GAS
PRODUCTION OFFICE	
OPERATOR	

6-OCC, 2-EPNG, El Paso, Farm. 1-F
NEW MEXICO OIL CONSERVATION COMMISSION
 Santa Fe, New Mexico

Form C-101
 Revised (12/1/55)

NOTICE OF INTENTION TO DRILL

Notice must be given to the District Office of the Oil Conservation Commission and approval obtained before drilling or recompletion begins. If changes in the proposed plan are considered advisable, a copy of this notice showing such changes will be returned to the sender. Submit this notice in **QUINTUPLICATE**. One copy will be returned following approval. See additional instructions in Rules and Regulations of the Commission. If State Land submit 6 Copies Attach Form C-128 in triplicate to first 3 copies of form C-101

Farmington, New Mexico

January 2, 1964

(Place)

(Date)

OIL CONSERVATION COMMISSION
SANTA FE, NEW MEXICO

Gentlemen:

You are hereby notified that it is our intention to commence the Drilling of a well to be known as
Beta Development Co.

(Company or Operator)

Frame

(Lease)

Well No. **1**, in **J** (Unit)

located **1640** feet from the **South** line and **1720** feet from the **East** line of Section **21**, T. **30 N**, R. **11 W**, NMPM.

(GIVE LOCATION FROM SECTION LINE) **Basin Dakota** Pool, **San Juan** County

D	C	B	A
E	F	G	H
L	K	J	I
M	N	O	P

If State Land the Oil and Gas Lease is No.

If patented land the owner is **Margurite Sullivan Frame**

Address **Hesperus, Colorado**

We propose to drill well with drilling equipment as follows:

Rotary rig to total depth

The status of plugging bond is **10,000 on file**

Drilling Contractor **Loffland Brothers Company**

We intend to complete this well in the **Dakota** formation at an approximate depth of **6750'** feet.

CASING PROGRAM

We propose to use the following strings of Casing and to cement them as indicated:

Size of Hole	Size of Casing	Weight per Foot	New or Second Hand	Depth	Sacks Cement
12 1/4"	8 5/8"	24#	New	300'	175 sx
7 7/8"	4 1/2"	10.5#	New	6750'	1st stage 150 sx
					2nd stage 1000 cu. ft.

If changes in the above plans become advisable we will notify you immediately.

ADDITIONAL INFORMATION (If recompletion give full details of proposed plan of work.)

Approved
 Except as follows:

Sincerely yours,

Beta Development Co.

Original signed by Company or Operator:

By **JOHN T. HAMPTON**

Position **Manager**

Send Communications regarding well to

Name **Beta Development Co.**

Address **234 Petr. Club Plaza, Farmington, N. M.**

OIL CONSERVATION COMMISSION

By *[Signature]*

NEW MEXICO OIL CONSERVATION COMMISSION

Well Location and Acreage Dedication Plat

Section A.

Date January 2, 1964

Operator THE BETA DEVELOPMENT CORPORATION Lease Frame
 Well No. 1 Unit Letter J Section 21 Township 30 NORTH Range 11 WEST NMPM
 Located 1640 Feet From the SOUTH Line, 1720 Feet From the EAST Line
 County SAN JUAN G. L. Elevation 5792.7 Dedicated Acreage S/320 Acres
 Name of Producing Formation Dakota Pool Basin Dakota

1. Is the Operator the only owner in the dedicated acreage outlined on the plat below?

Yes ☒ No ☒2. If the answer to question one is "no", have the interests of all the owners been consolidated by communitization agreement or otherwise? Yes _____ No ☒ If answer is "yes", Type of Consolidation.

Operator owns 100% working interest, royalty interest to be communitized. Royalty owners

2. If the answer to question two is "no", list all the owners and their respective interests below: listed below.

OwnerLand DescriptionMargurite Sullivan FrameN/2 SE/4, NE/4 SW/4, 120 acresMyron FifieldW/2 SW/4, 80 acresFederalS/2 SE/4, SE/4 SW/4, 120 acres

Section B.

This is to certify that the information
 in Section A above is true and complete
 to the best of my knowledge and belief.

Beta Development Co.Original signatoryJOHN T. HAMPTON Manager(Representative)234 Petr. Club Plaza(Address)Farmington, New Mexico

Note: All distances must be from outer boundaries of section.

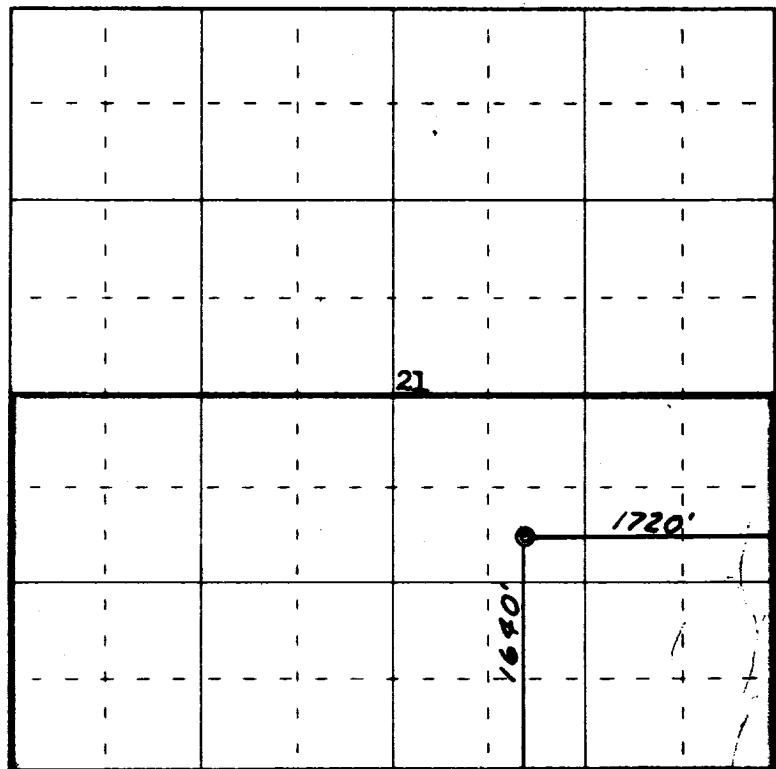

0 330 660 990 1320 1650 1980 2310 2640 2000 1500 1000 500 0

Scale 4 inches equal 1 mile



This is to certify that the above plat was prepared from field notes of actual surveys
 made by me or under my supervision and that the same are true and correct to the best
 of my knowledge and belief.

Date Surveyed 2 January, 1964

Registered Professional Engineer and/or Land Surveyor

