

NEW MEXICO OIL CONSERVATION COMMISSION

Well Location and Acreage Dedication Plat

Section A.

Date March 18, 1959

Operator Elliott Production Company Lease Mary C. Hagwood
Well No. 1 Unit Letter Section 24 Township 30 North Range 14 West NMPM
Located 1050 Feet From North Line, 1040 Feet From East Line
County San Juan G. L. Elevation 5859 Dedicated Acreage 320 Acres
Name of Producing Formation Dakota Pool Undesignated

1. Is the Operator the only owner* in the dedicated acreage outlined on the plat below?
Yes x No .
2. If the answer to question one is "no," have the interests of all the owners been consolidated by communitization agreement or otherwise? Yes No . If answer is "yes,"
Type of Consolidation
3. If the answer to question two is "no," list all the owners and their respective interests below:

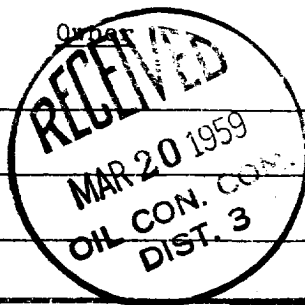

Land Description

Section B

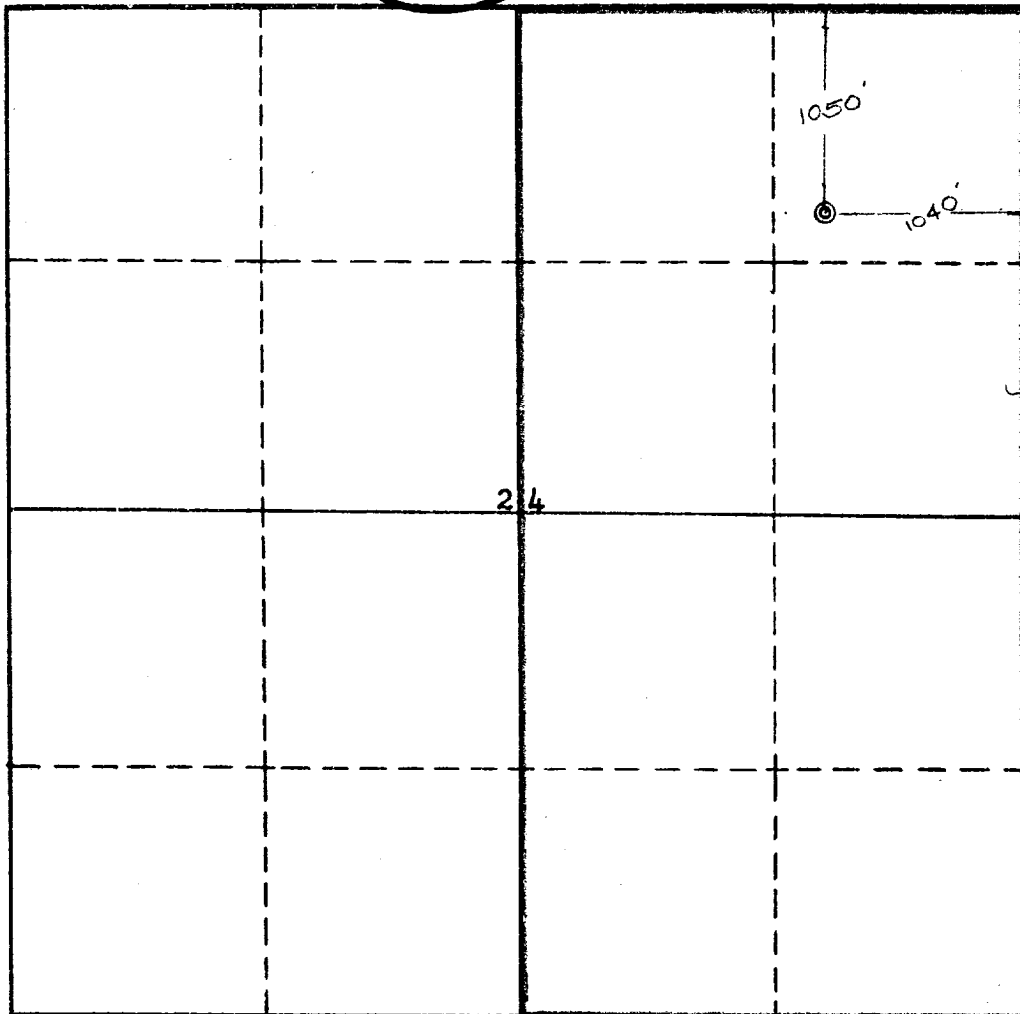

This is to certify that the information in Section A above is true and complete to the best of my knowledge and belief.

ELLIOTT PRODUCTION COMPANY

(Operator)

[Signature]
(Representative)

Box 5669, Roswell, New Mexico
Address

This is to certify that the well location shown on the plat in Section B was plotted from field notes and actual surveys made by me or under my supervision, and that the same is true and correct to the best of my knowledge and belief.

Date Surveyed Feb. 27, 1959

[Signature]
Ernest V. Echohawk
Registered Land Surveyor.

Certificate No. 1545