

NEW MEXICO OIL CONSERVATION COMMISSION
Santa Fe, New Mexico

Form C-101
Revised (12/1/55)

NOTICE OF INTENTION TO DRILL

Notice must be given to the District Office of the Oil Conservation Commission and approval obtained before drilling or recompletion begins. If changes in the proposed plan are considered advisable, a copy of this notice showing such changes will be returned to the sender. Submit this notice in QUINTUPPLICATE. One copy will be returned following approval. See additional instructions in Rules and Regulations of the Commission. If State Land submit 6 Copies Attach Form C-128 in triplicate to first 3 copies of form C-101

Albuquerque, New Mexico

June 6, 1957

(Place)

(Date)

OIL CONSERVATION COMMISSION
SANTA FE, NEW MEXICO

Gentlemen:

You are hereby notified that it is our intention to commence the Drilling of a well to be known as
Northwest Production Corporation

(Company or Operator)

Blanco 30-12

(Lease)

Well No. **14-15**

"1"

(Unit)

located **1850** feet from the **South** line and **1190** feet from the

West

line of Section **15**

T. **30N**

R. **12W**

NMPM.

(GIVE LOCATION FROM SECTION LINE)

Wildcat (Piet Cliffs)

Pool, **San Juan**

County

If State Land the Oil and Gas Lease is No.

If patented land the owner is **C. R. Hancock, et al**

Address

We propose to drill well with drilling equipment as follows: **Rotary rig from surface to total depth of approx 1930'.**

The status of plugging bond is **\$10,000**

Drilling Contractor **Empire States Drilling Corporation**

We intend to complete this well in the **Pictured Cliffs** formation at an approximate depth of **1865-1920**

CASING PROGRAM

We propose to use the following strings of Casing and to cement them as indicated:

Size of Hole	Size of Casing	Weight per Foot	New or Second Hand	Depth	Sacks Cement
9-5/8	7-5/8	24.00	New	130	175
6-3/4	4-1/2	9.50	New	1930	100

If changes in the above plans become advisable we will notify you immediately.

ADDITIONAL INFORMATION (If recompletion give full details of proposed plan of work.)

Pictured Cliffs formation to be fractured thru perforis using approx 30,000 gals water w/1# oil/gal. 1-1/4" OD tubing will be hung at 1900' and the well stubbed in. The SW/4 of Section 15, containing 160 acres, is dedicated to the well.

Approved 6-7, 1957
Except as follows:

Sincerely yours,

Northwest Production Corp.

(Company or Operator)

By **Ray Phillips** RAY PHILLIPS

Position **Asst Mgr, Prod Operations**

Send Communications regarding well to

Name **W. R. Johnston**

Address **520 Sims Bldg, Albuquerque, N.M.**

OIL CONSERVATION COMMISSION

By Emory C. Amos

1944

1944-1945 (1944-1945)

1944-1945 (1944-1945)

1944

1944-1945

1944

1944

1944

1944

1944

1944

1944-1945

1944-1945 (1944-1945)

1944-1945 (1944-1945)

1944-1945 (1944-1945)

1944-1945 (1944-1945)

1944-1945

1944-1945 (1944-1945)

1944

1944-1945

1944-1945

1944

1944

1944

1944

1944-1945

1944

1944-1945

1944

1944

1944-1945

1944-1945

1944-1945

1944-1945 (1944-1945)

1944-1945 (1944-1945)

1944-1945 (1944-1945)

1944-1945 (1944-1945)

1944-1945

1944-1945 (1944-1945)

1944-1945

1944-1945 (1944-1945)

NEW MEXICO
OIL CONSERVATION COMMISSION

Well Location and/or Gas Proration Plat

Form C-125

Date JUN 6 1957

Operator NORTHWEST PRODUCTION CO.

Lease BLANCO 30-12

Well No. 14-15 Section 15 Township 30 N Range 12 W NMPM

Located 1850 Feet From south Line 1190 Feet From west Line

San Juan County, New Mexico G. L. Elevation 5646

Name of Producing Formation Pictured Cliffs Pool Wildcat Dedicated Acreage 160

(Note: All distances must be from outer boundaries of Section)

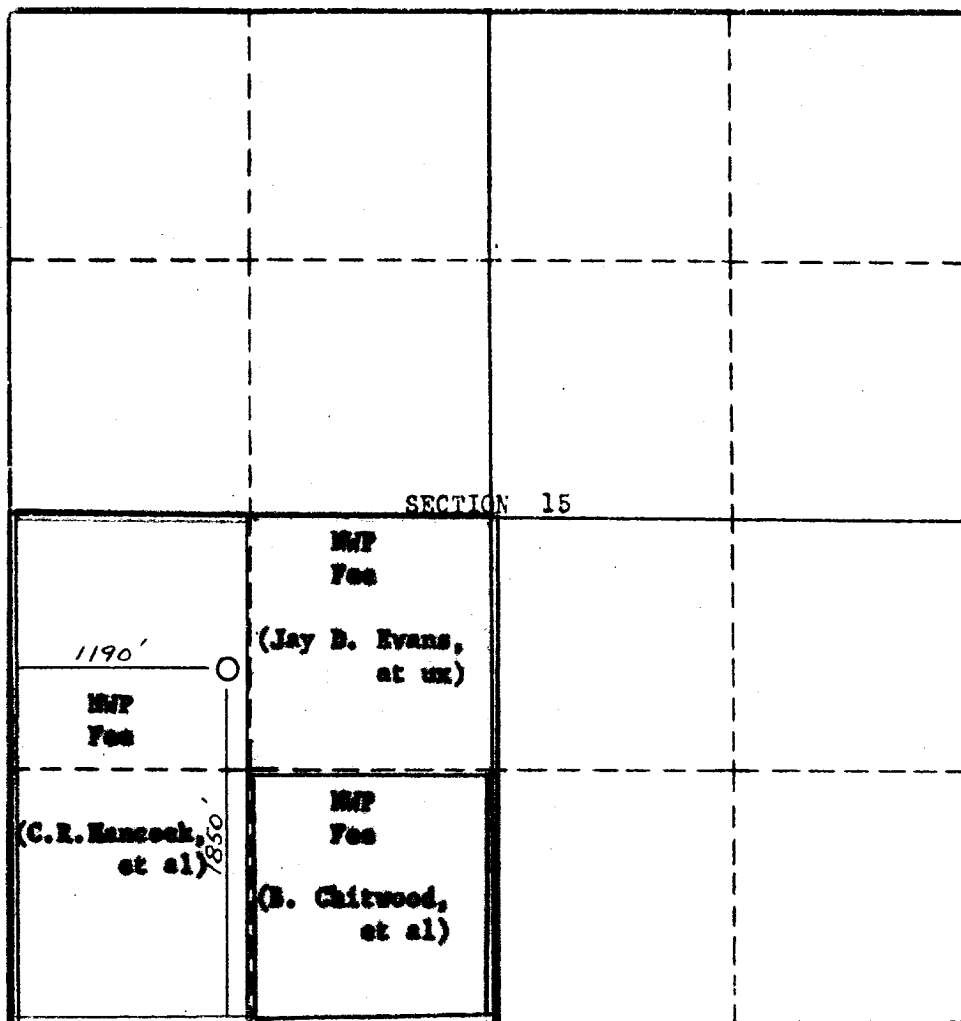

Scale—1 Inch Equals 1000 Feet

1. Is this Well a Dual Comp.? Yes No **X**
2. If the answer to Question 1 is yes, are there any other dually completed wells within the dedicated acreage? Yes No

Name RAY PHILLIPS Ray Phillips

Position Asst Mgr., Prod Operations

Representing NORTHWEST PRODUCTION CORPORATION

Address 1221 Street NW, Albuquerque, New Mexico

This is to certify that the above plat was prepared from field notes of actual surveys made by me or under my supervision and that the same are true and correct to the best of my knowledge and belief.

Date Surveyed June 4, 1957

Stephen H. Kinney

STEPHEN H. KINNEY,

Registered Professional Engineer and Land Surveyor





NEW MEXICO OIL CONSERVATION COMMISSION
Well Location and Acreage Dedication Plat

Section A.

Date June 6, 1957

Operator Northwest Production Corp. Lease Blanco 30-12
Well No. 14-15 Unit Letter L Section 15 Township 30N Range 12W NMPM
Located 1850 Feet From South Line, 1190 Feet From West Line
County San Juan G. L. Elevation 5648 Dedicated Acreage 160 Acres
Name of Producing Formation Pictured Cliffs Pool Wildcat

1. Is the Operator the only owner* in the dedicated acreage outlined on the plat below?
Yes ☒ No ☐.
2. If the answer to question one is "no," have the interests of all the owners been consolidated by communitization agreement or otherwise? Yes ☐ No ☐. If answer is "yes," Type of Consolidation _____
3. If the answer to question two is "no," list all the owners and their respective interests below:

Owner

Land Description

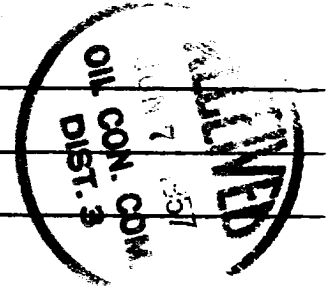

Section B

		15	
<u>1190'</u> NWP Fee	NWP Fee (Jay D. Evans, et ux)		
(C.R. Hancock, et al)	NWP Fee (B. Chitwood, et al)		

This is to certify that the information in Section A above is true and complete to the best of my knowledge and belief.

Northwest Production Corporation
(Operator)
RAY PHILLIPS
Ray Phillips, Asst Mgr, Prod Opr
(Representative)

520 Simms Bldg, Albuquerque, N.M.
Address

This is to certify that the well location shown on the plat in Section B was plotted from field notes of actual surveys made by me or under my supervision and that the same is true and correct to the best of my knowledge and belief.

Date Surveyed 6-4-57

Stephen H. Kinney
Registered Professional
Engineer and/or Land Surveyor.



(See instructions for completing this form on the reverse side)

Certificate No. 803

INSTRUCTIONS FOR COMPLETION:

1. Operator shall furnish and certify to the information called for in Section A.
2. Operator shall outline the dedicated acreage for both oil and gas wells on the plat in Section B.
3. A registered professional engineer or land surveyor registered in the State of New Mexico or approved by the Commission shall show on the plat the location of the well and certify this information in the space provided.
4. All distances shown on the plat must be from the outer boundaries of Section.
5. If additional space is needed for listing owners and their respective interests as required in question 3, Section A, please use space below

OIL CONSERVATION COMMISSION		
AZTEC DISTRICT OFFICE		
No. Copies Received 6		
DISTRIBUTION		
	NO. FURNISHED	
Operator	1	
Santa Fe	1	
Proration Office		
State Land Office		
U. S. G. S.	2	
Transporter		
File	1	<input checked="" type="checkbox"/>

* "Owner" means the person who has the right to drill into and to produce from any pool and to appropriate the production either for himself or for himself and another. (65-3-29 (e) NMSA 1953 Comp.)