

(SUBMIT IN TRIPLICATE)

UNITED STATES
DEPARTMENT OF THE INTERIOR
GEOLOGICAL SURVEY

Land Office New Mexico
Lesse No. EN 04407
Unit J. W. Aldila "B"

SUNDRY NOTICES AND REPORTS ON WELLS

NOTICE OF INTENTION TO DRILL.....	<input checked="" type="checkbox"/>	SUBSEQUENT REPORT OF WATER SHUT-OFF.....	
NOTICE OF INTENTION TO CHANGE PLANS.....		SUBSEQUENT REPORT OF SHOOTING OR ACIDIZING.....	
NOTICE OF INTENTION TO TEST WATER SHUT-OFF.....		SUBSEQUENT REPORT OF ALTERING CASING.....	
NOTICE OF INTENTION TO RE-DRILL OR REPAIR WELL.....		SUBSEQUENT REPORT OF RE-DRILLING OR REPAIR.....	
NOTICE OF INTENTION TO SHOOT OR ACIDIZE.....		SUBSEQUENT REPORT OF ABANDONMENT.....	
NOTICE OF INTENTION TO PULL OR ALTER CASING.....		SUPPLEMENTARY WELL HISTORY.....	
NOTICE OF INTENTION TO ABANDON WELL.....			

(INDICATE ABOVE BY CHECK MARK NATURE OF REPORT, NOTICE, OR OTHER DATA)

J. W. Aldila "B"

Farmington, New Mexico September 24, 19 59

Well No. 3 is located 1980 ft. from N line and 2310 ft. from W line of sec. 14

N 1/4 Section 14
(1/4 Sec. and Sec. No.)

T30N
(Twp.)

R16W
(Range)

N.M.P.M.
(Meridian)

Mercedee Gallup
(Field)

San Juan
(County or Subdivision)

New Mexico
(State or Territory)

The elevation of the derrick floor above sea level is ft. (To be reported later.)

DETAILS OF WORK

(State names of and expected depths to objective sands; show sizes, weights, and lengths of proposed casings; indicate mudding jobs, cementing points, and all other important proposed work)

We propose to drill the above well to a depth of approximately 2900' to test and develop productive Gallup zones. Stimulation will be as indicated upon penetration of Gallup pay. Rotary tools will be used to total depth. Casing program will be as follows:

SIZE	DEPTH	CEMENT	REMARKS
8-5/8"	200'	—	Test - circulate to surface.
5-1/2"	2900'	—	4 1/2 gal and neat.

Copies of location plat are attached. A copy of any survey taken will be submitted upon completion of well.

I understand that this plan of work must receive approval in writing by the Geological Survey before operations may be commenced.

Company Pan American Petroleum Corporation

Address Box 457

Farmington, New Mexico

Attn: L. O. Spear, Jr.

ORIGINAL SIGNED BY
E. M. Bauer, Jr.

By

Title Area Engineer

NEW MEXICO OIL CONSERVATION COMMISSION

Well Location and Acreage Dedication Plat

Section A.

Date May 6, 1959

Operator PAN AMERICAN PETROLEUM CORPORATION Lease J. W. AIDLIN "B"
Well No. 1 Unit Letter P Section 14 Township 30 NORTH Range 14 WEST N.M.
Located 1958 Feet From NORTH Line, 2330 Feet From WEST Line
County SAN JUAN G. L. Elevation 5513 Dedicated Acreage 40 Acres
Name of Producing Formation GALLUP Pool HERBERT GALLUP

1. Is the Operator the only owner* in the dedicated acreage outlined on the plat below?
Yes X No _____
2. If the answer to question one is "no," have the interests of all the owners been consolidated by communitization agreement or otherwise? Yes _____ No _____, If answer is "yes,"
Type of Consolidation _____
3. If the answer to question two is "no," list all the owners and their respective interests below:

Owner

Land Description



Section B

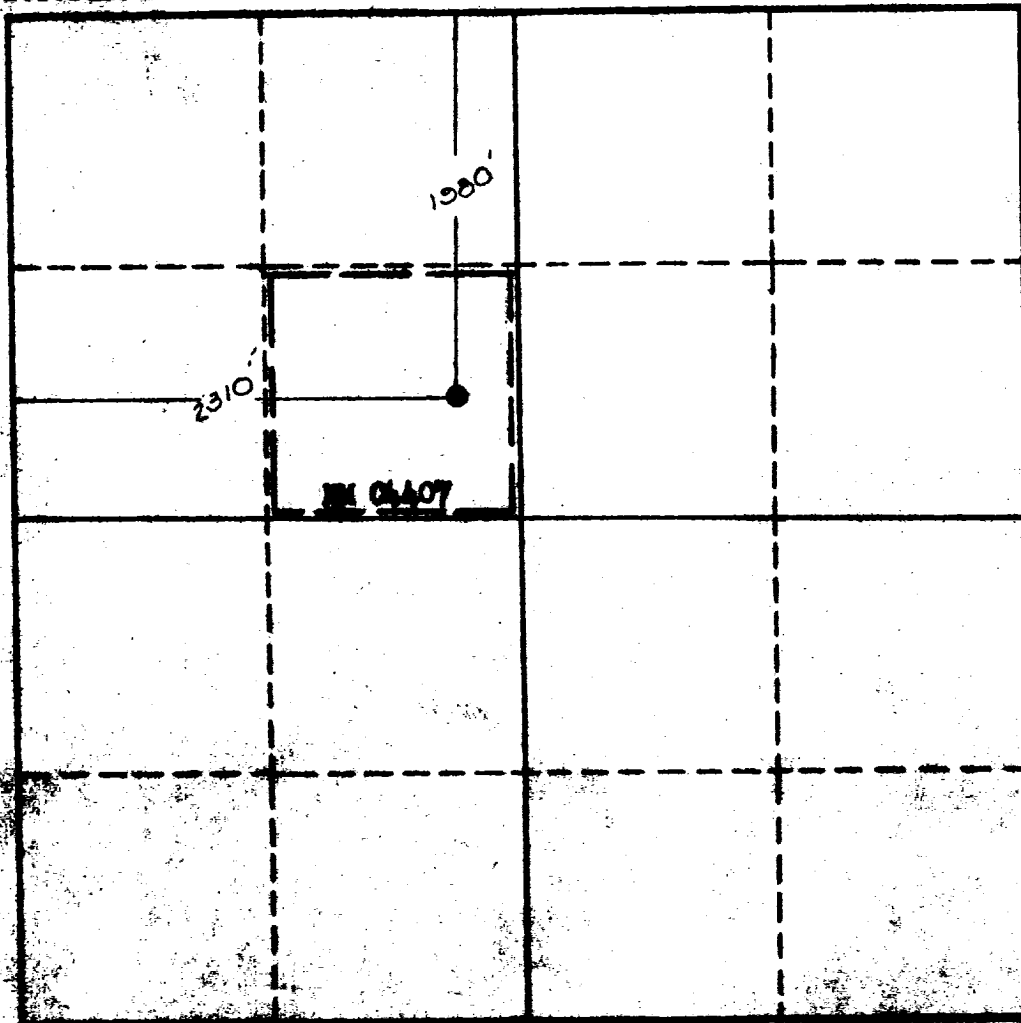

This is to certify that the information in Section A above is true and complete to the best of my knowledge and belief.

PAN AMERICAN PETROLEUM CORP.

(Operator)

R. M. Bauer, Jr. RMBauer, Jr.

(Representative)

Box 457, Farmington, New Mexico

Address

This is to certify that the well location shown on the plat in Section A is plotted from records of a legal survey and is to the best of my knowledge and belief.

Date Surveyed Oct. 3, 1959

Ernest V. Schabach
Registered Land Surveyor.

Certificate No. 1545