

7

Associated well
Beta Development
Pearl Wilks #1

EPFS

EL PASO FIELD SERVICES

P.O. Box 4990
Farmington, NM 87499

March 4, 1996

New Mexico Oil Conservation Division
ATTN: Frank Chavez
1000 Rio Brazos Rd.
Aztec, New Mexico 87410

Dear Sir:

On February 20, 1996 EPFS removed approximately five (5) cubic yards of hydrocarbon contaminated soil caused by a leaking valve on a Lateral 11A -6 end of line (EOL) blowdown. The legal coordinates for the described area are Unit Letter "A", Section 14, Township 30, Range 12. This investigation /remediation was performed in response to a landowner's request via your office on 2/9/96.

The soil removed was taken from approximately a 3 foot circumference and to a depth of 3 1/2 feet in depth. The soil was taken to Tierra Environmental's landfarm. A field PID was used to measure the extent of contamination.

I have enclosed the analytical report and site assessment information relating to this investigation. EPFS does not anticipate further action at this location.

If you have any questions please contact me at (505) 599 - 2158.

Sincerely Yours,

Lucy A. Cosby

Compliance Engineering Specialist

xc: Jerry Cagle, Kutz Pipeline District

RECEIVED
MAR - 6 1996

OIL CON. DIV.
DIST. 3

FIELD PIT SITE ASSESSMENT FORM

GENERAL

Meter: N/A Location: Latera/ 11A-6 (EOL)
 Operator #: N/A Operator Name: EPFS P/L District: KUTZ
 Coordinates: Letter: A Section 14 Township: 30 Range: 12
 Or Latitude _____ Longitude _____
 Pit Type: Dehydrator _____ Location Drip: _____ Line Drip: _____ Other: X
 Site Assessment Date: 2/20/96 Area: _____ Run: _____

SITE ASSESSMENT

NMOCD Zone:
 (From NMOCD
 Maps)

Inside
 Outside

☐ (1)
☒ (2)

Land Type:

BLM ☐ (1)
 State ☐ (2)
 Fee ☒ (3)
 Indian _____

Depth to Groundwater

Less Than 50 Feet (20 points) ☐ (1)
 50 Ft to 99 Ft (10 points) ☐ (2)
 Greater Than 100 Ft (0 points) ☒ (3)

Wellhead Protection Area :

Is it less than 1000 ft from wells, springs, or other sources of fresh water extraction? , or ; Is it less than 200 ft from a private domestic water source? ☐ (1) YES (20 points) ☒ (2) NO (0 points)

Horizontal Distance to Surface Water Body

Less Than 200 Ft (20 points) ☐ (1)
 200 Ft to 1000 Ft (10 points) ☐ (2)
 Greater Than 1000 Ft (0 points) ☒ (3)

Name of Surface Water Body _____

(Surface Water Body : Perennial Rivers, Major Wash, Streams, Creeks, Irrigation Canals, Ditches, Lakes, Ponds)

Distance to Nearest Ephemeral Stream ☐ (1) < 100' (Navajo Pits Only)
☐ (2) > 100'

TOTAL HAZARD RANKING SCORE: 0 POINTS

REMARKS

Remarks : Contaminated soil due to leaking valve

ORIGINAL PIT LOCATION

ORIGINAL PIT LOCATION

Original Pit : a) Degrees from North _____ Footage from Wellhead _____
b) Length : _____ Width : _____ Depth : _____

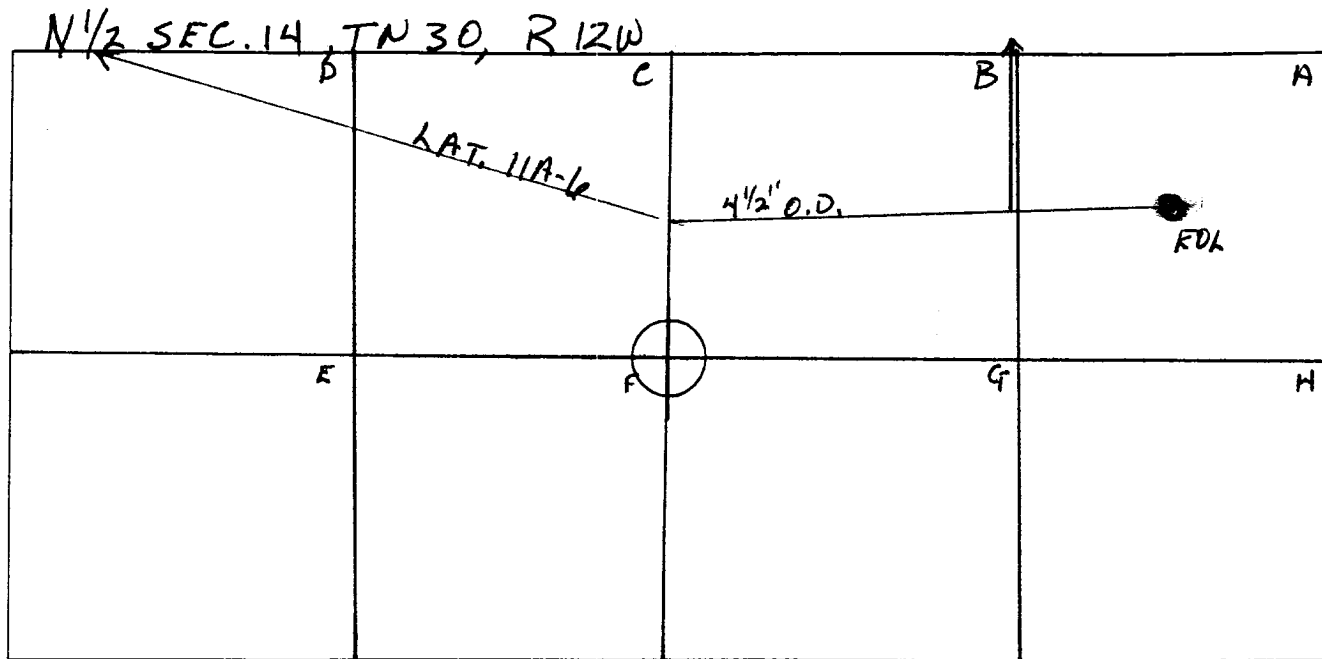

REMARKS

Remarks :

FOL - END REINE, NO PIT INVOLVED ONLY A SMALL AMOUNT
of surface & subsurface contamination. Field PID Result = 52 ppm

Completed By:

Ruby A. Carley
Signature

2/20/96
Date



EL PASO FIELD SERVICES
FIELD SERVICES LABORATORY
ANALYTICAL REPORT

SAMPLE IDENTIFICATION

SAMPLE NUMBER: 960169
MATRIX: Soil
SAMPLE DATE: 20-Feb-96
SAMPLE TIME (Hrs.): 945
SAMPLED BY: Rick Cosby
LOCATION: Lateral 11A-6
SAMPLE POINT: End of Line Drip Pit
DATE OF EXTRACTION: TPH-02/23/96 BTEX-02/23/96
DATE OF ANALYSIS: TPH-02/23/96 BTEX-02/23/96

REMARKS:

EPA Method 8020 (BTEX) and Method 418.1 (TPH) RESULTS

PARAMETER	RESULT MG/KG	QUALIFIER	Dilution Factor
BENZENE	<0.2	None	1
TOLUENE	<0.2	None	1
ETHYL BENZENE	<0.2	None	1
TOTAL XYLENES	<0.6	None	1
TOTAL BTEX	<1.2	None	1
TPH by EPA 418.1	336	None	1
PERCENT SOLIDS	95.1	Results are on as received basis.	
SURROGATE % RECOVERY	96	Allowed Range 80 to 120 %	

NOTES:

The Field PID was 52 ppm.

Approved By: _____

2-26-96
Date

