

NEW MEXICO OIL CONSERVATION COMMISSION
Santa Fe, New Mexico

Form G-101
Revised (12/1/55)

NOTICE OF INTENTION TO DRILL

Notice must be given to the District Office of the Oil Conservation Commission and approval obtained before drilling or recompletion begins. If changes in the proposed plan are considered advisable, a copy of this notice showing such changes will be returned to the sender. Submit this notice in QUINTUPLICATE. One copy will be returned following approval. See additional instructions in Rules and Regulations of the Commission. If State Land submit 6 Copies Attach Form G-128 in triplicate to first 3 copies of form G-101

Midland, Texas

(Place)

November 12, 1962

(Date)

OIL CONSERVATION COMMISSION
SANTA FE, NEW MEXICO

Gentlemen:

You are hereby notified that it is our intention to commence the Drilling of a well to be known as
Tidewater Oil Company

(Company or Operator)

M. L. Wright

(Lease)

Well No. **1**

in **B**

(Unit)

located **790** feet from the **North** line and **1837** feet from the

East

line of Section **13**, T. **30 N**, R. **12-W**, NMPM.

(GIVE LOCATION FROM SECTION LINE) **Basin Dakota** Pool, **San Juan** County

If State Land the Oil and Gas Lease is No.

If patented land the owner is **M. L. Wright**

Address.

We propose to drill well with drilling equipment as follows: **Rotary**

The status of plugging bond is **Blanket Bond dated November 30, 1937**
With Saint Paul Indemnity

Drilling Contractor **Contract not let**

We intend to complete this well in the **Dakota**

formation at an approximate depth of **6750** feet.

CASING PROGRAM

We propose to use the following strings of Casing and to cement them as indicated:

Size of Hole	Size of Casing	Weight per Foot	New or Second Hand	Depth	Sacks Cement
11"	8-5/8"	24#	New	320'	275 Sks Next
6-3/4"	4-1/2"	9.5#	New	6750'	150 Sks 50-50
				(Pomix, 6% Gal 75 Sks Next 2 Stg. Collar at 2100, Cement W/ 250 Sks.	

If changes in the above plans become advisable we will notify you immediately.

ADDITIONAL INFORMATION (If recompletion give full details of proposed plan of work.)

Approved 11-14, 1962
Except as follows:

Sincerely yours,

Tidewater Oil Company
(Company or Operator)

By J. M. Amis

Position **Authorized Employee**

Send Communications regarding well to

Name **Mr. G. L. Wade**

Address **Box 547, Hobbs, New Mexico**

OIL CONSERVATION COMMISSION

By Emmy C. Curtis

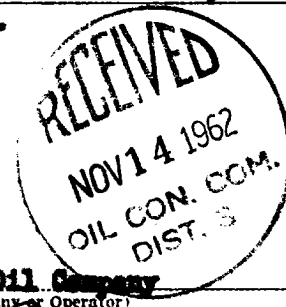

Well Location and Acreage Dedication Plat

Section A.

Date NOVEMBER 12, 1962

Operator TIDEWATER OIL COMPANY Lease WRIGHT GAS UNIT
 Well No. 1 Unit Letter B Section 13 Township 30 NORTH Range 12 WEST NMPM
 Located 790 Feet From the NORTH Line, 1837 Feet From the EAST Line
 County SAN JUAN G. L. Elevation 5590.0 Dedicated Acreage 320.0 Acres
 Name of Producing Formation DAKOTA Pool BASIN DAKOTA

1. Is the Operator the only owner in the dedicated acreage outlined on the plat below?

Yes _____ No X2. If the answer to question one is "no", have the interests of all the owners been consolidated by communitization agreement or otherwise? Yes X No _____. If answer is "yes", Type of Consolidation. Operating Agreement.

3. If the answer to question two is "no", list all the owners and their respective interests below:

OwnerLand DescriptionTIDEWATER OIL COMPANYE₂ Sec. 13, T 30 N, R 12 W, N.M.P.M.

Section B.

Note: All distances must be from outer boundaries of section.

This is to certify that the information in Section A above is true and complete to the best of my knowledge and belief.

TIDEWATER OIL COMPANY

(Operator)

J. M. Davis

(Representative)

P. O. BOX 1231

(Address)

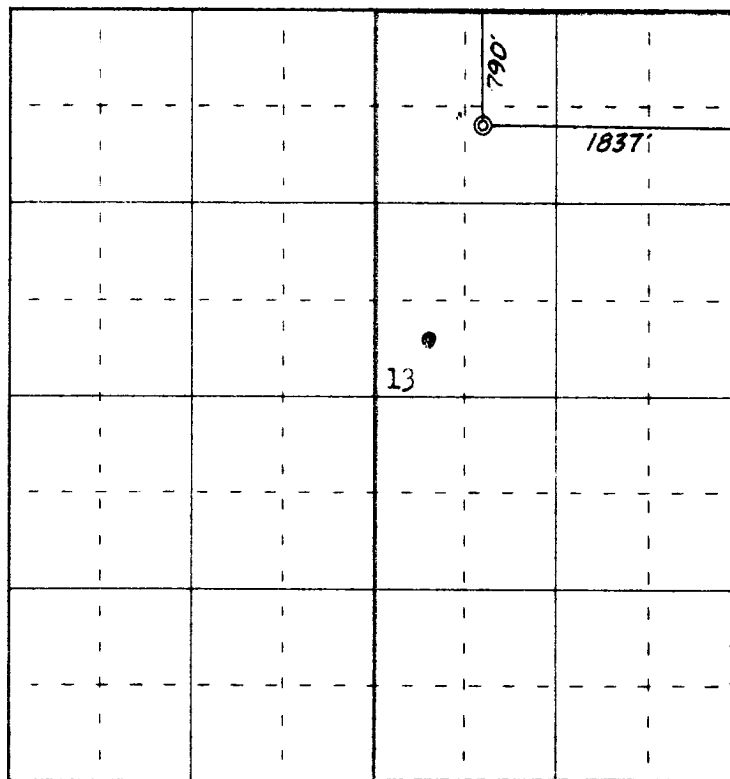
MIDLAND, TEXAS

0 330 660 990 1320 1650 1980 2310 2640 2000 1500 1000

Scale 4 inches equal 1 mile

Ref: GLO plat dated 7 April 1881

This is to certify that the above plat was prepared from field notes of land surveys made by me or under my supervision and that the same are true and correct to the best of my knowledge and belief.

(Seal)

Date Surveyed 7 November 1962

James P. Leese
 Registered Professional Engineer and/or Land Surveyor
 James P. Leese, N. Mex. Reg. No. 1463
 San Juan Engineering Company

Farmington, New Mexico

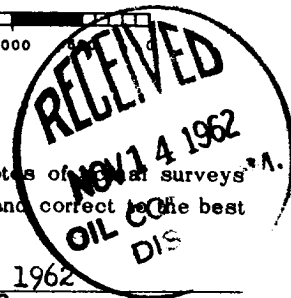

5
572-1
File 14
copy - 2
April 1