

FIELD PIT SITE ASSESSMENT FORM

He 10 sample ID **EPFS**
EL PASO FIELD SERVICES

GENERAL

Meter: 73940 Location: TAFT GAS Com #1
Operator #: 0203 Operator Name: Amoco P/L District: Kut 2
Coordinates: Letter: A Section 14 Township: 30 Range: 13
Or Latitude _____ Longitude _____
Pit Type: Dehydrator _____ Location Drip: X Line Drip: _____ Other: _____
Site Visit Date: 4-13-94 Run: 02 31

SITE ASSESSMENT

NMOCD Zone: Inside _____ Land Type: BLM ☐
(From NMOCD Vulnerable _____ State ☐
Maps) Zone ☒ Fee ☒
Outside ☐ Indian _____
APR 13 1995
Depth to Groundwater
Less Than 50 Feet (20 points) ☐
50 Ft to 99 Ft (10 points) ☐
Greater Than 100 Ft (0 points) ☒
Wellhead Protection Area :
Is it less than 1000 ft from wells, springs, or other sources of
fresh water extraction? , or ; Is it less than 200 ft from a private
domestic water source? ☐ YES (20 points) ☒ NO (0 points)
Horizontal Distance to Surface Water Body
Less Than 200 Ft (20 points) ☐
200 Ft to 1000 Ft (10 points) ☐
Greater Than 1000 Ft (0 points) ☒
Name of Surface Water Body _____
(Surface Water Body : Perennial Rivers, Major Wash, Streams, Creeks,
Irrigation Canals, Ditches, Lakes, Ponds)
TOTAL HAZARD RANKING SCORE: 0 POINTS

RECEIVED
APR - 4 1995

OIL CON. BUREAU
DIST. 8

REMARKS

Remarks : FIVE pit ON location will close two of
Then both pits are dry

ORIGINAL PIT LOCATION

Original Pit : a) Degrees from North 115° Footage to Wellhead 88'
 b) Degrees from North _____ Footage to Dogleg _____
 Dogleg Name _____
 c) Length : 14' Width : 12' Depth : 3'

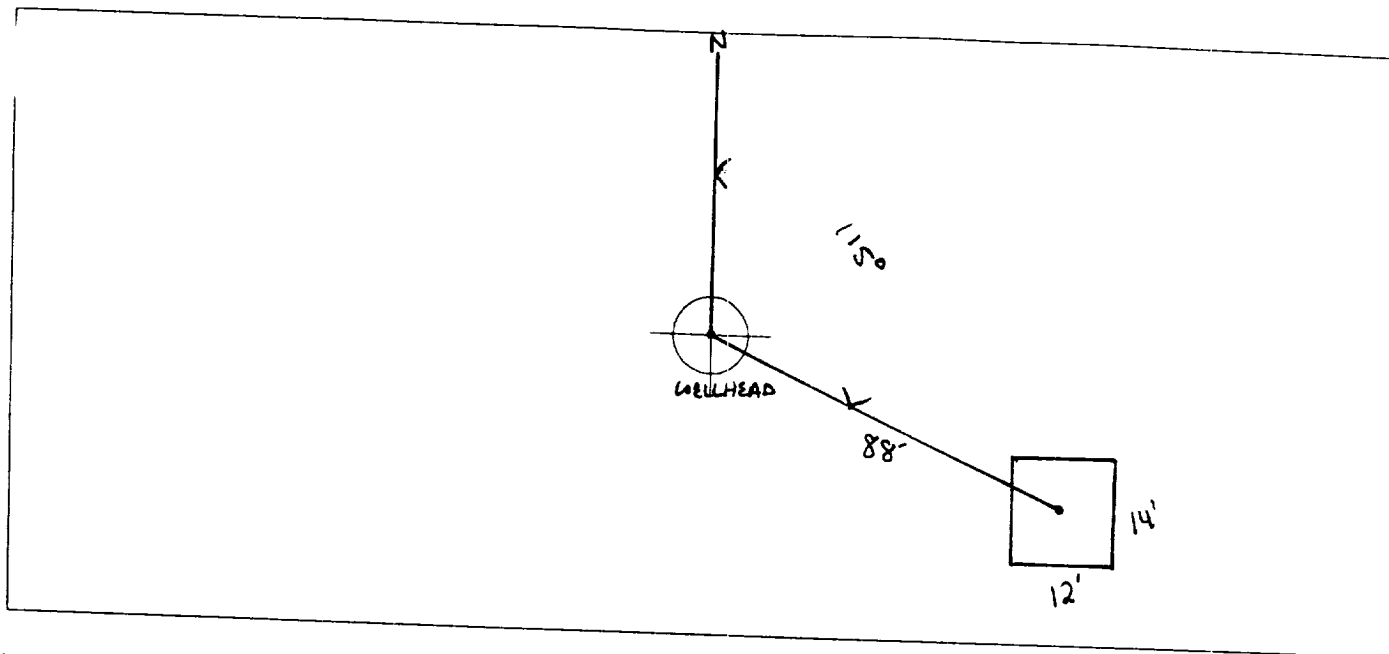

Remarks :

STARTED TAKING PICTURES AT 3:19 P.M.

Completed By:

Signature

Date

NMOCD ZONE ASSESSMENT FORM

GENERAL

Meter: 73940 Location: TAFT GAS COM #1
 Operator #: _____ Operator Name: _____ P/L District: _____
 Coordinates: Letter: _____ Section: _____ Township: _____ Range: _____
 Or Latitude: _____ Longitude: _____
 Pit/Type: Dehydrator _____ Location Drip: _____ Line Drip: _____ Other: _____
 Site Assessment Date: _____ Area: 02 Run: 31

SITE ASSESSMENT

NMOCD Zone: (From NMOCD Maps) Inside ☐ (1) Outside ☐ (2)

Land Type: BLM ☐ (1) State ☐ (2) Fee ☐ (3) Indian _____

Depth to Groundwater
 Less Than 50 Feet (20 points) ☒ (1)
 50 Ft to 99 Ft (10 points) ☐ (2)
 Greater Than 100 Ft (0 points) ☐ (3)

Wellhead Protection Area :
 Is it less than 1000 ft from wells, springs, or other sources of fresh water extraction? , or ; Is it less than 200 ft from a private domestic water source? ☐ (1) YES (20 points) ☐ (2) NO (0 points)

Horizontal Distance to Surface Water Body
 Less Than 200 Ft (20 points) ☒ (1)
 200 Ft to 1000 Ft (10 points) ☐ (2)
 Greater Than 1000 Ft (0 points) ☐ (3)

Name of Surface Water Body FARMINGTON GLADE
 (Surface Water Body : Perennial Rivers, Major Wash, Streams, Creeks, Irrigation Canals, Ditches, Lakes, Ponds)

Distance to Nearest Ephemeral Stream ☐ (1) < 100' (Navajo Pits Only)
☐ (2) > 100'

TOTAL HAZARD RANKING SCORE: 40 POINTS

REMARKS

Remarks : _____

FIELD PIT REMEDIATION/CLOSURE FORM

GENERAL

Meter: 73940 Location: Taft Gas Com #1
 Coordinates: Letter: A Section 14 Township: 30 Range: 13
 Or Latitude _____ Longitude _____
 Date Started : 4-20-94 Area: 02 Run: 31

FIELD OBSERVATIONS

Sample Number(s): ⁹⁴⁰⁸³⁸ KD12 _____
 Sample Depth: 12' Feet
 Final PID Reading 1 ppm PID Reading Depth 12' Feet
 Yes No
 Groundwater Encountered ☐ (1) ☒ (2) Approximate Depth _____ Feet

CLOSURE

Remediation Method :
 Excavation ☐ (1) Approx. Cubic Yards 0
 Onsite Bioremediation ☐ (2)
 Backfill Pit Without Excavation ☒ (3)
 Soil Disposition:
 Envirotech ☐ (1) ☒ (3) Tierra
 Other Facility ☐ (2) Name: _____
 Pit Closure Date: 4-20-94 Pit Closed By: BET

REMARKS

Remarks : Pit Located Close to Farmington Glade, Pit Remediate
as per WVZ requirements.
Location Drip Pit, located downstream of meter run

Signature of Specialist: _____

Kenny Dean



FIELD SERVICES LABORATORY
ANALYTICAL REPORT
PIT CLOSURE PROJECT - Soil

46
46 D-3p 217

SAMPLE IDENTIFICATION

SAMPLE NUMBER:

Field ID

Lab ID

KD12	940838
73940	NIA
4/20/94	1050
NIA	
4-22-94	4-22-94
4/29/94	4/30/94
VG	Coarse Brown Sand

MTR CODE | SITE NAME:

SAMPLE DATE | TIME (Hrs):

SAMPLED BY:

DATE OF TPH EXT. | ANAL.:

DATE OF BTEX EXT. | ANAL.:

TYPE | DESCRIPTION:

REMARKS:

RESULTS

PARAMETER	RESULT	UNITS	QUALIFIERS			
			DF	Q	M(g)	V(ml)
BENZENE	<1.0	MG/KG	20			
TOLUENE	2.69	MG/KG	20	B		
ETHYL BENZENE	<1.0	MG/KG	20			
TOTAL XYLENES	<1.0	MG/KG	20			
TOTAL BTEX	2.69	MG/KG	1843		2.17	20
TPH (418.1)	<10	MG/KG			2.03	28
HEADSPACE PID	1 ppm	PPM				
PERCENT SOLIDS	97.4%	%				

-- TPH is by EPA Method 418.1 and BTEX is by EPA Method 8020 --

The Surrogate Recovery was at
Narrative:

95.6 % for this sample All QA/QC was acceptable.

IDF
20

DF = Dilution Factor Used

Approved By:

John Sardi

Date:

5/17/94