

(SUBMIT IN TRIPLICATE)

UNITED STATES
DEPARTMENT OF THE INTERIOR
GEOLOGICAL SURVEY

Land Office New Mexico
Lease No. 881 04443
Unit O. J. Hoover "3"

SUNDRY NOTICES AND REPORTS ON WELLS

NOTICE OF INTENTION TO DRILL	<input checked="" type="checkbox"/>	SUBSEQUENT REPORT OF WATER SHUT-OFF	
NOTICE OF INTENTION TO CHANGE PLANS		SUBSEQUENT REPORT OF SHOOTING OR ACIDIZING	
NOTICE OF INTENTION TO TEST WATER SHUT-OFF		SUBSEQUENT REPORT OF ALTERING CASING	
NOTICE OF INTENTION TO RE-DRILL OR REPAIR WELL		SUBSEQUENT REPORT OF RE-DRILLING OR REPAIR	
NOTICE OF INTENTION TO SHOOT OR ACIDIZE		SUBSEQUENT REPORT OF ABANDONMENT	
NOTICE OF INTENTION TO PULL OR ALTER CASING		SUPPLEMENTARY WELL HISTORY	
NOTICE OF INTENTION TO ABANDON WELL			

(INDICATE ABOVE BY CHECK MARK NATURE OF REPORT, NOTICE, OR OTHER DATA)

O. J. Hoover "3"

Farmington, New Mexico U. S. GEOLOGICAL SURVEY
FARMINGTON, NEW MEXICO

Well No. 1 is located 420 ft. from N line and 217 ft. from W line of sec. 15
NE 1/4 SW 1/4 Section 15 T-30-N R-16-E N.M.F.M.
(1/4 Sec. and Sec. No.) (Twp.) (Range) (Meridian)
Horseshoe Gallup San Juan New Mexico
(Field) (County or Subdivision) (State or Territory)

The elevation of the derrick floor above sea level is _____ ft. (To be reported later)

DETAILS OF WORK

(State names of and expected depths to objective sands; show sizes, weights, and lengths of proposed casings; indicate mudding jobs, cementing points, and all other important proposed work)

We propose to drill the above well to approximately 1900' to test and develop productive Gallup zones. Stimulation will be as indicated upon penetration of Gallup pay. Rotary tools will be used to total depth. Casing program as follows:

Size	Depth	Cement	Remarks
2-5/8"	100'	—	Neat—circulate to surface
3-1/2"	1900'	130	6 1/2 gal and neat.

Copies of location plate attached. A copy of any survey map will be submitted upon completion of well.

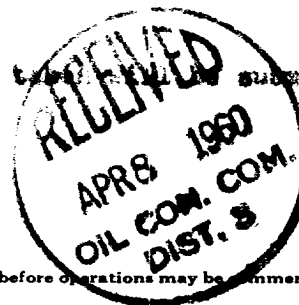

I understand that this plan of work must receive approval in writing by the Geological Survey before operations may be commenced.

Company Pan American Petroleum Corporation

Address P.O. Box 487
Farmington, New Mexico

Attn: L. O. Spear, Jr.

ORIGINAL SIGNED BY
L. O. Spear, Jr.

By _____
Title Area Superintendent

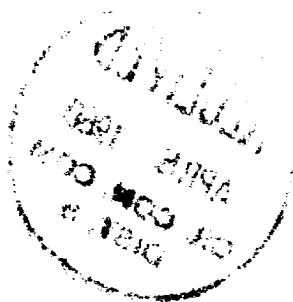

NEW MEXICO OIL CONSERVATION COMMISSION

Well Location and Acreage Dedication Plat

Section A.

Date APRIL 1, 1960

Operator PAN AMERICAN PETROLEUM CORPORATION Lease O. J. HOOVER "H"
Well No. 1 Unit Letter C Section 15 Township 30 NORTH Range 16 WEST NMPM
Located 820 Feet From NORTH Line, 2170 Feet From WEST Line
County SAN JUAN G. L. Elevation * Dedicated Acreage 40 Acres
Name of Producing Formation GALLUP Pool HORSESHOE GALLUP

1. Is the Operator the only owner* in the dedicated acreage outlined on the plat below?
Yes X No *To be reported later.
2. If the answer to question one is "no," have the interests of all the owners been consolidated by communitization agreement or otherwise? Yes No . If answer is "yes,"
Type of Consolidation
3. If the answer to question two is "no," list all the owners and their respective interests below:

Owner

Land Description

Section. B

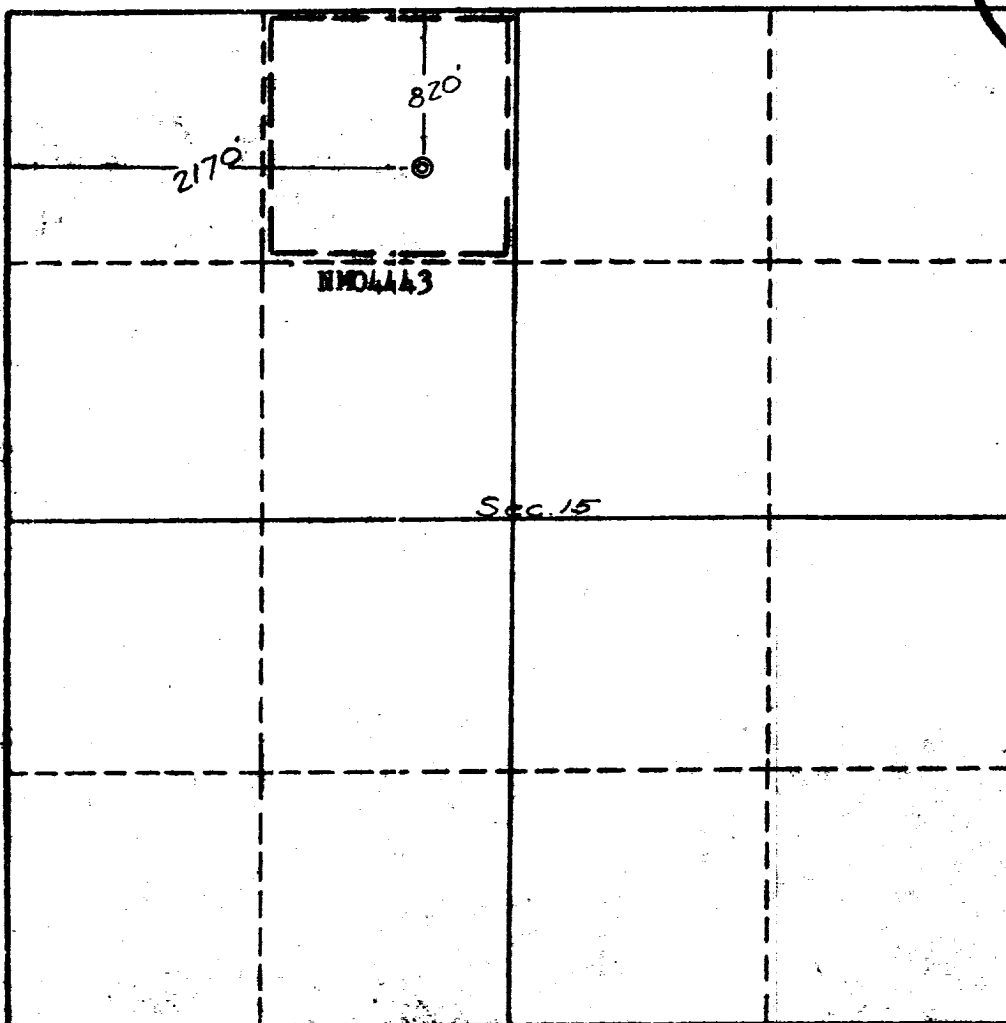

This is to certify that the information in Section A above is true and complete to the best of my knowledge and belief.

PAN AMERICAN PETROLEUM CORP.

(Operator)

R. M. BAUER, JR.

(Representative)

BOX 487, FARMINGTON, N. MEX.

Address

This is to certify that the well location shown on the plat in Section B was located from field notes of actual surveys made by or under my supervision and the same is true and correct to the best of my knowledge and belief.

Date Surveyed MARCH 31, 1960

Ernest V. Bohchawk
Registered Land Surveyor.

Certificate No. 1545

