

UNITED STATES
DEPARTMENT OF THE INTERIOR
BUREAU OF LAND MANAGEMENT

APPLICATION FOR PERMIT TO DRILL OR DEEPEN

1a. TYPE OF WORK
 DRILL DEEPEN

b. TYPE OF WELL
 OIL WELL GAS WELL OTHER SINGLE ZONE MULTIPLE ZONE

2. NAME OF OPERATOR
 Robert L. Bayless 19418

3. ADDRESS AND TELEPHONE NO.
 P.O. Box 168 Farmington, NM 87499 (505) 326-2659

4. LOCATION OF WELL (Report location clearly and in accordance with any State requirements.)*
 At surface
 1000 FSL & 1650 FEL
 At proposed prod. zone Same

14. DISTANCE IN MILES AND DIRECTION FROM NEAREST TOWN OR POST OFFICE*

15. DISTANCE FROM PROPOSED* LOCATION TO NEAREST PROPERTY OR LEASE LINE, FT. (Also to nearest drlg. unit line, if any)

16. NO. OF ACRES IN LEASE

17. NO. OF ACRES ASSIGNED TO THIS WELL

18. DISTANCE FROM PROPOSED LOCATION* TO NEAREST WELL, DRILLING, COMPLETED, OR APPLIED FOR, ON THIS LEASE, FT.

19. PROPOSED DEPTH
 4860 Ft.

20. ROTARY OR CABLE TOOLS
 Rotary

21. ELEVATIONS (Show whether DF, RT, GR, etc.)
 5796 GL, 5799 DF

22. APPROX. DATE WORK WILL START*
 ASAP

5. LEASE DESIGNATION AND SERIAL NO.
 SF-078841-B

6. IF INDIAN, ALLOTTEE OR TRIBE NAME

7. UNIT AGREEMENT NAME

8. FARMOR LEASE NAME, WELL NO. 18290
 Hazel Bolack #10 #1

9. AM WELL NO.
 30-045-09614 -

10. FIELD AND POOL, OR WILDCAT
 Blanco Mesaverde 72319

11. SEC., T., R., M., OR BLK. AND SURVEY OR AREA
 0
 Sec 10, T30N R11W

12. COUNTY OR PARISH
 San Juan

13. STATE
 New Mexico

23. This action is subject to technical and procedural review pursuant to 43 CFR 3165.3 and appeal pursuant to 43 CFR 3165.4. DRILLING OPERATIONS AUTHORIZED ARE SUBJECT TO COMPLIANCE WITH ATTACHED "GENERAL REQUIREMENTS"

SIZE OF HOLE	GRADE	SETTING DEPTH	PROPOSED CASING AND CEMENTING PROGRAM	QUANTITY
Existing 12 1/4"	8 5/8" J55	24.0 #/Ft.	106 Ft.	90 sx (106 Ft.) ³
Existing 7 7/8"	5 1/2" J55	14.0 #/Ft.	2260 Ft.	150 sx (177 Ft.) ³
Proposed 4 3/4"	3 1/2" N80	9.3 #/Ft.	4860 Ft.	215 sx (383 Ft.) ³

Robert L. Bayless proposes to deepen this existing Pictured Cliffs well to the Mesaverde formation as per the attached procedure. No abnormal pressures or temperatures are anticipated. Blowout preventor schematic is attached. The gas from this well is dedicated.

RECEIVED
 APR 26 1996
 OIL CON. DIV.
 DIST. 3

RECEIVED
 APR 19 AM 8:19
 DISTRICT MANAGER

IN ABOVE SPACE DESCRIBE PROPOSED PROGRAM: If proposal is to deepen, give data on present productive zone and proposed new productive zone. If proposal is to drill or deepen directionally, give pertinent data on subsurface locations and measured and true vertical depths. Give blowout preventer program, if any.

24. SIGNED Kevin H. McNeil TITLE Petroleum Engineer DATE 4-17-96

(This space for Federal or State office use)

PERMIT NO. _____ APPROVAL DATE _____

Application approval does not warrant or certify that the applicant holds legal or equitable title to those rights in the subject lease which would entitle the applicant to conduct operations thereon.

CONDITIONS OF APPROVAL, IF ANY:

APPROVED BY CA TITLE _____

APPROVED AS AMENDED
 APR 24 1996
 DISTRICT MANAGER

*See Instructions On Reverse Side

District I
 PO Box 1900, Hobbs, NM 88241-1900
 District II
 PO Drawer DD, Artesia, NM 88211-0719
 District III
 1000 Rio Brazos Rd., Aztec, NM 87410
 District IV
 PO Box 2088, Santa Fe, NM 87504-2088

State of New Mexico
 Energy, Minerals & Natural Resources Department

OIL CONSERVATION DIVISION
 PO Box 2088
 Santa Fe, NM 87504-2088

Form C-107
 Revised February 10, 1994
 Instructions on back
 Submit to Appropriate District Office
 State Lease - 4 Copies
 Fee Lease - 3 Copies

AMENDED REPORT

WELL LOCATION AND ACREAGE DEDICATION PLAT

API Number 30-045-09614		Pool Code 72319	Pool Name Blanco Mesaverde	
Property Code 18290	Property Name Hazel Bolack		Well Number 1-10	
OGRID No. 019418	Operator Name Robert L. Bayless		Elevation 5796 GL	

10 Surface Location

UL or lot no.	Section	Township	Range	Lot Idn	Feet from the	North/South line	Feet from the	East/West line	County
0	10	30N	11W		1000	South	1650	East	San Juan

11 Bottom Hole Location If Different From Surface

UL or lot no.	Section	Township	Range	Lot Idn	Feet from the	North/South line	Feet from the	East/West line	County

Dedicated Acres 3203/8.74	Joint or Infill	Consolidation Code	Order No.
------------------------------	-----------------	--------------------	-----------

NO ALLOWABLE WILL BE ASSIGNED TO THIS COMPLETION UNTIL ALL INTERESTS HAVE BEEN CONSOLIDATED OR A NON-STANDARD UNIT HAS BEEN APPROVED BY THE DIVISION



17 OPERATOR CERTIFICATION

I hereby certify that the information contained herein is true and complete to the best of my knowledge and belief

Kevin H. McCord
 Signature
 Kevin H. McCord
 Printed Name
 Petroleum Engineer
 Title
 4-17-96
 Date

18 SURVEYOR CERTIFICATION

I hereby certify that the well location shown on this plat was plotted from field notes of actual surveys made by me or under my supervision, and that the same is true and correct to the best of my belief.

Date of Survey
 Signature and Seal of Professional Surveyer

Original Plat on file
 Certificate Number

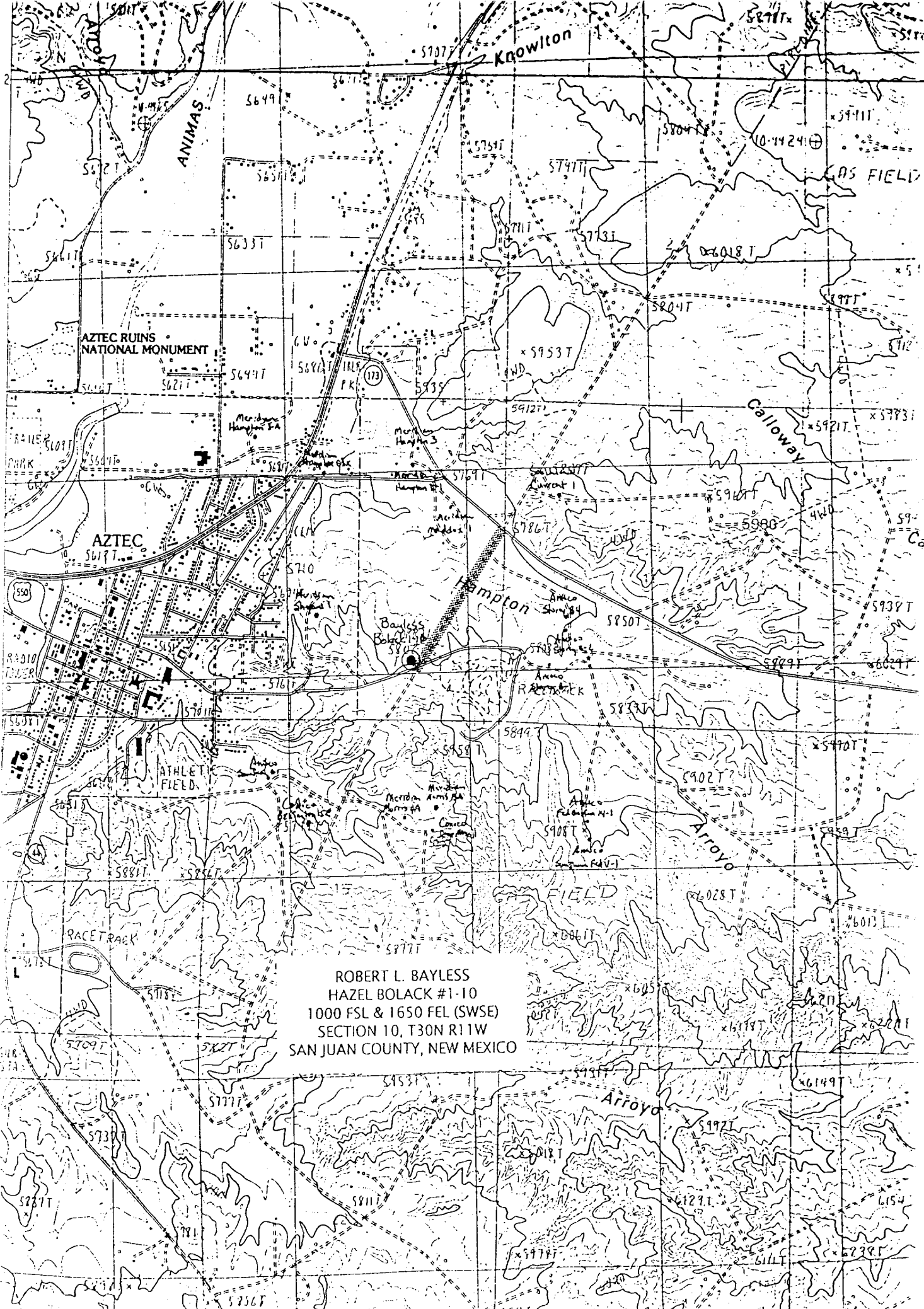

ROBERT L. BAYLESS
HAZEL BOLACK #1-10
1000 FSL & 1650 FEL (SWSE)
SECTION 10, T30N R11W
SAN JUAN COUNTY, NEW MEXICO

Knowlton

ANIMAS

CAS FIELD

AZTEC RUINS
NATIONAL MONUMENT

Calloway

AZTEC

Hampton

ATHLETIC FIELD

FIELD

Arroyo

Arroyo

Bayless
Bolack #1-10

