

District I

P.O. Box 1980, Hobbs, NM

District II

P.O. Drawer, Artesia, NM 88211

District III

1000 Rio Brazos Rd. Aztec, NM 87410

State Of New Mexico

Energy, Minerals and Natural Resources Department

OIL CONSERVATION DIVISION

P.O. Box 2098
Santa Fe, New Mexico 87504-2098

RECEIVED
III - 9 1999
OIL CON. DIV.
DIST. 3

SUBMIT 1 COPY TO
APPROPRIATE
DISTRICT OFFICE
AND 1 COPY TO
SANTA FE OFFICE
(Revised 3/9/94)

PIT REMEDIATION AND CLOSURE REPORT

Operator: Conoco Inc.Telephone: 505-324-5813Address: 3315 Bloomfield Hwy - Farmington, NM 87401Facility Or: Kate Standage #1

Well Name

Location: Unit or Qtr/Qtr Sec J Sec 12 T 30N R 12W County San JuanPit Type: Separator Dehydrator X Other Land Type: BLM State X Fee Other Pit Location: Pit dimension: length 12' width 12' depth 3'
(Attach diagram)Reference: wellhead X other Footage from reference: 100'Direction from reference: 330 Degrees East of X North
X West South

Depth To Ground Water:

(Vertical distance from
contaminants to seasonal
high water elevation of
ground water)

Less than 50 feet (20 points)
50 feet to 9 feet (10 points)
Greater than 100 feet (0 points)

Total 0

Wellhead Protection Area:

(Less than 200 feet from a private
domestic water source, or; less than
1000 feet from all other water sources)

Yes (20 points)
No (0 points)

Total 0

Distance To Surface Water:

(Horizontal distance to perennial
lakes, ponds, rivers, streams, creeks,
irrigation canals and ditches)

Less than 200 feet (20 points) (20 points)
200 feet to 1000 feet (10 points) (10 points)
Greater than 1000 feet (0 points) (0 points)

Total 0RANKING SCORE (TOTAL POINTS): 0

Date Remediation Started: _____		Date Completed: _____	
Remediation Method: (Check all appropriate sections)	Excavation: _____	Approx. cubic yards _____	
	Landfarm _____	Insitu Bioremediation _____	
	Other _____		
Remediation Location: Onsite _____ Offsite _____			
(ie. landfarmed onsite, name and location of offsite facility)			
General Description Of Remedial Action: _____			
One sample was taken at 3' below bottom of pit center. No PID reading was conducted on location. Sample was transported to laboratory for TPH analysis per EPA Method 8015 and for BTEX analysis per EPA Method 8020A			
OVM sample = 3 ppm			
Ground Water Encountered: No <input checked="" type="checkbox"/> Yes _____ Depth _____			
Final Pit: _____		Sample location Center of pit below bottom of pit	
Closure Sampling: _____		Sample depth 3'	
(if multiple samples attach sample results and diagram of sample locations and depths)		Sample date 2/25/99 Sample time 1502	
Sample Results			
		Benzene (ppm)	n/a
		Total BTEX (ppm)	n/a
		Field headspace (ppm)	3
		TPH	ND
Ground Water Sample: Yes _____ No <input checked="" type="checkbox"/> (If yes, attach sample results)			
I HEREBY CERTIFY THAT THE INFORMATION ABOVE IS TRUE AND COMPLETE TO THE BEST OF MY KNOWLEDGE AND BELIEF			
DATE June 28, 1999		PRINTED NAME _____	
SIGNATURE [Signature]		AND TITLE P.E.	

Lease Name: Kate Standage 1 Operator: Steve Miller Date: 2-24-99

Site Security
(Indicate North)

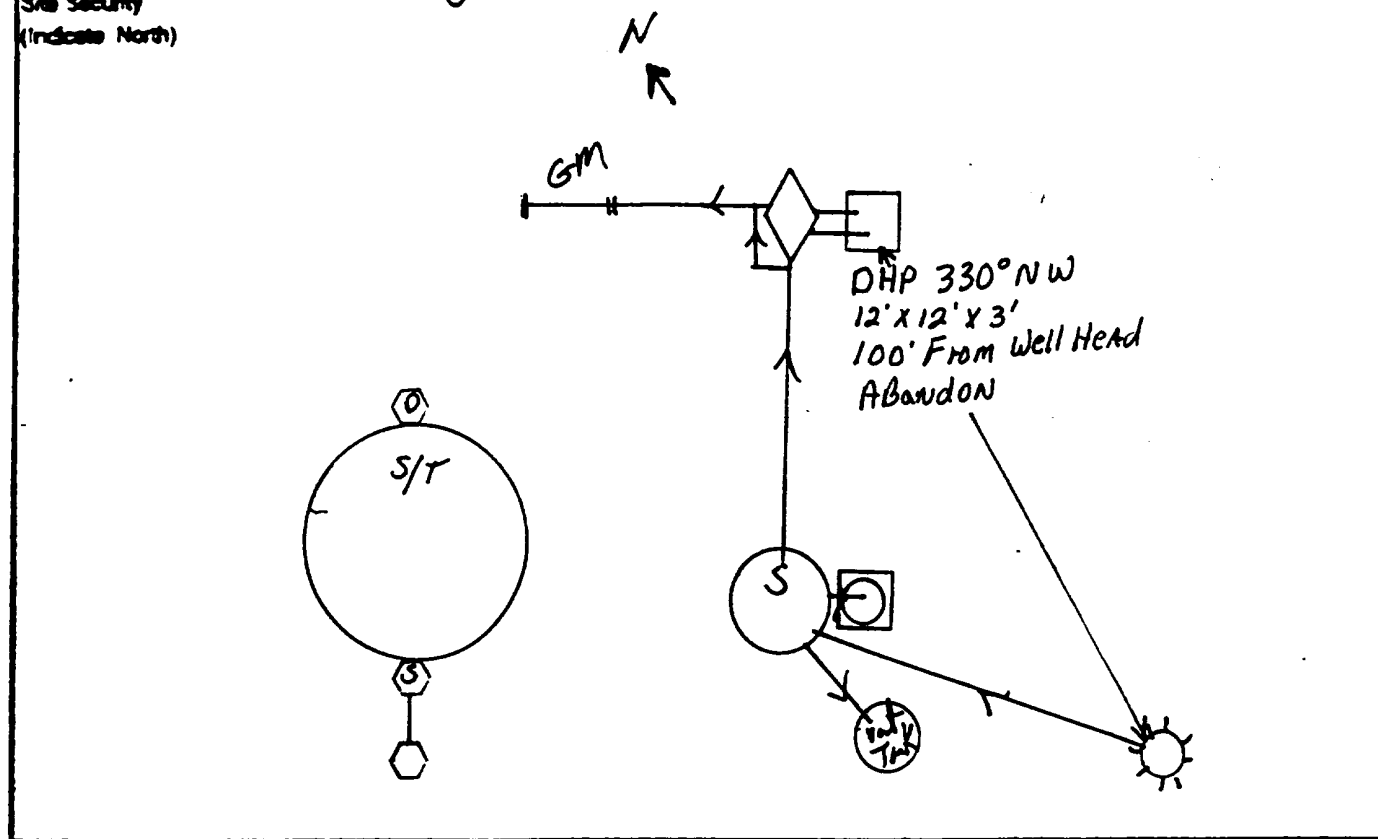

Lease Name: Kate Standage 1

Federal/ Indian Lease No: _____

CA No.: _____

Unit: J

Legal Description: Sect: 12 TP: 30N R: 12W

County: SAN JUAN, NM

Load line valves :
Sealed during Production

Drain line valves :
Sealed during Production

Production Line valve:
Sealed during sales

This lease is subject to the site security plan for
San Juan Basin Operations. The plan is located at:
Conoco Inc.
3315 Bloomfield Hwy
Farmington, NM

Kate Standage

D.H.P.

100' From W.H. 330° NW.

12' x 12' x 3'

CENTER of PIT

Time : 1502
P.P.M. : 3

⊗ Sample

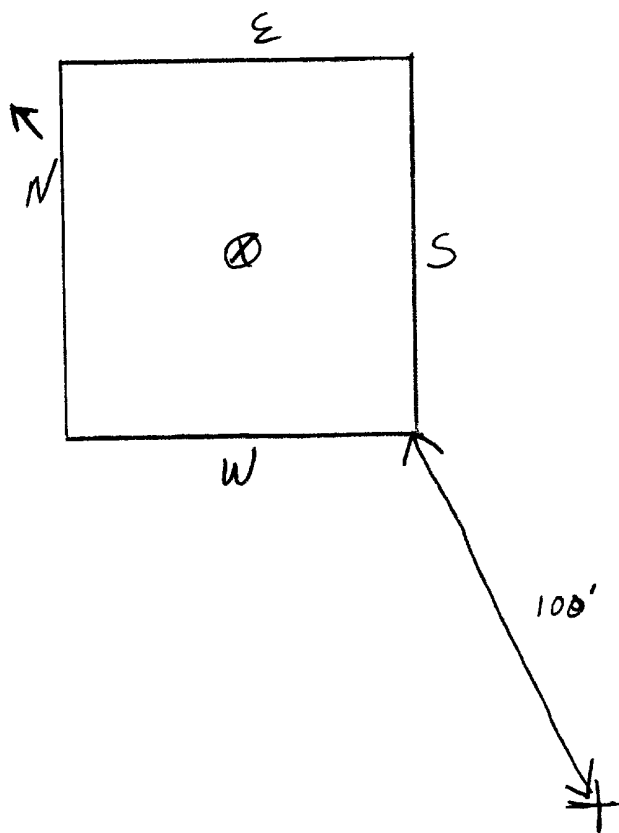

22-141 50 SHEETS
22-142 100 SHEETS
22-144 200 SHEETS







9125

Page 1 of 1

657 W. Maple • P. O. Box 2606 • Farmington NM 87499
LAB: (505) 325-5667 • FAX: (505) 325-6256

[illegible]

Distribution:	White – On Site	Yellow – LAB	Pink – Sampler	Goldenrod – Client
---------------	-----------------	--------------	----------------	--------------------



பி

Page 1 of 1

Distribution: White – On Site	Yellow – LAB	Pink – Sampler	Goldenrod – Client
-------------------------------	--------------	----------------	--------------------



OFF: (505) 325-5667



LAB: (505) 325-1556

March 11, 1999

Shirley Ebert
Conoco, Inc.
3315 Bloomfield Hwy
Farmington, NM 87401
TEL: (505) 324-5813
FAX (505) 324-5825

RE: Kate Standage 1 DHP

Order No.: 9902098

Dear Shirley Ebert,

On Site Technologies, LTD. received 1 sample on 2/26/99 for the analyses presented in the following report.

The Samples were analyzed for the following tests:

Diesel Range Organics (SW8015)

Gasoline Range Organics (SW8015)

There were no problems with the analyses and all data for associated QC met EPA or laboratory specifications except where noted in the Case Narrative.

If you have any questions regarding these tests results, please feel free to call.

Sincerely,

A handwritten signature in black ink, appearing to be 'David Cox'.

David Cox



OFF: (505) 325-5667



LAB: (505) 325-1556

On Site Technologies, LTD.

Date: 11-Mar-99

CLIENT: Conoco, Inc.
Project: Kate Standage 1 DHP
Lab Order: 9902098

CASE NARRATIVE

Samples were analyzed using the methods outlined in the following references:

Test Methods for Evaluating Solid Waste, Physical/Chemical Methods, SW846, 3rd Edition

All method blanks, laboratory spikes, and/or matrix spikes met quality assurance objectives.

OFF: (505) 325-5667



LAB: (505) 325-1556

ANALYTICAL REPORT

Date: 11-Mar-99

Client:	Conoco, Inc.	Client Sample Info:	Kate Standage 1 DHP
Work Order:	9902098	Client Sample ID:	Center of Pit
Lab ID:	9902098-01A	Matrix:	SOIL
Project:	Kate Standage 1 DHP	Collection Date:	2/25/99
		COC Record:	5716

Parameter	Result	PQL	Qual	Units	DF	Date Analyzed
DIESEL RANGE ORGANICS		SW8015				Analyst: HR
T/R Hydrocarbons: C10-C28	ND	25		mg/Kg	1	3/10/99
GASOLINE RANGE ORGANICS		SW8015				Analyst: HR
T/R Hydrocarbons: C6-C10	ND	0.18		mg/Kg	1	3/2/99

Qualifiers:

PQL - Practical Quantitation Limit

ND - Not Detected at Practical Quantitation Limit

J - Analyte detected below Practical Quantitation Limit

B - Analyte detected in the associated Method Blank

S - Spike Recovery outside accepted recovery limits

R - RPD outside accepted recovery limits

E - Value above quantitation range

Surr: - Surrogate

1 of 1

P.O. BOX 2606 • FARMINGTON, NM 87499

- TECHNOLOGY BLENDING - INTEGRITY WITH THE ENVIRONMENT -

