

(SUBMIT IN TRIPLICATE)

UNITED STATES
DEPARTMENT OF THE INTERIOR
GEOLOGICAL SURVEY

Land Office **SF**
Lease No. **081299**
Unit **Williams**

SUNDRY NOTICES AND REPORTS ON WELLS

RECEIVED

NOTICE OF INTENTION TO DRILL	<input checked="" type="checkbox"/>	SUBSEQUENT REPORT OF WATER SHUT-OFF	
NOTICE OF INTENTION TO CHANGE PLANS		SUBSEQUENT REPORT OF SHOOTING OR ACIDIZING	
NOTICE OF INTENTION TO TEST WATER SHUT-OFF		SUBSEQUENT REPORT OF ALTERING CASING	
NOTICE OF INTENTION TO RE-DRILL OR REPAIR WELL		SUBSEQUENT REPORT OF RE-DRILLING OR REPAIR	
NOTICE OF INTENTION TO SHOOT OR ACIDIZE		SUBSEQUENT REPORT OF ABANDONMENT	
NOTICE OF INTENTION TO PULL OR ALTER CASING		SUPPLEMENTARY WELL HISTORY	
NOTICE OF INTENTION TO ABANDON WELL			

OCT 26 1959

U. S. GEOLOGICAL SURVEY
FARMINGTON, NEW MEXICO

(INDICATE ABOVE BY CHECK MARK NATURE OF REPORT, NOTICE, OR OTHER DATA)

October 21, 1959

Well No. 3 is located 1650 ft. from N line and 2310 ft. from E line of sec. 11
NW SE/4 Section 11 30N 16W NMPM
(1/4 Sec. and Sec. No.) (Twp.) (Range) (Meridian)
Horseshoe Gallup Ext. San Juan New Mexico
(Field) (County or Subdivision) (State or Territory)

The elevation of the derrick floor above sea level is 5443 ft.

DETAILS OF WORK

(State names of and expected depths to objective sands; show sizes, weights, and lengths of proposed casings; indicate mudding jobs, cementing points, and all other important proposed work)

It is intended to drill a well through the Lower-Gallup Formation using rotary tools and mud circulation. Possible productive intervals will be perforated and sandall fractured. Estimated Total Depth 2240'.

Casing Program:

9-5/8" at 100' with 125 sacks cement circulated to surface.
5-1/2" at 2240' with 100 sacks cement.

The NW SE/4 of Section 11 is dedicated to this well.

NW SE/4 Section 11 SF-081299



I understand that this plan of work must receive approval in writing by the Geological Survey before operations may be commenced.

Company El Paso Natural Gas Products Company

Address Post Office Box 1565
Farmington, New Mexico

ORIGINAL SIGNED BY: WILLIAM K. GLAZENER

By _____
Title Petroleum Engineer

NEW MEXICO OIL CONSERVATION COMMISSION

Well Location and Acreage Dedication Plat

Section A.

Date October 21, 1959

Operator El Paso Natural Gas Products Company Lease Williams **SP-081299**
Well No. 3 Unit Letter J Section 11 Township 30 North Range 16 West NMPN
Located 1650' Feet From South Line, 2310' Feet From East Line
County San Juan G. L. Elevation 5441 Dedicated Acreage 40 Acres
Name of Producing Formation Lower-Gallup Pool Horseshoe Gallup Est.

1. Is the Operator the only owner* in the dedicated acreage outlined on the plat below?
Yes X No
2. If the answer to question one is "no," have the interests of all the owners been consolidated by communitization agreement or otherwise? Yes No . If answer is "yes,"
Type of Consolidation
3. If the answer to question two is "no," list all the owners and their respective interests below:

Owner

Land Description

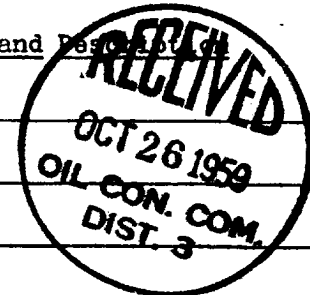

Section. B

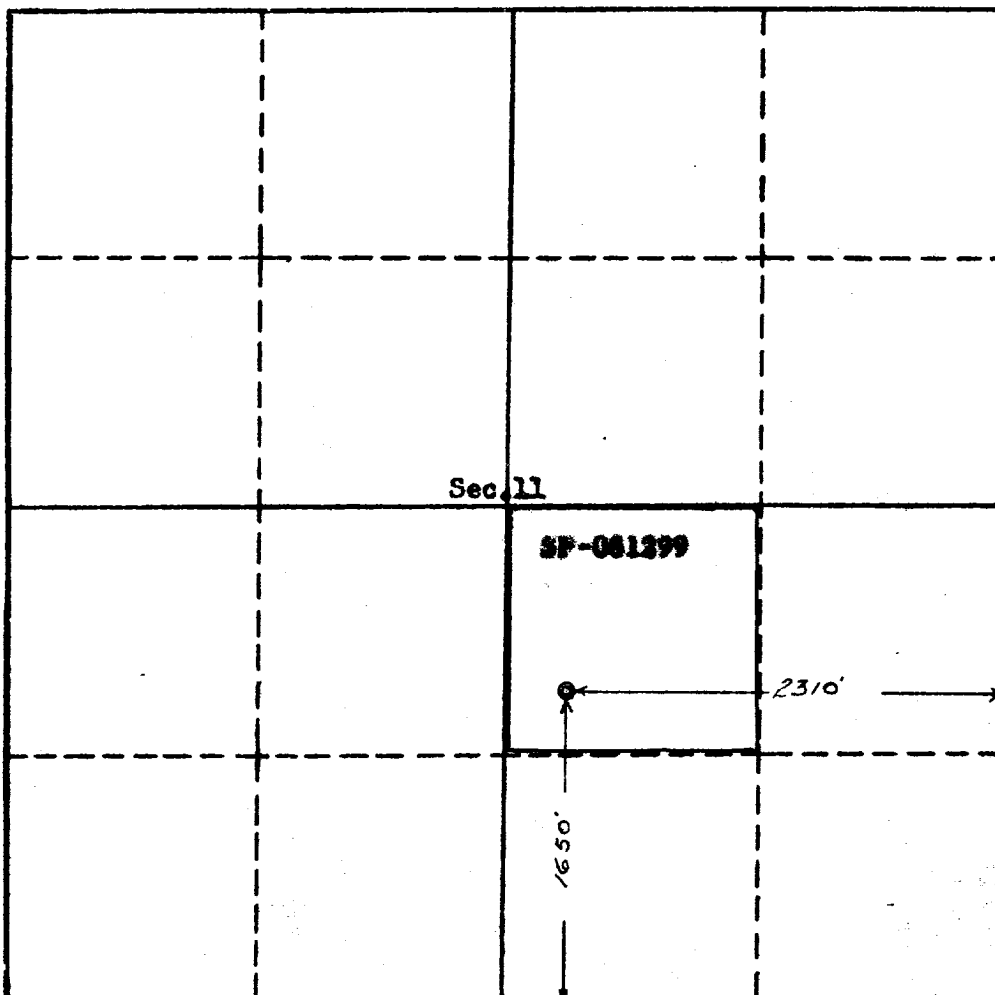

This is to certify that the information in Section A above is true and complete to the best of my knowledge and belief.

El Paso Natural Gas Products Co.

(Operator)

William K. Mayone
(Representative)

Box 1365, Farmington, New Mexico

Address

This is to certify that the well location shown on the plat in Section B was plotted from field notes of a well survey made by me or under my supervision and that the same is true to the best of my knowledge and belief.

Date Surveyed August 17, 1959

Ernest V. Echobawk
Ernest V. Echobawk
Registered Land Surveyor.

Certificate No. 1545

