

(SUBMIT IN TRIPLICATE)

UNITED STATES  
DEPARTMENT OF THE INTERIOR  
GEOLOGICAL SURVEY

Land Office SP 078139Lease No. A. F. Elliott #C1

Unit \_\_\_\_\_

## SUNDRY NOTICES AND REPORTS ON WELLS

NOTICE OF INTENTION TO DRILL	<input checked="" type="checkbox"/>	SUBSEQUENT REPORT OF WATER SHUT-OFF	
NOTICE OF INTENTION TO CHANGE PLANS		SUBSEQUENT REPORT OF SHOOTING OR ACIDIZING	
NOTICE OF INTENTION TO TEST WATER SHUT-OFF		SUBSEQUENT REPORT OF ALTERING CASING	
NOTICE OF INTENTION TO RE-DRILL OR REPAIR WELL		SUBSEQUENT REPORT OF RE-DRILLING OR REPAIR	
NOTICE OF INTENTION TO SHOOT OR ACIDIZE		SUBSEQUENT REPORT OF ABANDONMENT	
NOTICE OF INTENTION TO PULL OR ALTER CASING		SUPPLEMENTARY WELL HISTORY	
NOTICE OF INTENTION TO ABANDON WELL			

(INDICATE ABOVE BY CHECK MARK NATURE OF REPORT, NOTICE, OR OTHER DATA)

E. F. Elliott #C1 Farmington, New Mexico December 8, 1958

Well No. 2 is located 1755 ft. from [N] line and 1455 ft. from [E] line of sec. 9

1/4 Section 9 T-30-N R-9-W N.M.P.M.  
(1/4 Sec. and Sec. No.) (Twp.) (Range) (Meridian)  
Blanco-Pictured Cliffs San Juan New Mexico  
(Field) (County or Subdivision) (State or Territory)

The elevation of the derrick floor above sea level is \_\_\_\_\_ ft. (To be reported later.)

## DETAILS OF WORK

(State names of and expected depths to objective sands; show sizes, weights, and lengths of proposed casings; indicate mudding jobs, cementing points, and all other important proposed work)

We propose to drill the above well with rotary tools to an approximate total depth of 3040' to complete in the Pictured Cliffs formation. Stimulation will be indicated on reaching total depth.

## Proposed casing program:

SIZE	DEPTH	WEIGHT
4-5/8"	300'	250
5-1/2"	3040'	

circulate

circulate to surface sufficient to fill above pay.

Copies of location plat are attached. Logs will be furnished upon completion of well.

I understand that this plan of work must receive approval in writing by the Geological Survey before operations may be commenced.

Company Pan American Petroleum Corporation

Address Box 487

Farmington, New Mexico

ORIGINAL SIGNED BY

By D. J. SCOTT

Title Field Clerk

NEW MEXICO OIL CONSERVATION COMMISSION

Well Location and Acreage Dedication Plat

Section A.

Date December 8, 1958

Operator PAN AMERICAN PETROLEUM CORPORATION Lease E. E. Elliot "C"  
Well No. 2 Unit Letter F Section 9 Township 30 North Range 9 West NMPM  
Located 1755 Feet From North Line, 1455 Feet From West Line  
County San Juan G. L. Elevation \* Dedicated Acreage 160 Acres  
Name of Producing Formation Pictured Cliffs Pool Blanco Pictured Cliffs

1. Is the Operator the only owner\* in the dedicated acreage outlined on the plat below?  
Yes X No        \*To be reported later
2. If the answer to question one is "no," have the interests of all the owners been consolidated by communitization agreement or otherwise? Yes        No       . If answer is "yes,"  
Type of Consolidation
3. If the answer to question two is "no," list all the owners and their respective interests below:

Owner

Land Description

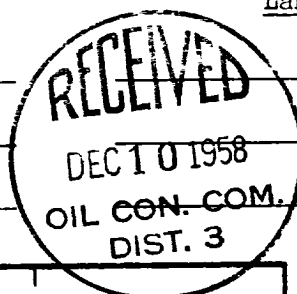

Section. B

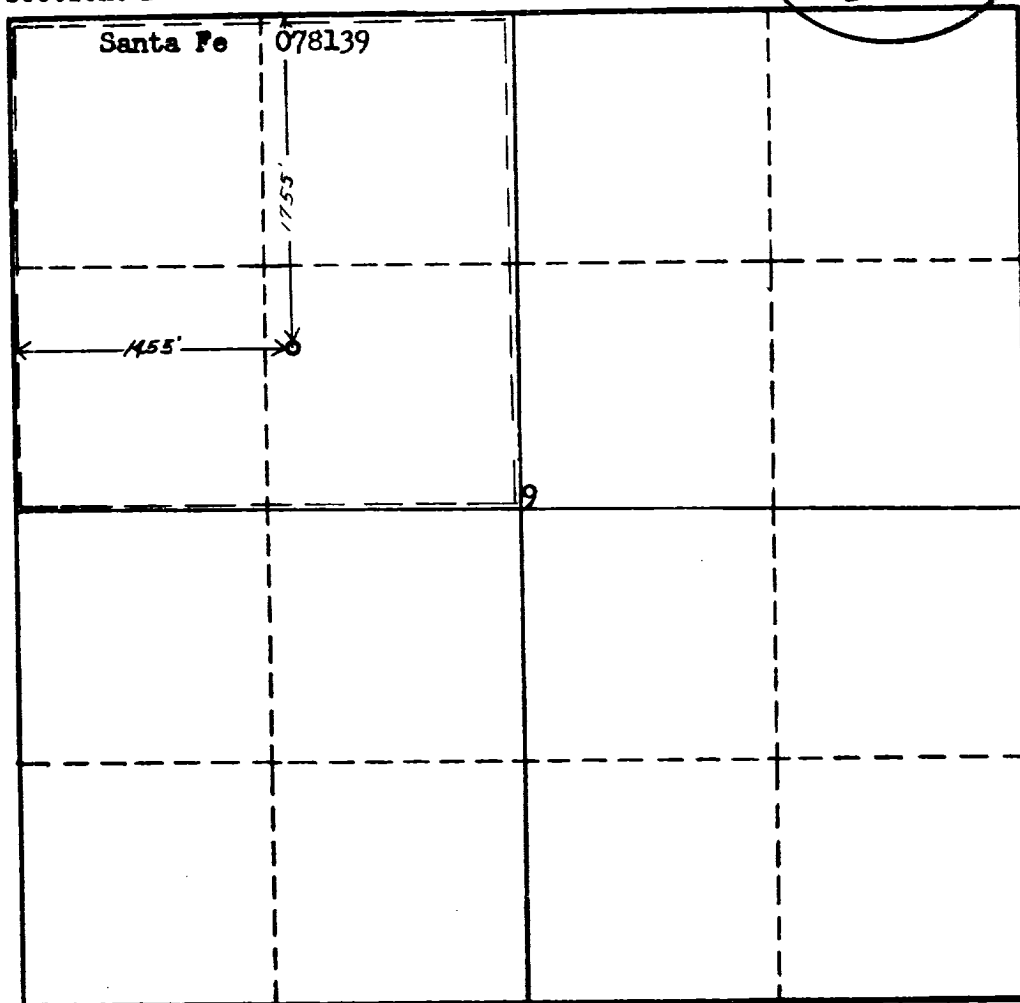

This is to certify that the information in Section A above is true and complete to the best of my knowledge and belief.

PAN AMERICAN PETROLEUM CORP.  
(Operator)

R.M. Bauer, Jr. *R.M. Bauer, Jr.*  
(Representative)

Box 487, Farmington, New Mexico  
Address

This is to certify that the well location shown on the plat in Section B was plotted from field notes of actual surveys made by me or under my supervision and that the same is true and correct to the best of my knowledge and belief.

Date Surveyed Dec. 4, 1958

*Ernest V. Echohawk*  
Ernest V. Echohawk  
Registered Land Surveyor.

Certificate No. 1545

