

(SUBMIT IN TRIPLICATE)

UNITED STATES
DEPARTMENT OF THE INTERIOR
GEOLOGICAL SURVEY

Land Office **New Mexico**
Lease No. **03195-A**
Unit

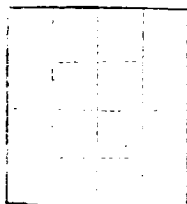

SUNDRY NOTICES AND REPORTS ON WELLS

RECEIVED

MAY 24 1963

U. S. GEOLOGICAL SURVEY
FARMINGTON, NEW MEXICO

| | | |
|--|-------------------------------------|--|
| NOTICE OF INTENTION TO DRILL | <input type="checkbox"/> | SUBSEQUENT REPORT OF WATER SHUT-OFF |
| NOTICE OF INTENTION TO CHANGE PLANS | <input checked="" type="checkbox"/> | SUBSEQUENT REPORT OF SHOOTING OR ACIDIZING |
| NOTICE OF INTENTION TO TEST WATER SHUT-OFF | <input type="checkbox"/> | SUBSEQUENT REPORT OF ALTERING CASING |
| NOTICE OF INTENTION TO RE-DRILL OR REPAIR WELL | <input type="checkbox"/> | SUBSEQUENT REPORT OF RE-DRILLING OR REPAIR |
| NOTICE OF INTENTION TO SHOOT OR ACIDIZE | <input type="checkbox"/> | SUBSEQUENT REPORT OF ABANDONMENT |
| NOTICE OF INTENTION TO PULL OR ALTER CASING | <input type="checkbox"/> | PERMANENT WELL LOGS |
| NOTICE OF INTENTION TO ABANDON WELL | <input type="checkbox"/> | |

INDICATE ABOVE BY CHECK MARK NATURE OF REPORT, NOTIFY, OR DATE

November 11

19 62

Sullivan

Well No. 1 (OWWO) is located 1694 ft. from ☒ N line and 1090 ft. from ☒ E line of sec. 7

NE/4 Section 7

30-N

10-W

N.M.P.M.

Blanco Mesa Verde

San Juan

New Mexico

The elevation of the derrick floor above sea level is 6206 ft.

DETAILS OF WORK

(State names of and expected depths to objective sands; show sizes, weights, and lengths of proposed casings; indicate mudlogging jobs, cementing points, and all other important proposed work)

It is intended to change plans as follows:

1. Plug the Point Lookout zone w/200 sacks cement.
2. Perforate & fracture the Cliff House formation. (4 1/2" casing will not be run.)



I understand that this plan of work must receive approval in writing by the Geological Survey before operations may be commenced.

Company **El Paso Natural Gas Company**

Address **Box 990**

Farmington, New Mexico

By

E. S. Olney

Title **Petroleum Engineer**



(SUBMIT IN TRIPLICATE)

UNITED STATES
DEPARTMENT OF THE INTERIOR
GEOLOGICAL SURVEY

Land Office **New Mexico**

Lease No. **03195-A**

Unit

SUNDRY NOTICES AND REPORTS ON WELLS

NOTICE OF INTENTION TO DRILL
NOTICE OF INTENTION TO CHANGE PLANS
NOTICE OF INTENTION TO TEST WATER SHUT-OFF
NOTICE OF INTENTION TO RE-DRILL OR REPAIR WELL
NOTICE OF INTENTION TO SHOOT OR ACIDIZE
NOTICE OF INTENTION TO PULL OR ALTER CASING
NOTICE OF INTENTION TO ABANDON WELL

SUBSEQUENT REPORT OF WATER SHUT-OFF
SUBSEQUENT REPORT OF SHOOTING OR ACIDIZING
SUBSEQUENT REPORT OF ALTERING CASING
SUBSEQUENT REPORT OF RE-DRILLING OR REPAIR
SUBSEQUENT REPORT OF ABANDONMENT
SUPPLEMENTARY WELL HISTORY

X

INDICATE ABOVE BY CHECK MARK NATURE OF TEST, SOURCE OF OTHER DATA.

May 22

1963

Sullivan
Well No. 1 (OWWO) is located 1694 ft. from ~~XXX~~ ^N line and 1090 ft. from ~~XXX~~ ^E line of sec. 7

NE/4 Section 7
(1/4 Sec. and 1/4 Sec. No.)
Blanco Mesa Verde
(Folio)

30-N
(Twp.)
San Juan

10-W
(R. 20)

N.M.P.M.

New Mexico

RECEIVED

MAY 24 1963

The elevation of the derrick floor above sea level is 6206 ft.

DETAILS OF WORK

U. S. GEOLOGICAL SURVEY
FARMINGTON, NEW MEXICO

(State names of and expected depths to objective sands; show sizes, weights, and lengths of proposed casings; indicate mudding jobs, cementing points, and all other important proposed work)

On 11-8-62 the Point Lookout zone was plugged in the following manner:

1. Set cast iron cement retainer @ 4530'.
2. Squeezed Point Lookout formation w/200 sacks cement (4530-5176')



I understand that this plan of work must receive approval in writing by the Geological Survey before operations may be commenced.

Company **El Paso Natural Gas company**

Address **Box 990**

Farmington, New Mexico

By

Title **Petroleum Engineer**