

NEW MEXICO OIL CONSERVATION COMMISSION
Santa Fe, New Mexico

NOTICE OF INTENTION TO DRILL OR RECOMPLETE

Notice must be given to the District Office of the Oil Conservation Commission and approval obtained before drilling or recompleting begins. If changes in the proposed plan are considered advisable, a copy of this notice showing such changes will be returned to the sender. Submit this notice in QUINTUPLICATE. One copy will be returned following approval. See additional instructions in Rules and Regulations of the Commission.

AZTEC, NEW MEXICO
(Place)

JULY 19, 1954
(Date)

OIL CONSERVATION COMMISSION
SANTA FE, NEW MEXICO

Gentlemen:

You are hereby notified that it is our intention to commence the (Drilling) (Recompletion) of a well to be known as

W. P. CARR

(Company or Operator)

JONES

(Lease)

Well No. **1**, in _____, (Unit) The well is

located **1750** feet from the **NORTH** line and **1740** feet from the

EAST

line of Section **7**, T. **30 N.**, R. **11 W.**, NMPM.

(GIVE LOCATION FROM SECTION LINE) **AZTEC PICTURED CLIFF** Pool, **SAN JUAN** County

If State Land the Oil and Gas Lease is No.

If patented land the owner is.

Address.

We propose to drill well with drilling equipment as follows: **WE WILL SET SURFACE**

CASING WITH CABLE TOOLS, ALL OTHER DRILLING WITH ROTARY

The status of plugging bond is **APPROVED**

Drilling Contractor **GREEN-SMITH DRILLING CORP.**

315 1/2 W. MAIN ST.

FARMINGTON, NEW MEXICO

We intend to complete this well in the **PICTURED CLIFFS FORMATION**

formation at an approximate depth of **2050** feet.

CASING PROGRAM

We propose to use the following strings of Casing and to cement them as indicated:

Size of Hole	Size of Casing	Weight per Foot	New or Second Hand	Depth	Sacks Cement
12-5/8	8-5/8	24	NEW	80-150	CIRCULATE
7-7/8	5-1/2	15.5	NEW	2050	50-150 8X.

If changes in the above plans become advisable we will notify you immediately.

ADDITIONAL INFORMATION (If recompleting give full details of proposed plan of work.)

WE WILL DRILL THROUGH THE PICTURED CLIFF FORMATION WITH ROTARY TOOLS. AFTER ELECTRIC LOGGING WE WILL SET 5 1/2" CASING ON TOP PRODUCING ZONE. WE WILL SHOOT THE INDICATED SECTIONS USING 2 1/2 TO 4 QTS. OF SOLID NITROGLYCERIN PER FOOT.

Approved **7-21, 1954**
Except as follows:

Sincerely yours,

W. P. CARR

(Company or Operator)

By **C. R. Phet**

Position **SUPT.**

Send Communications regarding well to

Name **W. P. CARR**

Address **6700 FOREST LANE**

DALLAS 30, TEXAS

OIL CONSERVATION COMMISSION

By **Ernest L. Howard**

Title **Oil and Gas Inspector Dist. #3.**

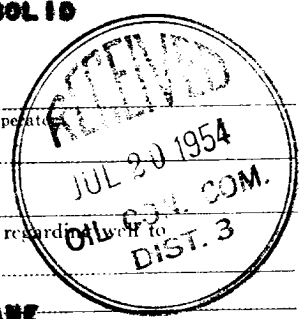

FEDERAL

80 ACRES

**CHARLES E. AND RUDY LAMORE JONES
AZTEC, NEW MEXICO**

60 ACRES

**FRANK AND LULA C. RIDENOUR
DURANGO, COLORADO**

20 ACRES

NEW MEXICO
OIL CONSERVATION COMMISSION

Gas Well Plat

Date JULY 20, 1954

W. P. CARR
Operator

JONES
Lease

1
Well No.

Name of Producing Formation PICTURED CLIFF Pool ATTEC PICTURED CLIFF

No. Acres Dedicated to the Well 160

Indicate Land Ownership Status. (Federal, State, Patented)

SECTION 7 TOWNSHIP 36 N. RANGE 11 W.

	80 ACRES FEDERAL		
	60 ACRES CHARLES E. AND RUBY LA MORE JONES		20 ACRES FRANK AND LULA C. RIDENOUR

I hereby certify that the information given above is true and complete to the best of my knowledge.

Name C. R. Short
Position Supt
Representing W. P. Carr
Address Dallas Tex

(over)

Company W.P.CARR

Lease JONES

Well No. 1

Sec. 7 T. 30 N R. 11 W N.M.P.M.

Location 1750 feet from north line; 1740 feet
from east line.

Elevation: 5689.6 GL.

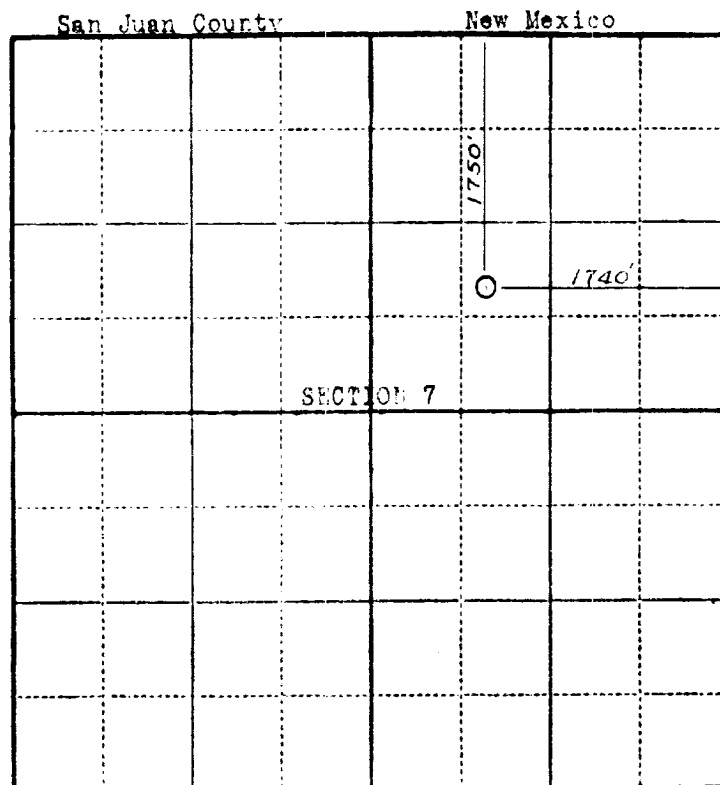

Scale--4 inches equal 1 mile.

This is to certify that the above plat was prepared from field notes of actual surveys made by me or under my supervision and that the same are true and correct to the best of my knowledge and belief

Stephen H. Kinney
STEPHEN H. KINNEY
Registered Professional
Engineer and Land Surveyor

Surveyed July 8, 1954

Seal:

OIL CONSERVATION COMMISSION		
AZTEC DISTRICT OFFICE		
No. Copies Received <u>5</u>		
DISTRIBUTION		
	NO. FURNISHED	
Operator	<u>1</u>	
Santa Fe	<u>1</u>	
Exploration Office		
State Land Office		
U. S. G. S.	<u>2</u>	
Transporter		
File	<u>1</u>	<input checked="" type="checkbox"/>