

(SUBMIT IN TRIPLICATE)

UNITED STATES
DEPARTMENT OF THE INTERIOR
GEOLOGICAL SURVEY

Land Office **Santa Fe**
Lease No. **081226-B**
Unit **Bolack**

SUNDRY NOTICES AND REPORTS ON WELLS

| | | | |
|--|-------------------------------------|--|--|
| NOTICE OF INTENTION TO DRILL | <input checked="" type="checkbox"/> | SUBSEQUENT REPORT OF WATER SHUT-OFF | |
| NOTICE OF INTENTION TO CHANGE PLANS | | SUBSEQUENT REPORT OF SHOOTING OR ACIDIZING | |
| NOTICE OF INTENTION TO TEST WATER SHUT-OFF | | SUBSEQUENT REPORT OF ALTERING CASING | |
| NOTICE OF INTENTION TO RE-DRILL OR REPAIR WELL | | SUBSEQUENT REPORT OF RE-DRILLING OR REPAIR | |
| NOTICE OF INTENTION TO SHOOT OR ACIDIZE | | SUBSEQUENT REPORT OF ABANDONMENT | |
| NOTICE OF INTENTION TO PULL OR ALTER CASING | | SUPPLEMENTARY WELL HISTORY | |
| NOTICE OF INTENTION TO ABANDON WELL | | | |

(INDICATE ABOVE BY CHECK MARK NATURE OF REPORT, NOTICE, OR OTHER DATA)

December 10th, 19 58

Well No. 14 is located 1650 ft. from N line and 1750 ft. from E line of sec. 9
SW/4 NE/4 Sec. 9 30N 16W N.M.P.M.
 (1/4 Sec. and Sec. No.) (Twp.) (Range) (Meridian)
Horseshoe Gallup San Juan New Mexico
 (Field) (County or Subdivision) (State or Territory)

The elevation of the derrick floor above sea level is 5462 ft.

DETAILS OF WORK

(State names of and expected depths to objective sands; show sizes, weights, and lengths of proposed casings; indicate mudlogging jobs, cementing points, and all other important proposed work)

Gallup test. Estimated total depth 1500'.

Surface Casing: 90' of 8-5/8" OD 24# J-55 cemented to surface.
 Production : Approximately 1500' of 5-1/2" OD 15# J-55 cemented with 75 sacks.

If commercial production is indicated, the producing section will be sand-oil fractured.

I understand that this plan of work must receive approval in writing by the Geological Survey before operations may be commenced.

Company TON BOLACK
 Address 1010 North Dustin
Farmington, New Mexico
 By Tom Bolack
 Title _____

UNITED STATES
DEPARTMENT OF THE INTERIOR
BUREAU OF LAND MANAGEMENT

0-13256-2

Form 100

UNITED STATES
DEPARTMENT OF THE INTERIOR
BUREAU OF LAND MANAGEMENT
GEOLOGICAL SURVEY

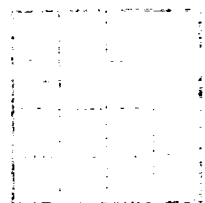

SUNDAY NOTICE AND REPORTS ON WELLS

| | | |
|---------------------|----------------------|---------------------|
| 1. NAME OF WELL | 2. LOCATION | 3. DATE OF SURVEY |
| 4. NAME OF SURVEYOR | 5. NAME OF COMPANY | 6. NAME OF ENGINEER |
| 7. NAME OF OPERATOR | 8. NAME OF ASSISTANT | 9. NAME OF RECORDER |
| 10. NAME OF WITNESS | 11. NAME OF WITNESS | 12. NAME OF WITNESS |
| 13. NAME OF WITNESS | 14. NAME OF WITNESS | 15. NAME OF WITNESS |
| 16. NAME OF WITNESS | 17. NAME OF WITNESS | 18. NAME OF WITNESS |

(PRINT NAME AND ADDRESS OF SURVEYOR OR COMPANY AT FOOT OF PAGE)

1. NAME OF WELL
2. LOCATION
3. DATE OF SURVEY
4. NAME OF SURVEYOR
5. NAME OF COMPANY
6. NAME OF ENGINEER
7. NAME OF OPERATOR
8. NAME OF ASSISTANT
9. NAME OF RECORDER
10. NAME OF WITNESS
11. NAME OF WITNESS
12. NAME OF WITNESS
13. NAME OF WITNESS
14. NAME OF WITNESS
15. NAME OF WITNESS
16. NAME OF WITNESS
17. NAME OF WITNESS
18. NAME OF WITNESS

DETAILS OF WORK

(This section is to be filled out by the surveyor or company at the foot of the page.)

1. NAME OF WELL
2. LOCATION
3. DATE OF SURVEY
4. NAME OF SURVEYOR
5. NAME OF COMPANY
6. NAME OF ENGINEER
7. NAME OF OPERATOR
8. NAME OF ASSISTANT
9. NAME OF RECORDER
10. NAME OF WITNESS
11. NAME OF WITNESS
12. NAME OF WITNESS
13. NAME OF WITNESS
14. NAME OF WITNESS
15. NAME OF WITNESS
16. NAME OF WITNESS
17. NAME OF WITNESS
18. NAME OF WITNESS

1. NAME OF WELL
2. LOCATION
3. DATE OF SURVEY
4. NAME OF SURVEYOR
5. NAME OF COMPANY
6. NAME OF ENGINEER
7. NAME OF OPERATOR
8. NAME OF ASSISTANT
9. NAME OF RECORDER
10. NAME OF WITNESS
11. NAME OF WITNESS
12. NAME OF WITNESS
13. NAME OF WITNESS
14. NAME OF WITNESS
15. NAME OF WITNESS
16. NAME OF WITNESS
17. NAME OF WITNESS
18. NAME OF WITNESS

1. NAME OF WELL
2. LOCATION
3. DATE OF SURVEY
4. NAME OF SURVEYOR
5. NAME OF COMPANY
6. NAME OF ENGINEER
7. NAME OF OPERATOR
8. NAME OF ASSISTANT
9. NAME OF RECORDER
10. NAME OF WITNESS
11. NAME OF WITNESS
12. NAME OF WITNESS
13. NAME OF WITNESS
14. NAME OF WITNESS
15. NAME OF WITNESS
16. NAME OF WITNESS
17. NAME OF WITNESS
18. NAME OF WITNESS

(This section is to be filled out by the surveyor or company at the foot of the page.)

1. NAME OF WELL

2. LOCATION

3. DATE OF SURVEY

4. NAME OF SURVEYOR

5. NAME OF COMPANY

NEW MEXICO OIL CONSERVATION COMMISSION

Well Location and Acreage Dedication Plat

Section A.

Date December 10, 1958

Operator Tom Bolack Lease Bolack
Well No. 14 Unit Letter Section 9 Township 30 North Range 16 West
Located 1650 Feet From North Line, 1750 Feet From East Line
County San Juan G. L. Elevation 5454 Dedicated Acreage
Name of Producing Formation Pool

1. Is the Operator the only owner* in the dedicated acreage outlined on the plat below?
Yes No
2. If the answer to question one is "no," have the interests of all the owners been consolidated by communitization agreement or otherwise? Yes No . If answer is "yes,"
Type of Consolidation
3. If the answer to question two is "no," list all the owners and their respective interests below:

Owner

Land Description



Section B

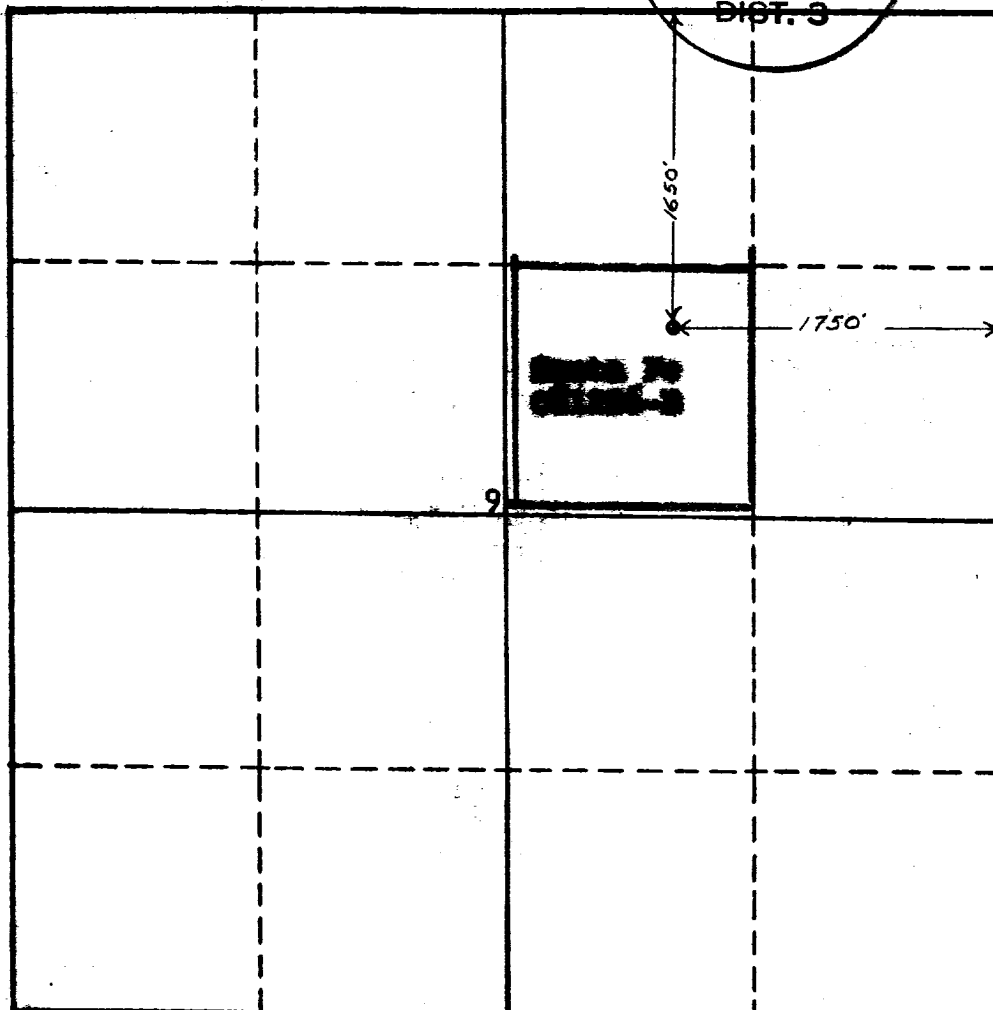

This is to certify that the information in Section A above is true and complete to the best of my knowledge and belief.

Tom Bolack
(Operator)

(Representative)

Address

This is to certify that the well location on the plat in Section A was located from field notes of actual surveys made by or under my supervision and that the same is true and correct to the best of my knowledge and belief.

Date Surveyed Dec. 6, 1958

Ernest V. Echohawk
Ernest V. Echohawk
Registered Land Surveyor.

Certificate No. 1545

