

(SUBMIT IN TRIPLICATE)

UNITED STATES
DEPARTMENT OF THE INTERIOR
GEOLOGICAL SURVEY

Land Office **ST 00123-C**
Lease No. **XXXXXXXXXX**
Unit **XXXXXXXXXX**

SUNDRY NOTICES AND REPORTS ON WELLS

| | | | |
|--|-------------------------------------|--|--|
| NOTICE OF INTENTION TO DRILL (XXXXXXXXXX) | <input checked="" type="checkbox"/> | SUBSEQUENT REPORT OF WATER SHUT-OFF | |
| NOTICE OF INTENTION TO CHANGE PLANS | | SUBSEQUENT REPORT OF SHOOTING OR ACIDIZING | |
| NOTICE OF INTENTION TO TEST WATER SHUT-OFF | | SUBSEQUENT REPORT OF ALTERING CASING | |
| NOTICE OF INTENTION TO RE-DRILL OR REPAIR WELL | | SUBSEQUENT REPORT OF RE-DRILLING OR REPAIR | |
| NOTICE OF INTENTION TO SHOOT OR ACIDIZE | | SUBSEQUENT REPORT OF ABANDONMENT | |
| NOTICE OF INTENTION TO PULL OR ALTER CASING | | SUPPLEMENTARY WELL HISTORY | |
| NOTICE OF INTENTION TO ABANDON WELL | | | |

(INDICATE ABOVE BY CHECK MARK NATURE OF REPORT, NOTICE, OR OTHER DATA)

• CHANGED WELL LOCATION

December 11, 19**50**

Well No. **2** is located **1746** ft. from **[N]** line and **1122** ft. from **[E]** line of sec. **9**

NE 1/4 Section 9 **30N** **14W** **100M**
(Field) (County or Subdivision) (Meridian) **NEW MEXICO**

The elevation of the derrick floor above sea level is **3434** ft.

DETAILS OF WORK

(State names of and expected depths to objective sands; show sizes, weights, and lengths of proposed casings; indicate mudding jobs, cementing points, and all other important proposed work)

Objective Sands: Lower Gailup @ approx. 1500'
Surface Casings: 8-6/8" 24' @ approx. 100' w/100 cu.
Production Casings: 3 1/2" 21.50 J-55 @ 20 w/100 cu.
Red Pumping: Wgt. 2.50/gal, Vls. 40-50 & Wtr Loss 8 cu; to cement @ 100'
Cementing Pumping: 8" to 100' & 700' to 20
Casing: None anticipated

I understand that this plan of work must receive approval in writing by the Geological Survey before operations may be commenced.

SEINO-ARLAS, INC.

Company **720 E. Main St.**

Address **Farmington, New Mexico**

ORIGINAL SIGNED BY

N. B. GOVE

By **E. L. GORE**

Title **XXXXXXXXXX**

NEW MEXICO OIL CONSERVATION COMMISSION

WELL LOCATION AND ACREAGE DEDICATION PLAT

FORM C-128
Revised 3/1/57

SEE INSTRUCTIONS FOR COMPLETING THIS FORM ON THE REVERSE SIDE

SECTION A

| | | | | | |
|--|--------------------------------------|-----------------------------|---|---------------------------|---------------------------------------|
| Operator PETRO-ATLAS, INC. | | | Lease XXXX HORSESHOE CANYON "B" | | Well No. 2 |
| Unit Letter H | Section 9 | Township 30 NORTH | Range 16 WEST | County SAN JUAN | |
| Actual Footage Location of Well: 1746 feet from the North line and 1122 feet from the East line | | | | | |
| Ground Level Elev. 5462.0 | Producing Formation GALLUP | | Pool HORSESHOE GALLUP | | Dedicated Acreage: 40 Acres |

1. Is the Operator the only owner in the dedicated acreage outlined on the plat below? YES ☒ NO ☐ ("Owner" means the person who has the right to drill into and to produce from any pool and to appropriate the production either for himself or for himself and another. (65-3-29 (e) NMSA 1935 Comp.)
2. If the answer to question one is "no," have the interests of all the owners been consolidated by communitization agreement or otherwise? YES ☐ NO ☐ If answer is "yes," Type of Consolidation _____
3. If the answer to question two is "no," list all the owners and their respective interests below:

| Owner | Land Description |
|-------|------------------|
| | |
| | |

SECTION B

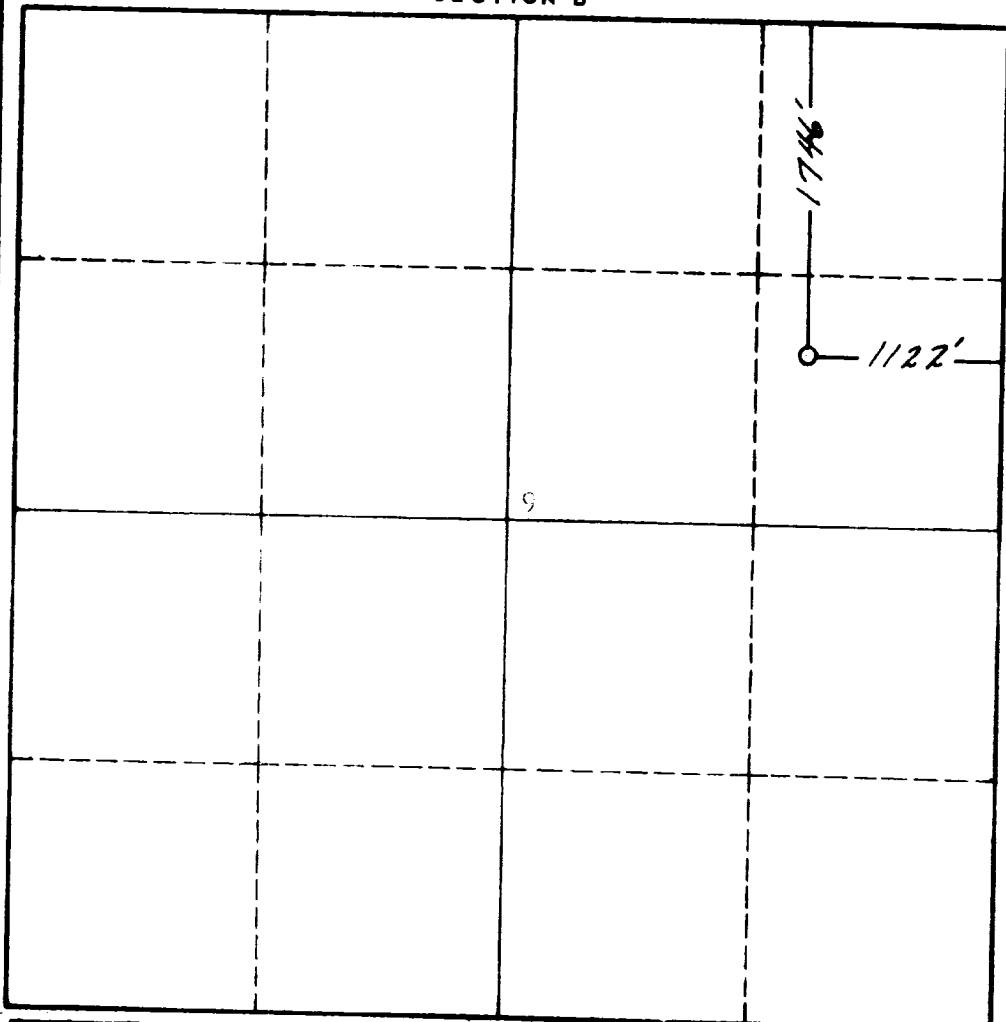

CERTIFICATION

I hereby certify that the information in SECTION A above is true and complete to the best of my knowledge and belief.

Name
J. S. Galt

Position
**N.B. GALT
ENGINEER**

Company
PETRO-ATLAS, INC.

Date
December 12, 1958

I hereby certify that the well location shown on the plat in SECTION B was plotted from field notes of actual surveys made by me or under my supervision, and that the same is true and correct to the best of my knowledge and belief.

Date Surveyed

Registered Professional Engineer
and/or Land Surveyor
[Signature]

Certificate No.

0 330 660 990 1320 1650 1980 2310 2640 2970 3300 3630 3960 4290 4620 4950 5280 5610 5940 6270 6600