

(SUBMIT IN TRIPLICATE)

Indian Agency **Havas**

Window Rock, Arizona

UNITED STATES
DEPARTMENT OF THE INTERIOR
GEOLOGICAL SURVEY

Allottee **14-20-0000-0000**

Lease No. **Havas Allotment #043004**

SUNDRY NOTICES AND REPORTS ON WELLS

NOTICE OF INTENTION TO DRILL	SUBSEQUENT REPORT OF WATER SHUT-OFF	<div style="border: 2px solid black; padding: 5px; text-align: center;"> RECEIVED FEB 5 1963 U. S. GEOLOGICAL SURVEY FARMINGTON, NEW MEXICO </div>
NOTICE OF INTENTION TO CHANGE PLANS	SUBSEQUENT REPORT OF SHOOTING OR ACIDIZING	
NOTICE OF INTENTION TO TEST WATER SHUT-OFF	SUBSEQUENT REPORT OF ALTERING CASING	
NOTICE OF INTENTION TO REDRILL OR REPAIR WELL	SUBSEQUENT REPORT OF REDRILLING OR REPAIR	
NOTICE OF INTENTION TO SHOOT OR ACIDIZE	SUBSEQUENT REPORT OF ABANDONMENT	
NOTICE OF INTENTION TO PULL OR ALTER CASING	SUPPLEMENTARY WELL HISTORY	
NOTICE OF INTENTION TO ABANDON WELL		

(INDICATE ABOVE BY CHECK MARK NATURE OF REPORT, NOTICE, OR OTHER DATA)

February 6, 19**63**

Well No. **1 Owen** is located **1870** ft. from **S** line and **620** ft. from **W** line of sec. **6**
SW 1/4 Section 6 **30 North 15 West N.M.P.M.**
Storvick (4 Sec. and Sec. No.) (Twp.) (Range) (Meridian)
Gallup **San Juan** **New Mexico**
 (Field) (County or Subdivision) (State or Territory)

The elevation of the derrick floor above sea level is **5430** ft.

DETAILS OF WORK

(State names of and expected depths to objective sands; show sizes, weights, and lengths of proposed casings; indicate casing points, and all other important proposed work)

It is intended to drill this well in the following manner:

Drill a 8" hole to the top of the Munoz shale (approx. 750') and run and cement 750' of 7" - 17 lb. casing with 150 sacks to shut off all water. Cement to be circulated to surface.

Drill a 6 1/2" hole with air to the base of the Gallup formation (approx. 2100'). The hole will be logged and 4 1/2" - 9.6 lb. casing will be run and cemented at approximately 1850' with 75 sacks.

The open hole (1850' to 2100') will be sand oil fractured with approximately 700 barrels of oil and 30,000 lbs. of sand. Tubing will be set at approximately 2050' and a pump, rods, and pumping unit installed and the well completed.

I understand that this plan of work must receive approval in writing by the Geological Survey before operations may be commenced.

Company **N. Martin Oil & Gas Company**

Address **4706 North 32nd Place**
Phoenix, Arizona

By *[Signature]*
H. A. Clement
 Title **Agent for N. Martin Oil Co.**

NEW MEXICO OIL CONSERVATION COMMISSION

Well Location and Acreage Dedication Plat

SECTION A.

Date February 5, 1963

Operator M. Martin Oil and Gas Company Lease Owens
Well No. 1 Unit Letter L Section 6 Township 30 North Range 15 West NMPM
Located 1870 Feet From South Line, 620 Feet From West Line
County San Juan G. L. Elevation 5426 Dedicated Acreage 39.31 Acres
Name of Producing Formation Gallup Pool Ward Gallup (Horseshoe)

1. Is the Operator the only owner* in the dedicated acreage outlined on the plat below? Yes _____ No X
2. If the answer to question One is "No," have the interests of all the owners been consolidated by communitization agreement or otherwise? Yes X No _____. If answer is "Yes," Type of Consolidation Federal
3. If the answer to question Two is "No," list all the owners and their respective interests below:

OWNER

LAND DESCRIPTION

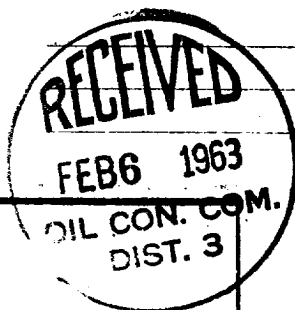

RECEIVED
FEB 5 1963

U. S. GEOLOGICAL SURVEY
FARMINGTON, NEW MEXICO

This is to certify that the information in Section A above is true and complete to the best of my knowledge and belief.

M. Martin Oil and Gas Company
(OPERATOR)

E. A. Clement
(REPRESENTATIVE)
E. A. CLEMENT
906 North Watson
Farmington, New Mexico
(ADDRESS)

SECTION B.

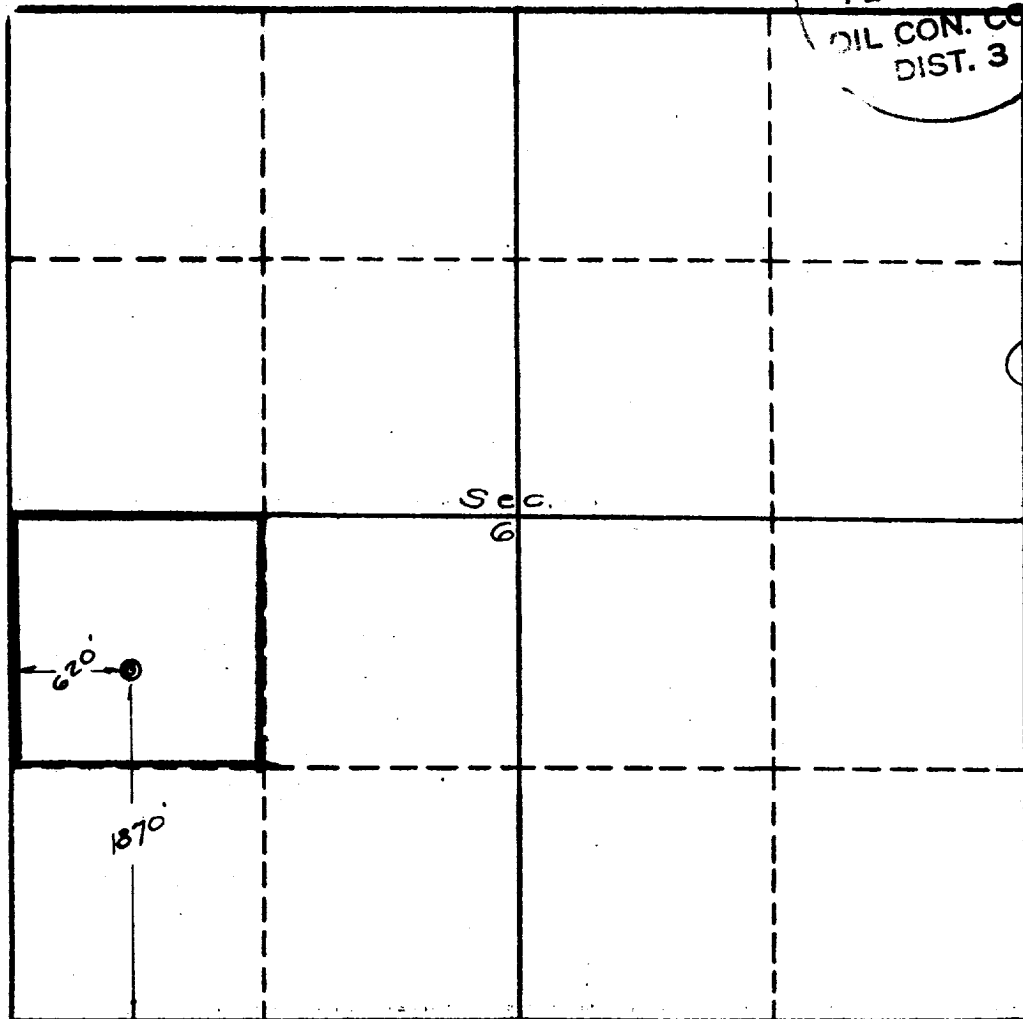

STATE OF NEW MEXICO
This is to certify that the well location shown on the plat in Section B was plotted from field notes of actual surveys made by me or under my supervision and that the same is true and correct to the best of my knowledge and belief.

Date Surveyed Feb. 4, 1963

Four States Engineering Co.
FARMINGTON, NEW MEXICO

Ernest V. Eckhardt
REGISTERED ENGINEER OR
LAND SURVEYOR

Certificate No. 3602

