

**(SUBMIT IN TRIPLICATE)**

UNITED STATES  
DEPARTMENT OF THE INTERIOR  
GEOLOGICAL SURVEY

Indian Agency \_\_\_\_\_

~~SECRET~~-----

Allottee \_\_\_\_\_

## Lease

			■

## SUNDRY NOTICES AND REPORTS ON WELLS

NOTICE OF INTENTION TO DRILL	SUBSEQUENT REPORT OF WATER SHUT-OFF
NOTICE OF INTENTION TO CHANGE PLANS	SUBSEQUENT REPORT OF SHOOTING OR ACIDIZING
NOTICE OF INTENTION TO TEST WATER SHUT-OFF	SUBSEQUENT REPORT OF ALTERING CASING
NOTICE OF INTENTION TO REDRILL OR REPAIR WELL	SUBSEQUENT REPORT OF REDRILLING OR REPAIR
NOTICE OF INTENTION TO SHOOT OR ACIDIZE	SUBSEQUENT REPORT OF ABANDONMENT
NOTICE OF INTENTION TO PULL OR ALTER CASING	SUPPLEMENTARY WELL HISTORY
NOTICE OF INTENTION TO ABANDON WELL	

**RECEIVED**

**AUG 29 1961**

**U. S. GEOLOGICAL SURVEY**

**FARMINGTON**

(INDICATE ABOVE BY CHECK MARK NATURE OF REPORT, NOTICE, OR OTHER DATA)

Well No. 2-1 is located 200 ft. from N line and 200 ft. from E line of sec. 2  
H-1  
2-1 (1/4 Sec. and Sec. No.) 200 (Twp.) 200 (Range) 200 (Meridian)  
200 (Field) 200 (County or Subdivision) 200 (State or Territory)

The elevation of the \_\_\_\_\_ floor above sea level is \_\_\_\_\_ ft.

## DETAILS OF WORK

(State names of and expected depths to objective sands; show sizes, weights, and lengths of proposed casings; indicate mudding jobs, cementing points, and all other important proposed work)

Drill 9" hole to 40' & set two jets 75 and 1-05 and connected w/20' on cement. Drill 6" hole to approx 1100' to test the Johns Signature. No commercial production is found at 9.5 1-05 and will be set and connected to the surface.



**I understand that this plan of work must receive approval in writing by the Geological Survey before operations may be commenced.**

Company Hing Oil Company  
Address Vol. E. Bureau & Assoc., Inc.  
120 S. Commercial  
Birmingham, New Mexico

By \_\_\_\_\_  
Title Consulting Engineer

NEW MEXICO OIL CONSERVATION COMMISSION  
Well Location and Acreage Dedication Plat

Section A.

Date August 27, 1958

Operator KING OIL COMPANY Lease NAVAJO  
Well No. W-2 Unit Letter I Section 5 Township 30 NORTH Range 17 WEST. NMFM  
Located 1980 Feet From the SOUTH Line, 330 Feet From the EAST Line  
County SAN JUAN G. L. Elevation 5081.0 Dedicated Acreage 1 Acres  
Name of Producing Formation Sakota Pool Undesignated

1. Is the Operator the only owner\* in the dedicated acreage outlined on the plat below?  
Yes 1 No       .
2. If the answer to question one is "no," have the interests of all the owners been consolidated by communitization agreement or otherwise? Yes        No       . If answer is "yes," Type of Consolidation
3. If the answer to question two is "no," list all the owners and their respective interests below:

Owner

Land Description

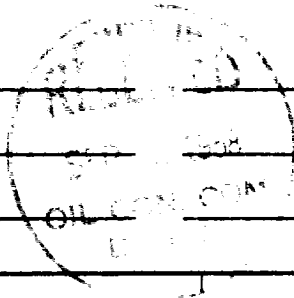

Section B

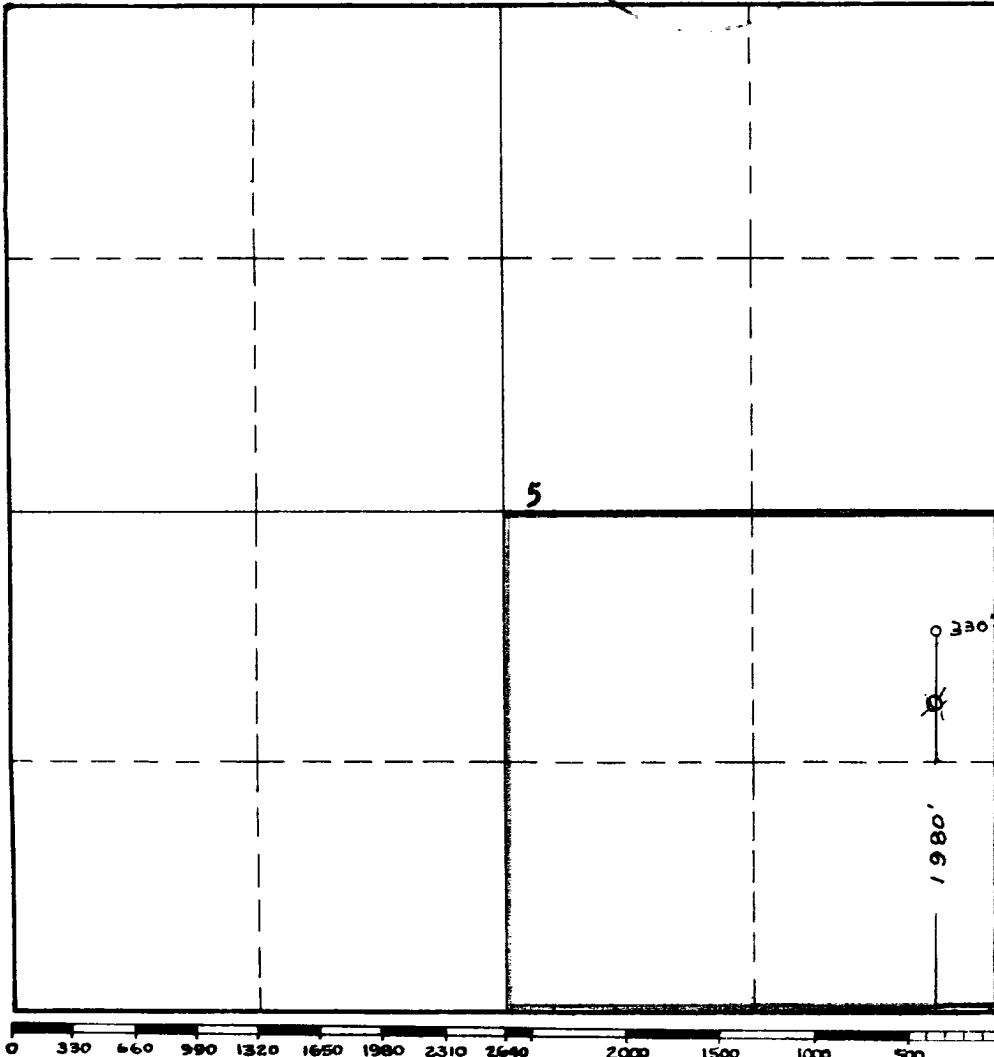

This is to certify that the information in Section A above is true and complete to the best of my knowledge and belief.

King Oil Company  
(Operator)

(Representative)  
120 S. Commercial  
Farlington, New Mexico  
Address

This is to certify that the well location shown on the plat in Section B was plotted from field notes of actual surveys made by me or under my supervision and that the same is true and correct to the best of my knowledge and belief.

Date Surveyed 17 August 1958

James P. Leese  
Registered Professional  
Engineer and/or Land Surveyor.  
James P. Leese

Certificate No. 1463

INSTRUCTIONS FOR COMPLETION:

1. Operator shall furnish and certify to the information called for in Section A.
2. Operator shall outline the dedicated acreage for both oil and gas wells on the plat in Section B.
3. A registered professional engineer or land surveyor registered in the State of New Mexico or approved by the Commission shall show on the plat the location of the well and certify this information in the space provided.
4. All distances shown on the plat must be from the outer boundaries of Section.
5. If additional space is needed for listing owners and their respective interests as required in question 3, Section A, please use space below

6

\* "Owner" means the person who has the right to drill into and to produce from any pool and to appropriate the production either for himself or for himself and another. (65-3-29 (e) NMSA 1953 Comp.)