

1-File
1-Review
1-File

(SUBMIT IN TRIPLICATE)

Budget Bureau No. 42-E359.4.
Approval expires 12-31-60.

Indian Agency Bureau

UNITED STATES
DEPARTMENT OF THE INTERIOR
GEOLOGICAL SURVEY

Allottee _____

Lease No. 34-20-403-2002

SUNDRY NOTICES AND REPORTS ON WELLS

NOTICE OF INTENTION TO DRILL <u>XX</u>	SUBSEQUENT REPORT OF WATER SHUT-OFF
NOTICE OF INTENTION TO CHANGE PLANS	SUBSEQUENT REPORT OF SHOOTING OR ACIDIZING
NOTICE OF INTENTION TO TEST WATER SHUT-OFF	SUBSEQUENT REPORT OF ALTERING CASING
NOTICE OF INTENTION TO REDRILL OR REPAIR WELL	SUBSEQUENT REPORT OF REDRILLING OR REPAIR
NOTICE OF INTENTION TO SHOOT OR ACIDIZE	SUBSEQUENT REPORT OF ABANDONMENT
NOTICE OF INTENTION TO PULL OR ALTER CASING	SUPPLEMENTARY WELL HISTORY
NOTICE OF INTENTION TO ABANDON WELL	

(INDICATE ABOVE BY CHECK MARK NATURE OF REPORT, NOTICE, OR OTHER DATA)

RECEIVED
AUG 19 1958
U. S. GEOLOGICAL SURVEY
FARMINGTON, NEW MEXICO

August 18

1958

Well No. Bureau 0-2 is located 3310 ft. from N line and 330 ft. from E line of sec. 5
SE 1/4 Sec 5 (1/4 Sec. and Sec. No.) 30N 17W 101N (Twp.) (Range) (Meridian)
Undesignated (Field) San Juan (County or Subdivision) New Mexico (State or Territory)

The elevation of the surface floor above sea level is 3040 ft.

DETAILS OF WORK

(State names of and expected depths to objective sands; show sizes, weights, and lengths of proposed casings; indicate mudding jobs, cementing points, and all other important proposed work)

Drill 9" hole to 90' and set 7" 20# J-55 csg cemented w/25 sz.

Drill 6 1/2" hole to approx 1050' to test Bakota formation.

RECEIVED
AUG 21 1958
U. S. GEOLOGICAL SURVEY
DIST. 3

I understand that this plan of work must receive approval in writing by the Geological Survey before operations may be commenced.

Company King Oil Company
Address Val E. House & Assoc., Inc.
120 S. Commercial
Farmington, New Mexico
By [Signature]
Title Consulting Engineer

NEW MEXICO OIL CONSERVATION COMMISSION
Well Location and Acreage Dedication Plat

Section A.

Date August 18, 1958

Operator KING OIL COMPANY Lease NAVAJO
Well No. 0-2 Unit Letter H Section 5 Township 30 NORTH Range 17 WEST NMFM
Located 2310 Feet From THE NORTH Line, 330 Feet From THE EAST Line
County SAN JUAN G. L. Elevation 5068.0 Dedicated Acreage 40 Acres
Name of Producing Formation Dakota Pool Undesignated

1. Is the Operator the only owner* in the dedicated acreage outlined on the plat below?
Yes X No .
2. If the answer to question one is "no," have the interests of all the owners been consolidated by communitization agreement or otherwise? Yes No . If answer is "yes," Type of Consolidation
3. If the answer to question two is "no," list all the owners and their respective interests below:

Owner

Land Description

Section B

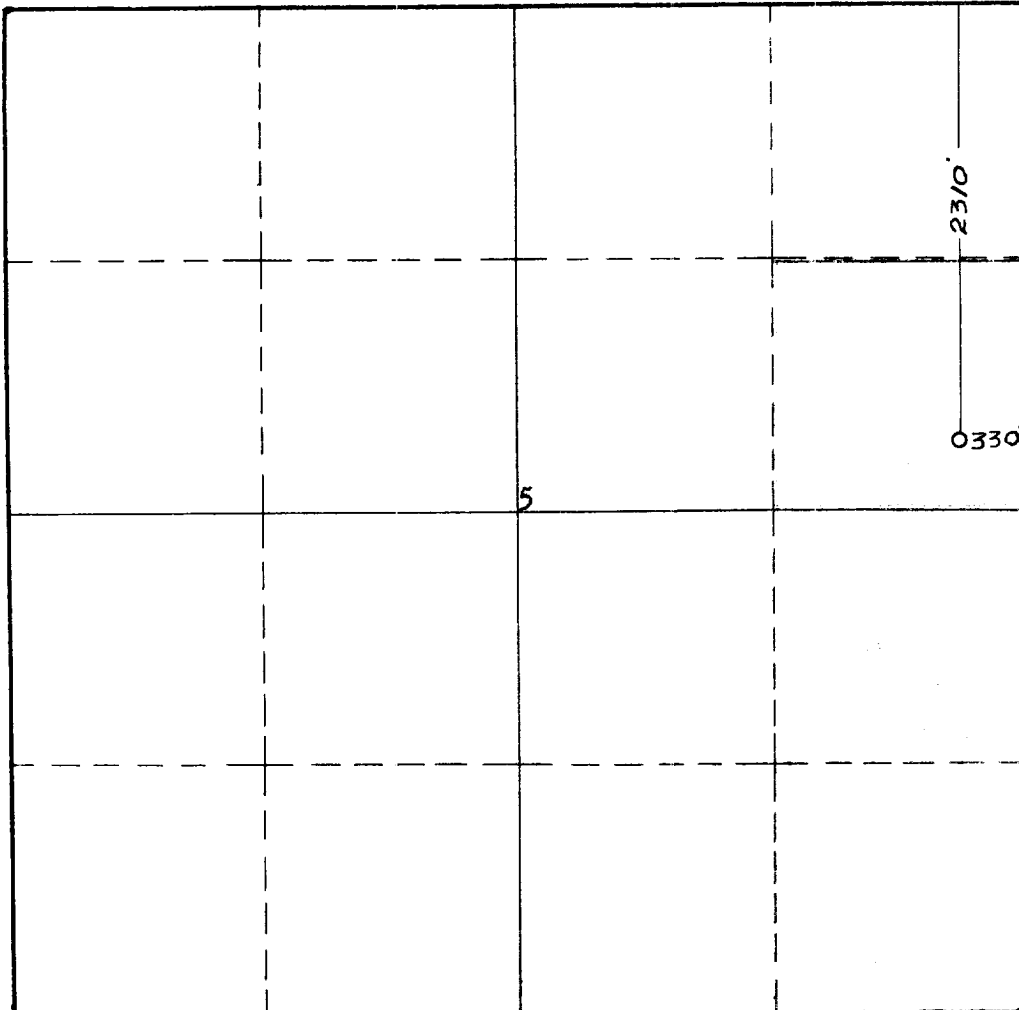

This is to certify that the information in Section A above is true and complete to the best of my knowledge and belief.

King Oil Company

(Operator)

(Representative)

Val R. Reese & Assoc., Inc.
120 S. Commercial

Address

Farmington, New Mexico

This is to certify that the well location shown on the plat in Section B was plotted from field notes of actual surveys made by me or under my supervision and that the same is true and correct to the best of my knowledge and belief.

Date Surveyed 17 AUGUST 1958

James P. Leese
Registered Professional
Engineer and/or Land Surveyor.

JAMES P. LEESE

Certificate No. 1463

(See instructions for completing this form on the reverse side)

INSTRUCTIONS FOR COMPLETION:

1. Operator shall furnish and certify to the information called for in Section A.
2. Operator shall outline the dedicated acreage for both oil and gas wells on the plat in Section B.
3. A registered professional engineer or land surveyor registered in the State of New Mexico or approved by the Commission shall show on the plat the location of the well and certify this information in the space provided.
4. All distances shown on the plat must be from the outer boundaries of Section.
5. If additional space is needed for listing owners and their respective interests as required in question 3, Section A, please use space below

* "Owner" means the person who has the right to drill into and to produce from any pool and to appropriate the production either for himself or for himself and another. (65-3-29 (e) NMSA 1953 Comp.)