

**ILLECIBLE**  
NEW MEXICO OIL CONSERVATION COMMISSION  
**NOTICE OF INTENTION TO DRILL**

See Rules 101 and 1104.

If changes in the proposed plan are considered advisable, a copy of this notice showing such changes will be returned to the sender. Submit this notice in triplicate. One copy will be returned following approval.

Form C-101

**RECEIVED**

MAY 6 1952

OIL CON. COM.

DIST. 3

P.O. Box 1360

Albuquerque, New Mexico

May 3, 1952

Place

Date

Notice hereby is given that it is our intention to commence the drilling of a well to be known as

**Pubco Development, Inc.**

**STATE**

well No. **7**

in **NE/4**

Company or Operator

Lease

of Sec. **32**, T. **31N**, R. **8E**, N. M., P. M., **Blanco** Pool, **San Juan** County.

N

The well is **1450'** feet from (N.) (**E**) line and **1790'** feet from (E.) (**N**.) line of the above section.

(Give location from section lines. Cross out wrong directions.)

If state land the oil and gas lease is No. **see below** Assignment No.

<del>1/2 NE/4 SE/4</del>	<b>5/2 NE/4 W/2 SE/4</b>	
<del>1/2 NE/4 SE/4</del>	<b>SE/4 SE/4 E-5384 Pubco</b>	<b>200 acres</b>
<del>1/2 NE/4 SE/4</del>	<b>NE/4 NE/4 B-11240 (assignment pending to Pubco)</b>	<b>40 acres</b>
<del>1/2 NE/4 SE/4</del>	<b>NE/4 NE/4 E-5113 Pubco</b>	<b>40 acres</b>
<del>1/2 NE/4 SE/4</del>	<b>NE/4 SE/4 E-1196 El Paso</b>	<b>40 acres</b>
<del>1/2 NE/4 SE/4</del>		<b>320 acres</b>

AREA 640 ACRES

LOCATE WELL CORRECTLY

We propose to drill well with drilling equipment as follows:

**Rotary tools to the top of the Cliffhouse and complete in the Mesa Verde**

The status of a bond for this well in conformance with Rule 101 of the General Rules and Regulations of the Commission is as follows: **\$10,000 payment bond on file with the Commission.**

We propose to use the following strings of casing and to land or cement them as indicated:

Size of Hole	Size of Casing	Weight Per Foot	New or Second Hand	Depth	Landed or Cemented	Sacks Cement
13 1/4"	10 1/4"	32.75'	NEW	200 - 250	cemented	150
9"	7"	20' & 23'	NEW	4800+	cemented	250

If changes in the above plans become advisable we will notify you before cementing or landing casing. We estimate that the first productive oil or gas sand should occur at a depth of about **4800 +** feet.

Additional information:

**It is requested that approval be given to drill with gas through the Mesa Verde Sands. It is also requested that approval be given to shoot the section with solid nitroglycerine.**

**MAY 6 1952**

Approved \_\_\_\_\_, 19\_\_\_\_

except as follows:

**Pubco Development, Inc.**

Company or Operator

By **Frank D. Gorham** by **C. S. Peters**

Position **Vice President**

Send communications regarding well to:

Name **Frank D. Gorham, Jr.**

Address **P.O. Box 1360, Albuquerque, New Mexico**

OIL CONSERVATION COMMISSION,

By **Al Green**

Title **Oil and Gas Inspector Dist. #3.**



Company Pubco Development, Inc.

Lease \_\_\_\_\_ Well No. \_\_\_\_\_

Sec. 32 T. 31 N., R. 8 W., N.M.P.M.

Location 1650' from the North line and 1790' from the East line.

San Juan County

New Mexico

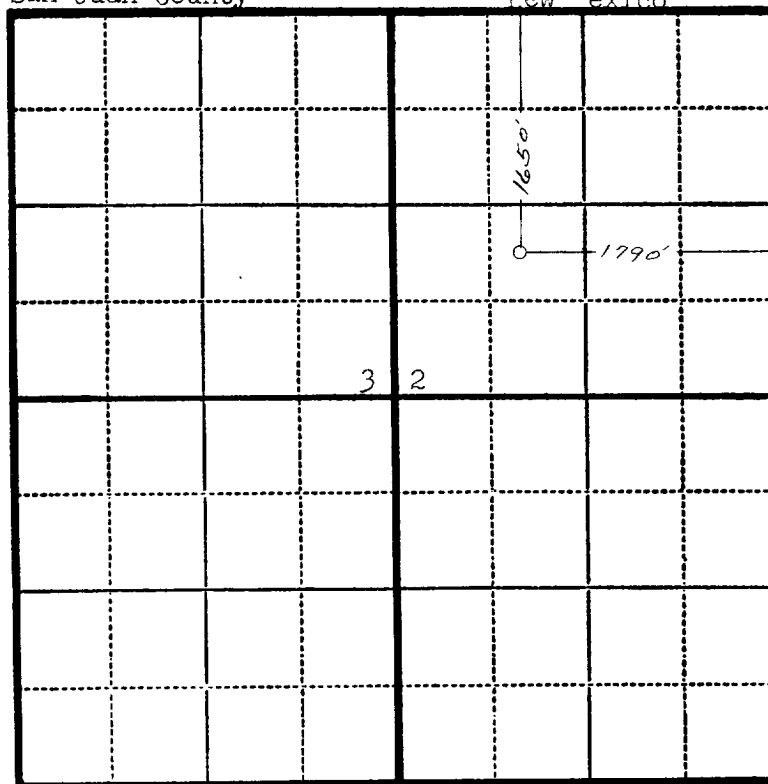

Scale—4 inches equals 1 mile.

This is to certify that the above plat was prepared from field notes of actual surveys made by me or under my supervision and that the same are true and correct to the best of my knowledge and belief.

Seal:

Registered Professional  
Engineer and Land Surveyor.

Charles J. Finklen  
N. Mex. Reg. No. 1302

Surveyed April 29, 19 52