



COPY TO O.G.C.

UNITED STATES  
DEPARTMENT OF THE INTERIOR  
GEOLOGICAL SURVEY  
P. O. Box 965  
Farmington, New Mexico

IN REPLY REFER TO:

May 24, 1956



Pacific Northwest Pipeline Corp.  
1134 West Main  
Farmington, New Mexico

Re: Santa Fe 079047  
14-08-001-446

Gentlemen:

Receipt is acknowledged of your "Notice of Intention to Drill" dated May 22, 1956 covering your well No. 17-23 San Juan 32-8 Unit in SW $\frac{1}{4}$  SW $\frac{1}{4}$  sed. 23, T. 31 N., R. 8 W., N. M. P. M., San Juan County, New Mexico, Blanco Mesa Verde pool.

Your proposed work is hereby approved subject to compliance with the provisions of the "Oil and Gas Operating Regulations" revised May 25, 1942, a copy of which will be sent to you on request, and subject to the following conditions:

1. Drilling operations so authorized are subject to the attached sheet for general conditions of approval.
2. Furnish copies of all logs.

Very truly yours,

(Orig. Sgd. P. T. McGrath)

P. T. McGrath  
District Engineer

PTMcGrath:ac

UNITED STATES  
DEPARTMENT OF THE INTERIOR  
GEOLOGICAL SURVEY



TO THE DIRECTOR, GEOLOGICAL SURVEY,  
WASHINGTON, D. C.

FROM THE CHIEF OF FIELD OFFICE,  
WASHINGTON, D. C.

SUBJECT: [Illegible]

[Illegible text follows, appearing to be a memorandum or report.]

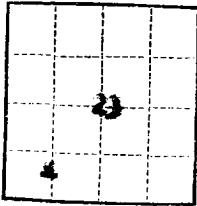

1-000  
1-000  
1-000

UNITED STATES  
DEPARTMENT OF THE INTERIOR  
GEOLOGICAL SURVEY

Land Office \_\_\_\_\_ Santa Fe \_\_\_\_\_  
Lease No. \_\_\_\_\_ M.F. 079042 \_\_\_\_\_  
Unit \_\_\_\_\_ 14-3 \_\_\_\_\_  
\_\_\_\_\_ 14-07-001-446 \_\_\_\_\_

NOTICE OF INTENTION TO DRILL.....	<input checked="" type="checkbox"/>	SUBSEQUENT REPORT OF WATER SHUT-OFF.....
NOTICE OF INTENTION TO CHANGE PLANS.....	<input type="checkbox"/>	SUBSEQUENT REPORT OF SHOOTING OR ACIDIZING.....
NOTICE OF INTENTION TO TEST WATER SHUT-OFF.....	<input type="checkbox"/>	SUBSEQUENT REPORT OF ALTERING CASING.....
NOTICE OF INTENTION TO RE-DRILL OR REPAIR WELL.....	<input type="checkbox"/>	SUBSEQUENT REPORT OF RE-DRILLING OR REPAIR.....
NOTICE OF INTENTION TO SHOOT OR ACIDIZE.....	<input type="checkbox"/>	SUBSEQUENT REPORT OF ABANDONMENT.....
NOTICE OF INTENTION TO PULL OR ALTER CASING.....	<input type="checkbox"/>	SUPPLEMENTARY WELL HISTORY.....
NOTICE OF INTENTION TO ABANDON WELL.....	<input type="checkbox"/>	

(INDICATE ABOVE BY CHECK MARK)

(INDICATE ABOVE BY CHECK MARK NATURE OF REPORT, NOTICE, OR OTHER DATA)

Well No. 17-23 is located 955 ft. from (N) line and 1055 ft. from (E) line of sec. 23

34-34-23 (Sec. and Sec. No.) 318 (Twp.) (Range) 14-14-14 (Meridian)  
Blanco, Mont. (Field) San Juan (County or Subdivision) New Mexico (State or Territory)

The elevation of the ~~structure~~ ~~derrick floor~~ above sea level is 6671.4 ft.

(State names of and expected depths to objective sands; show sizes, weights, and lengths of proposed casings; indicate mudding jobs, cementing points, and all other important proposed work)

Proposed to drill to 250'. Set 10-3/4" csg. cemented w/150 ex 41 gal. Drill w/water and minimum mud to 3514'. Set 7-5/8" csg cemented w/150 ex 81 gal and 50 ex seat on bottom. Drill w/gas to 5856'. Set 5-1/2" csg cemented w/175 ex reg ent. Perforate and water fracs the Cliff House, Menafee, and Ft. Lookout, separately, each w/40,000 gals water, clean out, run tubing and complete well. 320 Acres 1/2 sec 23 dedicated to this well.

**I understand that this plan of work must receive approval in writing by the Geological Survey before operations may be commenced.**

Company Pacific Northwest Pipeline Corp.

Address 4131 E. Main, Farmington, N.H.

By Original signed by T. A. Dugan

Title District Engineer

NEW MEXICO  
OIL CONSERVATION COMMISSION

Form C-128

Well Location and/or Gas Proration Plat

Date Mar 14, 1956

Operator PACIFIC NORTHWEST PIPELINE CORPORATION Lease Unit 12-0

Well No. 17-23 Section 23 Township 31 NORTH Range 8 WEST, NMPM

Located 955 Feet From the SOUTH Line, 1055 Feet From the WEST Line,

SAN JUAN County, New Mexico. G. L. Elevation 6471.4 UNGRADED.

Name of Producing Formation Blanco Pool Hess Verde Dedicated Acreage 320

(Note: All distances must be from outer boundaries of Section)

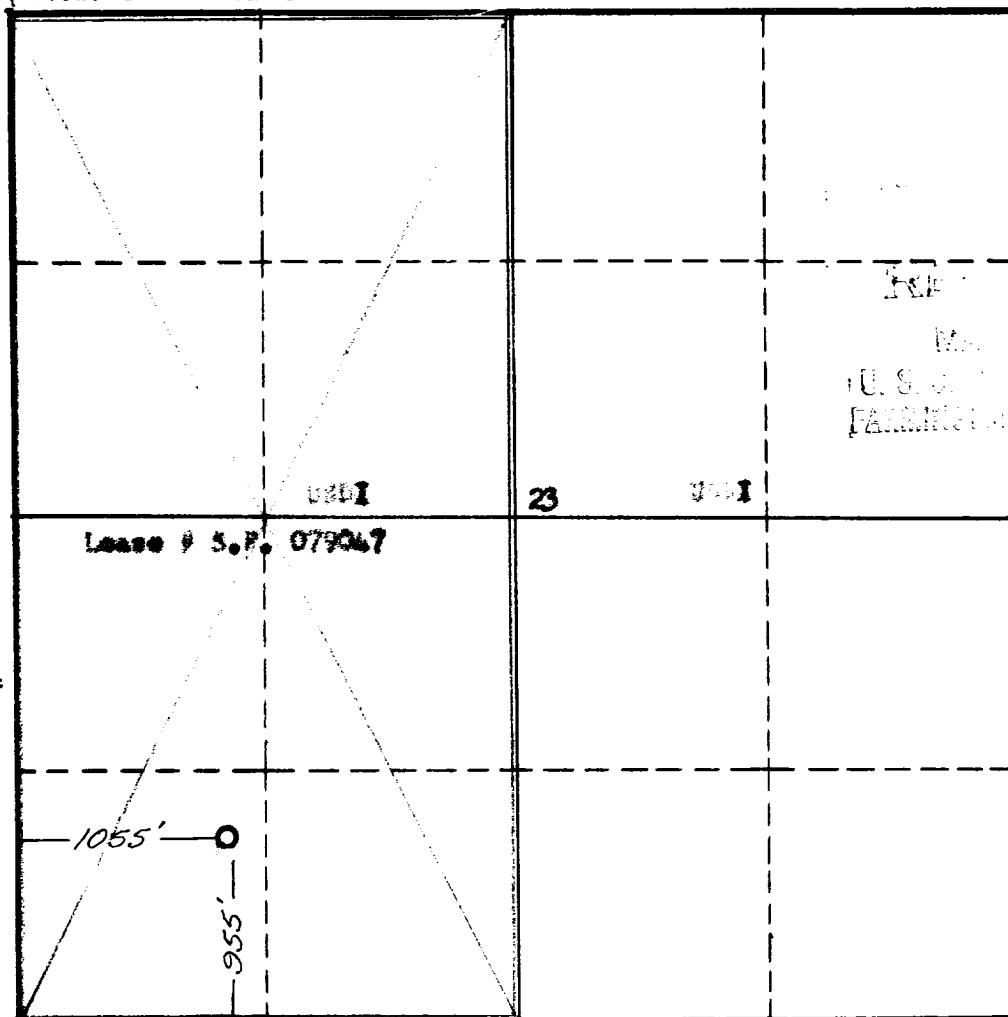

NOTE

This section of form is to be used for gas wells only.



1. Is this Well a Dual Comp. ? Yes    No
2. If the answer to Question 1 is yes, are there any other dually completed wells within the dedicated acreage? Yes    No

Name Original signed by T. A. Dugan  
Position District Engineer  
Representing Pacific Northwest Pipeline Corp.  
Address 413 W. Main, Pahrump, Nev.

This is to certify that the above plat was prepared from field notes of actual surveys made by me or under my supervision and that the same are true and correct to the best of my knowledge and belief.

Date Surveyed 15 MARCH 1956  
James P. Lense  
Registered Professional Engineer and/or  
Land Surveyor JAMES P. LENSE  
N. MEX. REG. NO. 1463