

(SUBMIT IN TRIPLICATE)

UNITED STATES
DEPARTMENT OF THE INTERIOR
GEOLOGICAL SURVEY

Land Office _____
Lease No. _____
Unit _____
14-08-001-446

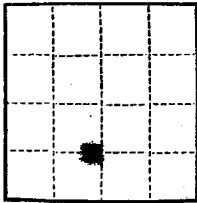

COPY TO O.C.C.

SUNDRY NOTICES AND REPORTS ON WELLS

NOTICE OF INTENTION TO DRILL	SUBSEQUENT REPORT OF WATER SHUT-OFF
NOTICE OF INTENTION TO CHANGE PLANS	SUBSEQUENT REPORT OF SHOOTING OR ACIDIZING
NOTICE OF INTENTION TO TEST WATER SHUT-OFF	SUBSEQUENT REPORT OF ALTERING CASING
NOTICE OF INTENTION TO RE-DRILL OR REPAIR WELL	SUBSEQUENT REPORT OF RE-DRILLING OR REPAIR
NOTICE OF INTENTION TO SHOOT OR ACIDIZE	SUBSEQUENT REPORT OF ABANDONMENT
NOTICE OF INTENTION TO PULL OR ALTER CASING	SUPPLEMENTARY WELL HISTORY
NOTICE OF INTENTION TO ABANDON WELL	

(INDICATE ABOVE BY CHECK MARK NATURE OF REPORT, NOTICE, OR OTHER DATA)

September 24, 1953

Well No. 9-20 is located 2360 ft. from S line and 2700 ft. from E line of sec. _____
22/23 Sec. 20 (1/4 Sec. and Sec. No.) 20 (Twp.) 20 (Range) S. 40. P. 20. (Meridian)
Wabasha (Field) San Juan (County or Subdivision) New Mexico (State or Territory)

The elevation of the ground above sea level is 6440 ft.

DETAILS OF WORK

(State names of and expected depths to objective sands; show sizes, weights, and lengths of proposed casings; indicate mudding jobs, cementing points, and all other important proposed work)

Propose to drill to approximately 3000 using tool. Set casing at top of pay. Some tests will be drilled with gas and cleaned out with gas after each. Rotary tools will be used to 20.

Proposed casing:

Set 9-5/8" casing at 1500 and cement with approximately 200 sac.
Set 7" casing at top of pay and cement with approximately 200 sac.

Location Plot attached.

I understand that this plan of work must receive approval in writing by the Geological Survey before operations may be commenced.

Company Phillips Petroleum Company

Address P. O. Box 999

Alamogordo, New Mexico

By Earl Stumm

Title District Superintendent

Company Phillips Petroleum Company

Lease _____ Well No. _____

Sec. 10, T. 31 N., R. 8 W., N.M.P.M.

Location 1160' from the South line and 1700' from the West line.

Elevation 6643 Ungraded ground.

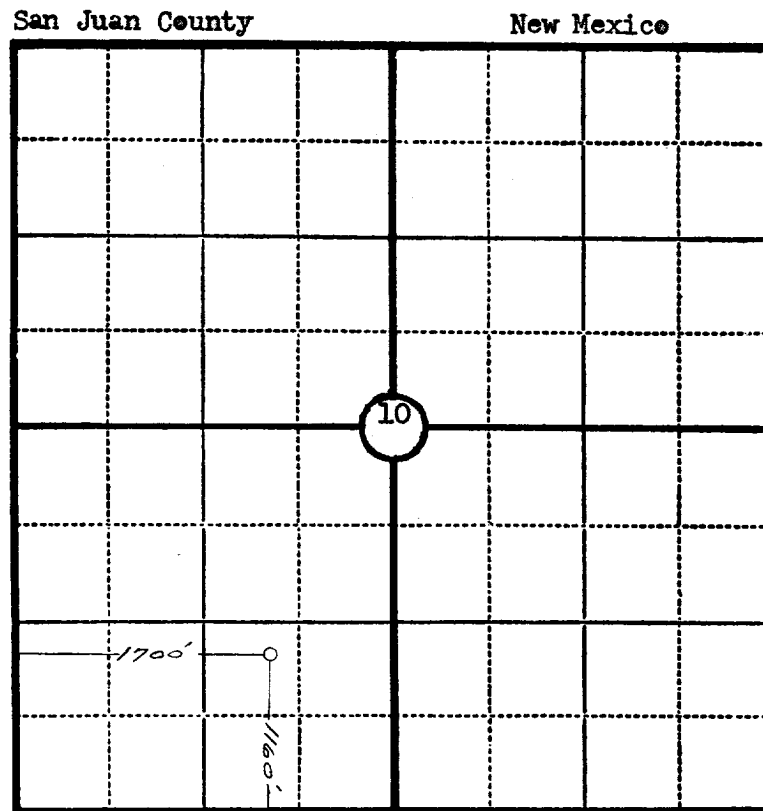

RECEIVED
SEP 13 53
U.S. SURVEY

RECEIVED
SEP 21 1953
OIL CON. COM.
DIST. 3

Scale—4 inches equal 1 mile.

This is to certify that the above plat was prepared from field notes of actual surveys made by me or under my supervision and that the same are true and correct to the best of my knowledge and belief.

Ernest V. Echohawk

Seal:

Registered Professional
Engineer and Land Surveyor.

Ernest V. Echohawk
N. Mex. Reg. No. 1545

Surveyed September 10, 19 53