

(SUBMIT IN TRIPLICATE)

UNITED STATES
DEPARTMENT OF THE INTERIOR
GEOLOGICAL SURVEY

Indian Agency _____

Navajo

Allettee _____

Lease No. 14-20-603-1055

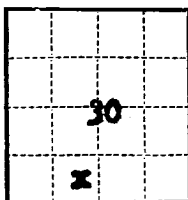

SUNDRY NOTICES AND REPORTS ON WELLS

RECEIVED

NOTICE OF INTENTION TO DRILL	<input checked="" type="checkbox"/>	SUBSEQUENT REPORT OF WATER SHUT-OFF	
NOTICE OF INTENTION TO CHANGE PLANS		SUBSEQUENT REPORT OF SHOOTING OR ACIDIZING	
NOTICE OF INTENTION TO TEST WATER SHUT-OFF		SUBSEQUENT REPORT OF ALTERING CASING	
NOTICE OF INTENTION TO REDRILL OR REPAIR WELL		SUBSEQUENT REPORT OF REDRILLING OR REPAIR	
NOTICE OF INTENTION TO SHOOT OR ACIDIZE		SUBSEQUENT REPORT OF ABANDONMENT	
NOTICE OF INTENTION TO PULL OR ALTER CASING		SUPPLEMENTARY WELL HISTORY	
NOTICE OF INTENTION TO ABANDON WELL			

OCT 15 1962

U. S. GEOLOGICAL SURVEY
FARMINGTON, NEW MEXICO

(INDICATE ABOVE BY CHECK MARK NATURE OF REPORT, NOTICE, OR OTHER DATA)

October 11, 1962

Well No. 150 is located 660 ft. from SW line and 1900 ft. from W line of sec. 30

SW 1/4 Section 30
(1/4 Sec. and Sec. No.)

T30N, R18W
(Twp.) (Range)

114M
(Meridian)

Rattlesnake Dakota
(Field)

San Juan County
(County or Subdivision)

New Mexico
(State or Territory)

The elevation of the derrick floor above sea level is 5226 ft.

DETAILS OF WORK

(State names of and expected depths to objective sands; show sizes, weights, and lengths of proposed casings; indicate mudding jobs, cementing points, and all other important proposed work)

We propose to drill this well with rotary tools to an estimated depth of 940' to test the Dakota formation. A string of 5 1/2" casing will be run and cemented to surface and the well completed.



I understand that this plan of work must receive approval in writing by the Geological Survey before operations may be commenced.

Company Continental Oil Company

Address P. O. Box 3312

Durango, Colorado

By

H. D. Haley

Title District Superintendent

... of the ... and ...
... of the ... and ...
... of the ... and ...

NUMBER OF COPIES RECEIVED	
DISTRIBUTION	
SANTAFE	
FILE	
U.S. S.	
LAND OFFICE	
TRANSPORTATION	OIL GAS
PRODUCTION OFFICE	
OPERATOR	

NEW MEXICO OIL CONSERVATION COMMISSION
WELL LOCATION AND ACREAGE DEDICATION PLAT
 SEE INSTRUCTIONS FOR COMPLETING THIS FORM ON THE REVERSE SIDE

FORM C-128
 Revised 5/1/57

SECTION A

Operator Continental Oil Company			Lease Hattiesburg		Well No. 130
Unit Letter N	Section 30	Township 30N	Range 18W	County San Juan	
Actual Footage Location of Well: 660 feet from the South line and 1900 feet from the West line					
Ground Level Elev. 5815	Producing Formation Dakota	Pool Hattiesburg Dakota		Dedicated Acreage: 40 Acres	

1. Is the Operator the only owner in the dedicated acreage outlined on the plat below? YES ☒ NO ____ . ("Owner" means the person who has the right to drill into and to produce from any pool and to appropriate the production either for himself or for himself and another. (65-3-29 (e) NMSA 1935 Comp.)
2. If the answer to question one is "no," have the interests of all the owners been consolidated by communitization agreement or otherwise? YES ____ NO ____ . If answer is "yes," Type of Consolidation _____
3. If the answer to question two is "no," list all the owners and their respective interests below:

Owner	Land Description

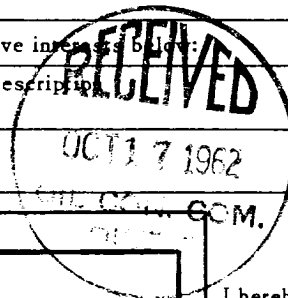

SECTION B

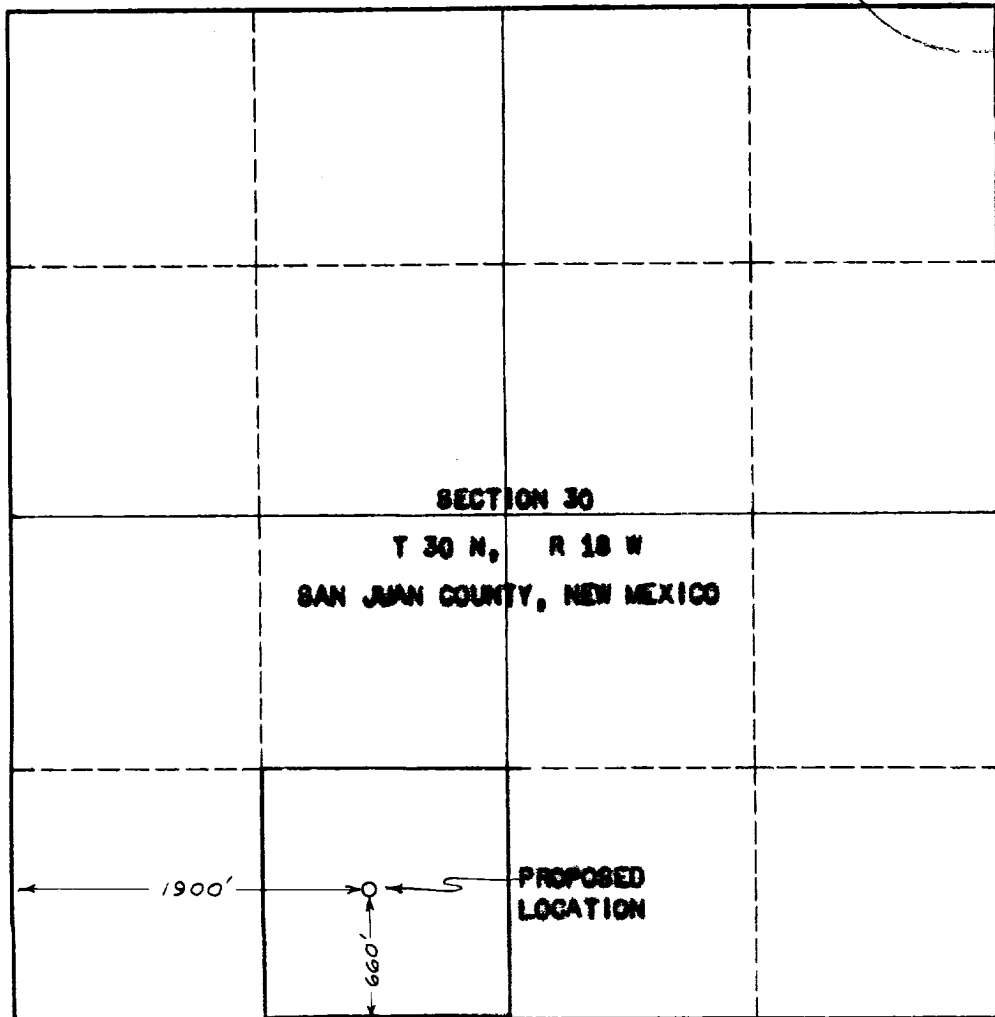

CERTIFICATION

I hereby certify that the information in SECTION A above is true and complete to the best of my knowledge and belief.

Name	Original Signed By: H. D. HALEY
Position	District Superintendent
Company	Continental Oil Company
Date	10-11-62

I hereby certify that the well location shown on the plat in SECTION B was plotted from field notes of actual surveys made by me or under my supervision, and that the same is true and correct to the best of my knowledge and belief.

Date Surveyed	10-10-62
Registered Professional Engineer and/or Land Surveyor	<i>[Signature]</i>

Certificate No. **3189**

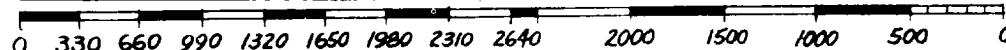

INSTRUCTIONS FOR COMPLETION OF FORM C-128

1. Operator shall furnish and certify to the information called for in Section A.
2. Operator shall outline the dedicated acreage for *both* oil and gas wells on the plat in Section B.
3. A registered professional engineer or land surveyor registered in the State of New Mexico or approved by the Commission shall show on the plat the location of the well and certify this information in the space provided.
4. All distances shown on the plat must be from the outer boundaries of the Section.
5. If additional space is needed for listing owners and their respective interests as required in question 3 of Section A, please use space below.