

30-045-21333

| | |
|------------------------|---|
| NO. OF COPIES RECEIVED | |
| DISTRIBUTION | 6 |
| SANTA FE | 1 |
| FILE | 1 |
| U.S.G.S. | 2 |
| LAND OFFICE | 1 |
| OPERATOR | 1 |

NEW MEXICO OIL CONSERVATION COMMISSION

Form C-101
Revised 1-1-65

| | |
|---|------------------------------|
| 5A. Indicate Type of Lease | |
| STATE <input checked="" type="checkbox"/> | FEE <input type="checkbox"/> |
| 5. State Oil & Gas Lease No. | |
| B-10400-1 | |

APPLICATION FOR PERMIT TO DRILL, DEEPEN, OR PLUG BACK

| | | | |
|---|--|----------------------------------|--|
| 1a. Type of Work | | 7. Unit Agreement Name | |
| DRILL <input checked="" type="checkbox"/> DEEPEN <input type="checkbox"/> PLUG BACK <input type="checkbox"/> | | | |
| b. Type of Well | | 8. Farm or Lease Name | |
| OIL WELL <input type="checkbox"/> GAS WELL <input checked="" type="checkbox"/> OTHER <input type="checkbox"/> | | Atlantic D Com O | |
| 2. Name of Operator | | 9. Well No. | |
| El Paso Natural Gas Company | | 16 | |
| 3. Address of Operator | | 10. Field and Pool, or Wildcat | |
| PO Box 990, Farmington, NM 87401 | | Blanco Pictured Cliffs Ext. | |
| 4. Location of Well | | 12. County | |
| UNIT LETTER <u>K</u> LOCATED <u>1650</u> FEET FROM THE <u>West</u> LINE | | San Juan | |
| AND <u>1460</u> FEET FROM THE <u>South</u> LINE OF SEC. <u>2</u> TWP. <u>30N</u> RGE. <u>10W</u> NMPM | | | |
| 19. Proposed Depth | | 19A. Formation | |
| 3243' | | Pictured Cliffs | |
| 20. Rotary or C.T. | | Rotary | |
| 21. Elevations (Show whether DF, RT, etc.) | | 22. Approx. Date Work will start | |
| 6438'GR | | | |
| 21A. Kind & Status Plug. Bond | | 21B. Drilling Contractor | |
| Statewide | | | |

23.

PROPOSED CASING AND CEMENT PROGRAM

| SIZE OF HOLE | SIZE OF CASING | WEIGHT PER FOOT | SETTING DEPTH | SACKS OF CEMENT | EST. TOP |
|--------------|----------------|-----------------|---------------|-----------------|----------------|
| 12 1/4" | 8 5/8" | 24.0# | 120' | 110 cu.ft. | circ. to surf. |
| 6 3/4" | 2 7/8" | 6.4# | 3243' | 430 cu.ft. | 1813' |

Selectively perforate and sandwater fracture the Pictured Cliffs formation.

The SW/4 of Section 2 is dedicated to this well.

APPROVAL VALID
FOR 90 DAYS UNLESS
DRILLING COMMENCED,EXPIRES 12-4-73

IN ABOVE SPACE DESCRIBE PROPOSED PROGRAM: IF PROPOSAL IS TO DEEPEN OR PLUG BACK, GIVE DATA ON PRESENT PRODUCTIVE ZONE AND PROPOSED NEW PRODUCTIVE ZONE. GIVE BLOWOUT PREVENTER PROGRAM, IF ANY.

I hereby certify that the information above is true and complete to the best of my knowledge and belief.

Signed A. H. Biscoe Title Drilling Clerk Date September 5, 1973

(This space for State Use)

APPROVED BY George E. Amel TITLE SUPERVISOR DIST. #0 DATE SEP 5 1973

CONDITIONS OF APPROVAL, IF ANY:

NE MEXICO OIL CONSERVATION COMMISSION
WELL LOCATION AND ACREAGE DEDICATION PLAT

Form O-10,
Supersedes O-12P
Effective 1-1-73

All distances must be from the outer boundaries of the Section.

| | | | | | |
|----------------------------------|--------------|---|---|--|----------------|
| EL PASO NATURAL GAS COMPANY | | | Lease ATLANTIC D COM. 0 (E-2724-2) | | Well No. 16 |
| Section Letter L | Section 2 | Township 30-N | Range 10-W | County SAN JUAN | |
| Actual Well Location: Well | | | | | |
| 1150 | SOUTH | | 1150 | WEST | |
| Ground Surface Elevation 6464 | | Distance from Section Corner PICTURED CLIFFS | Distance from Section Corner BLANCO PICTURED CLIFFS EXT. | Distance from Section Corner 160.00 | |

1. Outline the acreage dedicated to the subject well by colored pencil or hachure marks on the plat below.
2. If more than one lease is dedicated to the well, outline each and identify the ownership thereof (both as to working interest and royalty).
3. If more than one lease of different ownership is dedicated to the well, have the interests of all owners been consolidated by communitization, unitization, force-pooling, etc?

☒ Yes ☐ No If answer is "yes," type of consolidation **Communitization**

If answer is "no," list the owners and tract descriptions which have actually been consolidated. (Use reverse side of this form if necessary.)

No allowable will be assigned to the well until all interests have been consolidated (by communitization, unitization, forced-pooling, or otherwise) or until a non-standard unit, eliminating such interests, has been approved by the Commission. **NOTE: THIS PLAT IS REISSUED TO SHOW MOVED LOCATION. 11-8-73 11-13-73**

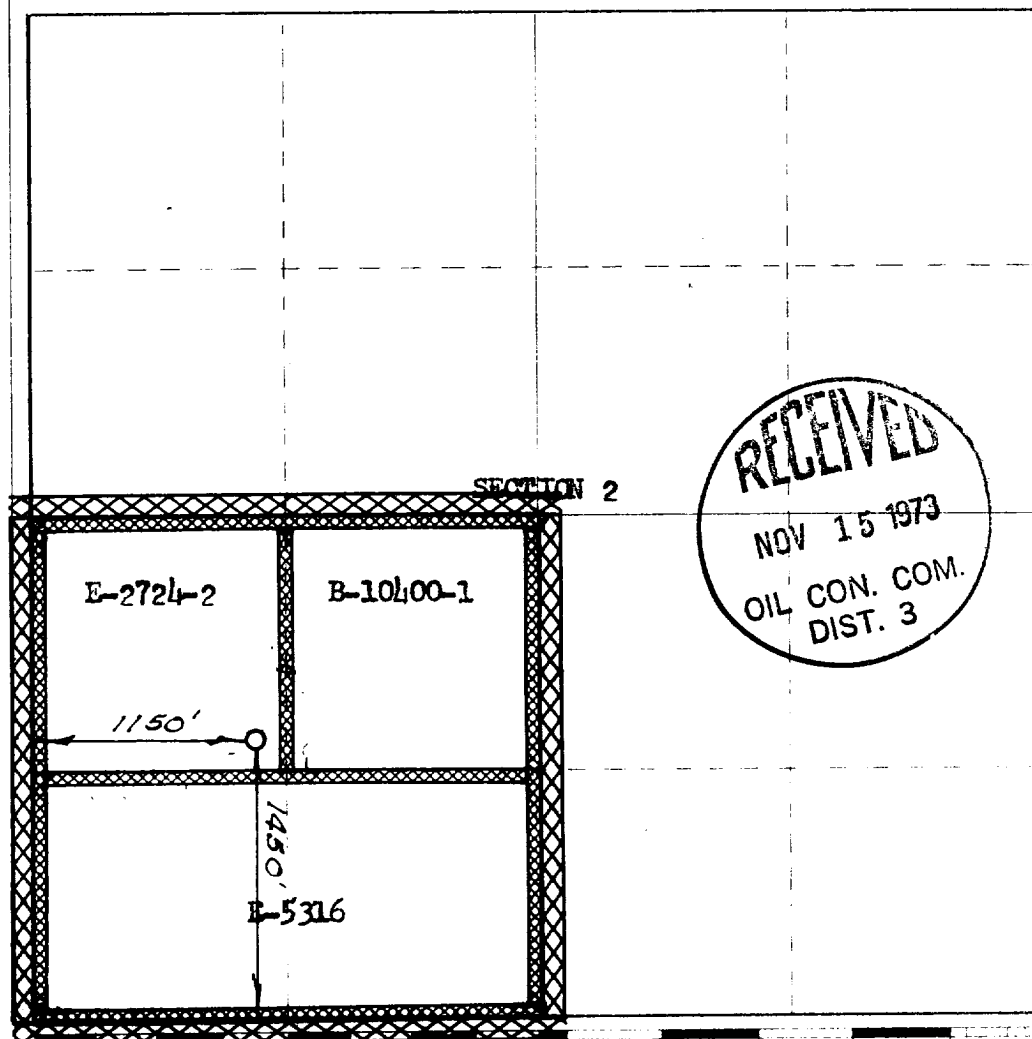

CERTIFICATION

I hereby certify that the information contained herein is true and complete to the best of my knowledge and belief.

Original Signed by
D. G. Brisco

Drilling Clerk

El Paso Natural Gas Co.

November 14, 1973

I hereby certify that the well location shown on this plat was plotted from the notes of actual surveys made by me or under my supervision, and that the same is true and correct to the best of my knowledge and belief.

NOVEMBER 7, 1973

David Wilson
1760

NEW MEXICO OIL CONSERVATION COMMISSION
WELL LOCATION AND ACREAGE DEDICATION PLAT

Form O-128
Supersedes O-128
Effective 1-1-73

All distances must be from the outer boundaries of the Section

| | | | | |
|-----------------------------|-----------------|------------------------------|--------|----------|
| EL PASO NATURAL GAS COMPANY | | ATLANTIC D CON. O (E-2724-2) | | 16 |
| L | 2 | 30-N | 10-W | SAN JUAN |
| 1550 | SOUTH | 1150 | WEST | |
| 6460 | PICTURED CLIFFS | BIANCO PICTURED CLIFFS EXT. | 160.00 | |

1. Outline the acreage dedicated to the subject well by colored pencil or hatchure marks on the plat below.
2. If more than one lease is dedicated to the well, outline each and identify the ownership thereof (both as to working interest and royalty).
3. If more than one lease of different ownership is dedicated to the well, have the interests of all owners been consolidated by communitization, unitization, force-pooling, etc?

X Yes ☐ No ☐ If answer is "yes," type of consolidation Communitization

If answer is "no," list the owners and tract descriptions which have actually been consolidated. (Use reverse side of this form if necessary.)

No allowable will be assigned to the well until all interests have been consolidated by communitization, unitization, force-pooling, or otherwise for until a non-standard unit, eliminating such interests, has been approved by the Commission. **NOTE: THIS PLAT IS REISSUED TO SHOW MOVED LOCATION. 11-8-73**

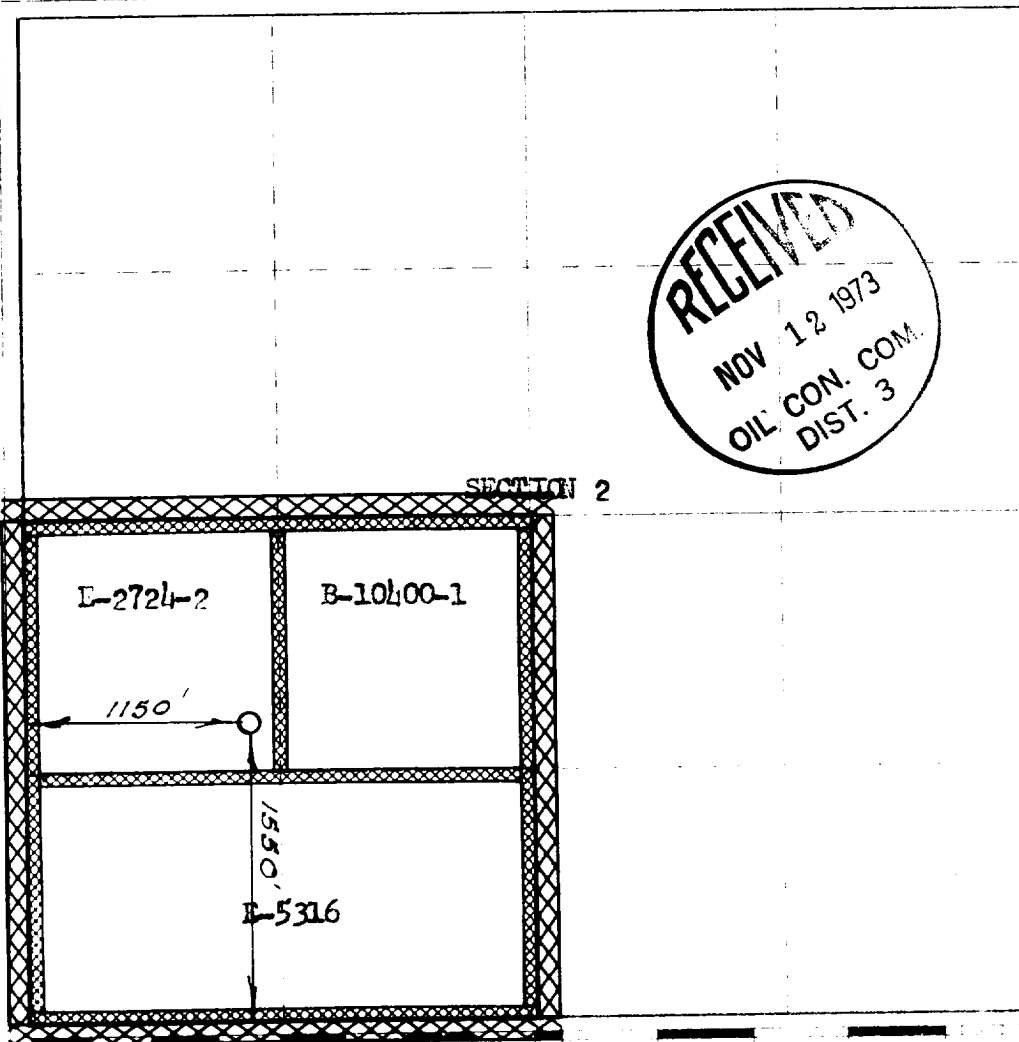

CERTIFICATION

I hereby certify that the information contained herein is true and complete to the best of my knowledge and belief.

Original Signed by
D. G. Brisco

Drilling Clerk

El Paso Natural Gas Co.

November 12, 1973

I hereby certify that the well location shown on this plat was determined from notes of actual survey made by me or under my supervision and that the same are correct to the best of my knowledge and belief.

NOVEMBER 7, 1973

David Wilburn
1760

NEW MEXICO OIL CONSERVATION COMMISSION
WELL LOCATION AND ACREAGE DEDICATION PLAT

Form O-101
Supersedes O-128
Effective 1-1-67

All distances must be from the outer boundaries of the Section

| | | | | |
|--|---------------------|---|----------------------|---------------------------|
| Owner EL PASO NATURAL GAS COMPANY | | Lease ATLANTIC D COM. 0 (B-10400-1) | | Well No. 16 |
| Tract Section K | Section 2 | Township 30-N | Range 10-W | County SAN JUAN |
| Amount - The Location of Well: 1460 feet from the SOUTH line and 1650 feet from the WEST line. Section and Elev. 6438 PICTURED CLIFFS BLANCO PICTURED CLIFFS EXT. 160.00 | | | | |

1. Outline the acreage dedicated to the subject well by colored pencil or hachure marks on the plat below.
2. If more than one lease is dedicated to the well, outline each and identify the ownership thereof (both as to working interest and royalty).
3. If more than one lease of different ownership is dedicated to the well, have the interests of all owners consolidated by communitization, unitization, force-pooling, etc?

☒ Yes ☐ No If answer is "yes," type of consolidation **Communitization**

If answer is "no," list the owners and tract descriptions which have actually been consolidated. (Use reverse side of this form if necessary.)

No allowable will be assigned to the well until all interests have been consolidated (by communitization, unitization, forced-pooling, or otherwise) or until a non-standard unit, eliminating such interests, has been approved by the Commission.

CERTIFICATION

I hereby certify that the information contained herein is true and complete to the best of my knowledge and belief.

Original Signed by

D. G. Brisco

Drilling Clerk

Position

El Paso Natural Gas Co.

Company

September 5, 1973

Date

I hereby certify that the well location shown on this plat was plotted from field notes of actual surveys made by me or under my supervision, and that the same is true and correct to the best of my knowledge and belief.

MARCH 5, 1973

Russell H McNeace
1500

